

# LIFE-SAFETY INFORMATION

<b>APPLICABLE CODES</b>	
NFPA 101 LIFE-SAFETY CODE 2015	
OCCUPANCY TYPE(S) AND CHAPTER(S) ASSEMBLY A-3 (CHAPTER 3)	
<b>OCCUPANT LOAD FACTOR</b>	(REFERENCE TABLE 7.3.1.2)
BLDG 'A' - ASSEMBLY A-3	50 GROSS - Exercise rooms 1st Flr = 15,526 s.f. / 50 gross = 310 2nd Flr = 14,150 s.f. / 50 gross = 283
BLDG 'B' - ASSEMBLY A-3	50 GROSS - Exercise rooms 1st Flr = 4,842 s.f. / 50 gross = 99 2nd Flr = 2,651 s.f. / 50 gross = 53
BLDG 'C' - ASSEMBLY A-3	50 GROSS - Exercise rooms 1st Flr = 21,605 s.f. / 50 gross = 432 2nd Flr = 12,784 s.f. / 50 gross = 256
<b>CLASSIFICATION OF HAZARD OF CONTENTS</b>	
(REFERENCE: OCCUPANCY CHAPTER AND 6.2.2. SPECIFY LOW, ORDINARY, OR HIGH)	
<b>CONSTRUCTION TYPE= VB</b> (REFERENCE: CHAPTER 8, TABLE A.8.2.1.2 AND COMMENTARY TABLE 8.1 IN HANDBOOK)	
<b>MINIMUM EXIT SEPARATION DISTANCE FOR REMOTELY LOCATED EXITS</b>	
(REFERENCE: SECTION 7.5; SPECIFY 1/2 OR 1/3 DIAGONAL DISTANCE OF AREA SERVED)	
1/2 DIAGONAL =	47'-8"
<b>MAXIMUM DEAD-END CORRIDORS</b>	(REFERENCE: OCCUPANCY CHAPTER AND TABLE A.7.6)
20 FEET	
<b>MAXIMUM COMMON PATH OF TRAVEL DISTANCE</b>	(REFERENCE: OCCUPANCY CHAPTER AND TABLE A.7.6)
20 FEET/15 FEET	
<b>MAXIMUM TRAVEL DISTANCE TO EXITS</b>	(REFERENCE: OCCUPANCY CHAPTER AND TABLE A.7.6)
200 FEET	
*MAIN ENTRANCE MUST BE SIGNED TO ACCOMMODATE 1/2 OCCUPANT LOAD OF BUILDING	
<b>EXTINGUISHMENT REQUIREMENTS</b>	NOT SPRINKLERED (NOT REQUIRED)
<b>DETECTION, ALARM, AND COMMUNICATION SYSTEMS</b>	NO
<b>ALLOWABLE HEIGHT AND BUILDING AREA</b>	PER IBC EQUIVALENT CONSTRUCTION TYPE

# CROSS GATES ATHLETIC CLUB SLIDELL LOUISIANA

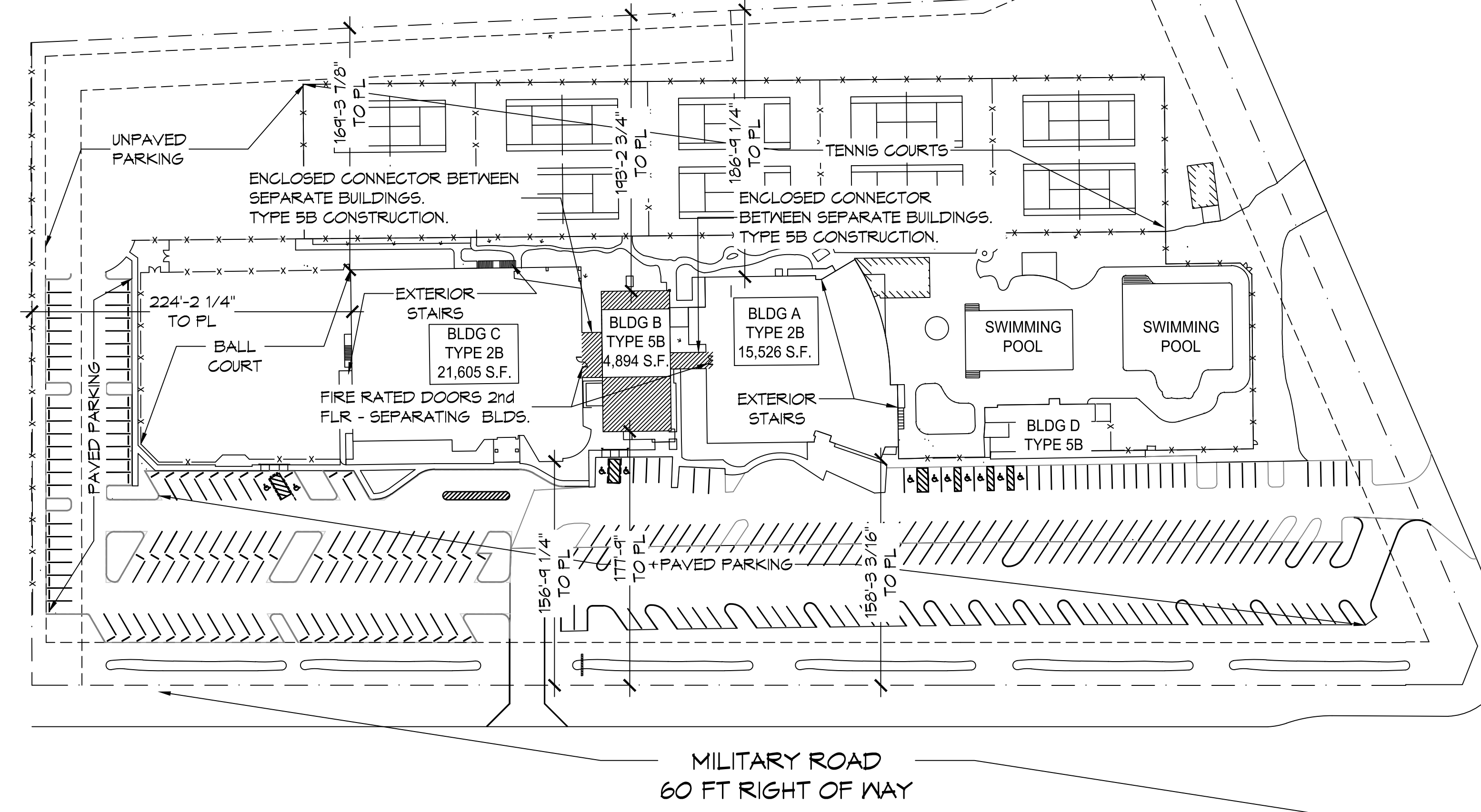

## BUILDING CODE INFORMATION

<b>APPLICABLE CODES</b>			
IBC 2015			
<b>ASSEMBLY GROUP AS</b>	(IBC 2015 CHAPTER 3)		
<b>OCCUPANT LOAD CALCULATIONS</b>	(REFERENCE TABLE 1004.1.2)		
BLDG 'A' - ASSEMBLY A-3	50 GROSS - Exercise rooms 1st Flr = 15,526 s.f. / 50 gross = 310 2nd Flr = 14,150 s.f. / 50 gross = 283		
BLDG 'B' - ASSEMBLY A-3	50 GROSS - Exercise rooms 1st Flr = 4,842 s.f. / 50 gross = 99 2nd Flr = 2,651 s.f. / 50 gross = 53		
BLDG 'C' - ASSEMBLY A-3	50 GROSS - Exercise rooms 1st Flr = 21,605 s.f. / 50 gross = 432 2nd Flr = 12,784 s.f. / 50 gross = 256		
<b>TOTAL OCCUPANTS</b>	Bldg A = 595 ; Bldg B = 152 ; Bldg C = 688		
<b>CONSTRUCTION TYPE(S)</b>	(TABLE 503)		
<b>ALLOWABLE HEIGHT AND BUILDING AREA LIMITED BY TYPE OF CONSTRUCTION</b>			
MAXIMUM HEIGHT (IBC TABLE 504.3)	MAXIMUM STORIES (IBC TABLE 504.4)	ALLOWABLE AREA FACTOR MULTI STORY SPRINKLERED	ALLOWABLE AREA FACTOR MULTI STORY NON-SPRINKLERED
BLDG A, SPRINKLED, TYP 2B = 75 FT	BLDG A, SPRINKLED, TYP 2B = 3	SM = 28,500 s.f.	NS = 9,500 s.f.
BLDG B, SPRINKLED, TYP 5B = 60 FT	BLDG B, SPRINKLED, TYP 5B = 2	SM = 18,000 s.f.	NS = 6,000 s.f.
BLDG C, SPRINKLED, TYP 2B = 75 FT	BLDG C, SPRINKLED, TYP 2B = 3	SM = 28,500 s.f.	NS = 9,500 s.f.

## WIND SPEED DESIGN REQUIREMENTS

THIS BUILDING SHALL BE DESIGNED WITH IBC SEC 1609 AS A FULLY ENCLOSED BLDG USING THE FOLLOWING INFORMATION:

<b>WIND DESIGN DATA: DETERMINATION OF WIND LOADS SHALL BE IN ACCORDANCE WITH IBC SEC 1609.3 (A), (B), OR (C) DEPENDING ON THE RISK CATEGORY</b>	
ULTIMATE WIND SPEED =	141 MPH (IBC FIG 1609C)
NOMINAL WIND SPEED =	V <sub>wd</sub> = 109 MPH
RISK FACTOR:	CATEGORY II
SURFACE ROUGHNESS =	B
TOPOGRAPHIC FACTOR =	1
EXPOSURE =	B
INTERNAL PRESSURE COEFFICIENT (ASCE 7-10 TABLE 26.11-1):	± 0.18

**LIVE LOADS (IBC SEC 1607)**

ASSEMBLY FIXED SEATING (IBC TABLE 1607.1):	60 PSF
PLATFORMS (ASSEMBLY) (IBC TABLE 1607.1):	100 PSF
LOBBIES (IBC TABLE 1607.1):	100 PSF
CLASSROOMS (IBC TABLE 1607.1):	40 PSF UNIFORM, 1,000 LB CONCENTRATED
ROOF LIVE LOADS (IBC TABLE 1607.1):	20 PSF UNIFORM, 300 LB CONCENTRATED
SNOW LOADS (IBC TABLE 1608):	
GROUND SNOW LOAD (IBC FIG 1608.2):	5 PSF

## FLOOD ZONE INFORMATION

BASED ON THE SURVEY OF THIS PROPERTY BY J.V. BURKES AND ASSOCIATES, INC. THIS PROPERTY IS IN A SPECIAL FLOOD HAZARD AREA. F.I.R.M. COMMUNITY MAP NO 220205 0420 E, REVISED 4/21/09.

FLOOD ZONE:	A
BASE FLOOD ELEVATION:	10.0 NSVD
BUILDING REFERENCE ELEVATION:	1124 DATUM
TOTAL ENCLOSED SPACE:	4248 SF

EXISTING INDUSTRIALIZED BUILDING FOR NEW CHURCH

### ALLOWABLE BLDG AREA INCREASE BLDG A

BLDG FULLY SPRINKLED, BLD'G CONSTRUCTION 2B  
ASSEMBLY GROUP A-3, SM = 28,500 s.f.; NS = 9,500 s.f.  
W = 30 (SHALL NOT EXCEED 30, IBC SEC, 506.3.2)  
IF = (F/P - 0.25) X W/30 (IBC SEC, 506.3.3)  
F = 249.66ft; P = 549.58ft;  
IF = ((249.66/549.58) - 0.25) X (30/30)  
IF = 0.20  
Aa = [At + (NS x IF)] x Sa  
Aa = [28,500 + (9,500 X 0.2)] X 2  
Aa = 60,800 s.f. / 2 STORIES = 30,400 s.f. Each Floor

### ALLOWABLE BLDG AREA INCREASE BLDG B

BLDG FULLY SPRINKLED, BLD'G CONSTRUCTION 5B  
ASSEMBLY GROUP A-3, SM = 18,000 s.f.; NS = 6,000 s.f.  
W = 30 (SHALL NOT EXCEED 30, IBC SEC, 506.3.2)  
IF = (F/P - 0.25) X W/30  
F = 95.33 ft; P = 292.0 ft  
IF = ((95.33/292.0) - 0.25) X (30/30)  
IF = 0.076  
Aa = [At + (At x IF) + (At x Is)] x Sa  
Aa = [18,000 + (6,000 X 0.076)] X 2  
Aa = 36,912 s.f. / 2 STORIES = 18,456 s.f. Each Floor

### ALLOWABLE BLDG AREA INCREASE BLDG C

BLDG FULLY SPRINKLED, BLD'G CONSTRUCTION 2B  
ASSEMBLY GROUP A-3, SM = 28,500 s.f.; NS = 9,500 s.f.  
W = 30 (SHALL NOT EXCEED 30, IBC SEC, 506.3.2)  
IF = (F/P - 0.25) X W/30 (IBC SEC, 506.3.3)  
F = 494.66 ft; P = 599.75 ft;  
IF = ((494.66/599.75) - 0.25) X (30/30)  
IF = 0.575  
Aa = [At + (NS x IF)] x Sa  
Aa = [28,500 + (9,500 X 0.575)] X 2  
Aa = 67,925 s.f. / 2 STORIES = 33,962 s.f. Each Floor

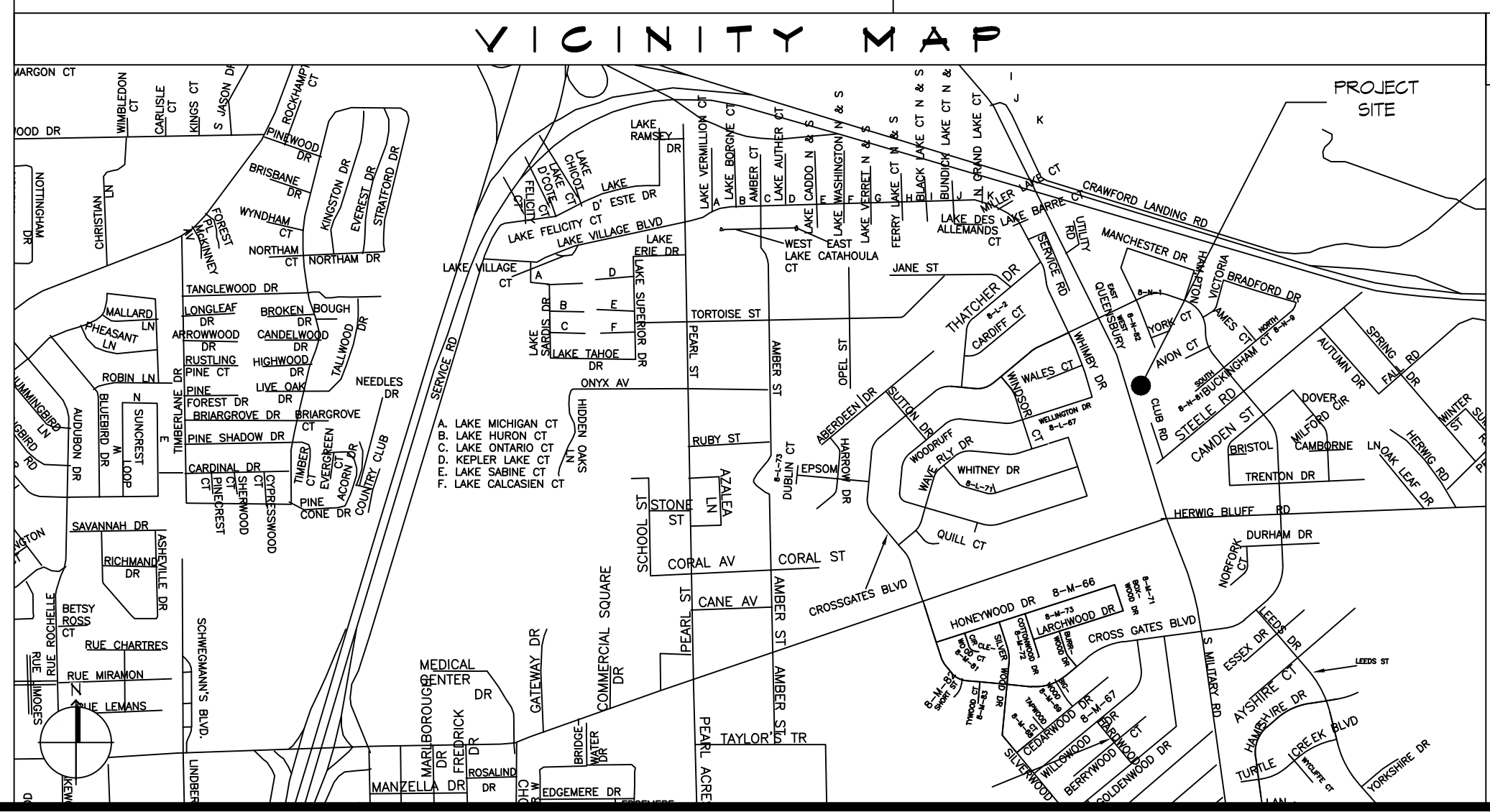

### SHEET INDEX

SHEET #	SHEET TITLE
G001	GENERAL PROJECT, LIFE-SAFETY, AND BUILDING CODE INFORMATION
G002	ACCESSIBILITY INFORMATION
C101	SITE PLAN
C102	UTILITY SITE PLAN
S101	FOUNDATION PLAN
S102	TYPICAL CONNECTIONS, DETAILS, SCHEDULES, & NOTES
A101	FLOOR PLAN
A102	ADA ACCESSIBLE RAMP PLAN AND DETAILS
A103	PORCHES, STAIRS PLANS AND DETAILS
A104	REFLECTED CEILING PLAN
P101	PLUMBING PLAN, RISER, & DETAILS
M101	MECHANICAL PLAN, SCHEDULES, & DETAILS
E101	POWER PLAN
E102	LIGHTING PLAN
E103	CIRCUIT PANELS AND ONE-LINE DIAGRAM

### GENERAL NOTES

- ALL MATERIALS AND WORK, INCIDENTAL TO THE CONSTRUCTION OF THIS PROJECT SHALL CONFORM TO ALL GOVERNING CODES, AND REGULATIONS OF AGENCIES IN AUTHORITY.
- CONTRACTOR SHALL PROVIDE ALL PUBLIC PROTECTIONS NECESSARY AS REQUIRED BY LAW.
- THE DRAWINGS, SPECIFICATIONS AND ANY SUBSEQUENTLY ISSUED APPENDA, AMENDMENTS OR SUCH CHANGE ORDERS APPROVED BY THE OWNER AND THE CONTRACTOR ARE PART OF THESE CONTRACT DOCUMENTS.
- DO NOT SCALE DRAWINGS. CONSULT WITH THE ARCHITECT REGARDING ANY ITEMS IN THE CONTRACT DOCUMENTS THAT REQUIRE CLARIFICATION.
- TRASH SHALL BE REMOVED FROM THE SITE NOT LESS THAN TWICE MONTHLY.
- THE GENERAL CONTRACTOR SHALL VERIFY EXISTING CONDITIONS PRIOR TO COMMENCING WORK AND REPORT ANY AND ALL DISCREPANCIES TO THE ARCHITECT.
- CONTRACTOR VEHICLES AND EQUIPMENT NECESSARY FOR CONSTRUCTION MAY BE PARKED ON THE SITE. OTHER VEHICLES PARKED ON THE SITE REQUIRE THE OWNER'S PERMISSION.
- NAMING A CERTAIN BRAND, MAKE OR MANUFACTURER IS TO DESIGNATE THE GENERAL STYLE, TYPE, CHARACTER AND QUALITY STANDARD OF THE PRODUCT DESIRED. SUBSTITUTION REQUESTS MUST BE SUBMITTED PRIOR TO BIDDING.
- ALL MATERIALS/EQUIPMENT SHALL BE INSTALLED PER MANUFACTURER'S RECOMMENDATIONS. WORK NOT CONSISTENT WITH MANUFACTURER'S RECOMMENDATIONS WILL BE REJECTED BY OWNER/ARCHITECT.

**PROJECT LOCATION:**  
NORTH MILITARY ROAD ROAD  
SLIDELL, LA 70460

**OWNER:**  
CROSS GATES ATHLETIC CLUB

**DAMMON ENGINEERING, INC.**  
LOUISIANA & MISSISSIPPI  
www.dammonengineering.com  
554 Old Spanish Trail  
Slidell, LA 70458  
PH: 985.649.5832

DATE	REVISIONS

SEAL:

**CROSS GATES ATHLETIC CLUB**

200 NORTH MILITARY ROAD  
SLIDELL, LA

JOB NO: 2527  
DATE: 10-27-17  
DRAWN BY: JMS  
CHECKED BY: JTL

**GOO1**

SHEET No: 1 of 1