

1. PROPOSED WALL SECTION
SCALE: 1/2" = 1'-0"

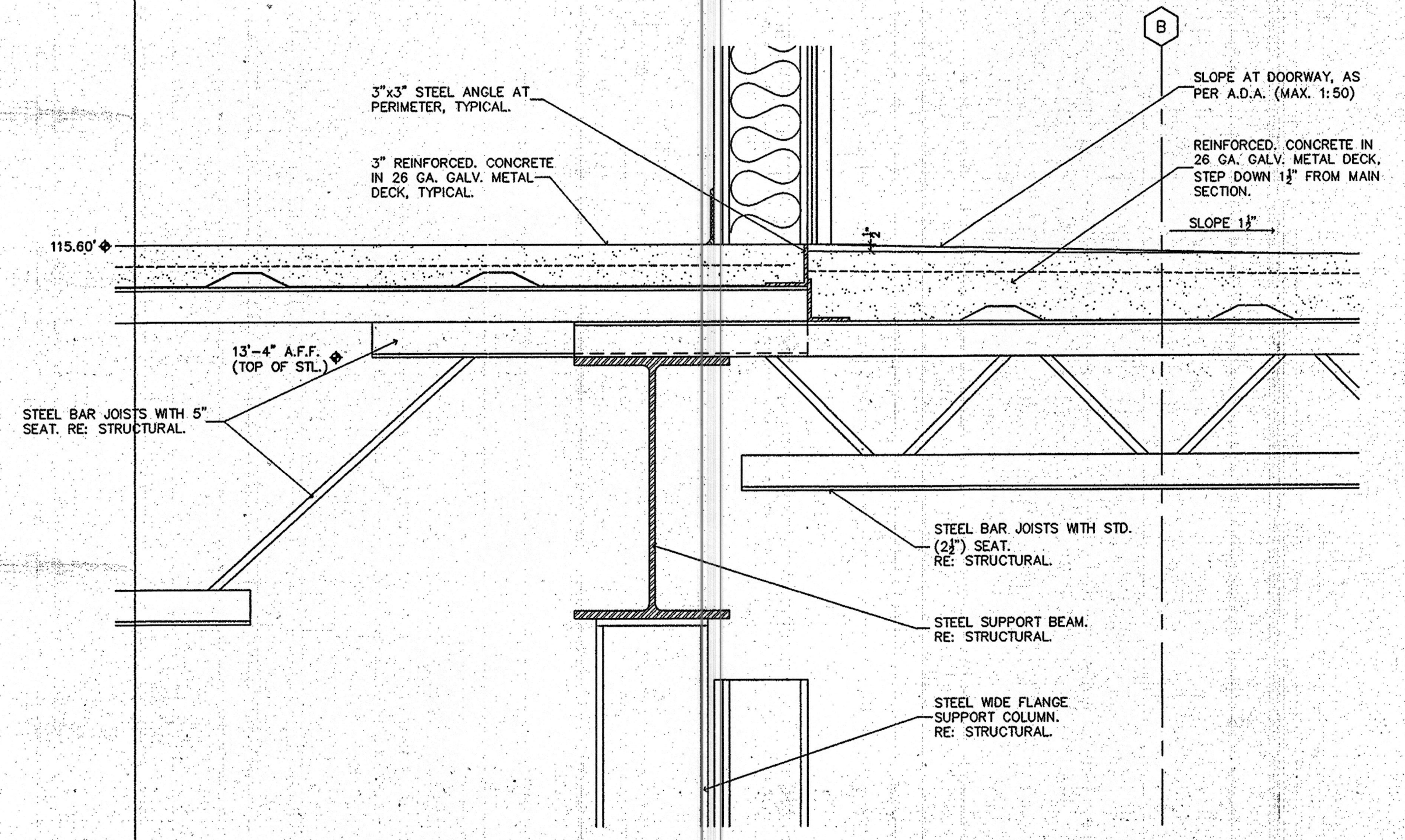

2. PROPOSED SECTION
SCALE: 1-1/2" = 1'-0"

project 1403
date 1-17-05
revisions

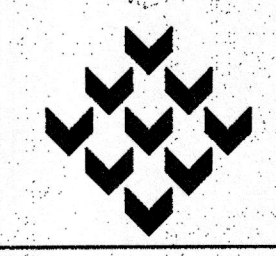

Piazza Architecture • Planning
Mandeville • Louisiana • Miramar Beach • Florida



EXPANSION and RENOVATION TO:
CROSSGATES ATHLETIC CLUB
200 NORTH MILITARY ROAD
SLIDELL - LOUISIANA

sheet
A12.3
of 68