

C-STORE

LA HIGHWAY 433 (OLD SPANISH TRAIL) SLIDELL, LA

(CIVIL PERMIT SET 12-20-2024)

C-STORE
 LA HIGHWAY 433 (OLD SPANISH TRAIL)
 SLIDELL, LOUISIANA

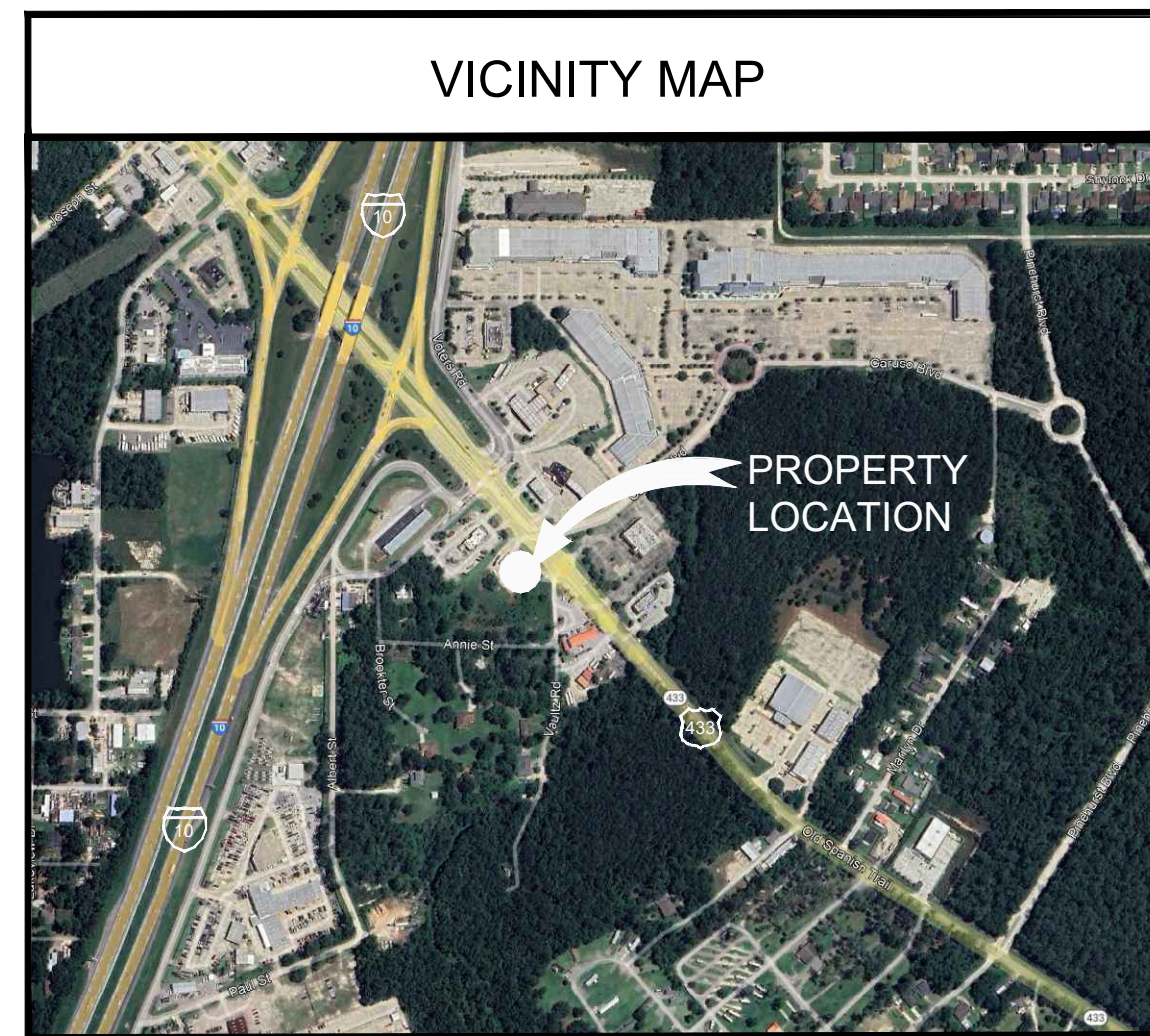

INDEX TO DRAWINGS	
SHEET NO.	SHEET TITLE
C000	COVER SHEET
C001	EXISTING CONDITIONS
C100	DEMOLITION PLAN
C110	EROSION, SEDIMENT AND POLLUTION CONTROL PLAN
C150	EROSION, SEDIMENT AND POLLUTION CONTROL DETAILS
C200	CIVIL SITE PLAN
C250	SITE DETAILS
C251	SITE DETAILS
C300	GRADING PLAN
C310	DRAINAGE PLAN
C350	DRAINAGE DETAILS
C400	UTILITY PLAN
C450	UTILITY DETAILS

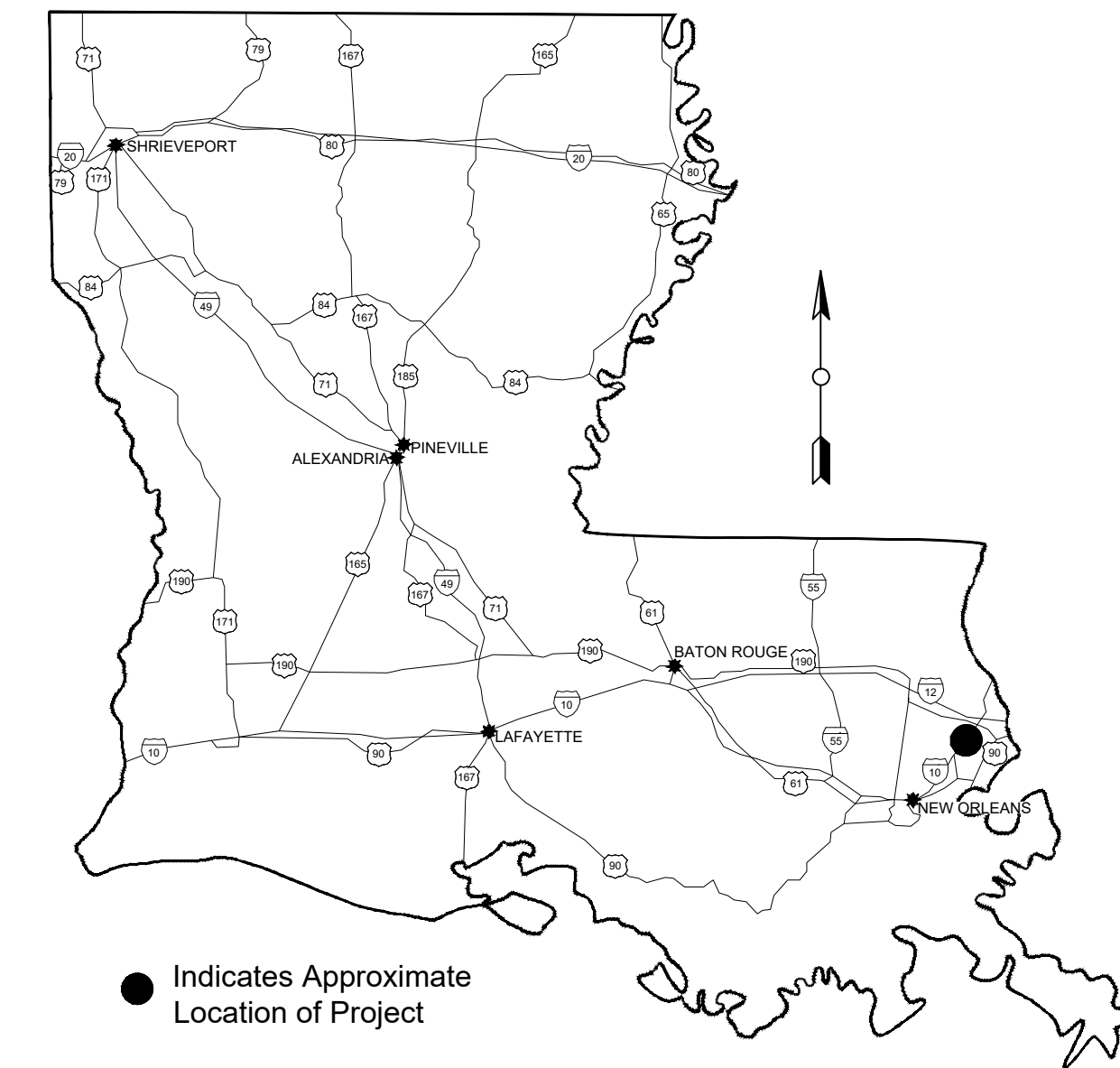

LOCATION MAP

SHEET REVISIONS:

#	DATE/REFERENCE

STAMP:
 NOT FOR CONSTRUCTION

CIVIL ENGINEERING SERVICES

OWNER'S REPRESENTATIVE AND DESIGN SERVICES

SHEET TITLE:
 COVER

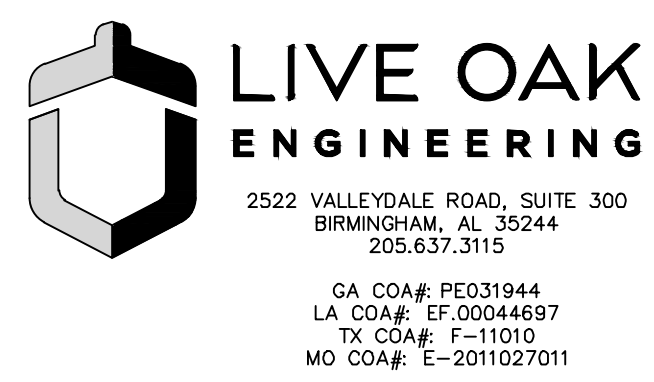

OWNER/DEVELOPER

Developer's Name: RIVEROAKS INVESTMENT GROUP, LLC.
 Developer's Address: 102 COLONY WAY
 City: BRANDON State: MISSISSIPPI, 39047
 Phone #: (601) 720-9956 Email: DAVETHIND@MSN.COM

DATE: 12/20/24
 SHEET NUMBER:
C000

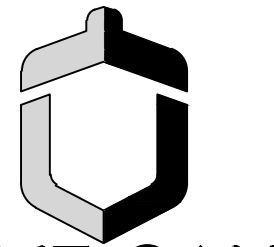

LIVE OAK ENGINEERING

955B HOWARD AVENUE
BILOXI, MS 39530
LIVEOAKENGINEERING.COM

LOE JOB #269-1

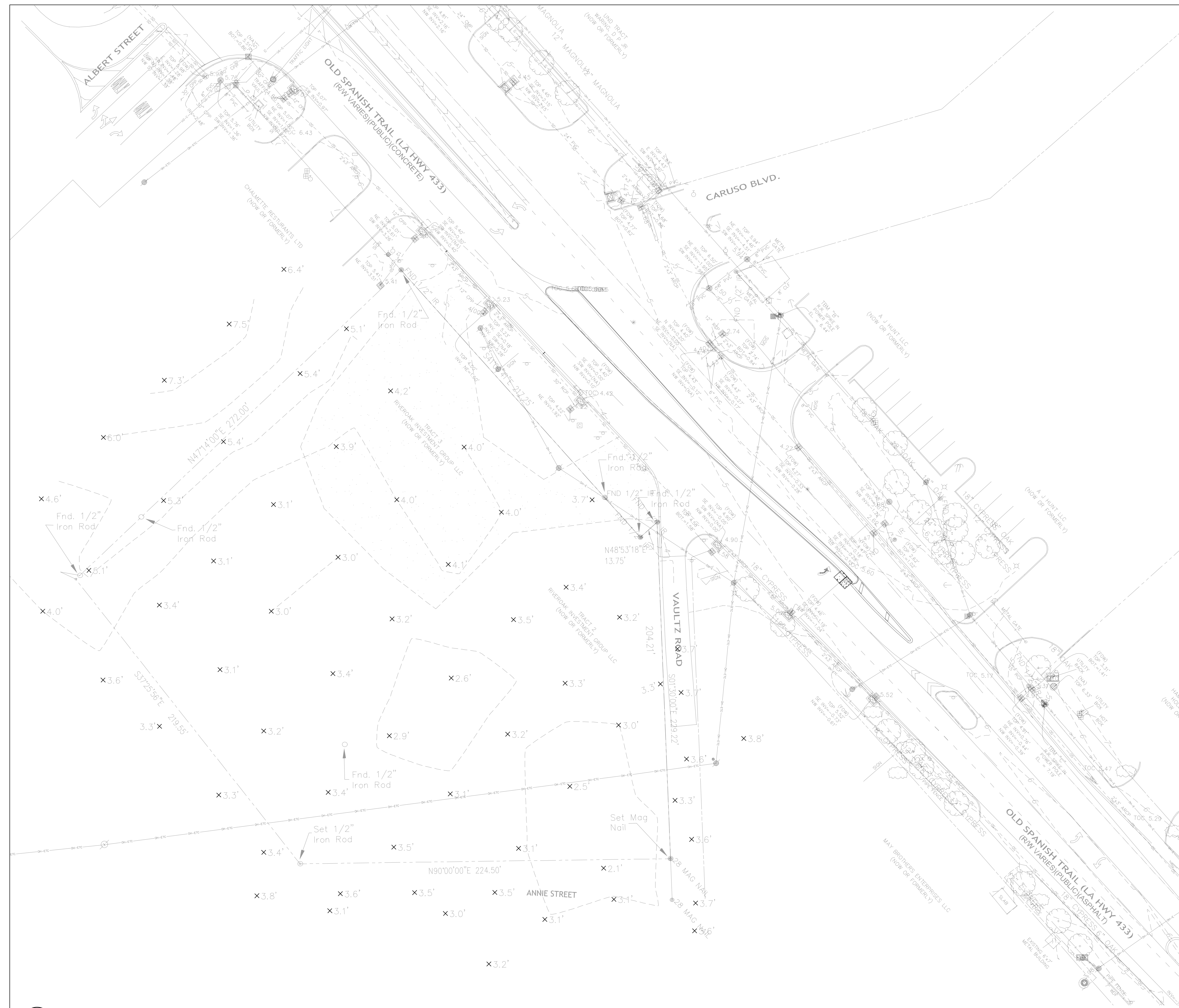
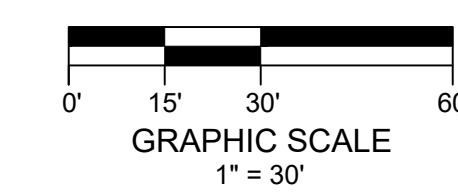

SURVEY LEGEND

LEGEND	
	S SEWER MANHOLE , SEWER LINE
	W WATER MANHOLE , WATER LINE
	G GAS MANHOLE , GAS LINE
	T TELE. MANHOLE , TELE. LINE
	D DRAIN MANHOLE , DRAIN LINE
	D DRAIN INLET , DRAIN LINE
	E T TV POWER POLE / OVERHEAD LINES ELECTRIC, TELEPHONE, CABLE TV
	E T TV ELEC. TOWER / OVERHEAD LINES
	CATCH BASIN
	LIGHT STANDARD
	TRAFFIC LIGHT
	TELE. , ELEC. , CATV PEDESTAL
	GAS , WATER , ELECTRIC METER
	GAS , WATER VALVE
	SEWER , DRAIN CLEANOUT
	FIRE HYDRANT
	GUY WIRE ANCHOR
	SIGN
	PYLON
	MAILBOX
	TREE
	SHRUB
	FENCE

UNDERGROUND UTILITY NOTES

1. CONTRACTOR SHALL VERIFY LOCATIONS OF ALL PROJECT RELATED UTILITIES, BURIED AND ABOVE GROUND, REGARDLESS OF INCLUSION ON THESE PLANS. THE LOCATIONS OF ANY EXISTING UTILITIES SHOWN ARE APPROXIMATE ONLY.
2. THE CONTRACTOR SHALL BE RESPONSIBLE FOR DETERMINING THE EXACT LOCATION OF ALL EXISTING UTILITIES BEFORE COMMENCING WORK.
3. ALL CONTRACTOR DAMAGED UTILITIES SHALL BE REPAIRED AT THE CONTRACTOR'S EXPENSE.

C-STORE
LA HIGHWAY 433 (OLD SPANISH TRAIL)
SLIDELL, LOUISIANA

SHEET REVISIONS:	
#	DATE/REFERENCE

STAMP:
NOT FOR CONSTRUCTION

SHEET TITLE:
EXISTING CONDITIONS

DATE: 12/20/24
SHEET NUMBER:

C001

1
C001 **EXISTING CONDITIONS**
SCALE: 1" = 30'

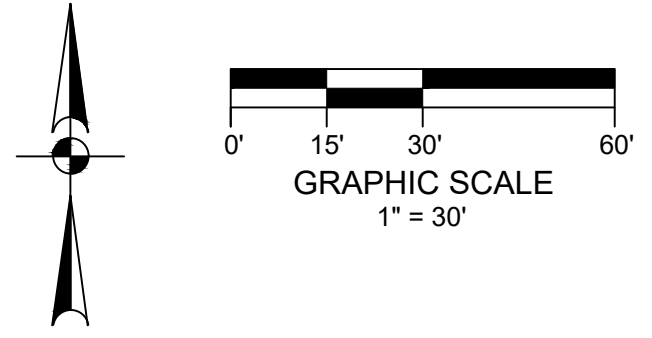
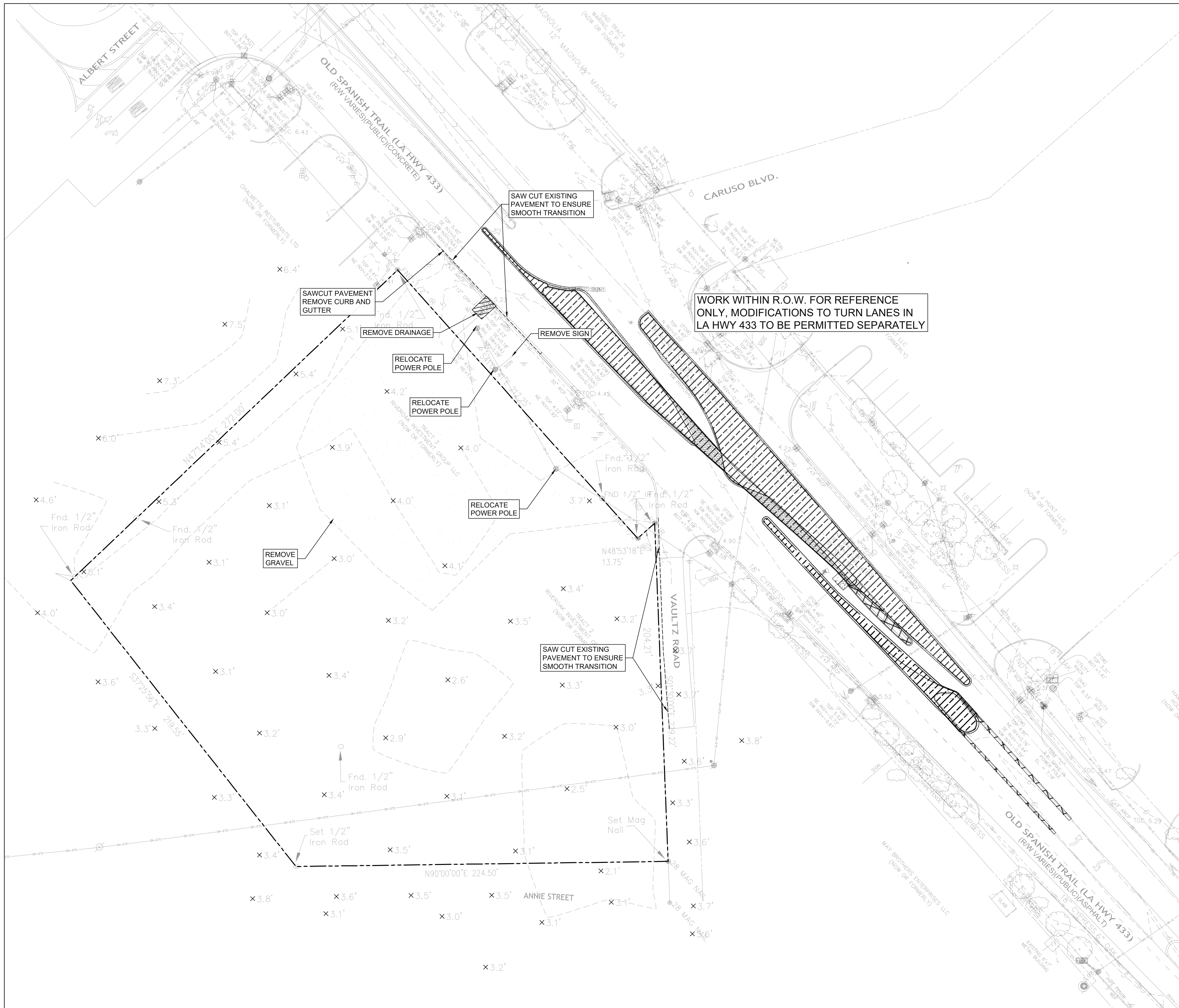

- DEMOLITION NOTES**
1. INFORMATION GIVEN WAS TAKEN FROM TOPOGRAPHICAL SURVEY SUPPLIED BY J.V. BURKES & ASSOCIATES, INC. CONTRACTOR IS TO FIELD VERIFY ALL DIMENSIONS AND CONDITIONS AND REPORT ANY DISCREPANCIES, CONFLICTS, OR OTHER UNSATISFACTORY CONDITIONS TO THE ARCHITECT/ENGINEER PRIOR TO CONSTRUCTION.
 2. THE CONTRACTOR SHALL CALL LOUISIANA 811 BY LAW TO LOCATE ALL EXISTING UTILITIES ON SITE PRIOR TO THE START OF HIS WORK.
 3. **EROSION CONTROL:** THE CONTRACTOR SHALL MAINTAIN EROSION AND SEDIMENT CONTROLS DURING THE ENTIRE COURSE OF WORK AS DETAILED ON EROSION CONTROL PLAN AND IN ACCORDANCE WITH THE SPECIFICATIONS.
 4. **SITE UTILITIES:** CONTRACTOR IS TO FIELD VERIFY ALL SUBSURFACE UTILITIES PRIOR TO STARTING ANY CONSTRUCTION AND CONTACTING THE ASSOCIATED UTILITY COMPANY AND COORDINATING ANY REQUIRED DISCONNECTS AND/OR CONNECTION TO EXISTING UTILITIES.

C-STORE
LA HIGHWAY 433 (OLD SPANISH TRAIL)
SLIDELL, LOUISIANA

SHEET REVISIONS:

#	DATE/REFERENCE

STAMP:

NOT FOR CONSTRUCTION

SHEET TITLE:

DEMOLITION PLAN

DATE: 12/20/24
 SHEET NUMBER:

C100

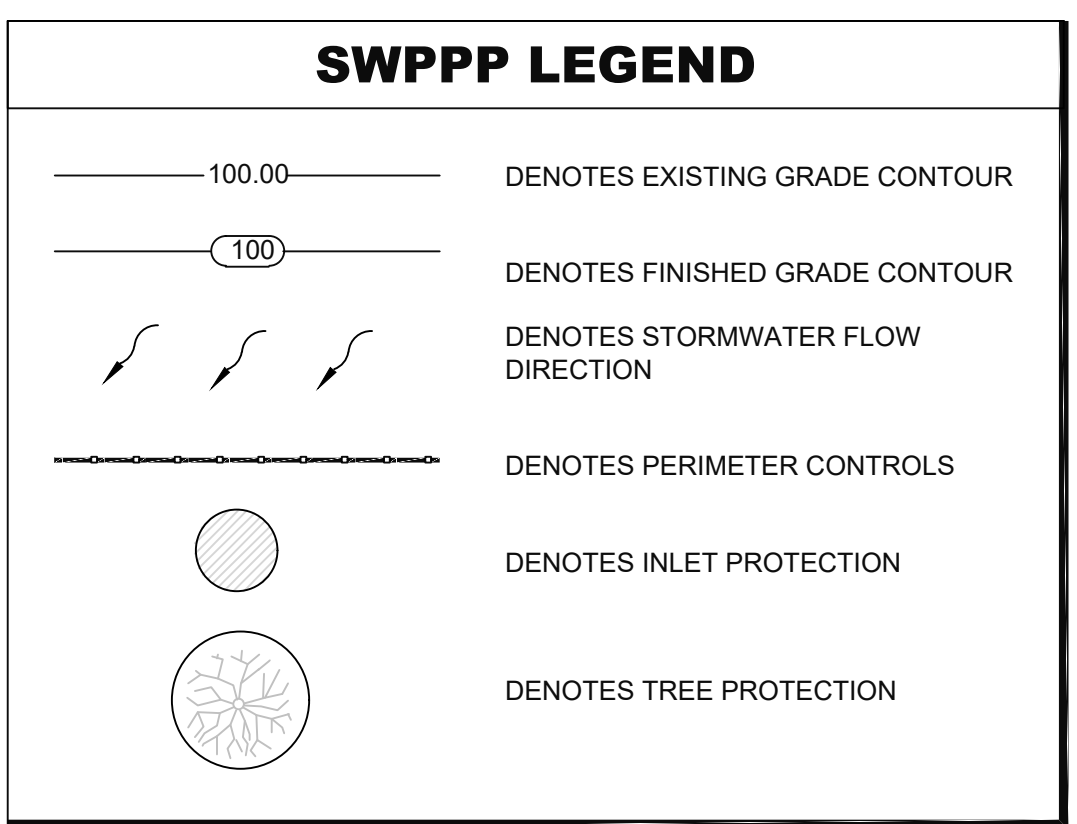
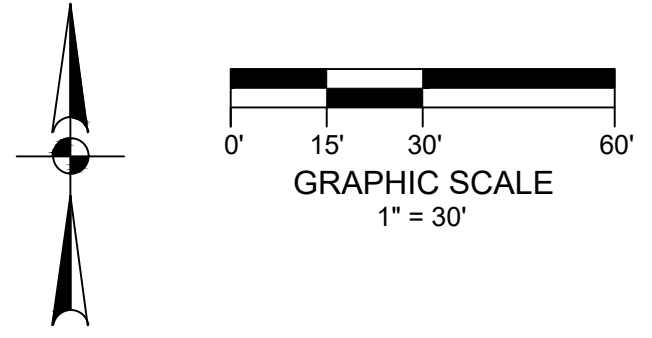

- ### SWPPP NOTES
- THIS PROJECT HAS COVERAGE UNDER THE STATE OF LOUISIANA DEPARTMENT OF ENVIRONMENTAL QUALITY (LDEQ) STORM WATER DISCHARGES FROM SMALL CONSTRUCTION ACTIVITIES (EQUAL TO OR GREATER THAN 1 ACRE BUT LESS THAN 5 ACRES)
 - THE CONTRACTOR SHALL BE FAMILIAR WITH, AND KNOWLEDGEABLE OF, ALL REQUIREMENTS, REGULATIONS, AND SPECIFICATIONS OF THE LDEQ STORM WATER DISCHARGES FROM SMALL CONSTRUCTION ACTIVITIES.
 - THE CONTRACTOR WILL BE REQUIRED TO COMPLETE A SMALL CONSTRUCTION NOTICE OF INTENT (SCNOI) FORM AND MAINTAIN A COPY OF THE SWPPP AND OTHER DOCUMENTS REQUIRED BY THE PERMIT ON THE SITE AND SHALL MAKE THESE DOCUMENTS READILY AVAILABLE UPON REQUEST. DOCUMENTS PERTAINING TO THE SMALL CONSTRUCTION GENERAL PERMIT CAN BE FOUND AT WWW.DEQ.LOUISIANA.GOV.
 - THE CONTRACTOR SHALL MAINTAIN EROSION AND SEDIMENT CONTROLS DURING THE ENTIRE COURSE OF WORK TO PREVENT ANY SEDIMENT FROM LEAVING THE CONSTRUCTION SITE AND ENTERING ROADWAYS, STORM DRAINS SYSTEMS, DITCHES, SWALES, DETENTION BASINS, LOCAL WATER BODIES, AND/OR ADJACENT PROPERTIES.
 - EROSION AND SEDIMENT CONTROL MEASURES SHALL BE INSTALLED PRIOR TO EXPOSING ANY SOIL.
 - CONTRACTOR SHALL STAGE, TIME AND SEQUENCE CONSTRUCTION TO MINIMIZE THE SIZE OF EXPOSED SOIL AREAS AND THE TIME BETWEEN EXPOSING THE SOIL AREA AND FINISHING THE SOIL AREA.
 - PERIMETER CONTROLS SHALL BE CONSTRUCTED OF SILT FENCE AND/OR APPROVED BMP'S AT LOCATIONS SHOWN ON THE PLANS OR AS DIRECTED BY THE ENGINEER.
 - ALL INLETS WITHIN THE CONTRACTOR'S LIMITS OF WORK SHALL BE PROTECTED WITH APPROVED EROSION AND SEDIMENT CONTROL MEASURES.
 - CONTRACTOR SHALL PROVIDE VEGETATION FOR AREAS WHERE SOILS HAVE BEEN EXPOSED AND WHERE CONSTRUCTION WILL CEASE FOR MORE THAN 14 DAYS. SEE LANDSCAPE FOR ADDITIONAL INFORMATION.
 - THE CONTRACTOR IS RESPONSIBLE FOR THE REMOVAL OF ANY SEDIMENT THAT MIGRATES INTO THE STORM DRAIN SYSTEM. ANY SEDIMENT THAT HAS MIGRATED OFF OF THE PROJECT SITE SHALL BE REMOVED IMMEDIATELY UPON DISCOVERY.
 - TEMPORARY EROSION AND SEDIMENT CONTROLS SHALL REMAIN FUNCTIONAL UNTIL PERMANENT EROSION AND SEDIMENT CONTROLS (SUCH AS PERMANENT GRASSING, PAVEMENT, ETC.) HAVE BEEN ESTABLISHED.
 - ALL SEDIMENT AND EROSION CONTROL STRUCTURES SHALL BE INSPECTED EVERY 7 DAYS AND AFTER ALL RAINFALLS IN EXCESS OF 0.5". AN INSPECTION REPORT SHALL BE MADE ON EACH OCCASION, NOTING CONDITION OF ALL STRUCTURES AND OUTLINING ANY REQUIRED MAINTENANCE. ALL STRUCTURES SHALL BE CLEANED AND REESTABLISHED WHEN SEDIMENT REACHES 50% OF STORAGE CAPACITY.
 - ALL EROSION CONTROL DEVICES SHALL BE PROPERLY MAINTAINED DURING ALL PHASES OF CONSTRUCTION ACTIVITIES AND ALL DISTURBED AREAS HAVE BEEN STABILIZED. ADDITIONAL CONTROL DEVICES MAY BE REQUIRED DURING CONSTRUCTION IN ORDER TO CONTROL EROSION AND/OR OFFSITE SEDIMENTATION. ALL TEMPORARY CONTROL DEVICES SHALL BE REMOVED ONCE CONSTRUCTION IS COMPLETE AND THE SITE IS STABILIZED. ANY ADDITIONAL TEMPORARY CONTROL DEVICES THAT MAY BE REQUIRED SHALL BE PROVIDED AS PART OF THIS PROJECT AT NO ADDITIONAL COST TO THE OWNER.
 - CONTRACTOR SHALL COMPLY WITH THE GOOD HOUSEKEEPING BMP'S ESTABLISHED IN THE SWPPP. CONTRACTOR SHALL SUBMIT A GOOD HOUSEKEEPING PLAN TO ESTABLISH PROCEDURES FOR MATERIAL HANDLING, WASTE MANAGEMENT, MATERIAL STORAGE, CONCRETE WASHOUT, EQUIPMENT/VEHICLE FUELING AND MAINTENANCE, AND SPILL PREVENTION AND CONTROL. ALL EQUIPMENT REPAIR AND MAINTENANCE SHALL BE DONE OFFSITE.

C-STORE
LA HIGHWAY 433 (OLD SPANISH TRAIL)
SLIDELL, LOUISIANA

SHEET REVISIONS:

#	DATE/REFERENCE

STAMP:

NOT FOR CONSTRUCTION

SHEET TITLE:

EROSION AND SEDIMENT CONTROL PLAN

DATE: 12/20/24
 SHEET NUMBER:

C110

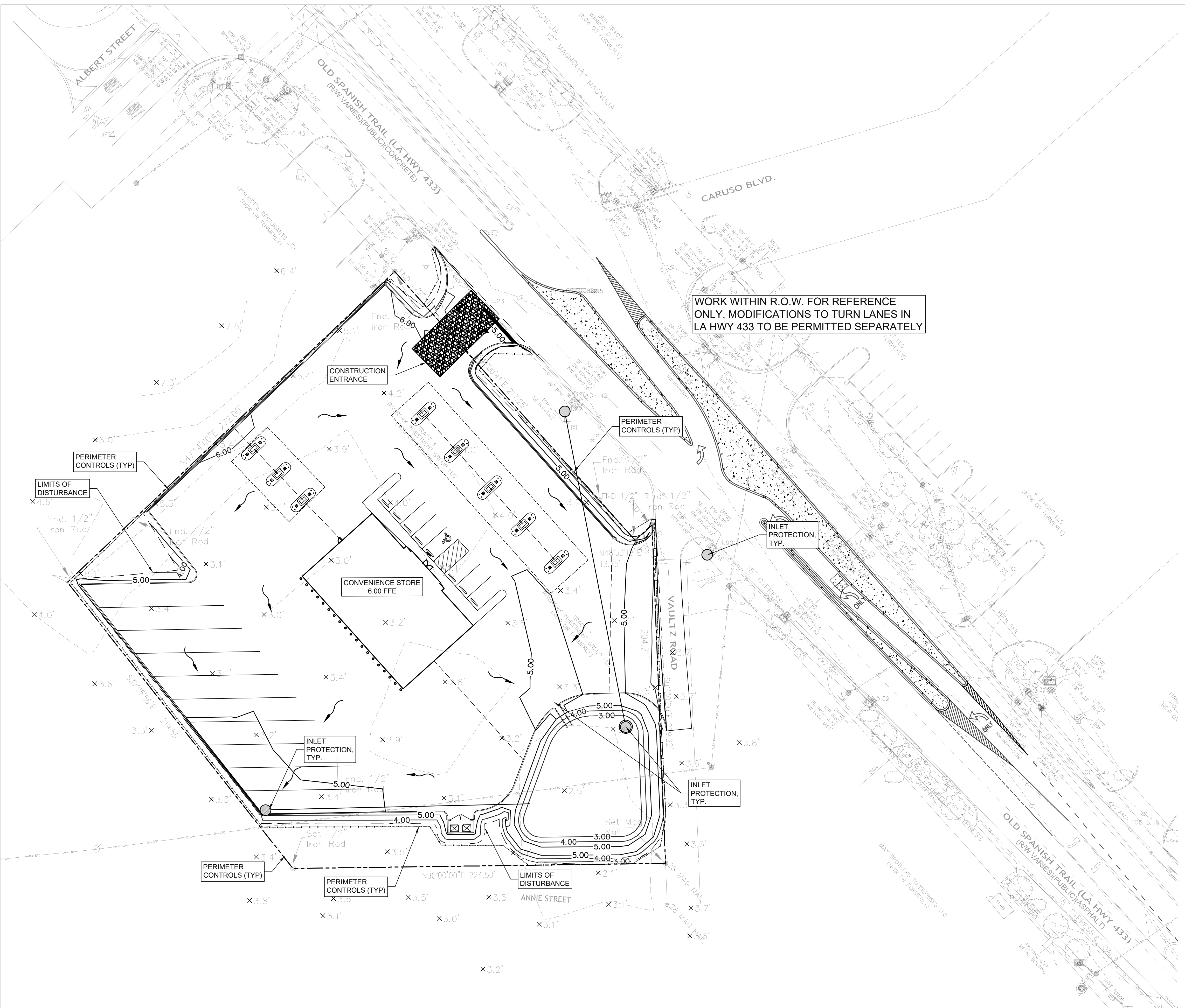

1 **EROSION AND SEDIMENT CONTROL PLAN**
 C110 SCALE: 1" = 30'

SHEET REVISIONS:

#	DATE/REFERENCE

STAMP:
 NOT FOR CONSTRUCTION

SHEET TITLE:
EROSION AND SEDIMENT CONTROL DETAILS

DATE: 12/20/24
 SHEET NUMBER:

C150

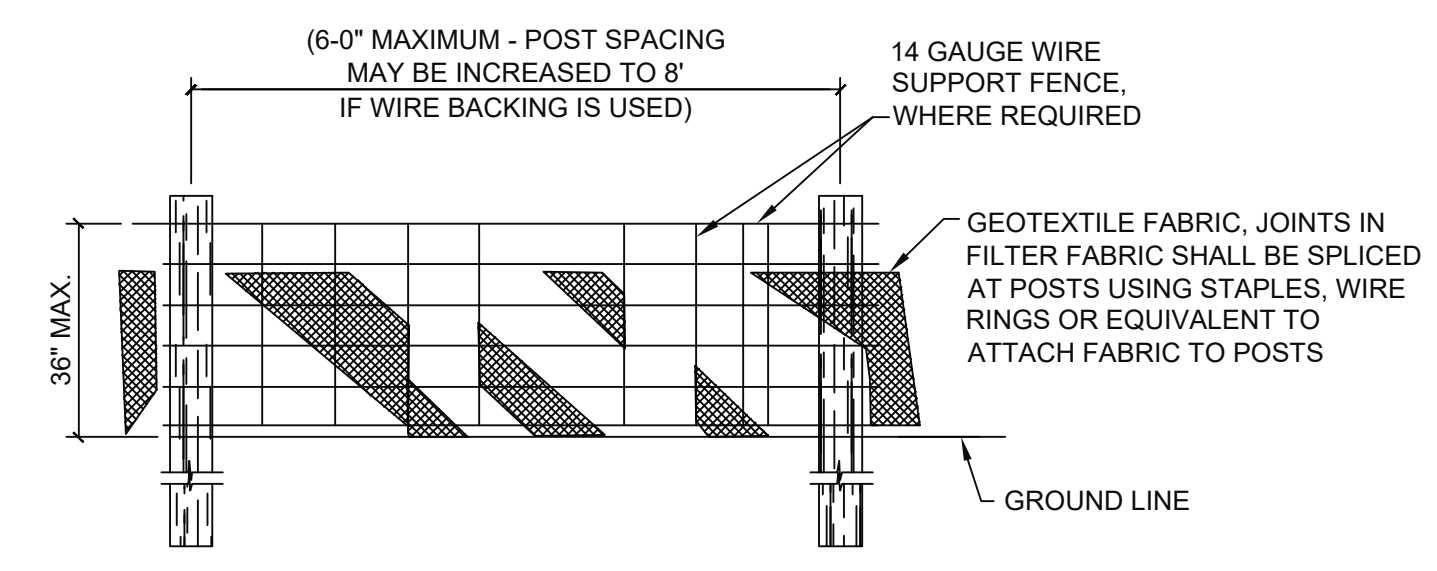

FRONT ELEVATION

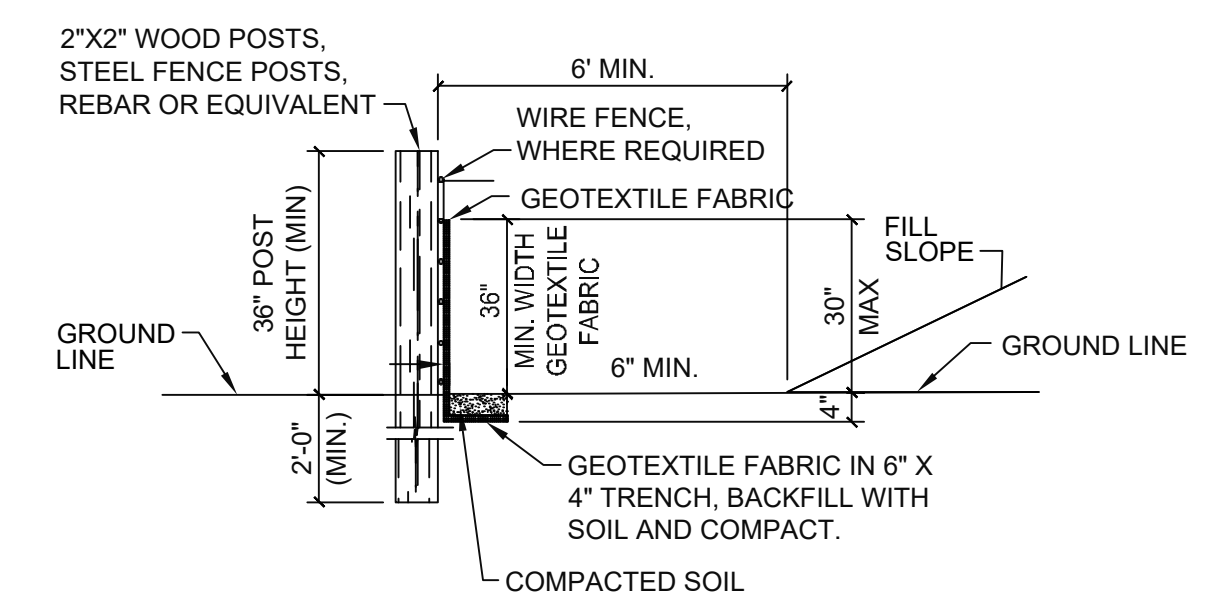

SIDE ELEVATION

1 TYPICAL PERIMETER CONTROL DETAILS
 SCALE: N.T.S.

- PERIMETER CONTROL NOTES**
1. FILTER FABRIC FENCES SHALL BE INSTALLED ALONG CONTOUR WHENEVER POSSIBLE.
 1. POSTS SHALL BE SPACED A MAXIMUM OF 6' O.C. SPACING MAY BE INCREASED TO 8' IF WIRE BACKING IS USED.
 2. POSTS SHALL BE A MINIMUM OF 5'-0" IN LENGTH. IN ADDITION POSTS SHALL BE EITHER 2" x 2" N.D. WOOD POST OR HEAVY DUTY STEEL T-POSTS WITH PROJECTIONS FOR WIRE FASTENING.
 3. WIRE SUPPORT FENCE SHALL BE A MINIMUM OF 36" IN HEIGHT. SHALL NOT EXTEND MORE THAN 36" ABOVE THE GROUND, AND SHALL EXTEND 2" INTO THE TRENCH.
 4. WIRE FENCE SHALL BE A MINIMUM OF 14 GAUGE AND SHALL HAVE A MAXIMUM MESH SPACING OF 6". WIRE SHALL BE SECURELY FASTENED TO THE UPSLOPE, PROJECT SIDE OF POSTS USING HEAVY DUTY STAPLES (AT LEAST 1" LONG), TIE WIRES OR HOG RINGS.
 5. GEOTEXTILE FABRIC SHALL BE A MINIMUM OF 36" IN HEIGHT, AND SHALL NOT EXTEND MORE THAN 36" ABOVE THE ORIGINAL GROUND SURFACE.
 6. FABRIC SHALL BE STAPLED OR WIRED TO THE FENCE AT THE TOP, MIDDLE, AND BOTTOM OF EACH POST. IN ADDITION THE FABRIC SHALL BE STAPLED OR WIRED TO THE WIRE FENCE APPROXIMATELY ONE HALF (1/2) THE DISTANCE BETWEEN THE POSTS AT THE TOP, MIDDLE AND BOTTOM OF THE WIRE FENCE.
 7. GEOTEXTILE FABRIC SHALL BE SPICED TOGETHER ONLY AT A SUPPORT POST, WITH A MINIMUM OF 3" OVERLAP. EACH FREE END OF THE FABRIC SHALL BE SECURELY TIED TO THE WIRE FENCE AT 6" O.C. VERTICALLY.
 8. SILT FENCES SHALL BE MAINTAINED FOR THE DURATION OF THE PROJECT. THE ENTIRE LENGTH OF FENCE SHALL BE CHECKED FOR ANY DAMAGES ON A DAILY BASIS AND BEFORE AND AFTER ANY RAINFALL EVENT. FOR ANY DAMAGES. ANY DAMAGES FOUND SHALL BE REMEDIATED BEFORE THE DAY'S END AT NO ADDITIONAL COST TO THE OWNER.
 9. SILT FENCES SHALL BE MAINTAINED TO PREVENT ANY MATERIAL FROM MIGRATING FROM THE UPSLOPE SIDE OF THE FENCE. ANY REQUIRED MAINTENANCE OF THE SILT FENCE SHALL BE THE RESPONSIBILITY OF THE CONTRACTOR.
 10. SEDIMENT DEPOSITS SHALL BE REMOVED AFTER EACH RAINFALL EVENT AND WHEN DEPOSITS REACH APPROXIMATELY ONE-HALF (1/2) THE HEIGHT OF THE FENCE.
 11. IN ORDER TO PREVENT SEDIMENT LADEN STORM WATER FROM BY-PASSING THE FENCE, IN AREAS WHERE SILT FENCES ARE NOT UTILIZED ON ALL SIDES OF A DISTURBED AREA, THE FENCE SHALL EXTEND BEYOND THE DISTURBED AREA IN J-HOOK SHAPE ON EACH END AS SHOWN IN THE ISOLATED SILT FENCE INSTALLATION PLAN VIEW.

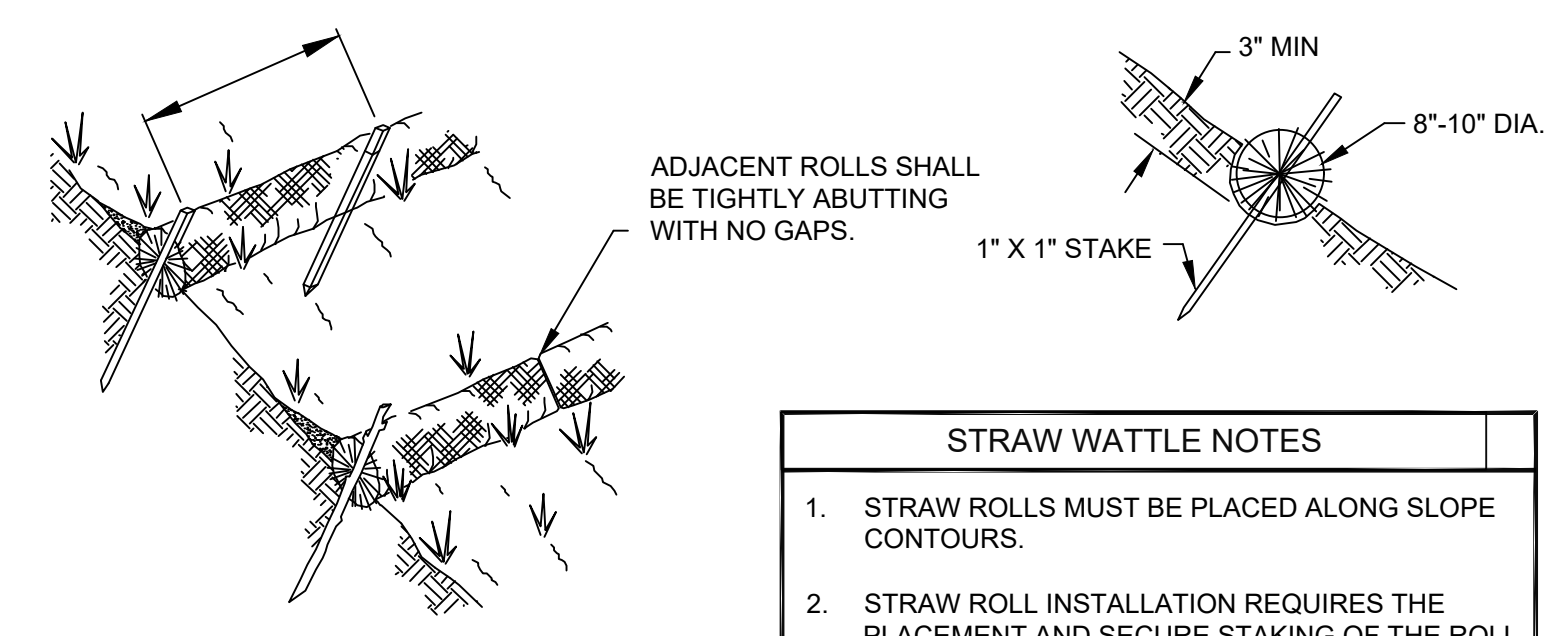

- STRAW WATTLE NOTES**
1. STRAW ROLLS MUST BE PLACED ALONG SLOPE CONTOURS.
 2. STRAW ROLL INSTALLATION REQUIRES THE PLACEMENT AND SECURE STAKING OF THE ROLL IN A 3" MINIMUM TRENCH DUG ON CONTOUR.
 3. IF STAKES CAN NOT BE USED SECURE WITH SAND BAGS SPACED 4' APART.
 4. RUNOFF MUST NOT BE ALLOWED TO RUN UNDER OR AROUND ROLL.

2 TYPICAL PERIMETER CONTROL DETAILS
 SCALE: NTS

- CONSTRUCTION ENTRANCE/EXIT NOTE**
1. CRUSHED AGGREGATE SHALL BE COMPRISED OF STONE RANGING FROM 3" MINIMUM TO 6" MAXIMUM IN SIZE.
 2. THE ENTRANCE SHALL BE PROPERLY GRADED TO PREVENT THE FLOW OF SEDIMENT ONTO PUBLIC ROADWAY. ALL MATERIALS SPILLED, DROPPED, WASHED OR TRACKED FROM VEHICLES ONTO ROADWAYS OR INTO STORM DRAINS SHALL BE REMOVED IMMEDIATELY.
 3. THE ENTRANCE SHALL BE PROPERLY MAINTAINED FOR THE DURATION OF THE PROJECT TO PREVENT THE TRACKING OF SEDIMENT ONTO PUBLIC ROADWAY. ALL MAINTENANCE AND REPAIRS SHALL BE THE RESPONSIBILITY OF THE CONTRACTOR.
 4. THE ENTRANCE SHALL BE CHECKED ON A DAILY BASIS AND BEFORE AND AFTER ANY RAINFALL EVENT FOR ANY DAMAGES. ANY DAMAGES FOUND SHALL BE REMEDIATED BEFORE THE DAYS END.
 5. MEASURES SHALL BE TAKEN TO PREVENT VEHICULAR TRAFFIC FROM BYPASSING THE CONSTRUCTION ENTRANCE DURING INGRESS AND EGRESS.

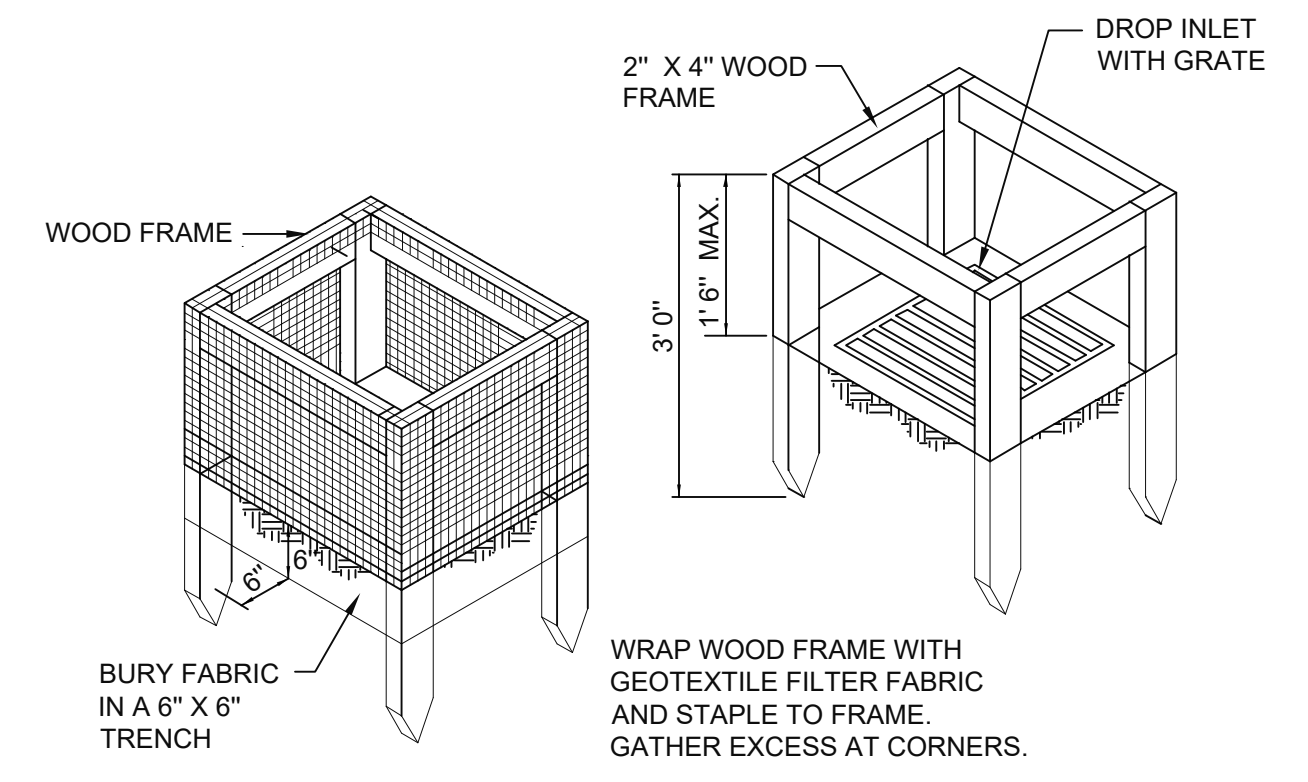

SILT FENCE OPTION

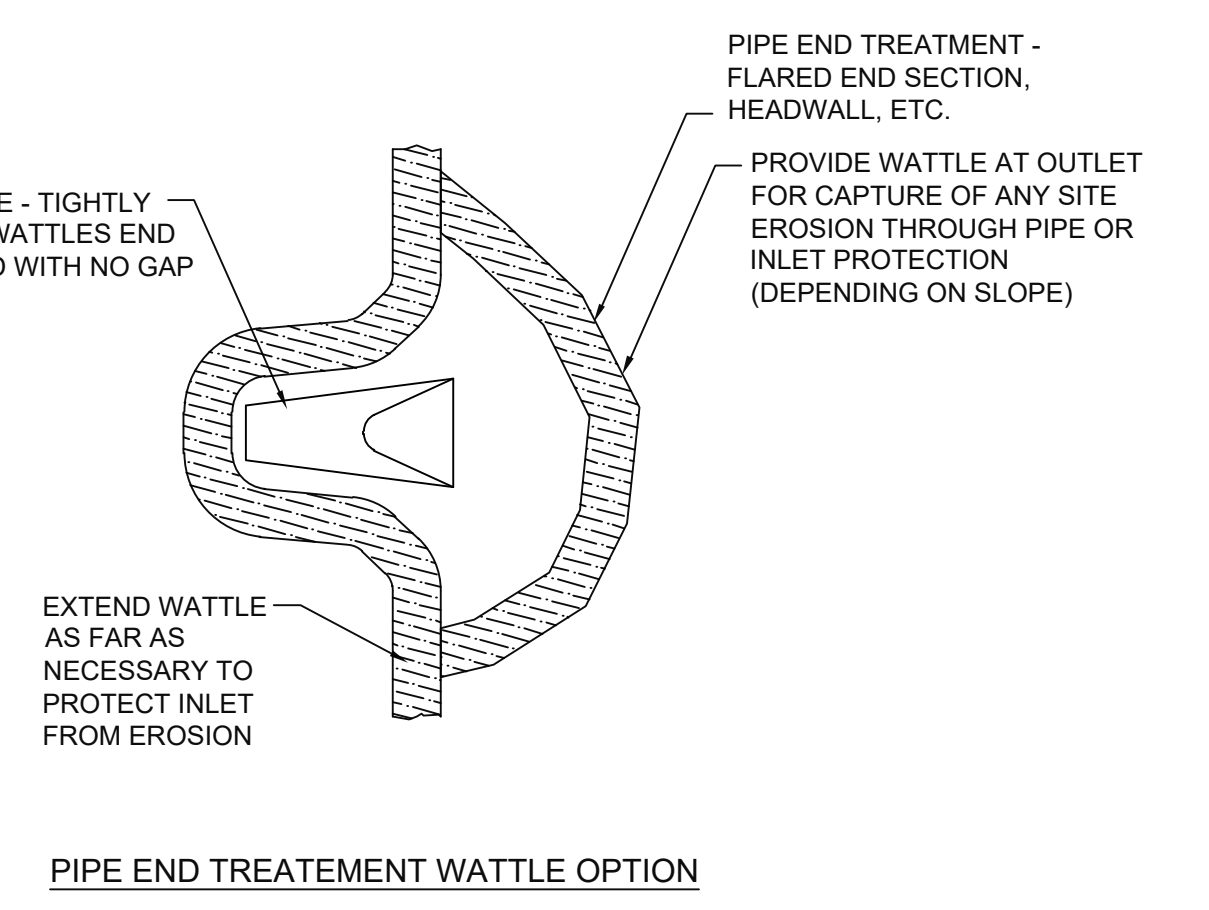
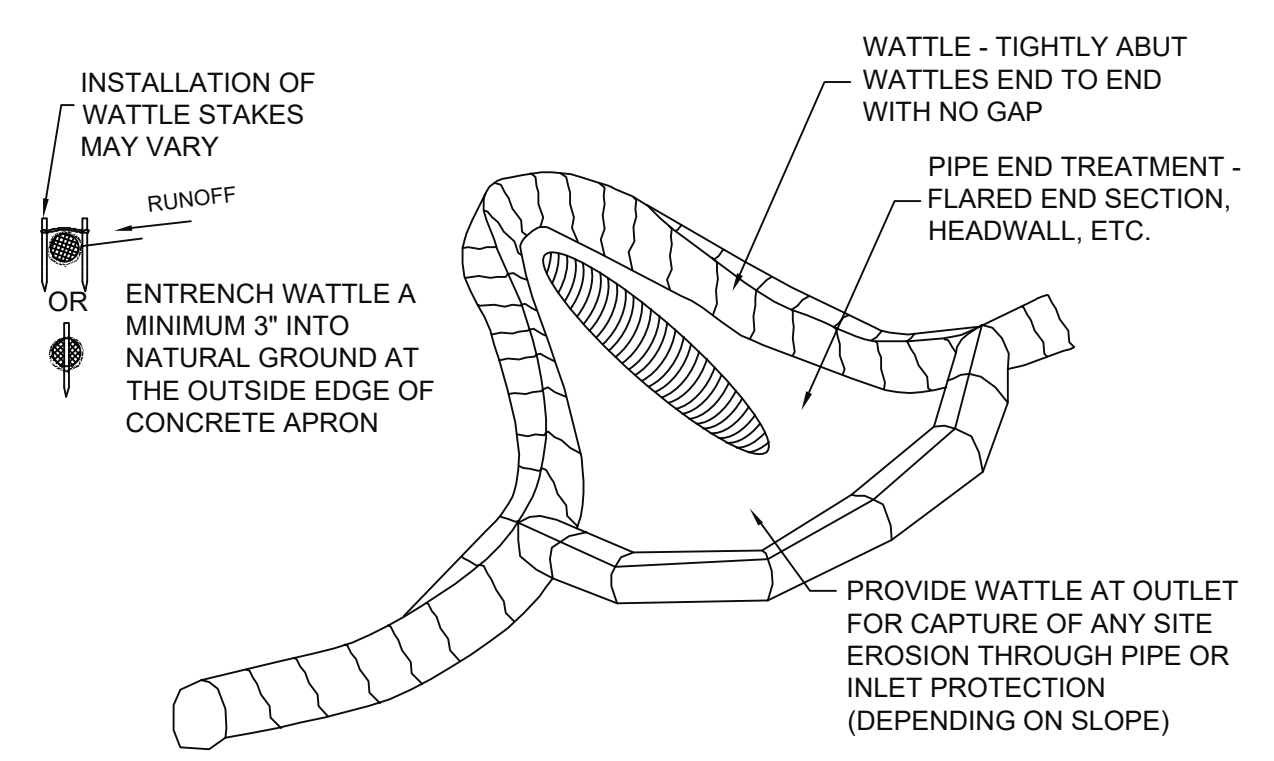

INLET STRAW ROLL WATTLE OPTION

PIPE END TREATMENT WATTLE OPTION

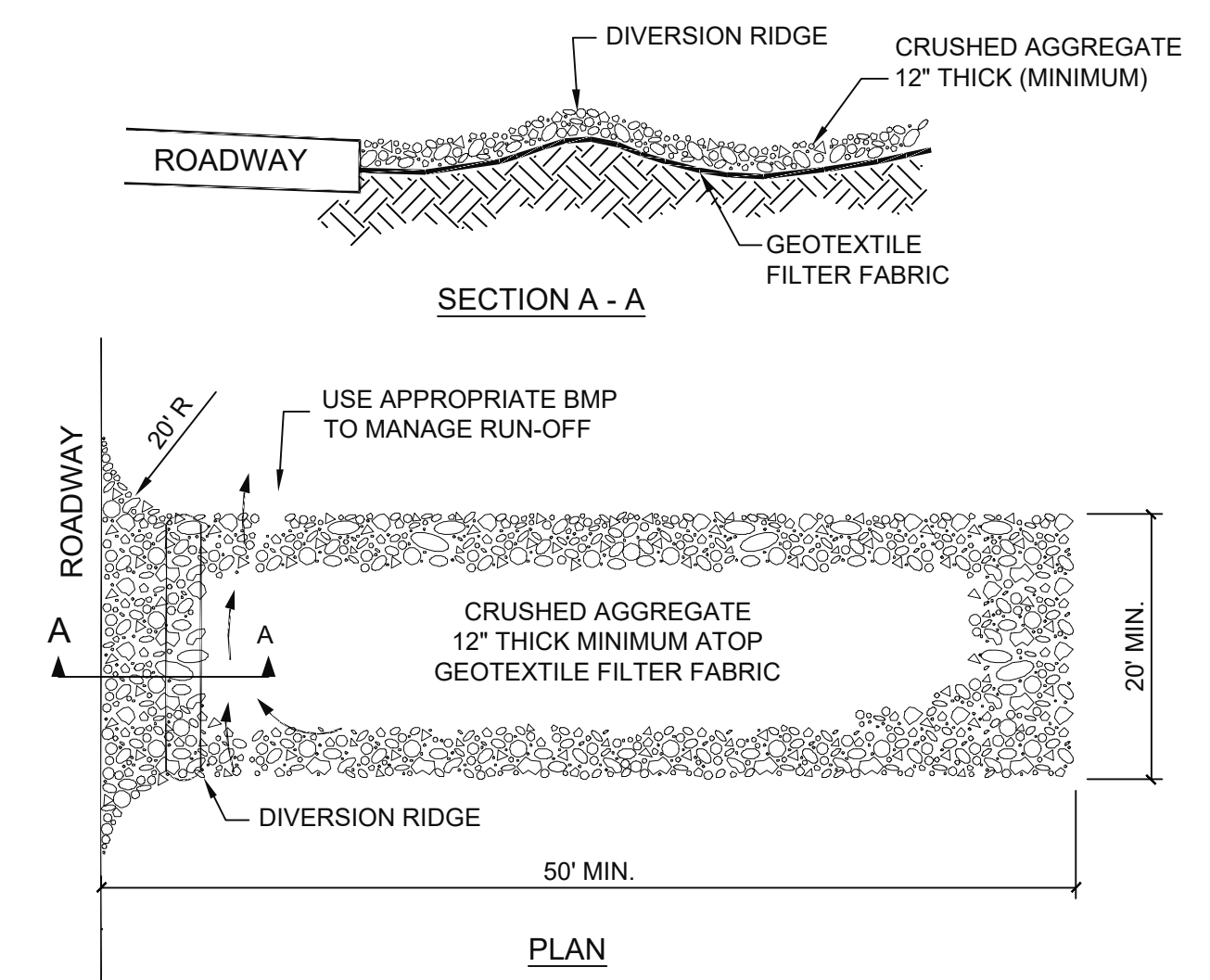

3 TYPICAL CONSTRUCTION ENTRANCE/EXIT DETAIL
 SCALE: NTS

4 TYPICAL INLET/OUTLET PROTECTION DETAIL
 SCALE: NTS

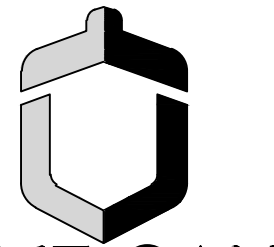

**LIVE OAK
ENGINEERING**

955B HOWARD AVENUE
BILOXI, MS 39530
LIVEOAKENGINEERING.COM

LOE JOB #269-1

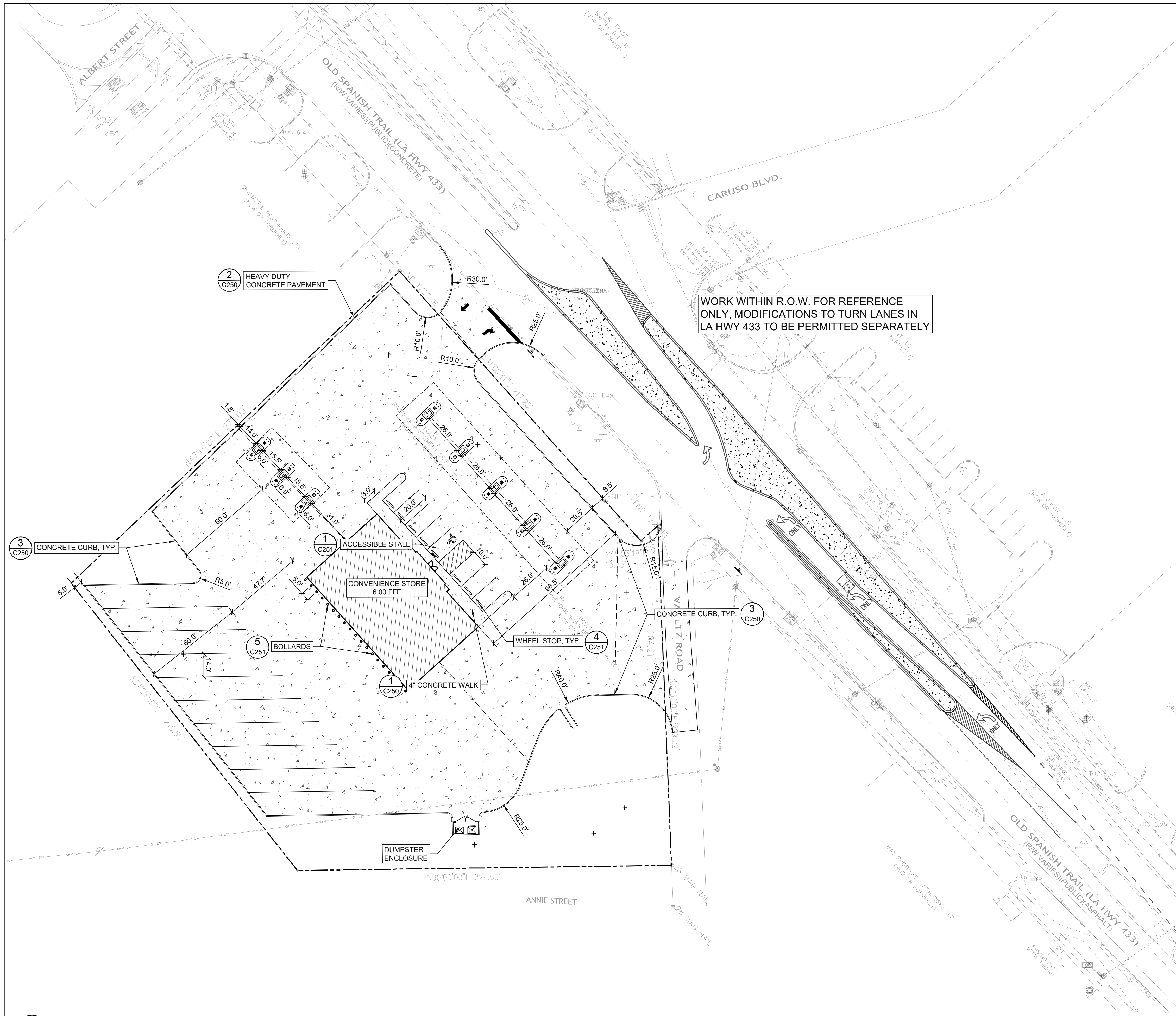
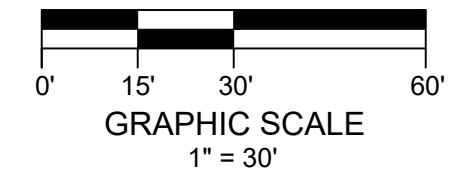

WORK WITHIN R.O.W. FOR REFERENCE ONLY. MODIFICATIONS TO TURN LANES IN LA HWY 433 TO BE PERMITTED SEPARATELY

PROJECT SITE DATA

PROJECT ADDRESS:	OLD SPANISH TRAIL (LA HWY 433)
ZONING DISTRICT:	HIGHWAY COMMERCIAL-2
PROJECT BOUNDARY AREA:	1.922 ACRES (83722.32 SF)
FEMA FLOOD ZONE DESIGNATION:	ZONE AE
PARKING:	19 SPACES (9 STANDARD 10 TRUCK)
BUILDING FOOTPRINT:	5,250 SF

C-STORE
LA HIGHWAY 433 (OLD SPANISH TRAIL)
SLIDELL, LOUISIANA

SHEET REVISIONS:

#	DATE/REFERENCE

STAMP:
**NOT FOR
CONSTRUCTION**

SHEET TITLE:
CIVIL SITE PLAN

DATE: 12/20/24
SHEET NUMBER:

C200

1
C200 **CIVIL SITE PLAN**
SCALE: 1" = 30'

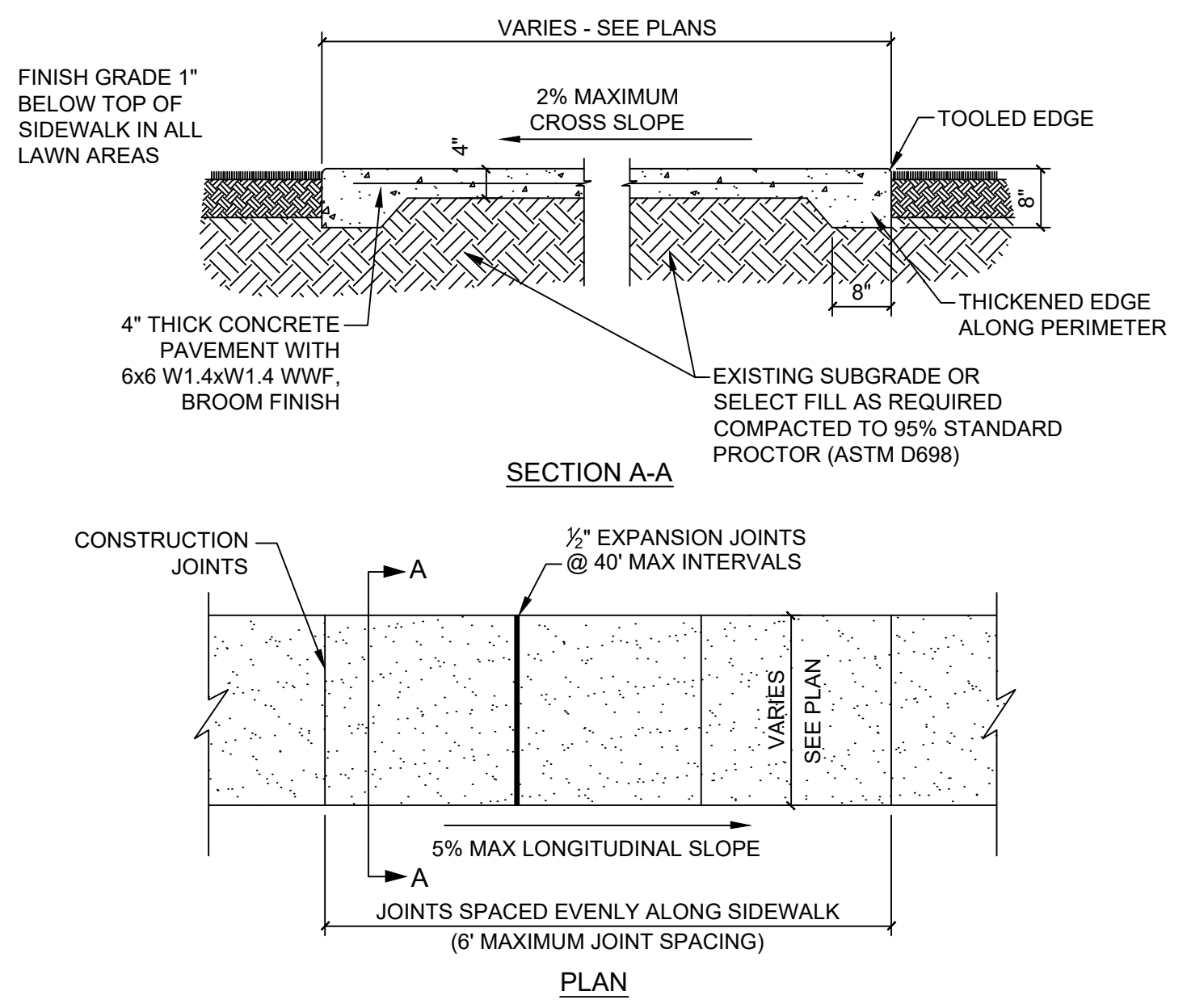

- 4" CONCRETE PAVEMENT NOTES**
- ALL JOINTS SHALL BE CONSTRUCTED IN ACCORDANCE WITH ACI 330R-08 OR SECTION 3.07 IN THE NRMCA GUIDE SPECIFICATIONS.
 - EXPANSION JOINTS SHALL BE LOCATED WHERE SIDEWALK ABUTS CONCRETE DRIVEWAYS, CURB OR OTHER ADJACENT STRUCTURES.
 - CONTRACTION JOINTS SHALL BE PLACED AT INTERVALS OF APPROXIMATELY 5 FEET OR AT A SPACING THAT MATCHES THE ADJACENT CURB.
 - JOINTS SHALL BE PROVIDED WITHIN TWELVE (12) HOURS OF FINISHING CONCRETE.
 - CONTRACTION JOINT CUTS SHALL BE 1/4 OF THE PAVEMENT THICKNESS DEEP. THE WIDTH OF THE CUT SHOULD BE APPROXIMATELY 1/8 INCH FOR UNSEALED JOINTS AND 1/4 INCH FOR SEALED JOINTS.
 - FORMED CONTRACTION JOINTS SHALL BE FINISHED WITH A TOOL HAVING A 1/4" RADIUS.
 - SCORED JOINTS SHALL BE 1/4" DEEP AND PLACED AT THE SPACING INDICATED FOR THE WIDTH OF SIDEWALK OR MATCH SCORED JOINTS OF ADJACENT CURB.
 - CONCRETE SHALL BE FINISHED BY MEANS OF A FLOAT, STEEL TROWELLED AND BROOMED WITH A FINE BRUSH IN A TRANSVERSE DIRECTION.
 - CONTRACTOR SHALL INSTALL CONSTRUCTION JOINTS AT THE END OF ONE PLACEMENT AND THE BEGINNING OF A SECOND PLACEMENT.
 - CONTRACTOR SHALL CONTINUE CONTRACTION JOINTS THROUGH CURB AND CURB AND GUTTER TO HELP ELIMINATE SYMPATHY CRACKS.

1 TYPICAL 4" CONCRETE SIDEWALK DETAILS
 C250 SCALE: NTS

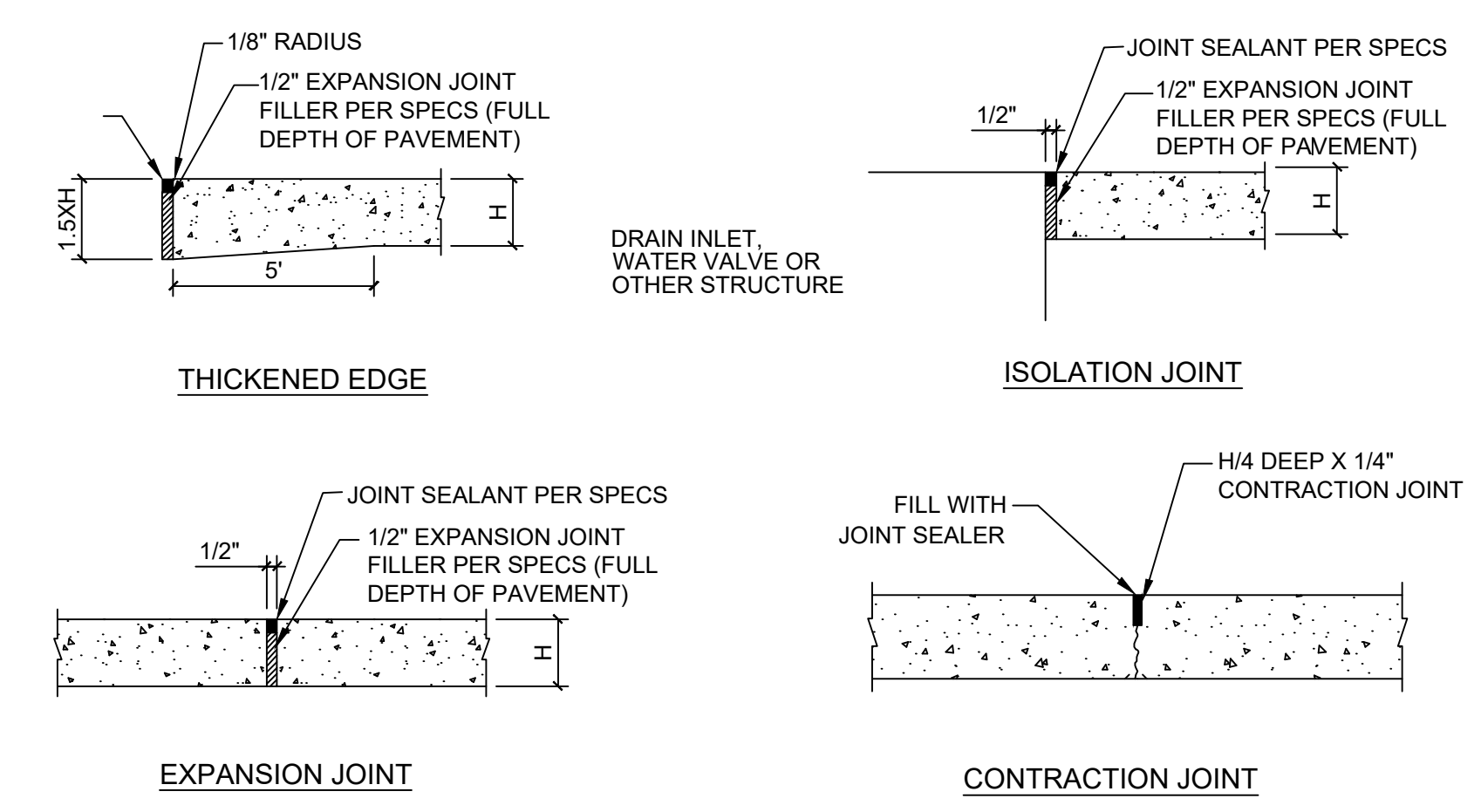

2 TYPICAL CONCRETE JOINT DETAILS
 C250 SCALE: NTS

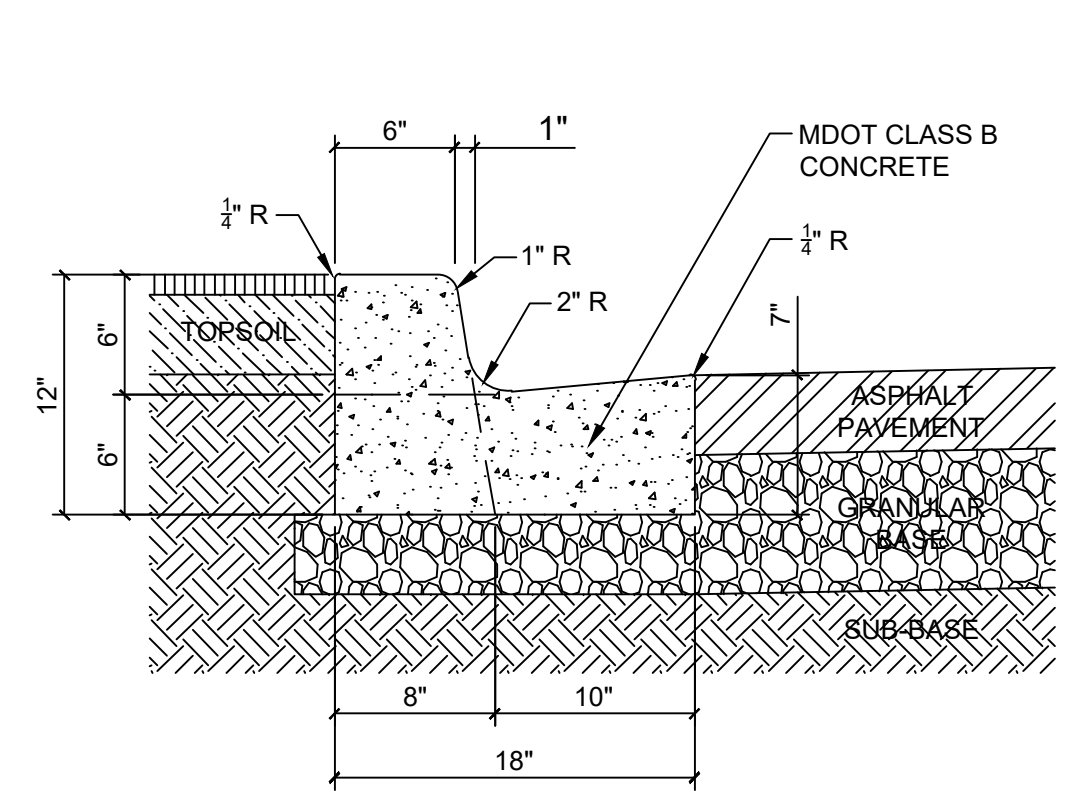

- CURB & GUTTER NOTES**
- CONSTRUCTION SHALL BE IN ACCORDANCE WITH LATEST ADDITION OF ACI 330R.
 - EXPANSION JOINTS SHALL BE SPACED AT A MAXIMUM DISTANCE OF 40' APART AND AT ALL RADIUS POINTS, PT'S, AND PC'S.
 - EXPANSION JOINTS SHALL BE LOCATED WHERE CURB ABUTS CONCRETE DRIVEWAYS, SIDEWALKS OR OTHER ADJACENT STRUCTURES.
 - CONTRACTION JOINTS SHALL BE SPACED AT A MAXIMUM DISTANCE OF 10' APART.
 - JOINTS SHALL BE PROVIDED WITHIN TWELVE (12) HOURS OF FINISHING CONCRETE.
 - 1/2 INCH BITUMINOUS JOINT FILLER SHALL BE INSTALLED AT EXPANSION JOINT LOCATIONS AND SHALL EXTEND THE FULL DEPTH OF THE CONCRETE.
 - CONTRACTION JOINT SHALL BE TOOLED AND BE 1/4 OF THE PAVEMENT THICKNESS DEEP. THE WIDTH OF THE TOOL SHOULD BE APPROXIMATELY 1/8 INCH FOR UNSEALED JOINTS AND 1/4 INCH FOR SEALED JOINTS.
 - FORMED CONTRACTION JOINTS SHALL BE FINISHED WITH A TOOL HAVING A 1/4" RADIUS.

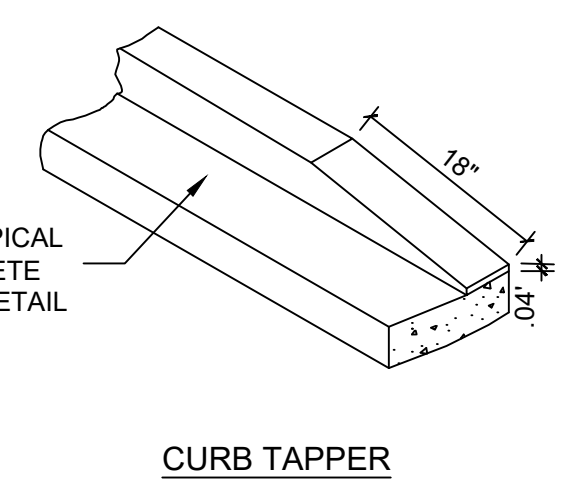
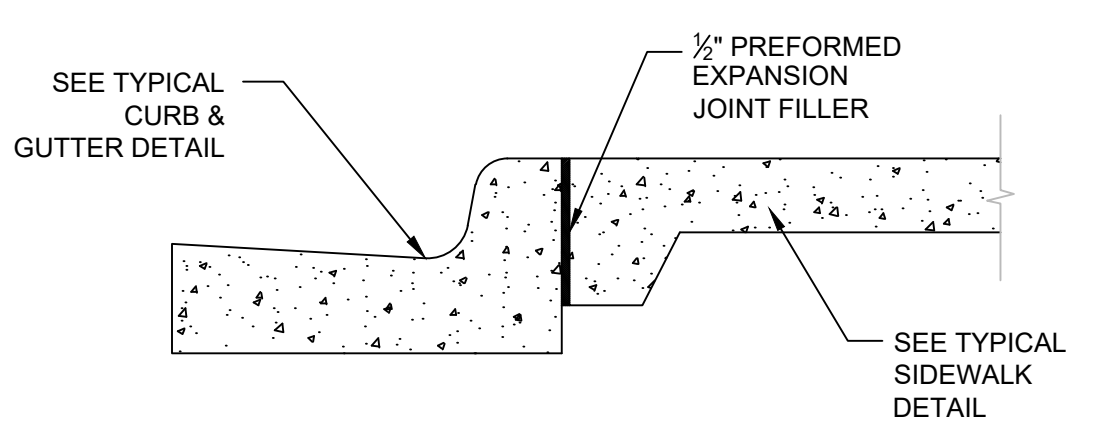

3 TYPICAL CONCRETE CURB DETAIL
 C250 SCALE: NTS

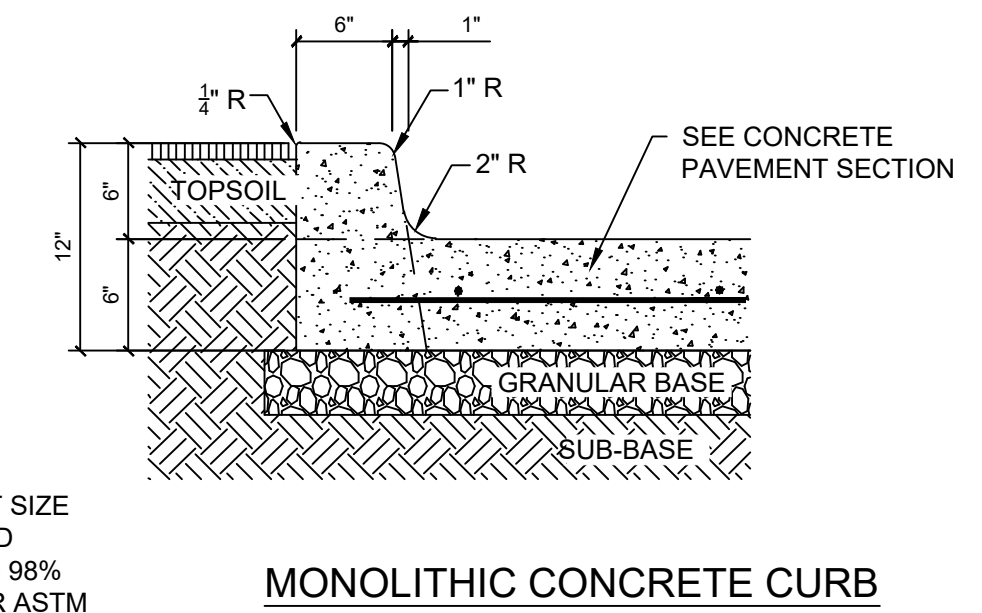
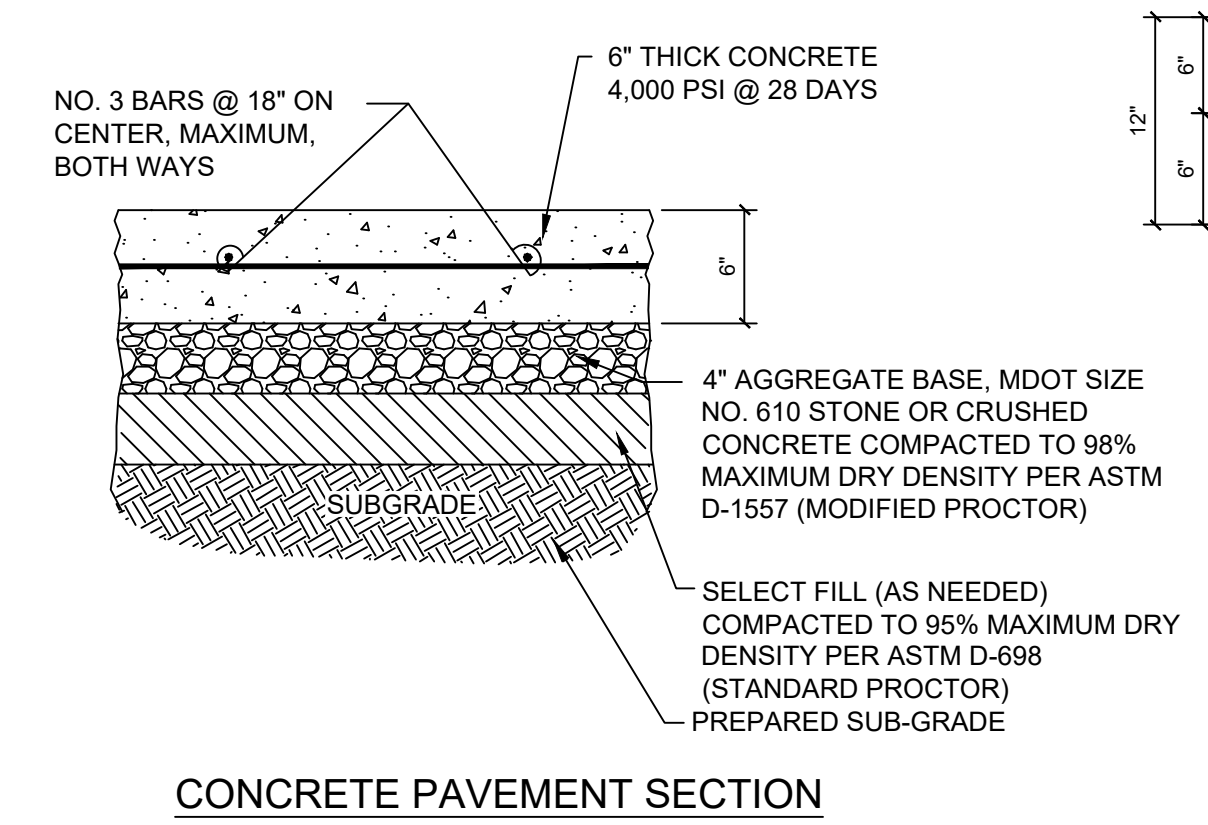

4 TYPICAL CONCRETE PAVEMENT SECTION
 C500 SCALE: NTS

C-STORE
 LA HIGHWAY 433 (OLD SPANISH TRAIL)
 SLIDELL, LOUISIANA

SHEET REVISIONS:

#	DATE/REFERENCE

STAMP:
 NOT FOR CONSTRUCTION

SHEET TITLE:
 SITE DETAILS

DATE: 12/20/24
 SHEET NUMBER:

C250

SHEET REVISIONS:

#	DATE/REFERENCE

STAMP:
 NOT FOR CONSTRUCTION

SHEET TITLE:
 SITE DETAILS

DATE: 12/20/24
 SHEET NUMBER:

C251

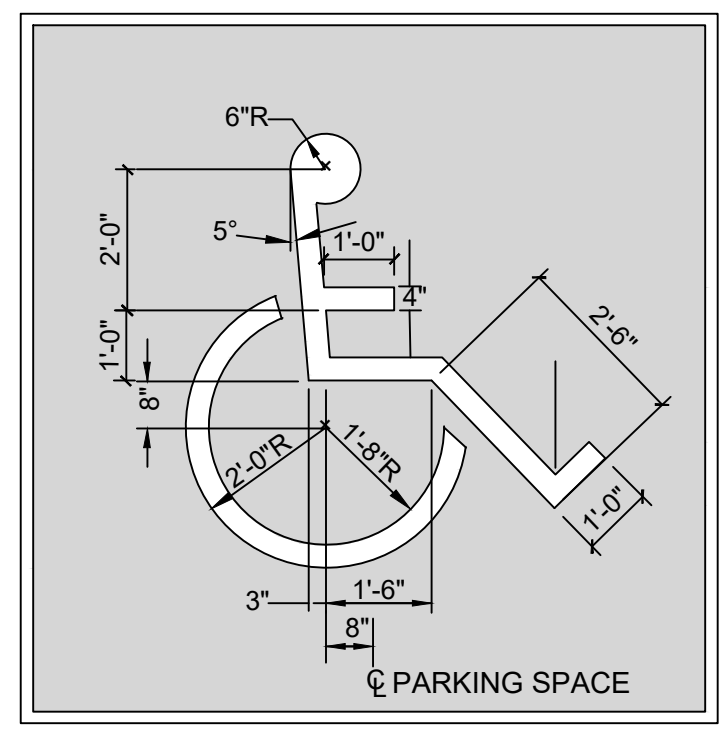

ACCESSIBLE SYMBOL

- HANDICAP SYMBOL DETAIL NOTES**
1. PAVEMENT SYMBOL SHALL BE PAINTED WHITE ON A BLUE BACKGROUND.
 2. BLUE COLOR SHALL MATCH NO. 15090 IN THE FEDERAL STANDARD 595B AS SPECIFIED IN SECTION 522(B)2.

- ACCESSIBLE STALL NOTES**
1. ALL STRIPING CONTIGUOUS TO HANDICAPPED PARKING SPACES SHALL BE PAINTED BLUE.
 2. ACCESSIBLE PARKING GRADES SHALL NOT EXCEED 1:50 IN ANY DIRECTION.

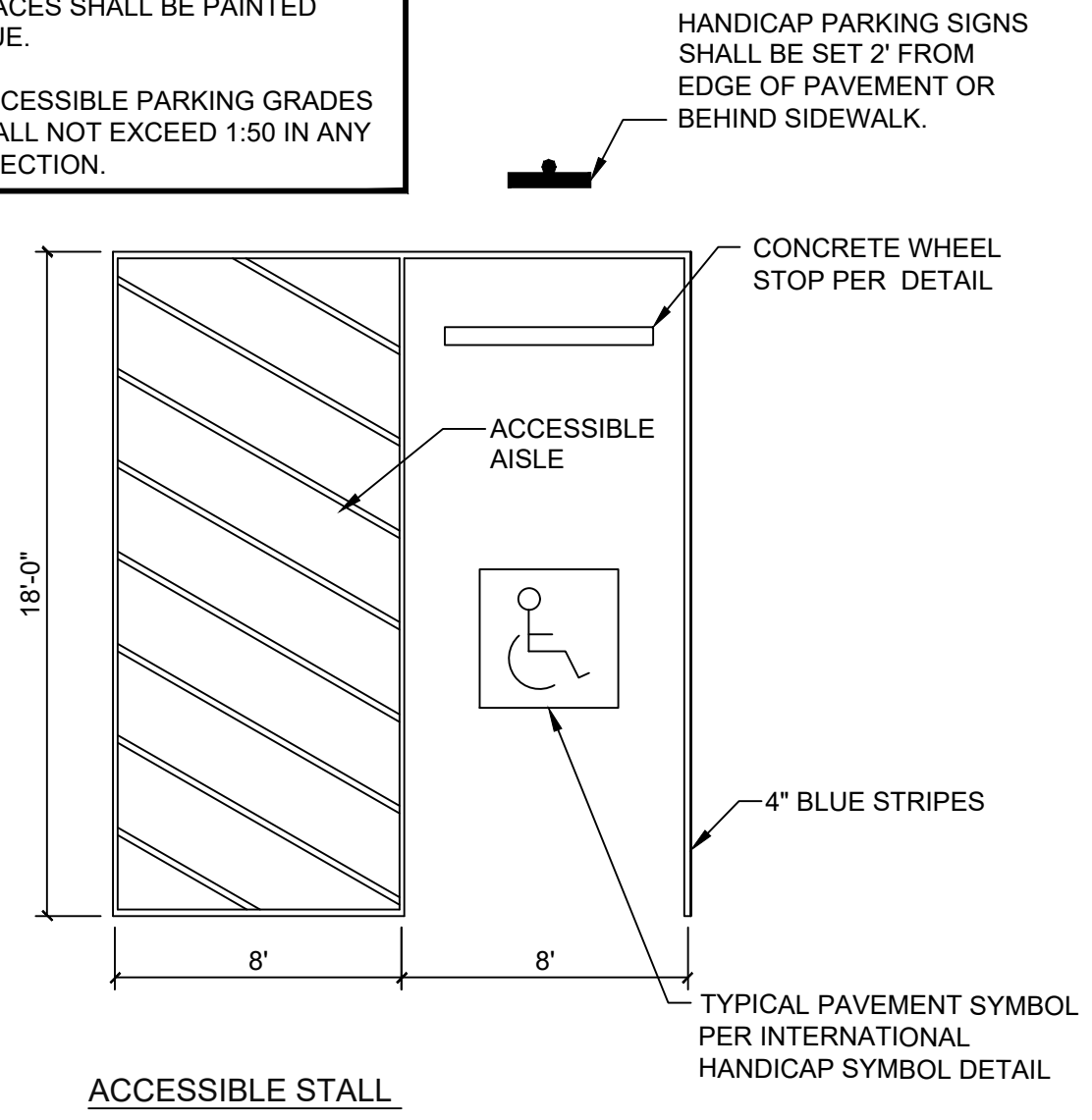

ACCESSIBLE STALL

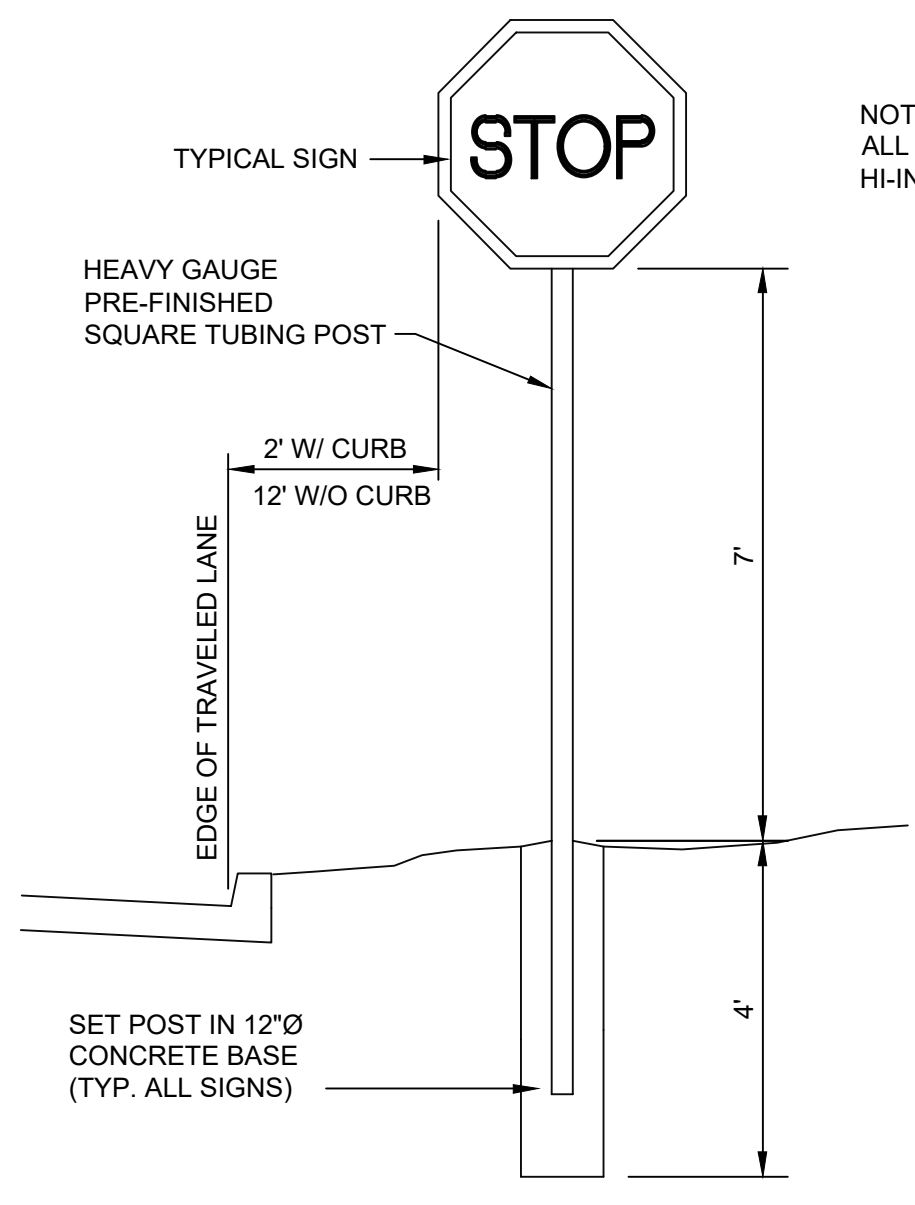

2 TYPICAL SIGN INSTALLATION DETAIL
 C251 SCALE: NTS

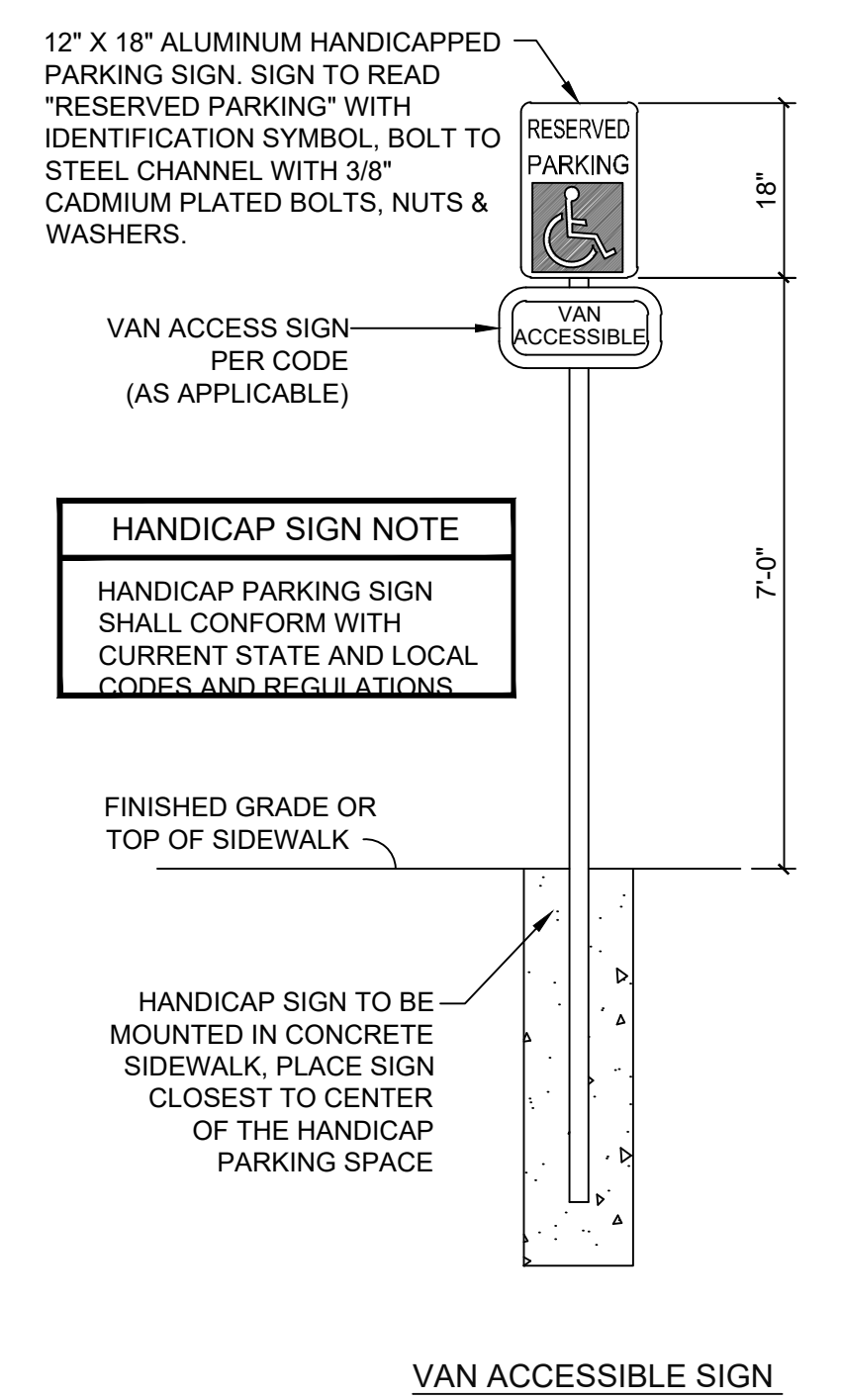

3 TYPICAL ACCESSIBLE SIGN DETAIL
 C251 SCALE: NTS

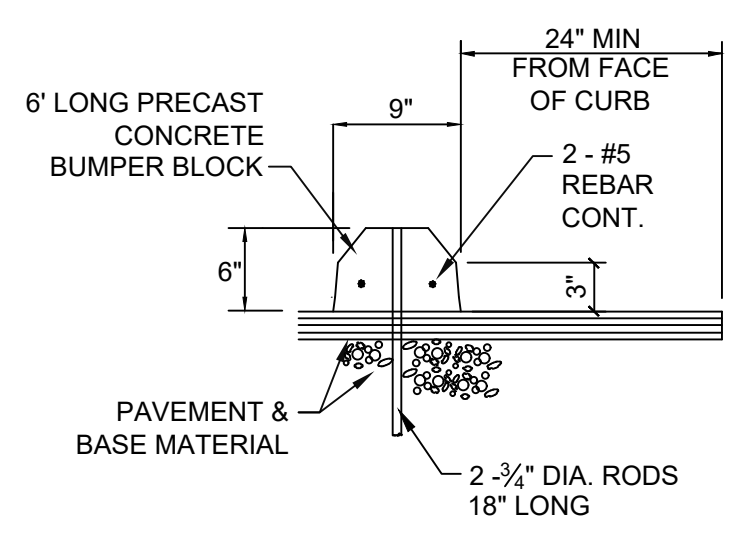

4 TYPICAL CONCRETE WHEEL STOP DETAIL
 C251 SCALE: NTS

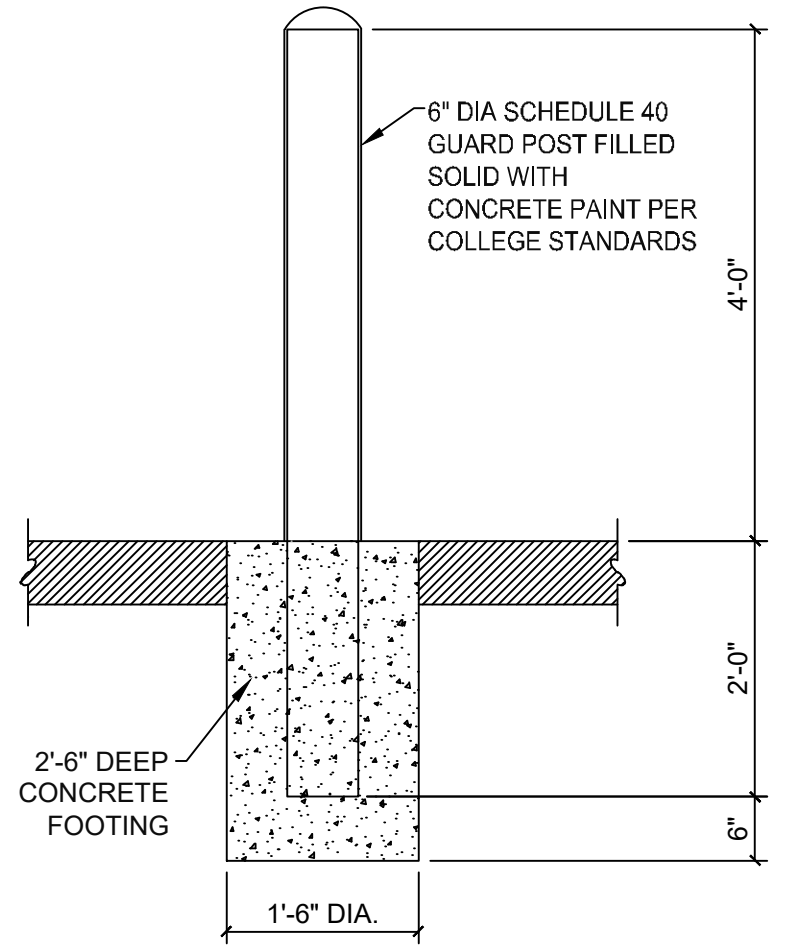
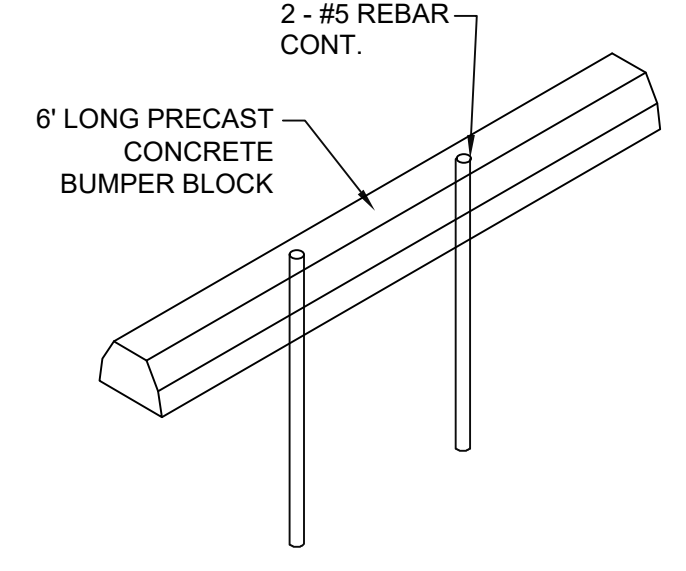

5 TYPICAL 6" BOLLARD DETAIL
 C251 SCALE: NTS

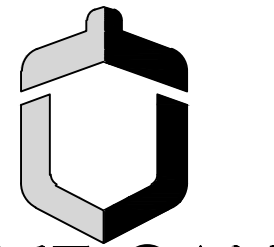

**LIVE OAK
ENGINEERING**

955B HOWARD AVENUE
BILOXI, MS 39530
LIVEOAKENGINEERING.COM

LOE JOB #269-1

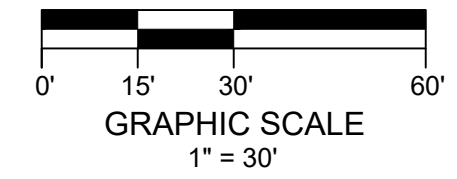

C-STORE
LA HIGHWAY 433 (OLD SPANISH TRAIL)
SLIDELL, LOUISIANA

SHEET REVISIONS:	
#	DATE/REFERENCE

STAMP:
**NOT FOR
CONSTRUCTION**

SHEET TITLE:
**GRADING
PLAN**

DATE: 12/20/24
SHEET NUMBER:

C300

- SITE GRADING AND DRAINAGE NOTES**
- CONTRACTOR SHALL BE RESPONSIBLE FOR VERIFYING HORIZONTAL AND VERTICAL LOCATIONS OF ALL EXISTING TIE-IN POINTS, STRUCTURES, PIPES, ETC., PRIOR TO CONSTRUCTION.
 - NO ACCESSIBLE PARKING STALLS OR ADJACENT ACCESS AISLES SHALL EXCEED 2% SLOPE IN ANY DIRECTIONS. CONTRACTOR SHALL NOTIFY ENGINEER PRIOR TO CONSTRUCTION IF CONDITIONS CANNOT BE MET ON SITE.
 - NO SIDEWALK CROSS SLOPE SHALL EXCEED 2% AND NO SIDEWALK LONGITUDINAL SLOPE SHALL EXCEED 5%. CONTRACTOR SHALL NOTIFY ENGINEER PRIOR TO CONSTRUCTION IF CONDITIONS CANNOT BE MET ON SITE.
 - FINISH SURFACES TO BE SMOOTH AND EVEN WITH NO ABRUPT OR AWKWARD CHANGES IN GRADE. IF SPECIFIC GRADES AND SLOPES ARE NOT SHOWN FOR WORK IN ANY AREA, THE CONTRACTOR SHALL ENSURE POSITIVE DRAINAGE IS ACHIEVED AWAY FROM BUILDINGS AND STRUCTURES AND TIE INTO EXISTING CONDITIONS.

- LEGEND**
- 10 — DENOTES EXISTING GRADE CONTOUR
 - (10) — DENOTES PROPOSED GRADE CONTOUR
 - 8.00 DENOTES PROPOSED SPOT ELEVATION
 - ↘ ↙ ↖ ↗ DENOTES WATERSHED FLOW DIRECTION
 - DS - DRAIN STRUCTURE
 - RCP - REINFORCED CONCRETE PIPE
 - RCAP - REINFORCED CONCRETE ARCH PIPE
 - HP - HIGH PERFORMANCE POLYPROPYLENE STORM PIPE

WORK WITHIN R.O.W. FOR REFERENCE ONLY. MODIFICATIONS TO TURN LANES IN LA HWY 433 TO BE PERMITTED SEPARATELY

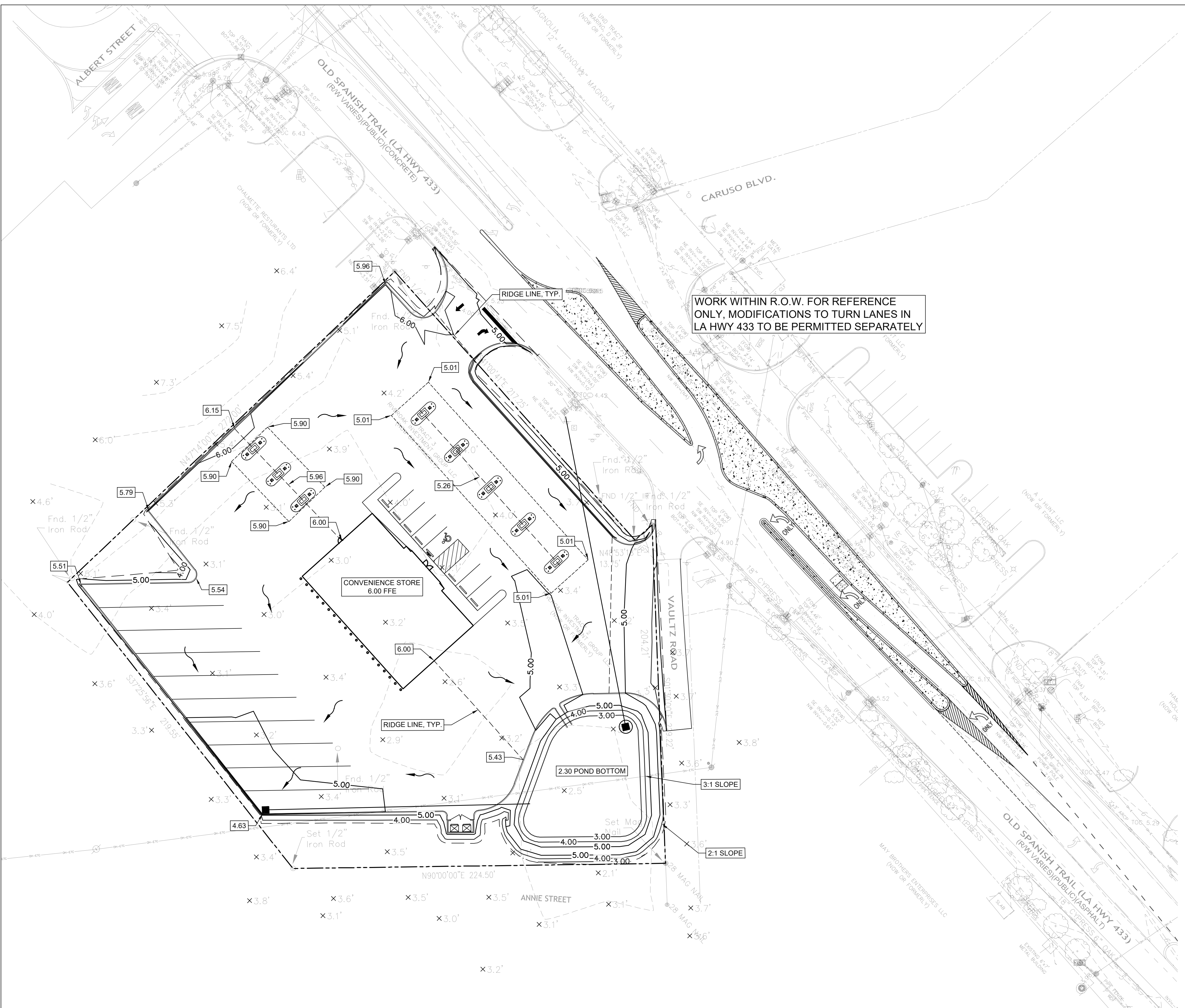

1 GRADING PLAN
C300 SCALE: 1" = 30'

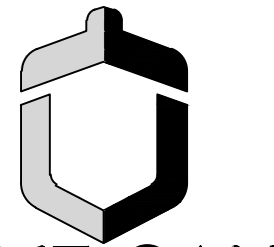

**LIVE OAK
ENGINEERING**

955B HOWARD AVENUE
BILOXI, MS 39530
LIVEOAKENGINEERING.COM

LOE JOB #269-1

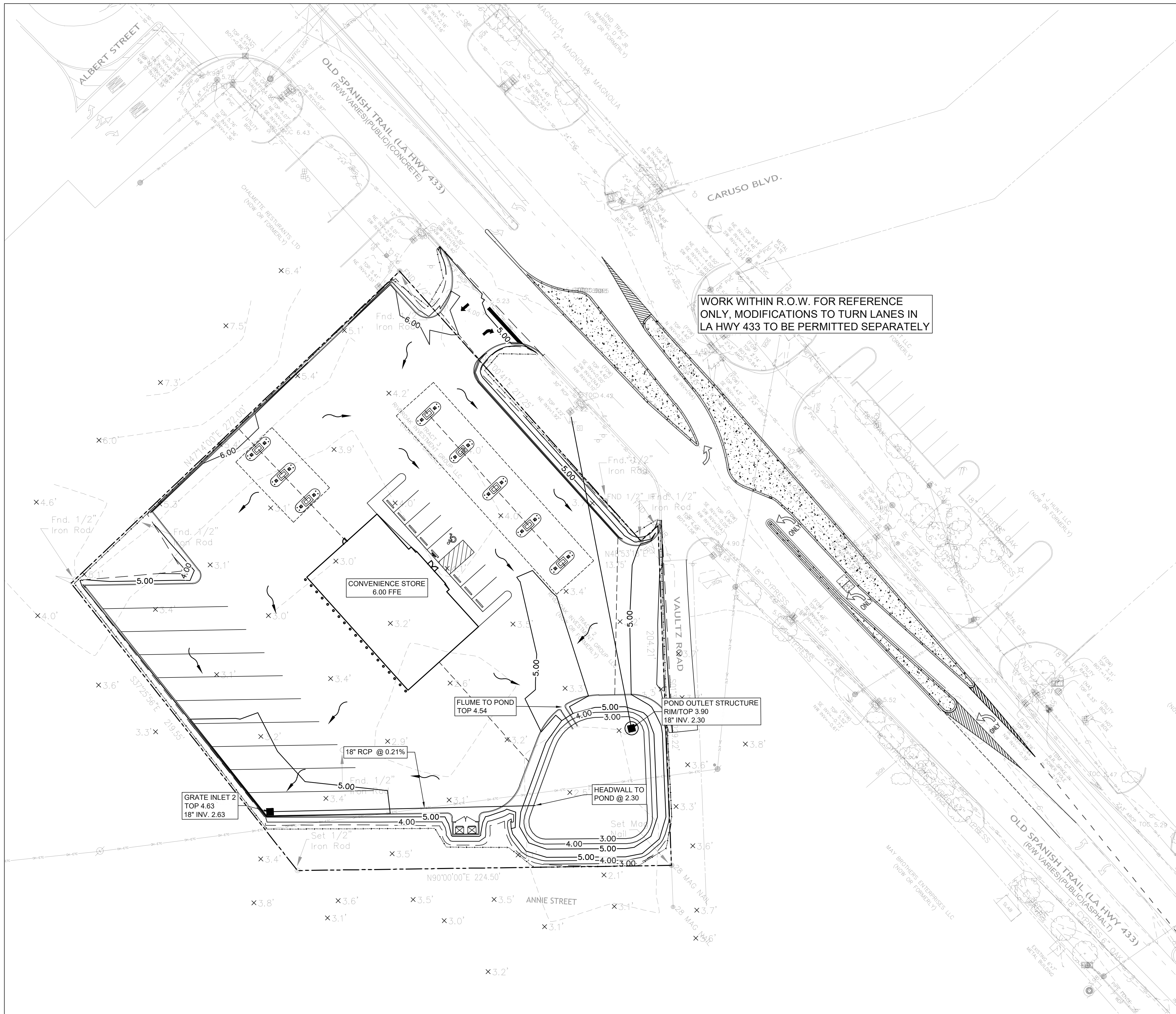
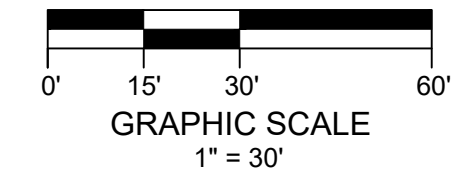
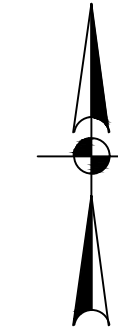

DRAINAGE FLOW SUMMARY		
DRAINAGE AREA	Pre Peak Run-Off	Post Peak Run-Off
Total Area (Pre)	6.350	
South Area (Post)*		1.680
North Area (Post)		4.560
TOTAL	6.350	6.240
* ROUTED THROUGH POND		

- STORM WATER MANAGEMENT NOTES**
- DRAINAGE SYSTEM SHOWN WILL BE PRIVATELY OWNED AND MAINTAINED.
 - IN THE EVENT OF CONFLICT BETWEEN CITY OF OXFORD STORM WATER REQUIREMENTS AND THE PLANS, THE CITY OF OXFORD LATEST STORM WATER MANAGEMENT ORDINANCE SHALL GOVERN.
 - TRASH RACKS ARE REQUIRED TO PROTECT DISCHARGE STRUCTURE ORIFICES AND CONTAIN GARBAGE FROM EXISTING THE PROPERTY.
 - ALL FLUMES AND OUTLET STRUCTURES ARE REQUIRED TO BE PROTECTED BY RIP-RAP.

- LEGEND**
- 10 --- DENOTES EXISTING GRADE CONTOUR
 - (10) --- DENOTES PROPOSED GRADE CONTOUR
 - 8.00 DENOTES PROPOSED SPOT ELEVATION
 - > DENOTES WATERSHED FLOW DIRECTION
 - DS - DRAIN STRUCTURE
 - RCP - REINFORCED CONCRETE PIPE
 - RCAP - REINFORCED CONCRETE ARCH PIPE
 - HP - HIGH PERFORMANCE POLYPROPYLENE STORM PIPE

C-STORE
LA HIGHWAY 433 (OLD SPANISH TRAIL)
SLIDELL, LOUISIANA

SHEET REVISIONS:

#	DATE/REFERENCE

STAMP:
NOT FOR CONSTRUCTION

SHEET TITLE:
DRAINAGE PLAN

DATE: 12/20/24
SHEET NUMBER:

C310

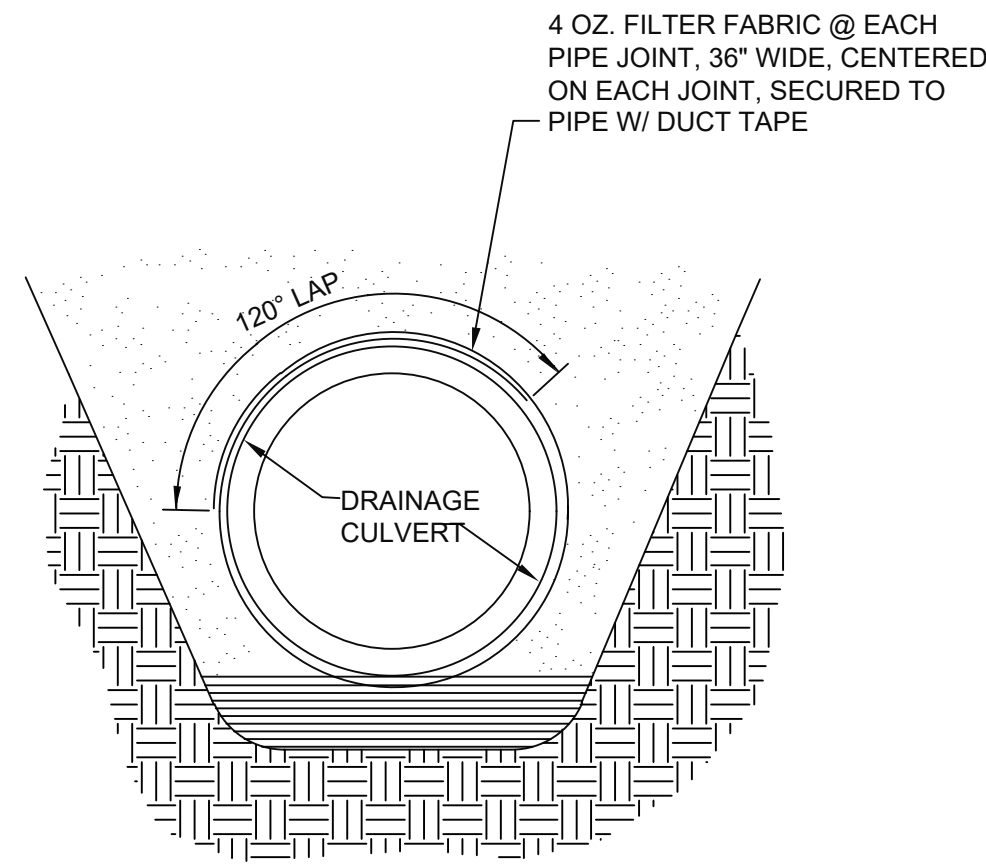

1 TYPICAL STORM DRAIN PIPE WRAP DETAIL

C350 SCALE: NTS

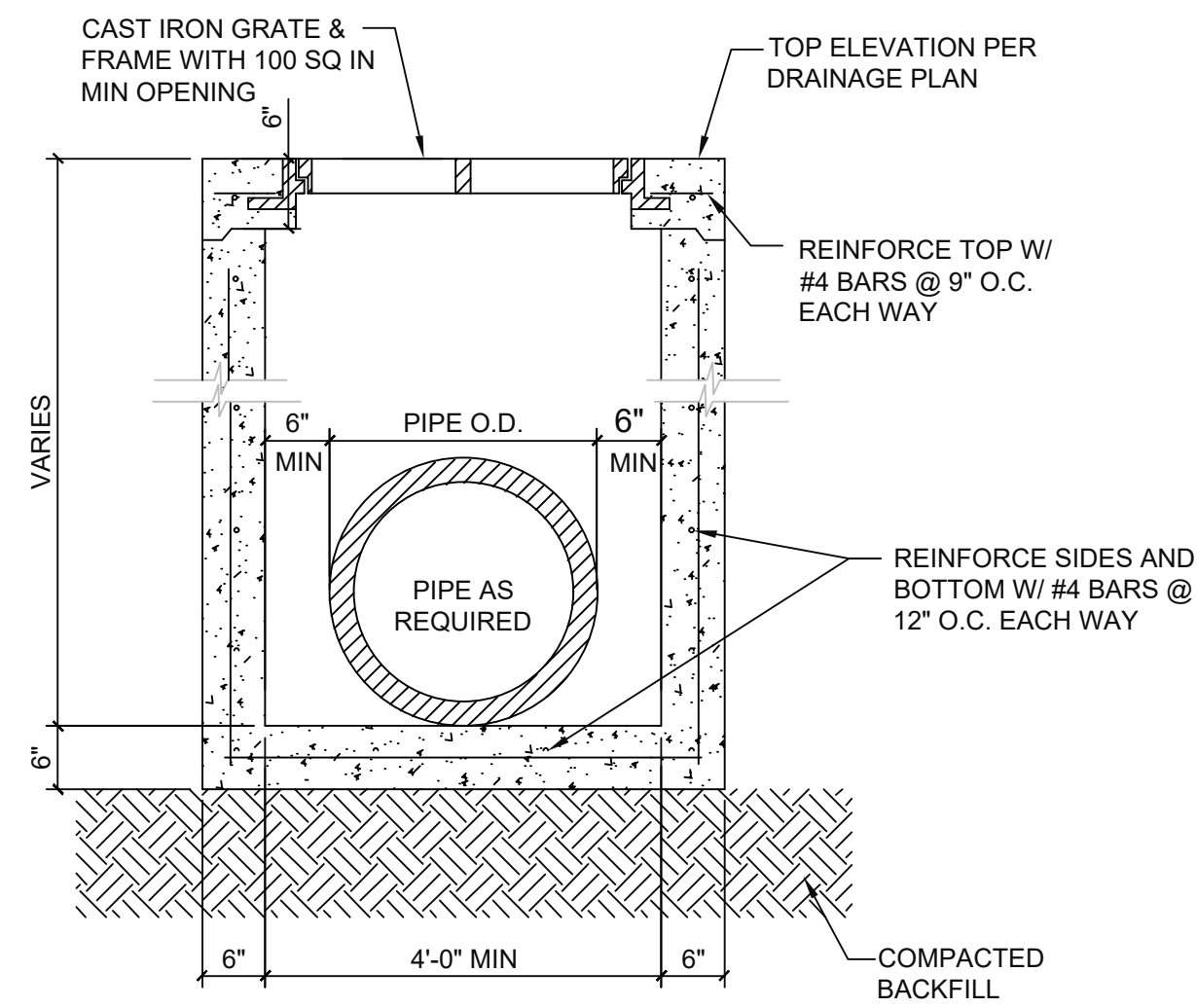

3 TYPICAL DRAIN INLET DETAIL

C350 SCALE: NTS

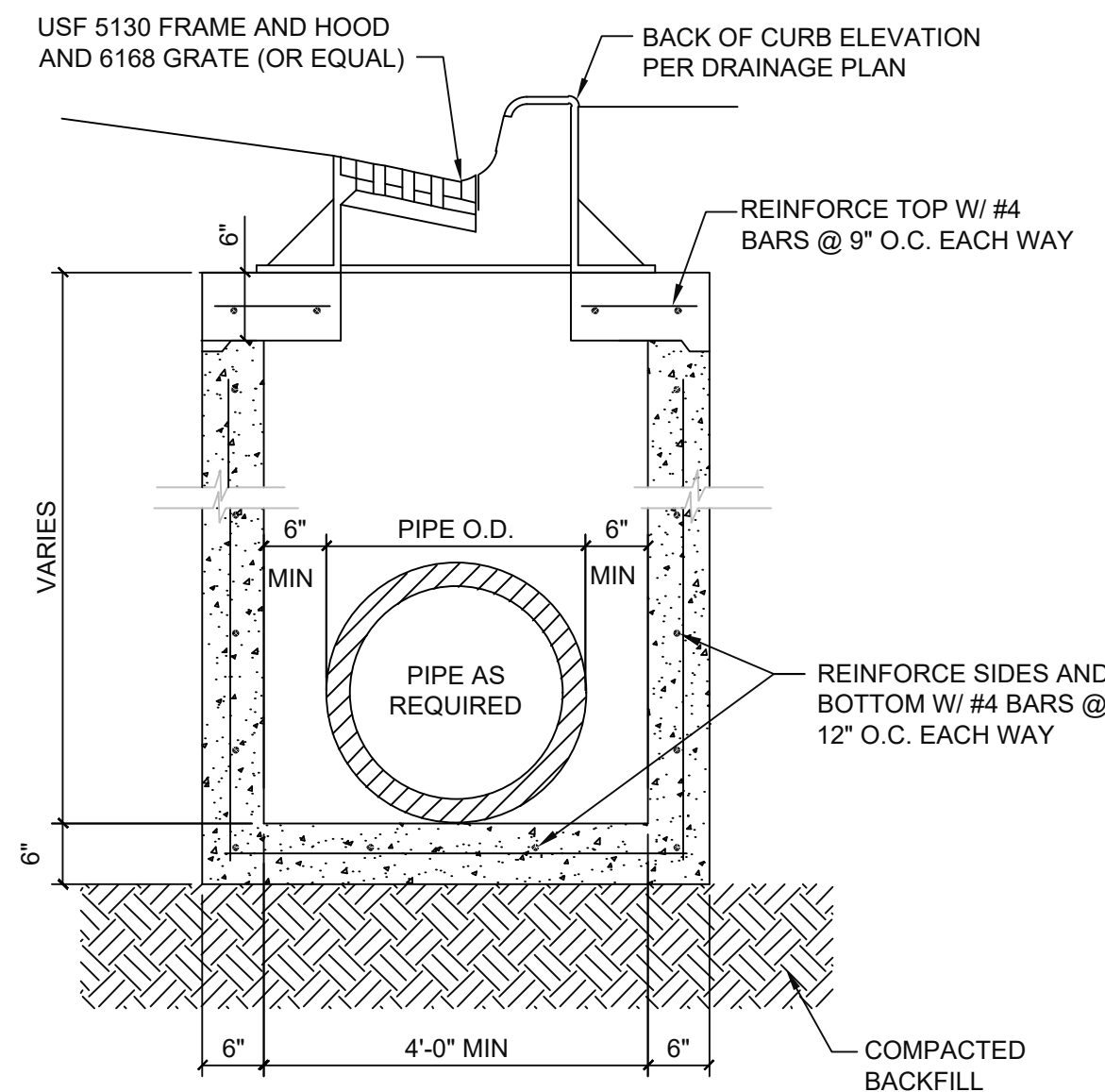

4 TYPICAL CURB INLET DETAIL

C350 SCALE: NTS

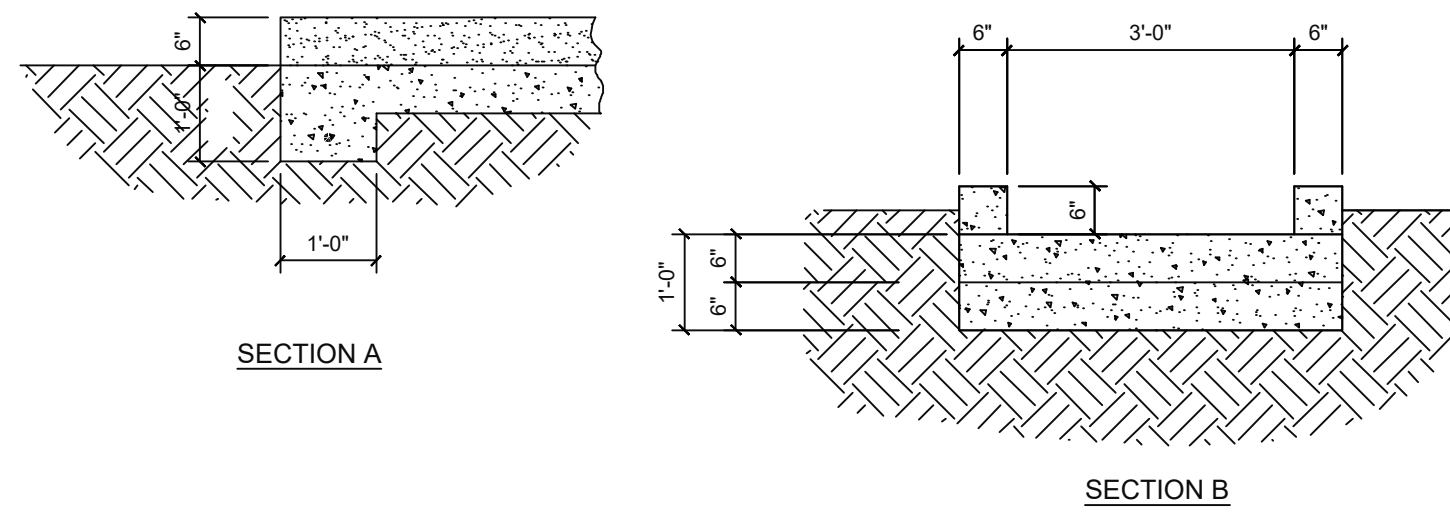
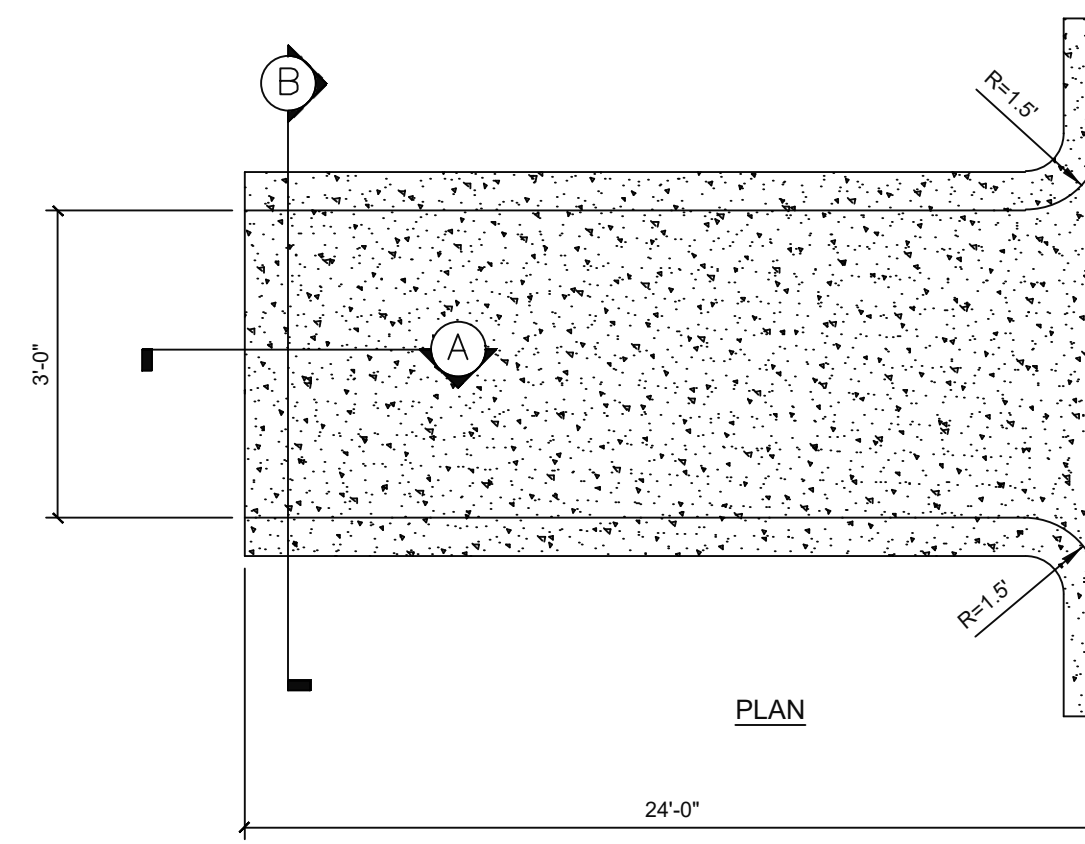

2 TYPICAL CONCRETE FLUME DETAIL

C500 SCALE: NTS

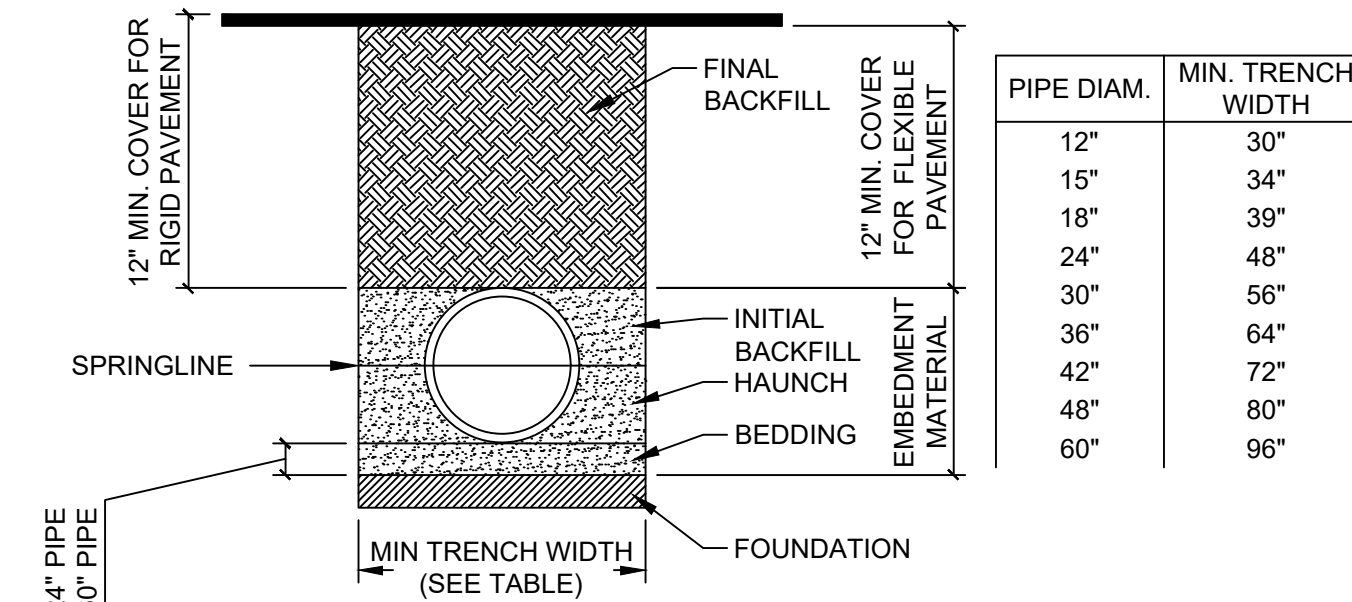

PIPE DIAM.	MIN. TRENCH WIDTH
12"	30"
15"	34"
18"	39"
24"	48"
30"	56"
36"	64"
42"	72"
48"	80"
60"	96"

HP STORM PIPE INSTALLATION NOTES

- ALL HP STORM PIPE SYSTEMS SHALL BE INSTALLED IN ACCORDANCE WITH LATEST VERSION OF ASTM D2321, "STANDARD PRACTICE FOR UNDERGROUND INSTALLATION OF THERMOPLASTIC PIPE FOR SEWERS AND OTHER GRAVITY FLOW APPLICATIONS".
- SUITABLE EMBEDMENT MATERIALS, EITHER ON-SITE OR IMPORTED, SHALL MEET THE REQUIREMENTS FOR CLASS I, II, OR III PER THE LATEST VERSION OF ASTM D2321. THE CONTRACTOR SHALL PROVIDE DOCUMENTATION TO THE ENGINEER FOR EMBEDMENT MATERIAL TO BE USED FOR PIPE INSTALLATION. SEE THE EMBEDMENT MATERIAL TABLE FOR COMPACTION AND LIFT PLACEMENT REQUIREMENTS.
- FOUNDATION: WHERE THE TRENCH BOTTOM IS UNSTABLE, THE CONTRACTOR SHALL EXCAVATE TO A DEPTH REQUIRED BY THE ENGINEER AND REPLACE WITH SUITABLE MATERIAL AS SPECIFIED BY THE ENGINEER.
- BEDDING: BEDDING IS REQUIRED TO ESTABLISH LINE AND GRADE AND TO PROVIDE FIRM PIPE SUPPORT. MINIMUM BEDDING THICKNESS SHALL BE 4" FOR UP TO 24" DIAMETER PIPE AND 6" FOR 30"-60" DIAMETER PIPE. THE MIDDLE 1/3 BENEATH THE PIPE INVERT SHALL BE LOOSELY PLACED, WHILE THE REMAINDER SHALL BE THOROUGHLY COMPACTED.
- HAUNCHING: THE HAUNCHING MATERIAL SHALL BE INSTALLED UNIFORMLY IN LIFTS ON EACH SIDE OF THE PIPE AND SHOVELED UNDER THE PIPE ENSURING TO FILL VOIDS. THE MATERIAL SHALL BE THOROUGHLY COMPACTED TO THE SPRING LINE OF THE PIPE EXTENDING TO THE SIDE WALLS OF THE TRENCH ENSURING THAT THE PIPE ALIGNMENT IS NOT DISTURBED.
- INITIAL BACKFILL: THE INITIAL BACKFILL SHALL PROCEED TO THE TOP OF THE PIPE. THE MATERIAL SHALL BE THOROUGHLY COMPACTED INSTALLED IN UNIFORMED LIFTS ON EACH SIDE OF THE PIPE EXTENDING TO THE SIDE WALLS OF THE TRENCH.
- FINAL BACKFILL (NON-TRAFFIC): SUITABLE MATERIAL IN NON-TRAFFIC APPLICATIONS (GRASS OR LANDSCAPE AREAS) SHALL BE GENERAL FILL MATERIAL. BACKFILL SHALL PROCEED TO FINISHED GRADE IN 12 INCH LIFTS COMPACTED TO ELIMINATE AIR VOIDS.
- FINAL BACKFILL (TRAFFIC): SUITABLE MATERIAL IN TRAFFIC APPLICATIONS SHALL BE SELECT FILL COMPACTED IN 8 INCH LOOSE LIFTS TO NOT LESS THAN 95 PERCENT STANDARD PROCTOR.
- MINIMUM COVER (NON-TRAFFIC): FOR NON-TRAFFIC APPLICATIONS (GRASS OR LANDSCAPE AREAS), MINIMUM COVER IS 12" FROM THE TOP OF PIPE TO GROUND SURFACE.
- MINIMUM COVER (TRAFFIC): FOR TRAFFIC APPLICATIONS THE MINIMUM COVER IS 12" FOR UP TO 48" DIAMETER PIPE AND 24" OF COVER FOR 60" DIAMETER PIPE, MEASURED FROM TOP OF PIPE TO BOTTOM OF FLEXIBLE PAVEMENT OR TO TOP OF RIGID PAVEMENT.
- CONTRACTOR SHALL MAINTAIN TRENCH BACKFILL AT GROUND SURFACE UNTIL FINAL ACCEPTANCE OF THE WORK. ALL SURPLUS MATERIALS NOT USED IN BACKFILLING SHALL BE REMOVED AND DISPOSED OF BY CONTRACTOR AT HIS OWN EXPENSE.

5 HP STORM PIPE TRENCH INSTALLATION DETAIL

C350 SCALE: NTS

SHEET REVISIONS:	
#	DATE/REFERENCE

STAMP:
 NOT FOR CONSTRUCTION

SHEET TITLE:
DRAINAGE DETAILS

DATE: 12/20/24
 SHEET NUMBER:

C350

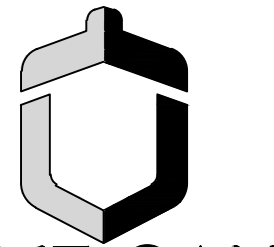

**LIVE OAK
ENGINEERING**

955B HOWARD AVENUE
BILOXI, MS 39530
LIVEOAKENGINEERING.COM

LOE JOB #269-1



0' 15' 30' 60'
GRAPHIC SCALE
1" = 30'

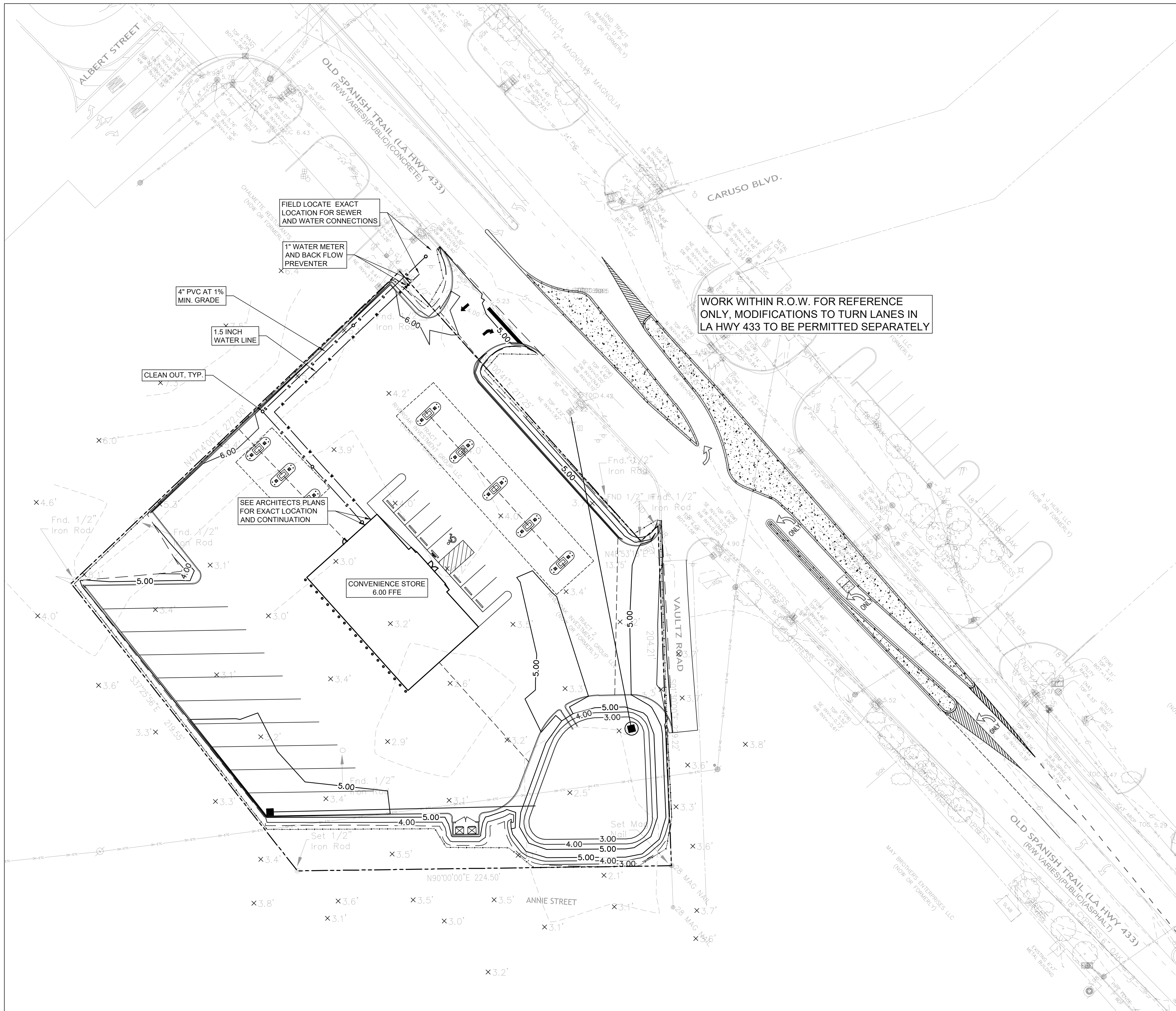

WORK WITHIN R.O.W. FOR REFERENCE ONLY. MODIFICATIONS TO TURN LANES IN LA HWY 433 TO BE PERMITTED SEPARATELY

- UNDERGROUND UTILITY NOTES**
1. CONTRACTOR SHALL VERIFY LOCATIONS OF ALL PROJECT RELATED UTILITIES, BURIED AND ABOVE GROUND, REGARDLESS OF INCLUSION ON THESE PLANS. THE LOCATIONS OF ANY EXISTING UTILITIES SHOWN ARE APPROXIMATE ONLY.
 2. THE CONTRACTOR SHALL BE RESPONSIBLE FOR DETERMINING THE EXACT LOCATION OF ALL EXISTING UTILITIES BEFORE COMMENCING WORK.
 3. ALL CONTRACTOR DAMAGED UTILITIES SHALL BE REPAIRED AT THE CONTRACTOR'S EXPENSE.

- SITE UTILITY NOTES**
1. CONTRACTOR SHALL BE RESPONSIBLE FOR VERIFYING LOCATIONS OF ALL PROJECT RELATED UTILITIES, BURIED AND ABOVE GROUND, REGARDLESS OF INCLUSION ON THESE PLANS. THE LOCATIONS OF ANY EXISTING UTILITIES SHOWN ARE APPROXIMATE ONLY. THE CONTRACTOR SHALL BE RESPONSIBLE FOR DETERMINING THE EXACT LOCATIONS OF ALL EXISTING UTILITIES BEFORE COMMENCING WORK. ALL CONTRACTOR DAMAGED UTILITIES SHALL BE REPAIRED AT THE CONTRACTOR'S EXPENSE.
 2. CONTRACTOR IS RESPONSIBLE FOR CONNECTION TO EXISTING WATER MAIN.
 3. CONTRACTOR IS RESPONSIBLE FOR PERFORMING GAS LINE TAP, PROVIDING GAS VALVE, AND PROVIDING GAS SERVICE TO THE BUILDING.
 4. CONTRACTOR SHALL FURNISH AND INSTALL 750 LINEAR FEET OF 4" SDR-21 CL200 PVC AND ASSOCIATED CAPS FOR USE AS IRRIGATION SLEEVES. LOCATIONS OF IRRIGATION SLEEVES SHALL BE COORDINATED WITH THE OWNER.
 5. CONTRACTOR SHALL BE RESPONSIBLE FOR COORDINATING WITH OTHER TRADES FOR TIE IN LOCATION AND SIZE REQUIREMENTS FOR UTILITY TIE IN POINTS.
 6. CONTRACTOR SHALL NOTIFY THE APPROPRIATE UTILITY AT LEAST 48 HOURS PRIOR TO COMMENCING CONSTRUCTION HAVING POTENTIAL IMPACT TO THE UTILITY'S STRUCTURE.
 7. CONTRACTOR SHALL INSTALL FITTINGS, THRUST BLOCKS, AND OTHER REQUIRED COMPONENTS TO ESTABLISH THE PROPER ALIGNMENT OF UTILITY MAINS AND SERVICES AS SHOWN ON THE PLANS.
 8. CONTRACTOR SHALL INSTALL ALL WATER MAINS AND SERVICES AT AN ELEVATION WHICH WILL AVOID ALL CONFLICTS WITH SEWER, DRAINAGE, AND OTHER UNDERGROUND UTILITIES. WATER MAINS SHALL BE LAID WITH A MINIMUM OF 30" COVER UNLESS APPROVED BY THE ENGINEER TO AVOID A CONFLICT.
 9. ALL VALVES BOXES, CLEANOUTS, SEWER MANHOLE TOPS, AND OTHER UTILITY STRUCTURE TOPS SHALL BE ADJUSTED BY THE CONTRACTOR TO MATCH FINAL GRADES IN ALL AREAS.

C-STORE
LA HIGHWAY 433 (OLD SPANISH TRAIL)
SLIDELL, LOUISIANA

SHEET REVISIONS:

#	DATE/REFERENCE

STAMP:
**NOT FOR
CONSTRUCTION**

SHEET TITLE:
UTILITY PLAN

DATE: 12/20/24
SHEET NUMBER:

C400

1
C400 **UTILITY PLAN**
SCALE: 1" = 30'

BEARING AREAS FOR THRUST BLOCKING IN SQUARE FEET						
FITTING:	4" DIA.	6" DIA.	8" DIA.	10" DIA.	12" DIA.	14" DIA.
TEES	2.0	2.5	4.7	5.0	7.0	9.0
90°	2.0	2.7	6.7	7.2	10.4	12.7
45°	1.0	1.5	3.6	3.9	5.6	6.9
22 1/2°	1.0	1.0	1.8	2.0	2.9	3.5

NOTE: ALL FITTINGS SHALL BE COVERED WITH A GEOTEXTILE FABRIC PRIOR TO POURING CONCRETE THRUST BLOCKING

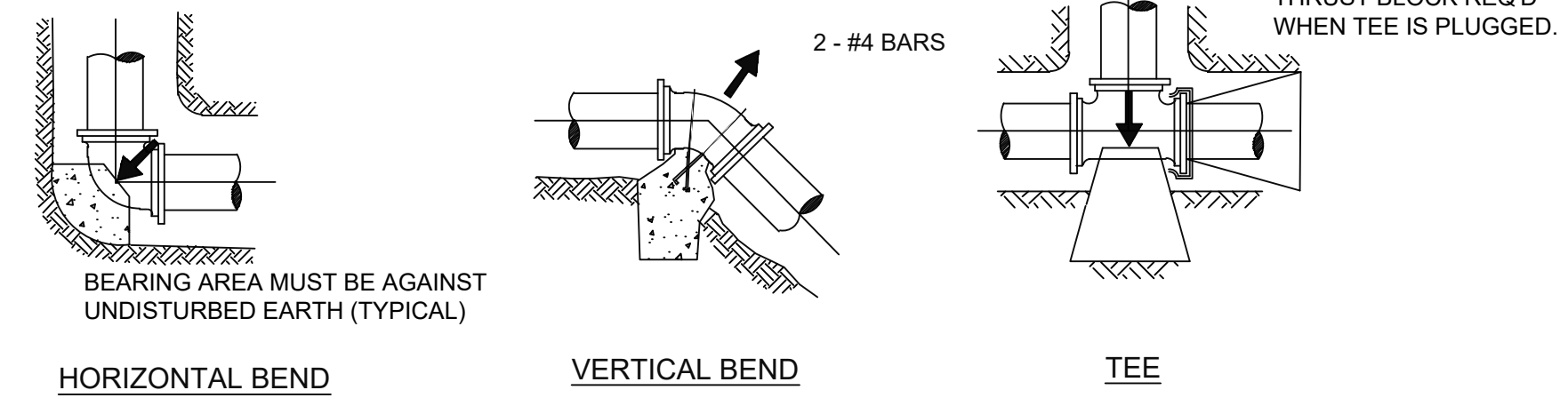

1 TYPICAL WATER MAIN THRUST BLOCK DETAIL
 SCALE: NTS

ASTM D2321 CLASS DESCRIPTION		ASTM D2487 DESCRIPTION NOTATION		MINIMUM STANDARD PROCTOR DENSITY (%)	MAXIMUM LIFT PLACEMENT DEPTH	
I	CRUSHED ROCK, ANGULAR	N/A	ANGULAR CRUSHED STONE OR ROCK, CRUSHED GRAVEL, CRUSHED SLAG; LARGE VOIDS WITH LITTLE OR NO FINES	DUMPED	18"	
II	CLEAN, COARSE-GRAINED SOILS	GW	WELL-GRADED GRAVEL, GRAVEL-SAND MIXTURES; LITTLE OR NO FINES	85%	12"	
		GP	POORLY-GRADED GRAVELS, GRAVEL-SAND MIXTURES; LITTLE OR NO FINES			
		SW	WELL-GRADED SANDS, GRAVELLY SANDS; LITTLE OR NO FINES			
		SP	POORLY-GRADED SANDS, GRAVELLY SAND; LITTLE OR NO FINES			
III	COARSE-GRAINED SOILS, BORDERLINE CLEAN TO W/FINES	GW-GC, SP-SM	SANDS AND GRAVELS WHICH ARE BORDERLINE BETWEEN CLEAN AND WITH FINES	90%	9"	
		COURSE-GRAINED SOILS WITH FINES	GM			SILTY GRAVELS, GRAVEL-SAND-SILT MIXTURES
			GC			CLAYEY GRAVELS, GRAVEL-SAND-CLAY MIXTURES
			SM			SILTY SANDS, SAND-CLAY MIXTURES
	SC		CLAYEY SANDS, SAND-CLAY MIXTURES			
	INORGANIC FINE-GRAINED SOILS	ML	INORGANIC SILTS AND VERY FINE SANDS, ROCK FLOUR, SILTY OR CLAYEY FINE SANDS, SILTS WITH SLIGHT PLASTICITY			
CL		INORGANIC CLAYS OF LOW TO MEDIUM PLASTICITY; GRAVELLY, SANDY, OR SILTY CLAYS; LEAN CLAYS				

2 EMBEDMENT MATERIAL TABLE
 SCALE: NTS

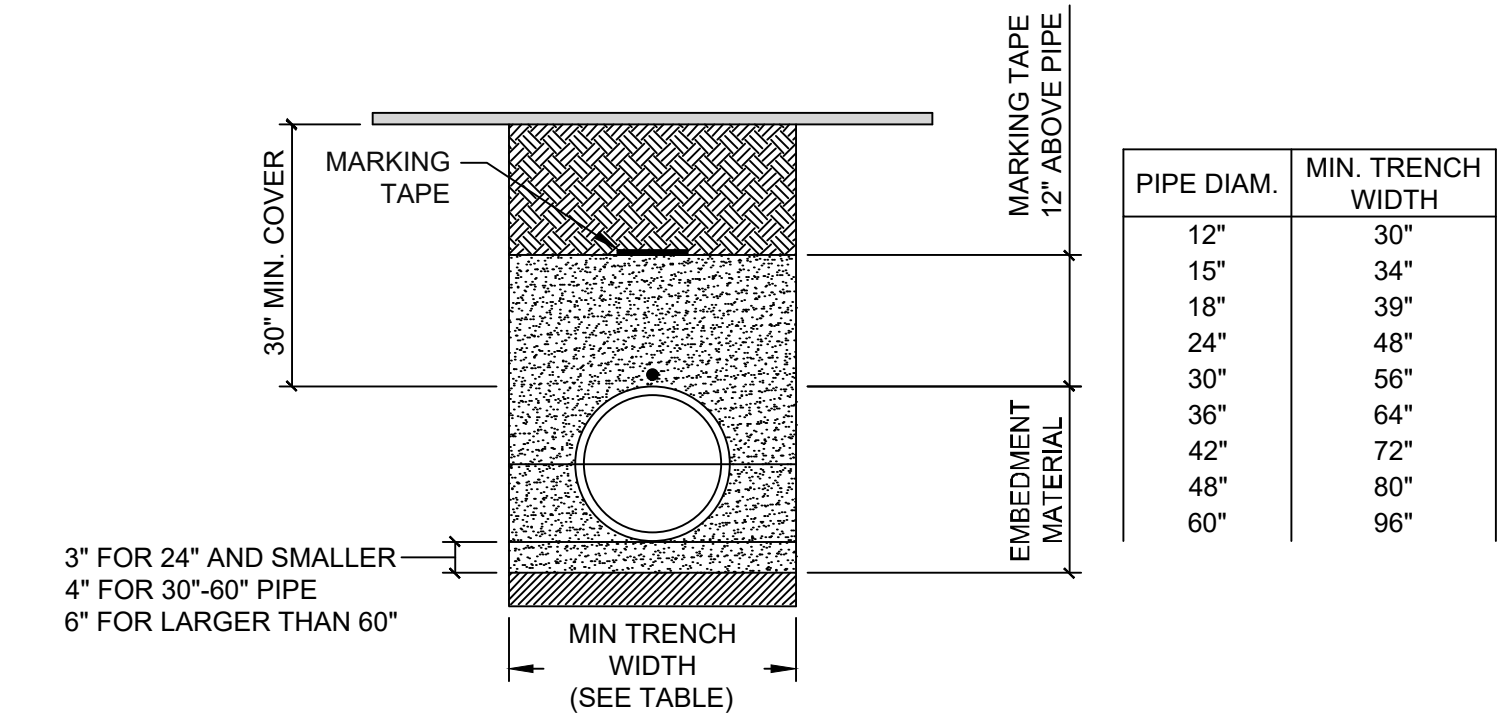

- WATER AND SEWER PIPE INSTALLATION NOTES**
- SUITABLE EMBEDMENT MATERIALS, EITHER ON-SITE OR IMPORTED, SHALL MEET THE REQUIREMENTS FOR CLASS I, II, OR III PER THE LATEST VERSION OF ASTM D2321. THE CONTRACTOR SHALL PROVIDE DOCUMENTATION TO THE ENGINEER FOR EMBEDMENT MATERIAL TO BE USED FOR PIPE INSTALLATION. SEE THE EMBEDMENT MATERIAL TABLE FOR COMPACTION AND LIFT PLACEMENT REQUIREMENTS.
 - FOUNDATION: WHERE THE TRENCH BOTTOM IS UNSTABLE, THE CONTRACTOR SHALL EXCAVATE TO A DEPTH REQUIRED BY THE ENGINEER AND REPLACE WITH SUITABLE MATERIAL AS SPECIFIED BY THE ENGINEER.
 - BEDDING: BEDDING IS REQUIRED TO ESTABLISH LINE AND GRADE AND TO PROVIDE FIRM PIPE SUPPORT. MINIMUM BEDDING THICKNESS SHALL BE 4" FOR UP TO 24" DIAMETER PIPE AND 6" FOR 30"-60" DIAMETER PIPE. THE MIDDLE 1/3 BENEATH THE PIPE INVERT SHALL BE LOOSELY PLACED, WHILE THE REMAINDER SHALL BE THOROUGHLY COMPACTED.
 - HAUNCHING: THE HAUNCHING MATERIAL SHALL BE INSTALLED UNIFORMLY IN LIFTS ON EACH SIDE OF THE PIPE AND SHOVELED UNDER THE PIPE ENSURING TO FILL VOIDS. THE MATERIAL SHALL BE THOROUGHLY COMPACTED TO THE SPRING LINE OF THE PIPE EXTENDING TO THE SIDE WALLS OF THE TRENCH ENSURING THAT THE PIPE ALIGNMENT IS NOT DISTURBED.
 - INITIAL BACKFILL: THE INITIAL BACKFILL SHALL PROCEED TO THE TOP OF THE PIPE. THE MATERIAL SHALL BE THOROUGHLY COMPACTED INSTALLED IN UNIFORMED LIFTS ON EACH SIDE OF THE PIPE EXTENDING TO THE SIDE WALLS OF THE TRENCH.
 - FINAL BACKFILL (NON-TRAFFIC): SUITABLE MATERIAL IN NON-TRAFFIC APPLICATIONS (GRASS OR LANDSCAPE AREAS) SHALL BE GENERAL FILL MATERIAL. BACKFILL SHALL PROCEED TO FINISHED GRADE IN 12 INCH LIFTS COMPACTED TO ELIMINATE AIR VOIDS.
 - FINAL BACKFILL (TRAFFIC): SUITABLE MATERIAL IN TRAFFIC APPLICATIONS SHALL BE SELECT FILL COMPACTED IN 8 INCH LOOSE LIFTS TO NOT LESS THAN 95 PERCENT STANDARD PROCTOR.
 - MINIMUM COVER (NON-TRAFFIC): FOR NON-TRAFFIC APPLICATIONS (GRASS OR LANDSCAPE AREAS), MINIMUM COVER IS 12" FROM THE TOP OF PIPE TO GROUND SURFACE.
 - MINIMUM COVER (TRAFFIC): FOR TRAFFIC APPLICATIONS THE MINIMUM COVER IS 12" FOR UP TO 48" DIAMETER PIPE AND 24" OF COVER FOR 60" DIAMETER PIPE, MEASURED FROM TOP OF PIPE TO BOTTOM OF FLEXIBLE PAVEMENT OR TO TOP OF RIGID PAVEMENT.
 - CONTRACTOR SHALL MAINTAIN TRENCH BACKFILL AT GROUND SURFACE UNTIL FINAL ACCEPTANCE OF THE WORK. ALL SURPLUS MATERIALS NOT USED IN BACKFILLING SHALL BE REMOVED AND DISPOSED OF BY CONTRACTOR AT HIS OWN EXPENSE.

3 WATER AND SEWER PIPE INSTALLATION DETAIL
 SCALE: NTS

C-STORE
 LA HIGHWAY 433 (OLD SPANISH TRAIL)
 SLIDELL, LOUISIANA

SHEET REVISIONS:	
#	DATE/REFERENCE

STAMP:
 NOT FOR CONSTRUCTION

SHEET TITLE:
 UTILITY DETAILS

DATE: 12/20/24
 SHEET NUMBER:

C450