

**DESIGN CRITERIA**

THE CONSTRUCTION FOR SAID RESIDENCE, WHERE WIND SPEED IS 140 MILES PER HOUR AND VIBRANT WIND SPEED IS 130 MPH, WIND EXPOSURE ZONE C, IS DESIGNED IN ACCORDANCE WITH AMERICAN FOREST AND PAPER ASSOCIATION (AF&PA) WOOD FRAME CONSTRUCTION MANUAL FOR ONE AND TWO FAMILY DWELLINGS (WFCM) 2001 EDITION AS WELL AS THE INTERNATIONAL RESIDENTIAL CODE (IRC) 2021 EDITION. STRUCTURE SHALL BE BUILT TO THE 2021 INTERNATIONAL ENERGY CONSERVATION CODE (IECC) AND STATE AMENDMENTS ADOPTED JULY 1, 2023.

SQUARE FOOTAGE						WINDOW SCHEDULE						DOOR SCHEDULE						DOOR SCHEDULE							
QTY	DESCRIPTION	UNIT	WIDTH	HEIGHT	FRAME MAT	NOTES	QTY	WIDTH	HEIGHT	THK	DOOR MAT	FRAME MAT	NOTES	QTY	WIDTH	HEIGHT	THK	DOOR MAT	FRAME MAT	NOTES					
1,828	LIVING						W01	3'-0"	6'-0"	VYNIL	WINDOW INSULATED	D01	3'-0"	8'-0"	1-3/4"	WOOD	WOOD	EXTERIOR DOOR WITH WINDOW	D06	2'-0"	8'-0"	1-3/4"	WOOD	WOOD	INTERIOR DOOR
91	FRONT PORCH						W02	3'-0"	4'-0"	VYNIL	WINDOW INSULATED	D02	2'-10"	8'-0"	1-3/4"	WOOD	WOOD	EXTERIOR DOOR WITH WINDOW	D07	(2)2'-6"	8'-0"	1-3/4"	WOOD	WOOD	INTERIOR DOUBLE DOOR
314	REAR PORCH						W03	4'-0"	4'-0"	VYNIL	WINDOW FIXED INSULATED	D03	2'-8"	8'-0"	1-3/4"	WOOD	WOOD	INTERIOR DOOR	D08	2'-10"	8'-0"	1-3/4"	WOOD	WOOD	INTERIOR POCKET DOOR
160	STAIRS AND LANDINGS						W04	3'-0"	1'-0"	VYNIL	WINDOW FIXED INSULATED TRANSOM	D04	2'-6"	8'-0"	1-3/4"	WOOD	WOOD	INTERIOR DOOR	D09	2'-6"	8'-0"	1-3/4"	WOOD	WOOD	INTERIOR HANGING BARN DOOR
2,348	TOTAL																								

NOTE: ALL EXTERIOR WINDOWS AND DOORS ASSEMBLES TO BE RATED FOR 140 MPH WINDS AND SHALL BE MISSILE IMPACT RESISTANT.

NOTE: OWNER TO PICK ALL DOOR STYLES AND COLORS

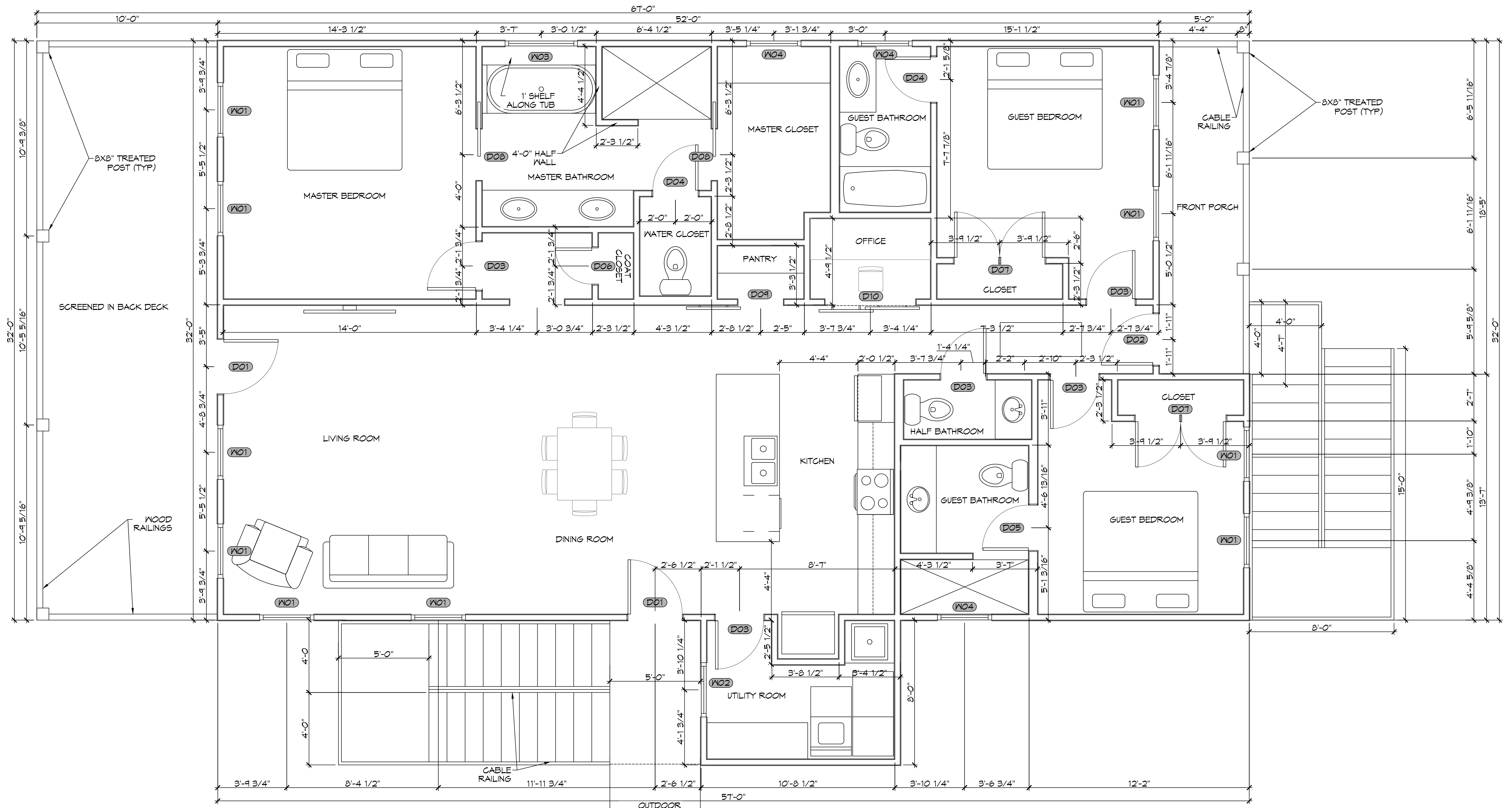

**1ST FLOOR PLAN**  
SCALE: 3/8" = 1'-0"

**DAMMON ENGINEERING, INC.**  
LOUISIANA & MISSISSIPPI  
www.dammonengineering.com  
info@dammonengineering.com  
Chief Engineer: Brian Misch, PE  
554 Old Spanish Trail  
Slidell, LA 70458  
PH: 985-649-5832

#	DESCRIPTION	DATE



**NEW HOUSE PLAN**  
**JASON GUY**  
LOT 229  
MONGA DRIVE, LASKY RIVER ESTATES,  
CONVINGTON, LOUISIANA 70335  
JOB No: DATE: 06-24-2025  
DRAWN BY: CKD CHECKED BY: BAM

SHEET TITLE:  
FLOOR PLAN  
DRAWING NUMBER:  
**A101**  
SHEET No: 8 of 12