

### Ordering Information

Applicable lavatory:		
With hole drillings through back	K-12674	shown
With single-hole drilling through top shelf	K-12672	not shown

### Product Information

Fixture*:		basin area	water depth
Lavatory		356 x 279mm	133mm
Outlet	Ø44mm		
Faucet holes	Ø30mm		
Spout hole	Ø29mm		
* Approximate measurements for comparison only.			

Holes	<b>K-12672</b>		
Spout	Ø29mm		
Faucet	Ø30mm		

Included Components:	
Hanger (1)	64839

### Installation Notes

Refer to installation instructions included with fixture before beginning installation.

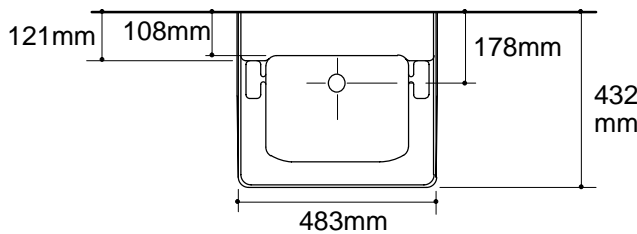

<b>Roughing-In Notes</b>
Fixture dimensions are nominal and conform to tolerances in ASME Standard A112.19.2M.
(T) Pop-up drain typically 365mm, drain typically 343mm.
(S) 203mm (Based on 305mm riser which may require cutting).

