

Plot date and plot times

Plot date and design file names

①	②	③	④
<b>CURVE DATA</b>	<b>CURVE DATA</b>	<b>CURVE DATA</b>	<b>CURVE DATA</b>
Δ=40°00'00"	Δ=40°00'00"	Δ=19°06'56"	Δ=19°06'56"
D=07°30'00"	D=07°30'00"	D=07°02'03"	D=08°06'30"
T=278.05'	T=278.05'	T=137.15'	T=118.98'
L=533.33'	L=533.33'	L=271.75'	L=235.75'
R=763.94'	R=763.94'	R=814.53'	R=706.62'

**SURV. & ABAND. CURVE DATA**  
 P.I.=166+24.66  
 Δ=76°45'56" LT.  
 D=20°20'00"  
 T=223.20'  
 L=377.54'  
 R=281.78'

Scale: 1" = 20'

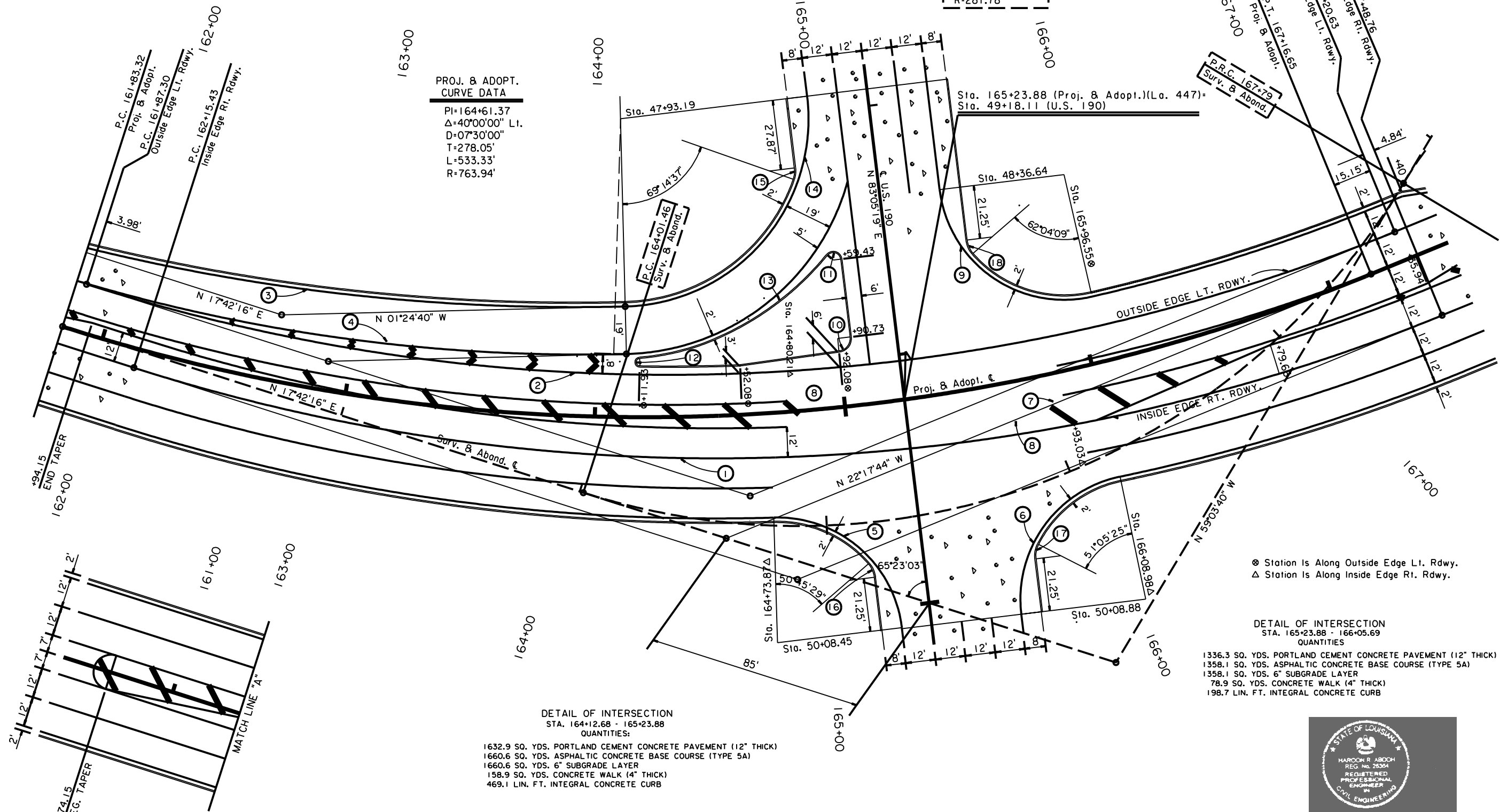

**PROJ. & ADOPT. CURVE DATA**  
 PI=164+61.37  
 Δ=40°00'00" LT.  
 D=07°30'00"  
 T=278.05'  
 L=533.33'  
 R=763.94'

**DETAIL OF INTERSECTION**  
 STA. 164+12.68 - 165+23.88  
 QUANTITIES:  
 1632.9 SQ. YDS. PORTLAND CEMENT CONCRETE PAVEMENT (12" THICK)  
 1660.6 SQ. YDS. ASPHALTIC CONCRETE BASE COURSE (TYPE 5A)  
 1660.6 SQ. YDS. 6" SUBGRADE LAYER  
 158.9 SQ. YDS. CONCRETE WALK (4" THICK)  
 469.1 LIN. FT. INTEGRAL CONCRETE CURB

**DETAIL OF INTERSECTION**  
 STA. 165+23.88 - 166+05.69  
 QUANTITIES:  
 1336.3 SQ. YDS. PORTLAND CEMENT CONCRETE PAVEMENT (12" THICK)  
 1358.1 SQ. YDS. ASPHALTIC CONCRETE BASE COURSE (TYPE 5A)  
 1358.1 SQ. YDS. 6" SUBGRADE LAYER  
 78.9 SQ. YDS. CONCRETE WALK (4" THICK)  
 198.7 LIN. FT. INTEGRAL CONCRETE CURB

CURVE TABLE

CURVE NO.	⑤	⑥	⑦	⑧	⑨	⑩	⑪	⑫	⑬	⑭	⑮	⑯	⑰	⑱
Δ	84°46'03"	85°05'58"	179°06'10"	181°17'36"	96°04'42"	91°45'53"	131°34'43"	174°34'56"	33°40'00"	95°30'00"	26°15'23"	34°00'33"	34°00'33"	34°00'33"
R	50'	50'	6.17'	5.10'	50'	5'	3'	1.5'	116.89'	75'	10'	10'	10'	10'

SHEET NUMBER	63
PARISH	LIVINGSTON
FEDERAL PROJECT	STP-423-1(003), STP-423-1(005)
STATE PROJECT	268-01-001.2, 268-02-001.4
DESIGNED BY	PERAULT
CHECKED BY	H. ABOOH
DATE	March 1993
SHEET	GEOMETRICAL
NO.	
DATE	
REVISION DESCRIPTION	
BY	

LA 447 & U.S. 190  
 GEOMETRIC DETAILS  
 STA. 162+00 - STA. 168+00

STATE OF LOUISIANA  
 HAROON R. ABOOH  
 REG. NO. 20304  
 REGISTERED PROFESSIONAL ENGINEER  
 CIVIL ENGINEERING

Haroon Abdooh  
 10/17/97

ROAD DESIGN

FIGURE 8-48: GEOMETRIC DETAILS