

FRONT ELEVATION



SCOPE OF WORK:

Manufacture & install new channel letters.
Connect to existing electrical.

EXISTING



**SALLY
BEAUTY**

Address 10840
2949 Veterans Memorial Blvd
Suite A4
City Metairie
State LA 70002

Account Representative:
Joleen Martinez

This design and engineering is submitted as our proposal, and the right to use or exhibit in any form, is not authorized without written permission by Vixxo.

Notes

- *
- *
- *
- *

Designer JW
Design # Vx1104955
Original Date 11/15/23
Revision Date 00/00/23

All electrical work to be completed in a U.L. approved method and shall meet current N.E.C. standards.



- * All electrical components shall be U.L. Listed.
- * Sign shall be grounded per N.E.C. Article 250.
- * Insulated conductors as per N.E.C. Code 310.8.
- * type to be used - metallic insulated conductors.
- * Disconnect switch as per N.E.C. Code 600.5.



sign & lighting

page 1

The purchaser agrees to hold the seller harmless against any claims for damages which may occur as a result of drilling for piers and foundations, including but not limited to seismic, gas lines or any underground utilities, which the purchaser or others may deem valuable.

PROPOSED



35'-6"

84"

SCALE: 3/16"=1'-0"

Electrical Notes: All electrical components to be UL approved Customer is responsible for one (1) 120v/20a dedicated circuit with ground per sign within 6' of sign Lock out switch installed at panel box for all electrical signs Install in accordance with N.E.C. article 600 and/or local codes. This includes proper grounding and bonding of signs



**DAMMON
ENGINEERING INC**

30" LINEAR CHANNEL LETTER SET



SCALE: 3/8"=1'-0"

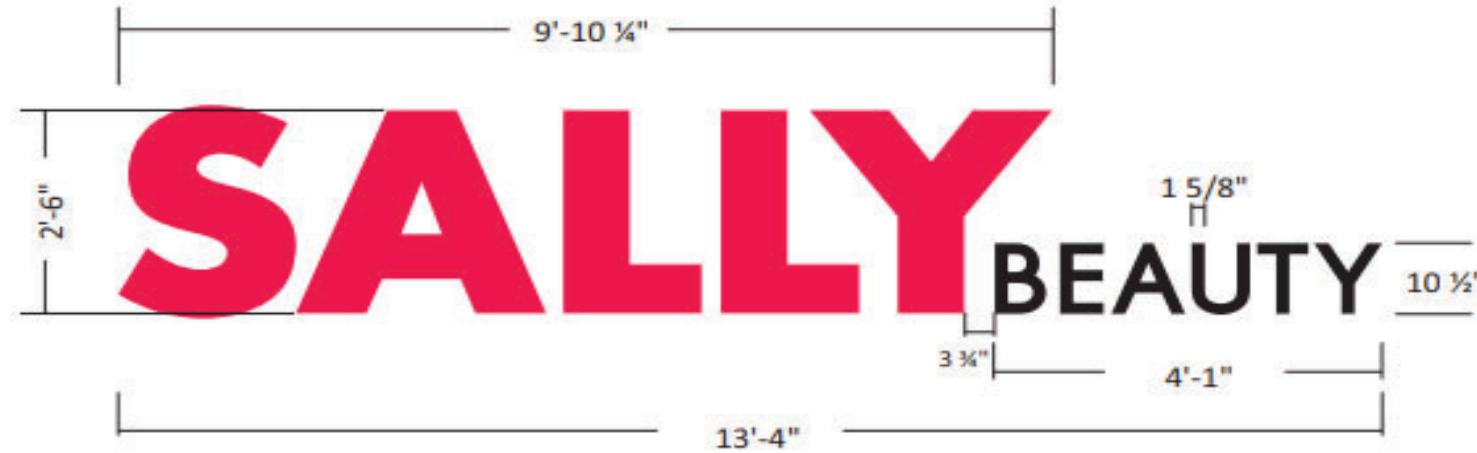

FLUSH MOUNT CHANNEL LETTER SET

33.3 SQUARE FEET

SPECIFICATIONS

1. 3" DEEP .050 ALUMINUM RETURNS PAINTED BLACK.
2. 1" TRIM CAP BLACK.
3. FACES ARE FLAT TRANSLUCENT
 "SALLY" #2793 RED 3/16" PLEX.
 "BEAUTY" #2447 WHITE ACRYLIC WITH 70/30 BLACK PERFORATED VINYL.
4. LETTERS ARE INTERNALLY ILLUMINATED WITH Principal LED:
 Red PL-FS2-RR1-P FOR "SALLY"
 White PL-OP2-SF3-P-TW FOR "BEAUTY"
5. LETTERS ARE MOUNTED FLUSH TO BUILDING WITH NON-CORROSIVE MOUNTING HARDWARE.

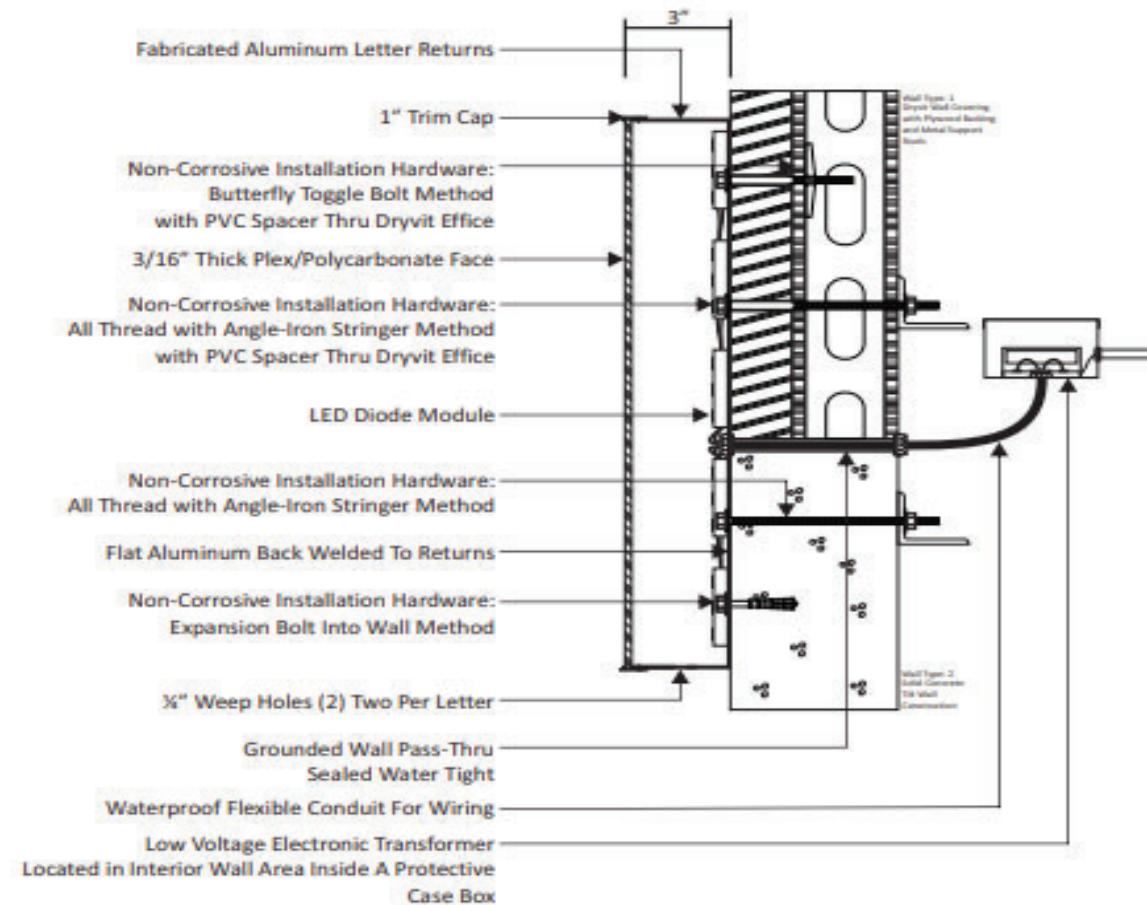

**SALLY
BEAUTY**

Address 10840
 2949 Veterans Memorial Blvd
 Suite A4
 City Metairie
 State LA 70002

Account Representative:
Joleen Martinez

This design and engineering is submitted as our proposal, and the right to use or exhibit in any form, is not authorized without written permission by Vixxo.

Notes

-
-
-
-

Designer JW
 Design # Vx1104955
 Original Date 11/15/23
 Revision Date 00/00/23

All electrical scope to be completed in a U.L. approved method and shall meet current N.E.C. standards.



* All electrical components shall be U.L. listed.
 * Sign shall be grounded per N.E.C. Article 250.
 * Insulated conductors as per N.E.C. Code 310.8.
 type to be used - metallic insulated suitable.
 * Disconnect switch as per N.E.C. Code 600.6.



sign & lighting

page 2

The purchaser agrees to hold the seller harmless against any claim for action for damages which may occur as a result of drilling for pipes and foundations, including but not limited to sewer, gas lines or any underground obstacles which the purchaser or others may deem suitable.

Electrical Notes: All electrical components to be UL approved Customer is responsible for one (1) 120v/20a dedicated circuit with ground per sign within 6' of sign Lock out switch installed at panel box for all electrical signs Install in accordance with N.E.C. article 600 and/or local codes. This includes proper grounding and bonding of signs



PYLON SIGN



SCALE: 1/2"=1'-0"

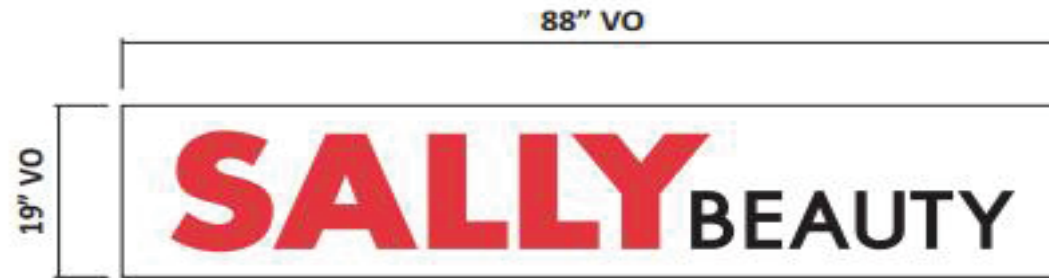

(SAME SIZE FOR OTHER SIDE)

**SALLY
BEAUTY**

TENANT PANELS - VINYL ONLY

(2) TWO REQUIRED

SCOPE OF WORK

1. FABRICATE, SHIP AND INSTALL (2) TWO NEW VINYL GRAPHICS.

SPECIFICATIONS

1. EXISTING FACES ARE WHITE FLEX WITH NEW VINYL OVERLAYS APPLIED FIRST SURFACE.
2. BACKGROUND IS WHITE.
3. SALLY IS TRANSLUCENT RED VINYL.
4. BEAUTY IS OPAQUE BLACK VINYL.

 3M #3630-33 RED VINYL

 3M #180C-12 BLACK VINYL



Address 10840
2949 Veterans Memorial Blvd
Suite A4
City Metairie
State LA 70002

Account Representative:
Joleen Martinez

This design and engineering is submitted as our proposal, and the right to use or exhibit in any form, is not authorized without written permission by Vixxo.

Notes

- *
- *
- *
- *

Designer JW
Design # Vx1104955
Original Date 11/15/23
Revision Date 00/00/23

All electrical work to be completed in a U.L. approved method and shall meet current N.E.C. standards.



* All electrical components shall be U.L. listed.
* Sign shall be grounded per N.E.C. Article 250.
* Insulated conductors as per N.E.C. Code 310.8.
* type to be used - metallic insulated sealable.
* Disconnect switch as per N.E.C. Code 600.8.



sign & lighting

page 3

The purchaser agrees to hold the seller harmless against any claim for action for damages which may occur as a result of drilling the poles and foundations, including but not limited to water, gas lines or any underground obstacles, which the purchaser or others may deem valuable.



Sally Beauty 2949 Veterans Blvd Ste A4 Metairie, LA 70002

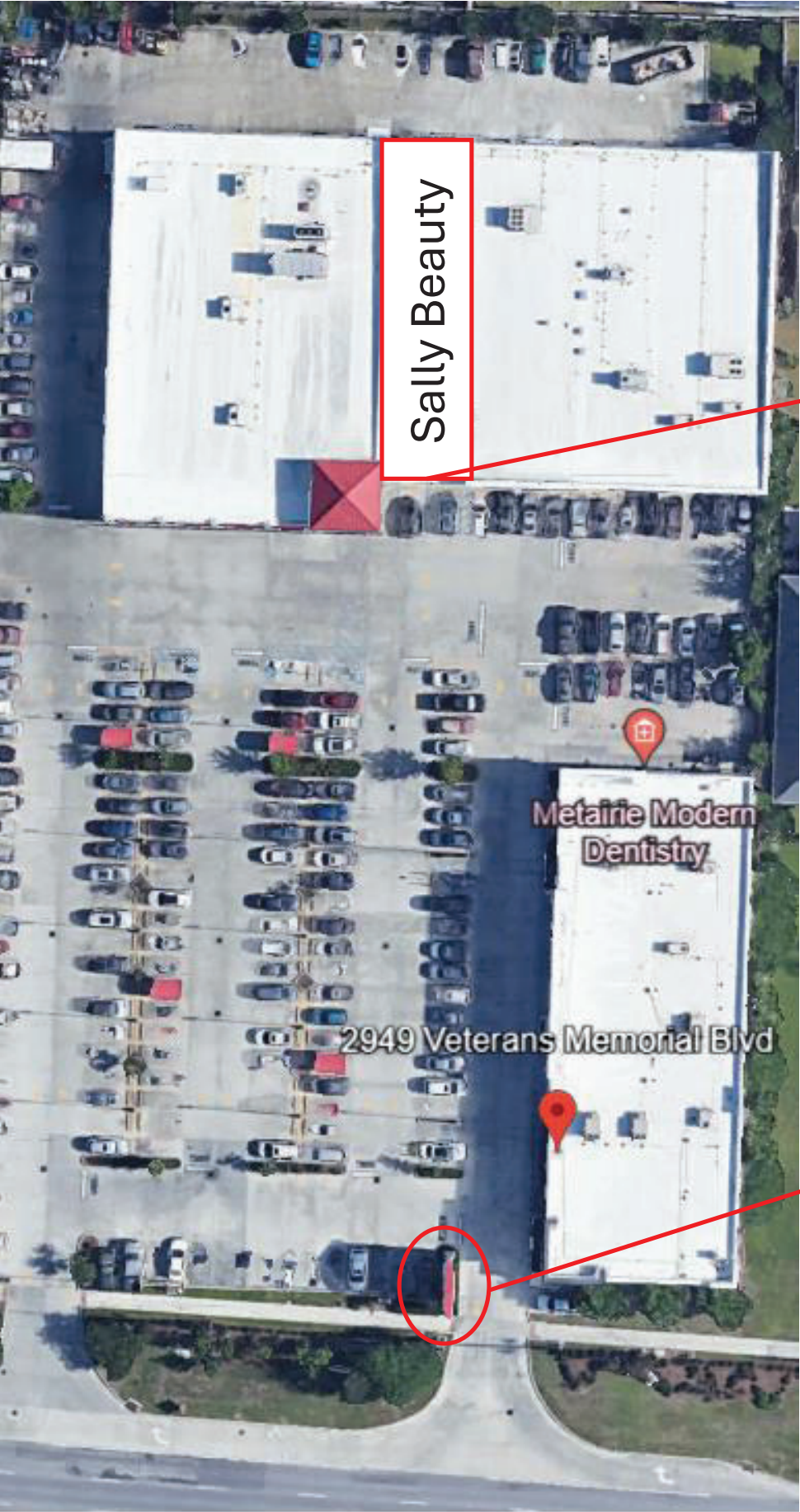

Sally Beauty

Tenant Space Building Sign

Metairie Modern Dentistry

2949 Veterans Memorial Blvd

Multi Tenant Sign Sign Panels (Vinyl Only)