

Builder must check correctness of this drawing PRIOR to erection of this system. This drawing is conceptual and should be used with the Architectural plans to insure proper joist and beam placement. Stairways may be drawn small to allow for adjustments in the field.

BEARING WALLS AND POINT LOADS FROM FLOORS ABOVE DIRECTLY EFFECT SLAB OR FLOORS BELOW AND SHOULD BE ADDRESSED PRIOR TO INSTALLATION OF SLAB OR FLOORS BELOW IF NOT DIRECTLY ADDRESSED IN THESE LAYOUTS

Symbols for reference only. Framers to verify fixture locations for proper joist adjustments.

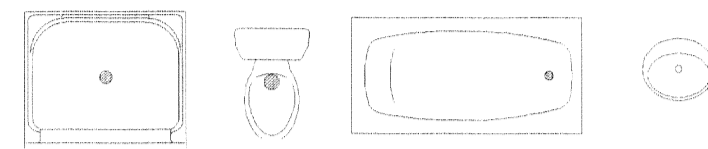

DN01 DO NOT cut, notch or drill flanges

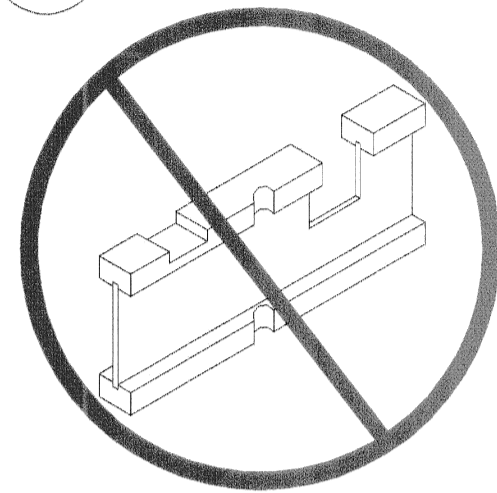

DN03 DO NOT support joist by top flange and/or web.

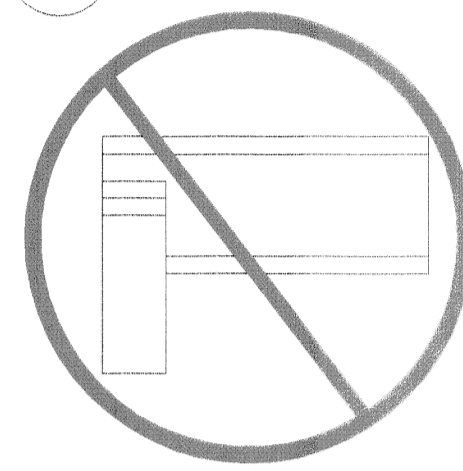

Sill plate to be properly anchored to steel beam

Steel Beam

Backer Block

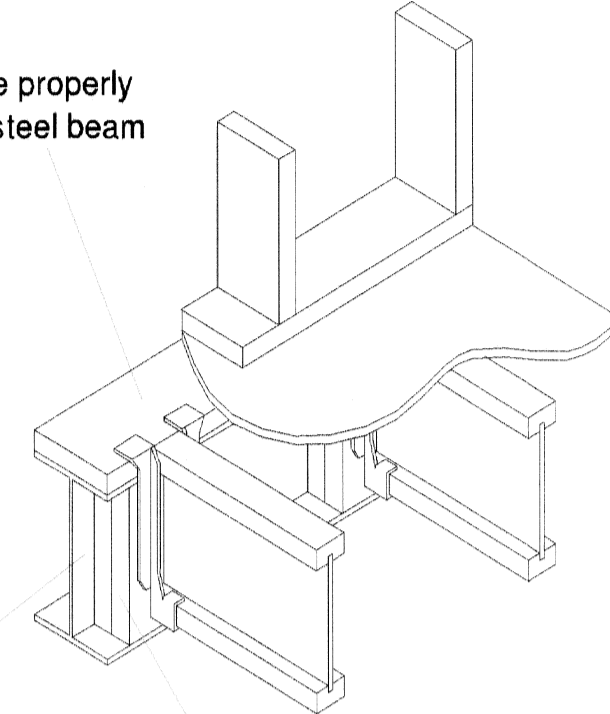

Connector Summary			
PlotID	Qty	Manuf	Product
Hu1	1	Simpson	GLTV 5.516
Hu2	2	Simpson	HGUS7.25/14
Hu3	29	Simpson	ITS2.37/16
Hu4	230	Simpson	ITS2.37/16
Hu5	2	Simpson	ITS2.37/16

PlotID	Net Qty	Product	Length	Piles
1	27	16" BCIB 6000s-1.8	24' 0"	1
2	195	16" BCIB 6000s-1.8	22' 0"	1
3-2	2	16" BCIB 6000s-1.8	22' 0"	2
4	125	16" BCIB 6000s-1.8	20' 0"	1
5	7	16" BCIB 6000s-1.8	12' 0"	1
6	144	16" BCIB 6000s-1.8	10' 0"	1
7	1	16" BCIB 6000s-1.8	4' 0"	1
8	17	16" BCIB 6000s-1.8	22' 0"	1
9-3	6	1-3/4" x 14" VERSALAM® 2.0 3100 2F	13' 0"	1
10-3	3	1-3/4" x 10" VERSALAM® 2.0 3100 2F	11' 0"	1
11-3	6	1-3/4" x 10" VERSALAM® 2.0 3100 2F	11' 0"	1
12-3	3	1-3/4" x 10" VERSALAM® 2.0 3100 2F	14' 0"	1
13-4	32	1-3/4" x 10" VERSALAM® 2.0 3100 2F	15' 0"	1
14-3	3	1-3/4" x 10" VERSALAM® 2.0 3100 2F	15' 0"	1
15-4	9	1-3/4" x 10" VERSALAM® 2.0 3100 2F	10' 0"	1
16-3	3	1-3/4" x 10" VERSALAM® 2.0 3100 2F	11' 0"	1
17-3	3	1-3/4" x 10" VERSALAM® 2.0 3100 2F	14' 0"	1
18	1	1-3/4" x 10" VERSALAM® 2.0 3100 2F	16' 0"	1
19	1	STEEL BEAM BY OTHERS	30' 0"	1
20	1	2" x 4" LVL	12' 0"	1
21	1	2" x 4" LVL	12' 0"	1

**ELP**  
ENGINEERED  
LUMBER PARTNERS  
Clinton, MS  
Phone: 601-925-1782  
Fax: 601-925-1783

NOTE:  
ALL MEASUREMENTS  
TO BE VERIFIED  
IN THE FIELD.

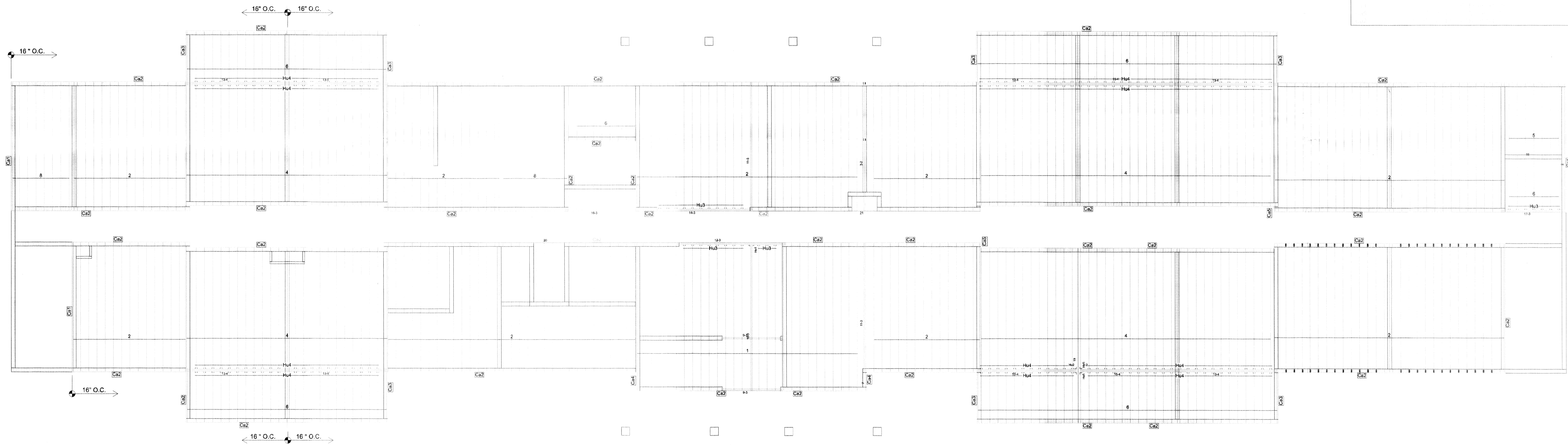

Floor 1

B12-A Side Loaded Connection Double & Triple 1-3/4" Versa-Lam® Nail Pattern

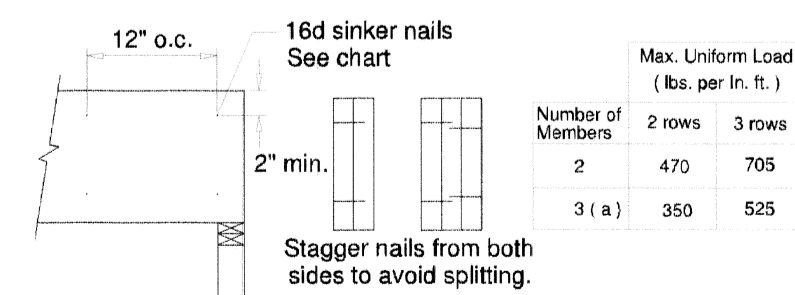

(a) Nail pattern for 3-piece member must occur on both sides. Nail values may be increased by 15% for snow load roofs and by 25% for non-snow load roofs where building code allows.

DN04 DO NOT cut holes near bearing support

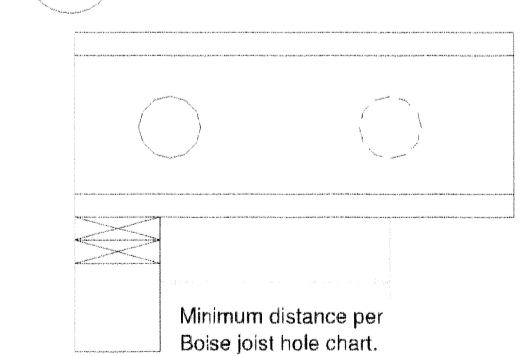

F27 Top Flange Joist Hanger

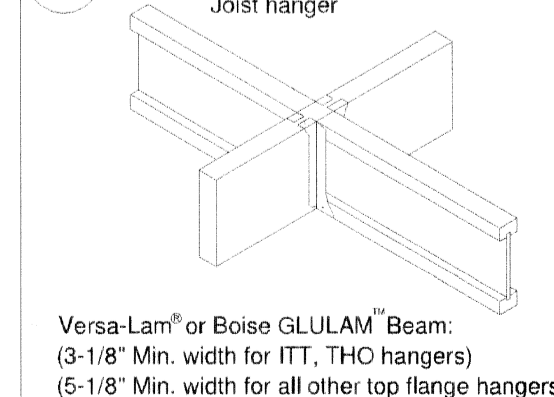

F27 Boise Joist TF Hanger Both Sides

F13-D

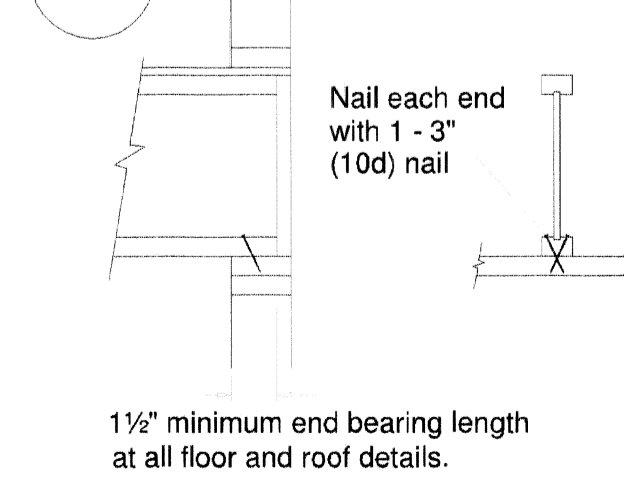

F27-A Top Flange Joist Hanger

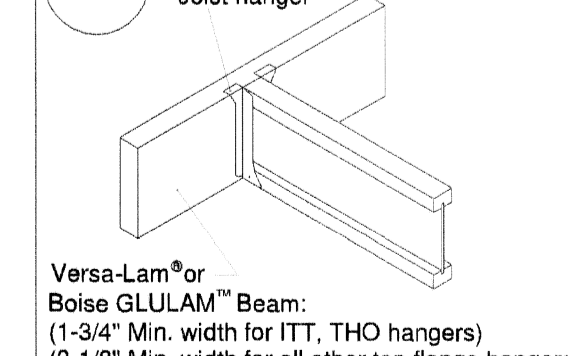

F27-A Boise Joist TF Hanger One Side

F07

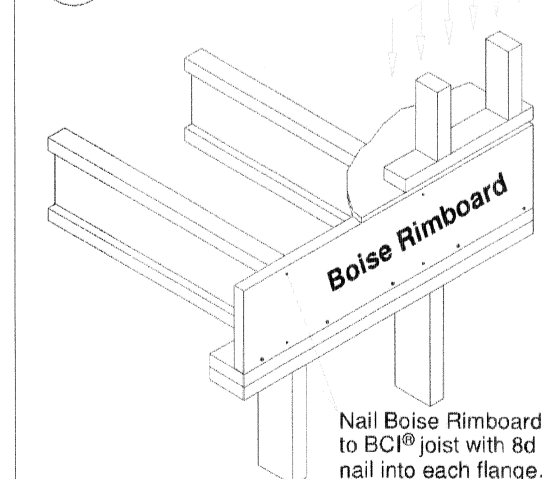

Abita Lumber -  
Mainstay Suites - 700 Main St.  
Hackberry

BC FRAMER  
Scale: N.T.S.  
Date: 6-10-16  
By: Ronnie Talley  
File: 21271  
DWG:  
Sheet: 1/1