

U.S. HIGHWAY NO. 190 (BUS.)
 A.K.A. W. 71ST AVENUE
 ASPHALT

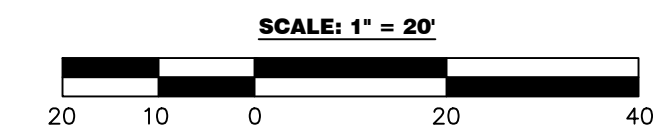

- REFERENCES:**
- 1) SURVEY BY FORTUBERTH SURVEYS INCORPORATED, DATED 12/23/1999.
 - 2) SURVEY OF BARKLEY PARC PHASE 4 FOR RANDALL BROWN & ASSOCIATES, INC., DATED 10/08/2014, MAP FILE NUMBER 53218.
 - 3) SURVEY BY THIS FIRM DATED 02/02/2026, DWG/NO.: 25-119-2.

NOTE: SERVITUDES SHOWN HEREON ARE NOT NECESSARILY EXCLUSIVE SERVITUDES OF RECORD AS SHOWN ON TITLE OPINION OR TITLE POLICY WILL BE ADDED HERETO UPON REQUEST, AS SURVEYOR HAS NOT PERFORMED ANY TITLE SEARCH OR ABSTRACT.

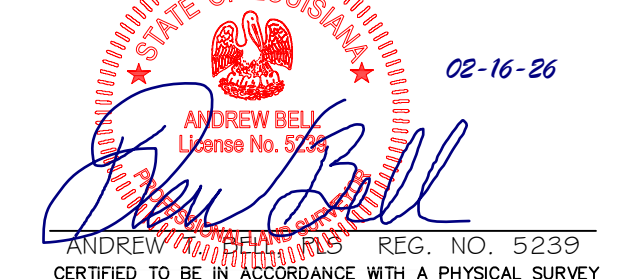

CERTIFIED TO BE IN ACCORDANCE WITH A PHYSICAL SURVEY MADE ON THE GROUND AND COMPLYING WITH THE CURRENT APPLICABLE STANDARDS OF PRACTICE FOR A CLASS "C" SURVEY. RED STAMP SIGNIFIES CORRECT PLAT.

NOTES

- 1) NO ATTEMPT HAS BEEN MADE BY BELCO SURVEYING, LLC TO VERIFY TITLE, ACTUAL LEGAL OWNERSHIPS, SERVITUDES, EASEMENTS, RIGHTS-OF-WAY OR OTHER BURDENS ON THE PROPERTY, OTHER THAN THAT SHOWN ON REFERENCE MAP(S) OR FURNISHED BY THE CLIENT OR HIS REPRESENTATIVE. BE AWARE THAT OTHER SERVITUDES, ENCUMBRANCES OR RESTRICTIONS, EITHER VISIBLE OR NOT VISIBLE, MAY AFFECT THE SUBJECT PROPERTY.
- 2) THE UTILITIES SHOWN WERE LOCATED FROM EXISTING VISIBLE EVIDENCE ON THE GROUND AT THE TIME THE SURVEY FIELDWORK WAS COMPLETED. THIS DOES NOT GUARANTEE THAT ALL THE UTILITIES SHOWN ON THIS SURVEY ARE IN THE CORRECT LOCATION AND THAT SOME UTILITIES MAY NOT BE SHOWN. IT IS THE CONTRACTOR'S RESPONSIBILITY TO COORDINATE WITH LA ONE CALL AND LOCAL UTILITY COMPANIES TO VERIFY EXISTING UTILITIES IN OR ABOVE GROUND. THE SURVEYOR WILL NOT BE HELD RESPONSIBLE FOR ANY UTILITIES THAT WERE NOT LOCATED AT THE TIME OF THE SURVEY.
- 3) BUILDING SETBACK INFORMATION IS NOT SHOWN AND SHOULD BE VERIFIED BEFORE ANY CONSTRUCTION BEGINS.
- 4) THE BASIS OF BEARING FOR THIS SURVEY IS REFERENCED TO THE LOUISIANA STATE PLANE COORDINATE SYSTEM, SOUTH ZONE 1702.
- 5) FLOOD ZONE INFORMATION:
 FLOOD ZONE: "C"
 FIRM PANEL ID: 225205 0230 C
 MAP REVISED: 10/17/1989
- 6) ZONING CLASSIFICATION:
 ZONE: CN - NEIGHBORHOOD COMMERCIAL DISTRICT

LEGEND:

- = 1/2 INCH IRON ROD FOUND
- = 1/2 INCH IRON ROD SET
- ⦿ = 1/2 INCH IRON PIPE FOUND
- ⦿ = 3/4 INCH IRON PIPE FOUND
- ⊙ = POWER POLE
- ⊙ = SEWER MANHOLE
- + 25.00' = SPOT ELEVATION
- = FENCE LINE
- = POWER LINE

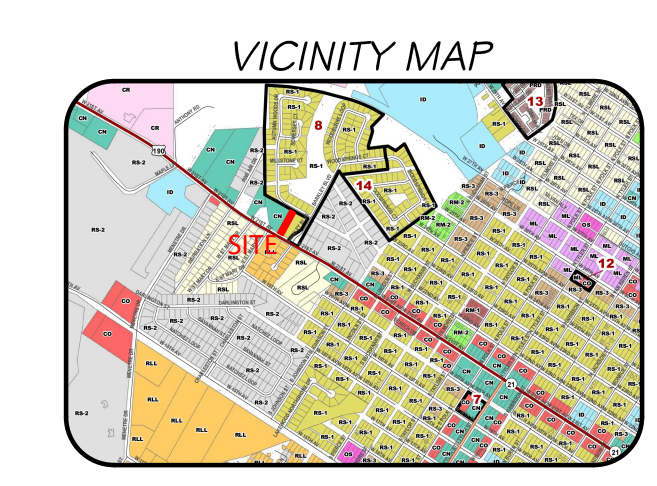

LA One
Local
 Call before you dig.
 1-800-272-3020

SUBSURFACE UTILITY LOCATES WERE NOT REQUESTED AND ARE NOT INCLUDED IN THIS SURVEY. OWNER OR CONTRACTORS ARE RESPONSIBLE FOR CONTACTING LA ONECALL BEFORE DIGGING.



DATE :	02/16/2026
JOB NO. :	25-119
DRAWN BY :	DB
REVISED :	
SCALE :	1" = 20'
PREPARED FOR :	RAWLING CARTER
DWG. NO. :	25-119-3

BELCO SURVEYING, LLC
 (LICENSED IN MS. & LA.)
 50233 TOM BELL ROAD
 FRANKLINTON, LA. 70438
 985-295-9433

TOPOGRAPHIC SURVEY OF
 LOT 1-A-2-1 (0.913 ACRES) OF
 BLOCK 3 OF THE J.H. WARNER ESTATE IN
 SECTION 32, T-6-S, R-1-E,
 IN THE CITY OF COVINGTON,
 ST. TAMMANY PARISH, LOUISIANA