

**FOUNTAINS
DOCTOR'S OFFICE**

9.29.17
FOUNTAINS BLVD.
MADISON, MS 39110

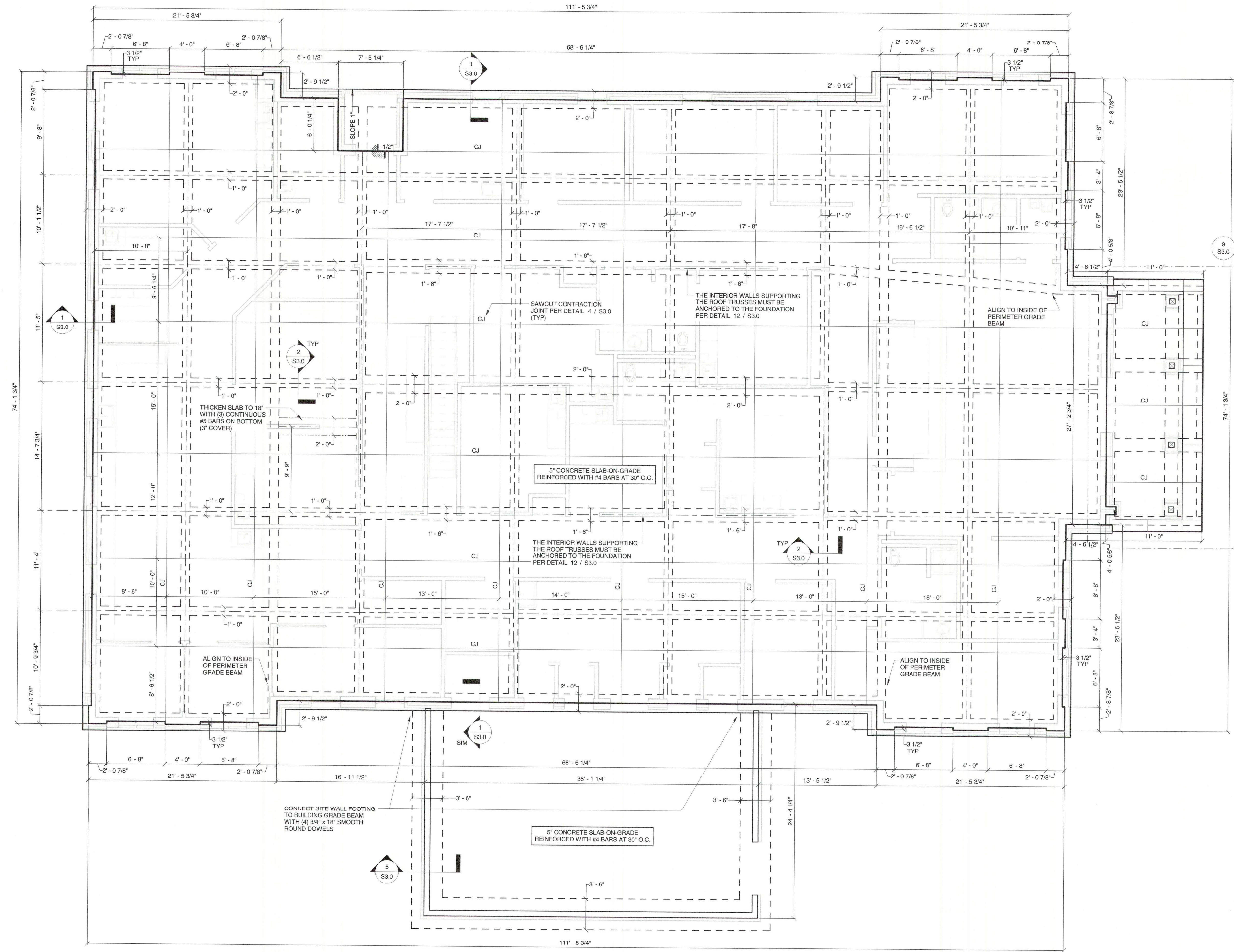

FOUNDATION PLAN
3/16" = 1'-0"

- FOUNDATION NOTES:**
1. PROVIDE CORNER BARS AT ALL GRADE BEAM INTERSECTIONS PER DETAIL 6 / S3.0
 2. PROVIDE REINFORCEMENT AROUND ALL SLAB BLOCKOUTS AND PENETRATIONS, INCLUDING PLUMBING PIPES, PER DETAIL 7 / S3.0
 3. SEE DETAIL 8 / S3.0 FOR PLUMBING PENETRATIONS IN GRADE BEAMS



SEPTEMBER 29, 2017
CONSTRUCTION DOCUMENTS
WBA #: 2217

NO.	REVISIONS DESCRIPTION	DATE

S2.0
FOUNDATION PLAN

