

FILE NAME: J:\1 - RESIDENTIAL\Drawings\Drawings\01 - Plan\01 - Plan.dwg DATE: 02-26-2024 10:46:00

WINDOW SCHEDULE					DOOR SCHEDULE						
MK	WIDTH	HEIGHT	FRAME MAT	NOTES	MK	WIDTH	HEIGHT	THK	DOOR MAT	FRAME MAT	NOTES
W01	3'-0"	5'-0"	ALUM	NEW WINDOW INSULATED	D01	3'-0"	6'-8"	1-3/4"	WOOD	WOOD	NEW EXTERIOR DOOR WITH SIDE LITES AND TRANSOM
W02	(2)3'-0"	5'-0"	ALUM	NEW WINDOW INSULATED	D02	3'-0"	6'-8"	1-3/4"	WOOD	WOOD	NEW INTERIOR DOOR
W03	2'-0"	4'-0"	ALUM	NEW WINDOW INSULATED	D03	2'-10"	6'-8"	1-3/4"	WOOD	WOOD	NEW INTERIOR DOOR
W04	4'-0"	5'-0"	ALUM	NEW WINDOW INSULATED	D04	2'-8"	6'-8"	1-3/4"	WOOD	WOOD	NEW INTERIOR DOOR
W05	2'-0"	5'-0"	ALUM	NEW WINDOW INSULATED	D05	2'-6"	6'-8"	1-3/4"	WOOD	WOOD	NEW INTERIOR DOOR
W06	4'-0"	3'-0"	ALUM	NEW WINDOW INSULATED WITH TRANSOM	D06	2'-4"	6'-8"	1-3/4"	WOOD	WOOD	NEW INTERIOR DOOR
W07	3'-6"	5'-0"	ALUM	NEW WINDOW WITH SIDE LITES	D07	(2)2'-0"	6'-8"	1-3/4"	WOOD	WOOD	NEW EXTERIOR FRENCH DOOR

**DESIGN CRITERIA**  
 THE CONSTRUCTION FOR SAID RESIDENCE, WHERE WIND SPEED IS 150 MILES PER HOUR AND V<sub>50</sub> WIND SPEED IS 130 MPH, WIND EXPOSURE ZONE C, IS DESIGNED IN ACCORDANCE WITH: AMERICAN FOREST AND PAPER ASSOCIATION (AF&PA) WOOD FRAME CONSTRUCTION MANUAL FOR ONE AND TWO FAMILY DWELLINGS (WFCM) 2001 EDITION AS WELL AS THE INTERNATIONAL RESIDENTIAL CODE (IRC) 2021 EDITION.

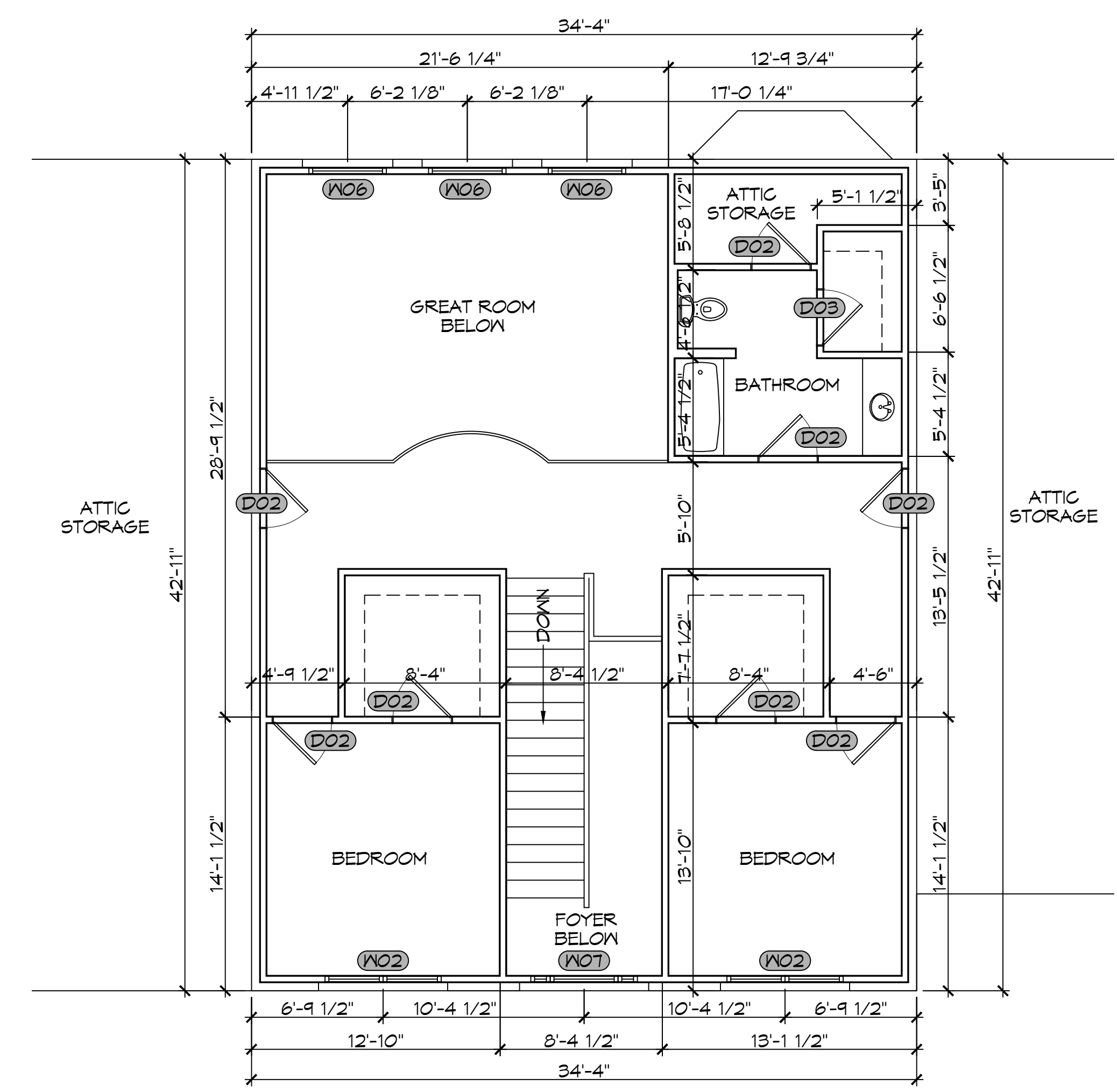
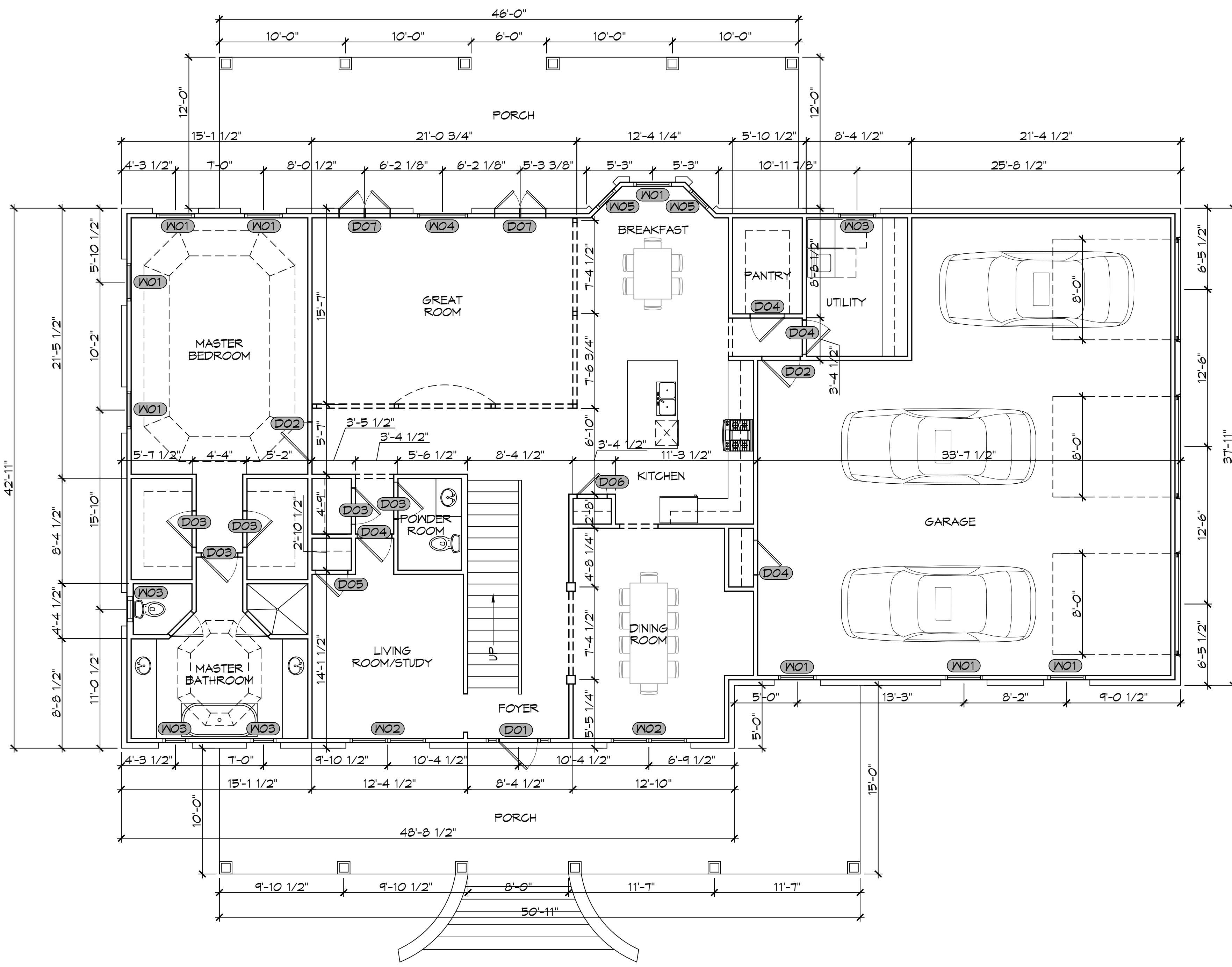

**DAMMON ENGINEERING, INC.**  
 LOUISIANA & MISSISSIPPI  
 Chief Engineer: Brian Metch, PE  
 554 Old Spanish Trail  
 Slidell, LA 70458  
 www.dammonengineering.com  
 info@dammonengineering.com  
 PH: 985.649.5832

#	DESCRIPTION	DATE

**DARRELL JOSEPH**  
 HOUSE PLAN  
 SHEET TITLE: FLOOR PLAN  
 DRAWING NUMBER:  
 DATE: 02-26-2024  
 CHECKED BY: SKJ  
 DRAWN BY: CKD

**A101**  
 SHEET No: 1 of 2

