

LIFE-SAFETY INFORMATION

APPLICABLE CODES
 NFPA 101 LIFE-SAFETY CODE 2015
 OCCUPANCY A-2, ASSEMBLY USES INTENDED FOR FOOD AND DRINK CONSUMPTION (RESTAURANTS); CONSTRUCTION TYPE V B ASSEMBLY (CHAPTER 13)

MIXED OCCUPANCY (REFERENCE CHAPTER 6)
OCCUPANT LOAD FACTOR (REFERENCE TABLE 7.3.1.2)

DINING	966 S.F. NET	ASSEMBLY WITHOUT FIXED SEATS - UNCONCENTRATED (TABLES AND CHAIRS) - 15 NET PER OCCUPANT =	64 OCCUPANTS
KITCHEN AREA	503 S.F.	100 S.F. / PERSON	5 OCCUPANTS

TOTAL OCCUPANTS = 69

CLASSIFICATION OF HAZARD OF CONTENTS
 REFERENCE: OCCUPANCY CHAPTER AND 8.2.2; SPECIFY LOW, ORDINARY, OR HIGH

CONSTRUCTION TYPE(S) (REFERENCE: CHAPTERS, TABLE A.5.2.1.2 AND COMMENTARY TABLE 8.1 IN HANDBOOK)
 CONST. TYPE: 5(000)

MINIMUM EXIT SEPARATION DISTANCE FOR REMOTELY LOCATED EXITS
 REFERENCE: SECTION 7.5; SPECIFY 1/2 OR 1/3 DIAGONAL DISTANCE OF AREA SERVED)

1/2 DIAGONAL DINING =	83.75 FT / 2 =	41.88 FT
1/3 DIAGONAL KITCHEN =	65.5 FT / 2 =	32.75 FT

MAXIMUM DEAD-END CORRIDORS (REFERENCE: OCCUPANCY CHAPTER AND TABLE A.7.6)
MAXIMUM COMMON PATH OF TRAVEL DISTANCE (REFERENCE: OCCUPANCY CHAPTER AND TABLE A.7.6)
MAXIMUM TRAVEL DISTANCE TO EXITS (REFERENCE: OCCUPANCY CHAPTER AND TABLE A.7.6)

MAIN ENTRANCE MUST BE SIGNED TO ACCOMMODATE 1/2 OCCUPANT LOAD OF BUILDING

EXTINGUISHMENT REQUIREMENTS SPRINKLER (NOT REQUIRED)
DETECTION, ALARM, AND COMMUNICATION SYSTEMS NO
ALLOWABLE HEIGHT AND BUILDING AREA PER IBC EQUIVALENT CONSTRUCTION TYPE

BUILDING CODE INFORMATION

APPLICABLE CODES
 IBC 2021

OCCUPANCY A-2, ASSEMBLY USES INTENDED FOR FOOD AND DRINK CONSUMPTION (RESTAURANTS) (IBC 2015 CHAPTER 10)

OCCUPANT LOAD CALCULATIONS (TABLE 1004.1.2)

ASSEMBLY - UN-CONCENTRATED (TABLES AND CHAIRS)	966 S.F. NET	15 NET / OCCUPANT	64 OCCUPANTS
SERVING AREA	503 S.F. GROSS	100 S.F. GROSS / OCCUPANT	5 OCCUPANTS

TOTAL OCCUPANTS = 69

CONSTRUCTION TYPE(S) (TABLE 503)
 V B (SECTION 503)

ALLOWABLE HEIGHT AND BUILDING AREA LIMITED BY TYPE OF CONSTRUCTION

MAXIMUM HEIGHT IN FEET (SECTION 503 & 504, TABLE 503)		40
MAXIMUM AREA IN SQUARE FEET (SECTION 503, 506 & 507, TABLE 503)	MULTI STORY NON-SPRINKLED	6,000 S.F.
ALLOWABLE BUILDING AREA WITH FRONTAGE INCREASE		8,160 S.F.

WIND SPEED DESIGN REQUIREMENTS

IMPROVEMENTS TO THIS BUILDING SHALL BE DESIGNED WITH IBC SEC 1609 AS A FULLY ENCLOSED BLDG USING THE FOLLOWING INFORMATION:

WIND DESIGN DATA:
 DETERMINATION OF WIND LOADS SHALL BE IN ACCORDANCE WITH IBC SEC 1609.3 (A), (B), OR (C) DEPENDING ON THE RISK CATEGORY

ULTIMATE WIND SPEED =	138MPH (IBC FIG 1609C)	NOMINAL WIND SPEED =	V _{asd} = 105 MPH
RISK FACTOR =	CATEGORY 2	SURFACE ROUGHNESS =	C
TOPOGRAPHIC FACTOR =	1	EXPOSURE =	C

INTERNAL PRESSURE COEFFICIENT (ASCE 7-10 TABLE 26.11-1): ± 0.18

LIVE LOADS (IBC SEC 1607)

DINING ROOMS AND RESTAURANTS (IBC TABLE 1607.1):	100 PSF
ASSEMBLY PLATFORMS (IBC TABLE 1607.1):	100 PSF
ROOF LIVE LOADS (IBC TABLE 1607.1):	20 PSF UNIFORM, 300 LB CONCENTRATED
SNOW LOADS (IBC TABLE 1608):	
GROUND SNOW LOAD (IBC FIG 1608.2):	5 PSF

FLOOD ZONE INFORMATION

BASED ON THE LSU AGRICULTURE FLOOD MAP THIS PROPERTY IS NOT IN A FLOOD ZONE

FIRM, COMMUNITY NO. 22089C135D DATE: 11/09/2012

FLOOD ZONE: N/A BASE FLOOD ELEVATION: N/A

ELEVATIONS REFER TO NGVD 1929 DATUM

LIFE-SAFETY LEGEND

SYMBOL	DESCRIPTION
➤	EXITS
(45)	DOOR FIRE RATINGS (MINUTES)
(36) (170)	DOOR WIDTH/EGRESS CAPACITY
☒	EXIT LIGHT
• FE	FIRE EXTINGUISHER W/ WALL MTD BRACKET
—	COMMON PATH OF TRAVEL
••••••••••	TRAVEL DISTANCE
●	DECISION POINT

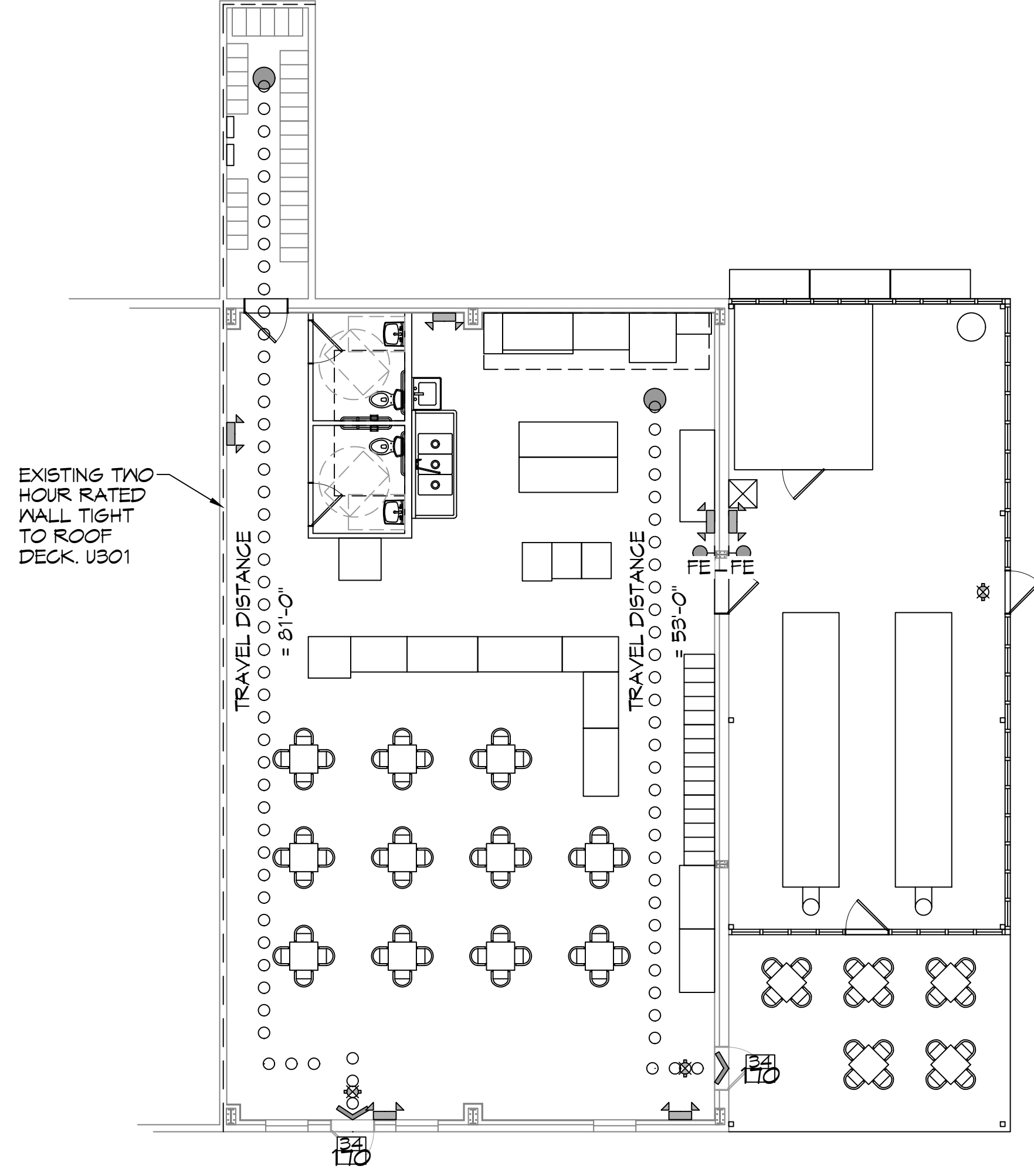

VICINITY MAP



SHEET INDEX

SHEET #	SHEET TITLE
G101	COVER PAGE
G102	ADAAG INFORMATION
C101	EXISTING SITE PLAN
S101	FOUNDATION PLAN
D101	DEMO PLAN
A101	FLOOR PLAN
A102	BUILDING ELEVATIONS
A103	REFLECTED CEILING PLAN
P101	PLUMBING PLAN AND DETAILS
M101	MECHANICAL PLAN
M102	MECHANICAL SCHEDULES AND DETAILS
E101	ELECTRICAL POWER PLAN
E102	ELECTRICAL LIGHTING PLAN
E103	PANEL SCHEDULE RISER

SCOPE OF WORK

1. THIS IS AN EXISTING SUITE THAT WILL BE UTILIZED AS RESTAURANT WITH OUTDOOR SEATING. NEW COOKING EQUIPMENT WITH DISPLAYS, CABINETS AND SINKS WILL BE INSTALLED TO MEET THE HEALTH DEPARTMENT REQUIREMENTS. TOTAL SQ. FT. = 9,467

GENERAL NOTES

- ALL MATERIALS AND WORK, INCIDENTAL TO THE CONSTRUCTION OF THIS PROJECT, SHALL CONFORM TO ALL GOVERNING CODES, AND REGULATIONS OF AGENCIES IN AUTHORITY.
- CONTRACTOR SHALL PROVIDE ALL PUBLIC PROTECTIONS NECESSARY AS REQUIRED BY LAW.
- THE DRAWINGS AND ANY SUBSEQUENTLY ISSUED ADDENDA, AMENDMENTS OR SUCH CHANGE ORDERS APPROVED BY THE OWNER AND THE CONTRACTOR ARE PART OF THESE CONTRACT DOCUMENTS.
- DO NOT SCALE DRAWINGS. CONSULT WITH THE ENGINEER REGARDING ANY ITEMS IN THE CONTRACT DOCUMENTS THAT REQUIRE CLARIFICATION.
- TRASH SHALL BE REMOVED FROM THE SITE NOT LESS THAN TWICE MONTHLY.
- THE GENERAL CONTRACTOR SHALL VERIFY EXISTING CONDITIONS PRIOR TO COMMENCING WORK AND REPORT ANY AND ALL DISCREPANCIES TO THE ARCHITECT.
- CONTRACTOR VEHICLES AND EQUIPMENT NECESSARY FOR CONSTRUCTION MAY BE PARKED ON THE SITE. OTHER VEHICLES PARKED ON THE SITE REQUIRE THE OWNER'S PERMISSION.
- ALL MATERIALS/EQUIPMENT SHALL BE INSTALLED PER MANUFACTURER'S RECOMMENDATIONS. WORK NOT CONSISTENT WITH MANUFACTURER'S RECOMMENDATIONS WILL BE REJECTED.

DAMMON ENGINEERING, INC.
 LOUISIANA & MISSISSIPPI
 Chief Engineer: Brian Mistich, PE
 554 Old Spanish Trail
 Slidell, LA 70688
 www.dammonengineering.com
 info@dammonengineering.com
 PH: 985.649.5832

#	DESCRIPTION	DATE

SEAL:

RESTAURANT
 GONZOS SMOKEHOUSE & BBQ
 13948 RIVER RD
 LULING, LA 70070
 JOB NO.:
 DATE: 04/03/2025
 DRAWN BY: JMS
 CHECKED BY: CKD

GENERAL INFORMATION SHEET

DRAWING NUMBER:
G101
 SHEET No: 1 of 14