

ZONING
C-2 IN OLD TOWN PRESERVATION DISTRICT
FLOOD ZONE
ZONE: AE9

DAMMON
ENGINEERING, INC.
LOUISIANA & MISSISSIPPI

Chief Engineer: Brian Watch, PE
554 Old Spanish Trail
Slidell, LA 70468
www.dammonengineering.com
info@dammonengineering.com
PH: 985.649.9332

#	DESCRIPTION	DATE

SEAL:

1 EXISTING OVERALL SITE PLAN
SCALE: 1" = 50'-0"

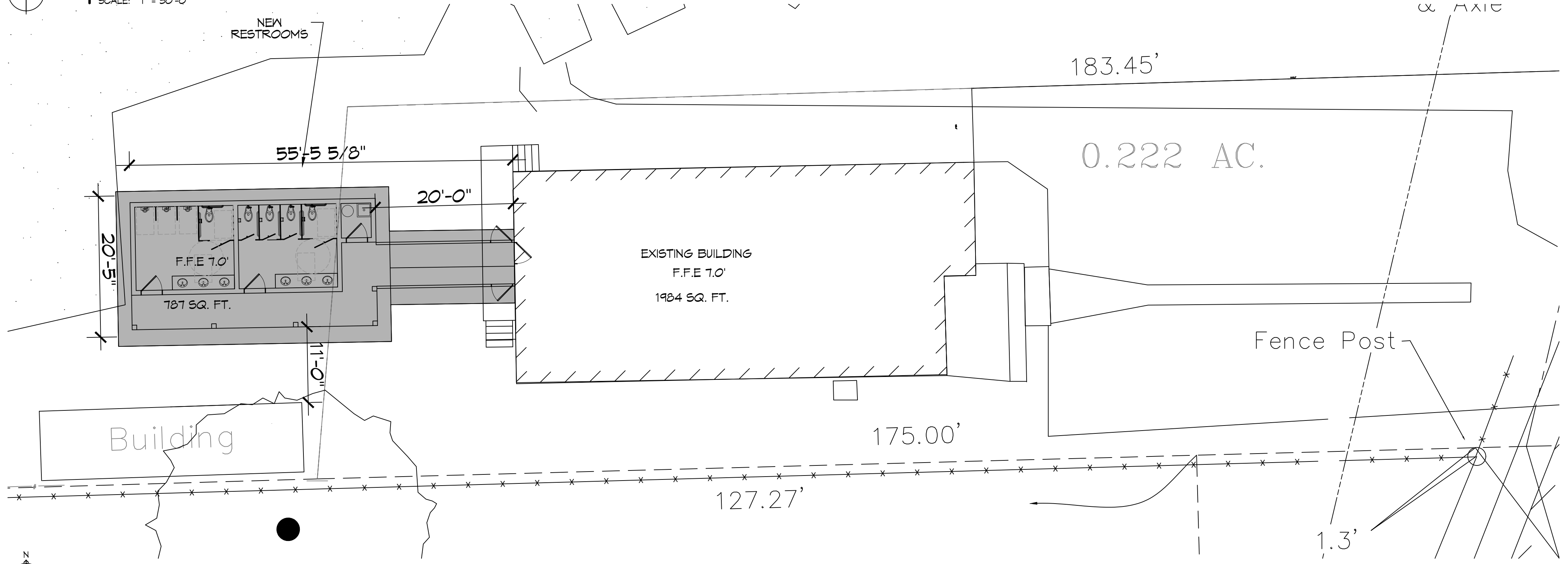

2 ENLARGED AREA PLAN
SCALE: 1" = 10'-0"

NEW RESTROOMS

PALMETTOS ON THE BAYOU

1901 BAYOU LN.
SLIDELL, LA 70459
JOB No: 2024 | DATE: 02-21-2024
DRAWN BY: JWS | CHECKED BY: CKD

SHEET TITLE:
EXISTING OVERALL SITE PLAN

DRAWING NUMBER:

C101

SHEET No: 1 of 2