

LIFE-SAFETY INFORMATION

APPLICABLE CODES	
NFPA 101 LIFE-SAFETY CODE 2015	
OCCUPANCY TYPE(S) AND CHAPTER(S)	
BUSINESS (CHAPTER 5B)	
MULTIPLE, MIXED, OR SEPARATE OCCUPANCY (REFERENCE CHAPTER 6)	
N/A	
OCCUPANT LOAD FACTOR (REFERENCE TABLE 7.3.1.2)	
2,824 SF / 500 SF PER OCCUPANT = 6 OCCUPANTS	
CLASSIFICATION OF HAZARD OF CONTENTS	
(REFERENCE: OCCUPANCY CHAPTER AND 6.2.2: SPECIFY LOW, ORDINARY, OR HIGH)	
CONSTRUCTION TYPE(S) (REFERENCE: CHAPTER 8, TABLE A.8.2.1.2 AND COMMENTARY TABLE 8.1 IN HANDBOOK)	
2B	
MINIMUM EXIT SEPARATION DISTANCE FOR REMOTELY LOCATED EXITS	
(REFERENCE: SECTION 7.5; SPECIFY 1/2 OR 1/3 DIAGONAL DISTANCE OF AREA SERVED)	
1/2 DIAGONAL = 43'-8"	
MAXIMUM DEAD-END CORRIDORS (REFERENCE: OCCUPANCY CHAPTER AND TABLE A.7.6)	
50'	
MAXIMUM COMMON PATH OF TRAVEL DISTANCE (REFERENCE: OCCUPANCY CHAPTER AND TABLE A.7.6)	
50'	
MAXIMUM TRAVEL DISTANCE TO EXITS (REFERENCE: OCCUPANCY CHAPTER AND TABLE A.7.6)	
200'	
EXTINGUISHMENT REQUIREMENTS SPRINKLERED	
DETECTION, ALARM, AND COMMUNICATION SYSTEMS NO	
ALLOWABLE HEIGHT AND BUILDING AREA PER IBC EQUIVALENT CONSTRUCTION TYPE	

BUILDING CODE INFORMATION

APPLICABLE CODES	
BC 2021	
BUSINESS GROUP 5-1 (IBC 2021 CHAPTER 5)	
OCCUPANT LOAD CALCULATIONS (TABLE 1004.1.1)	
STORAGE 2,824 SQ FT 500 SF PER OCCUPANT (GROSS) 6 OCCUPANTS	
CONSTRUCTION TYPE(S) (TABLE 504)	
2B (SECTION 504)	
ALLOWABLE HEIGHT AND BUILDING AREA LIMITED BY TYPE OF CONSTRUCTION	
MAXIMUM HEIGHT IN STORIES (SECTION 504.4) 2	
MAXIMUM AREA IN SQUARE FEET (SECTION 503, 506 & 507, TABLE 503) 17,500	

WIND SPEED DESIGN REQUIREMENTS

THIS BUILDING SHALL BE DESIGNED WITH IBC SEC 1609 AS A FULLY ENCLOSED BLDG USING THE FOLLOWING INFORMATION:

WIND DESIGN DATA:

DETERMINATION OF WIND LOADS SHALL BE IN ACCORDANCE WITH IBC SEC 1609.3 (1), (2), OR (3) DEPENDING ON THE RISK CATEGORY

WIND SPEED V_{ULT} (3 SECOND GUST) = 140 MPH (IBC FIG 1609.3(1))

NOMINAL DESIGN WIND SPEED V_{50ft} = 110 MPH (V_{ULT} x (0.6)^{1/2})

RISK CATEGORY: CATEGORY II BLDG SURFACE ROUGHNESS = B

TOPOGRAPHIC FACTOR = 1 EXPOSURE = B

DESIGN WIND PRESSURE (ASCE 7-10 TABLE 28.6-1): 31.1 PSF

INTERNAL PRESSURE COEFFICIENT (ASCE 7-10 TABLE 28.11-1): ± 0.18

LIVE LOADS (IBC SEC 1607)

STORAGE WAREHOUSE - HEAVY (IBC TABLE 1607.1): 250 PSF

ROOF LIVE LOADS (IBC TABLE 1607.1): 20 PSF UNIFORM, 300 LB CONCENTRATED

SNOW LOADS (IBC SEC 1608): 5 PSF

GROUND SNOW LOAD (IBC FIG 1608.2): 5 PSF

FLOOD ZONE INFORMATION

BASED ON THE SURVEY OF THIS PROPERTY BY J.V. BURKES, THIS PROPERTY IS NOT IN SPECIAL FLOOD HAZARD AREA

FIRM, COMMUNITY NO. 225205 0415 C DATED 04/02/1991

FLOOD ZONE: C BASE FLOOD ELEVATION: N/A

LIFE-SAFETY LEGEND

SYMBOL	DESCRIPTION
>	EXITS
(45)	DOOR FIRE RATING (MINUTES)
(36/170)	DOOR WIDTH/EGRESS CAPACITY
⊗	EXIT LIGHT
⊕ FE	FIRE EXTINGUISHER IV WALL MTD BRACKET
.....	COMMON PATH OF TRAVEL
.....	TRAVEL DISTANCE
●	DECISION POINT

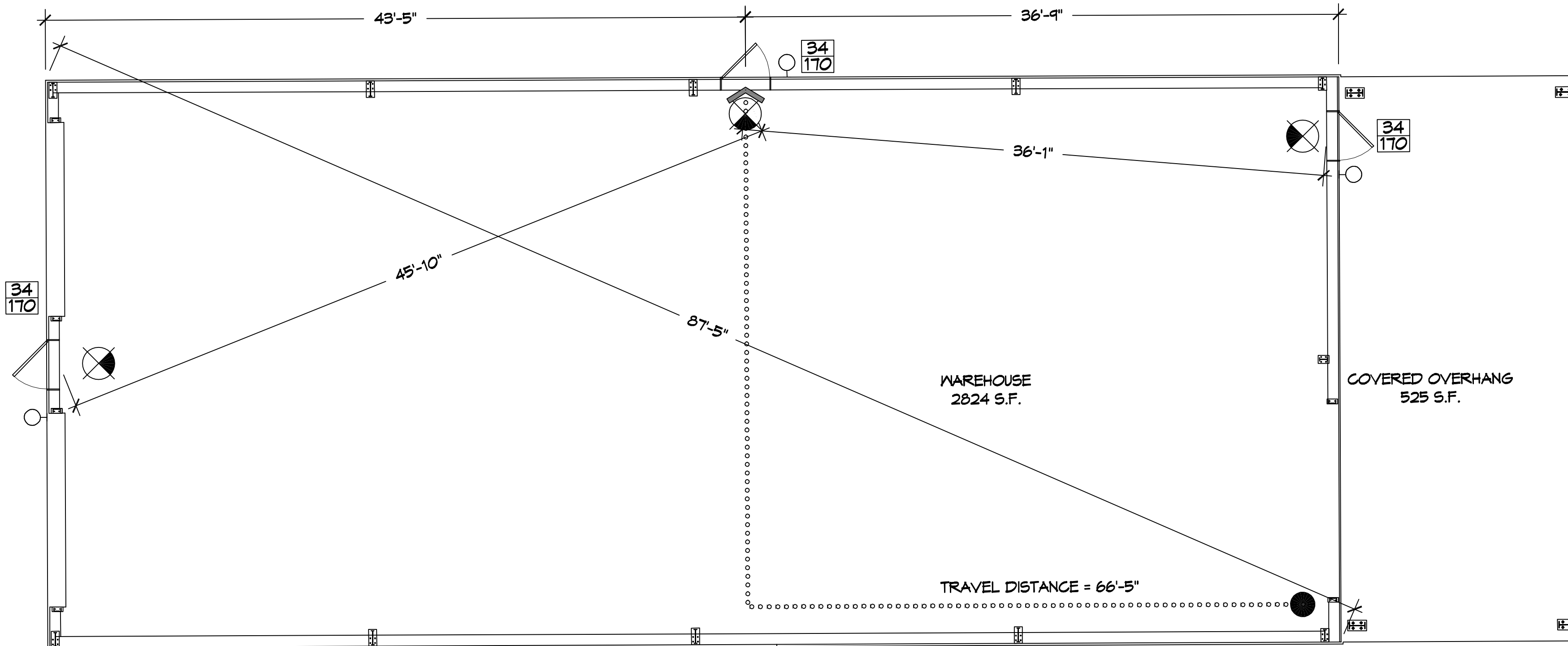

LIFE-SAFETY PLAN
SCALE: 3/16" = 1'-0"

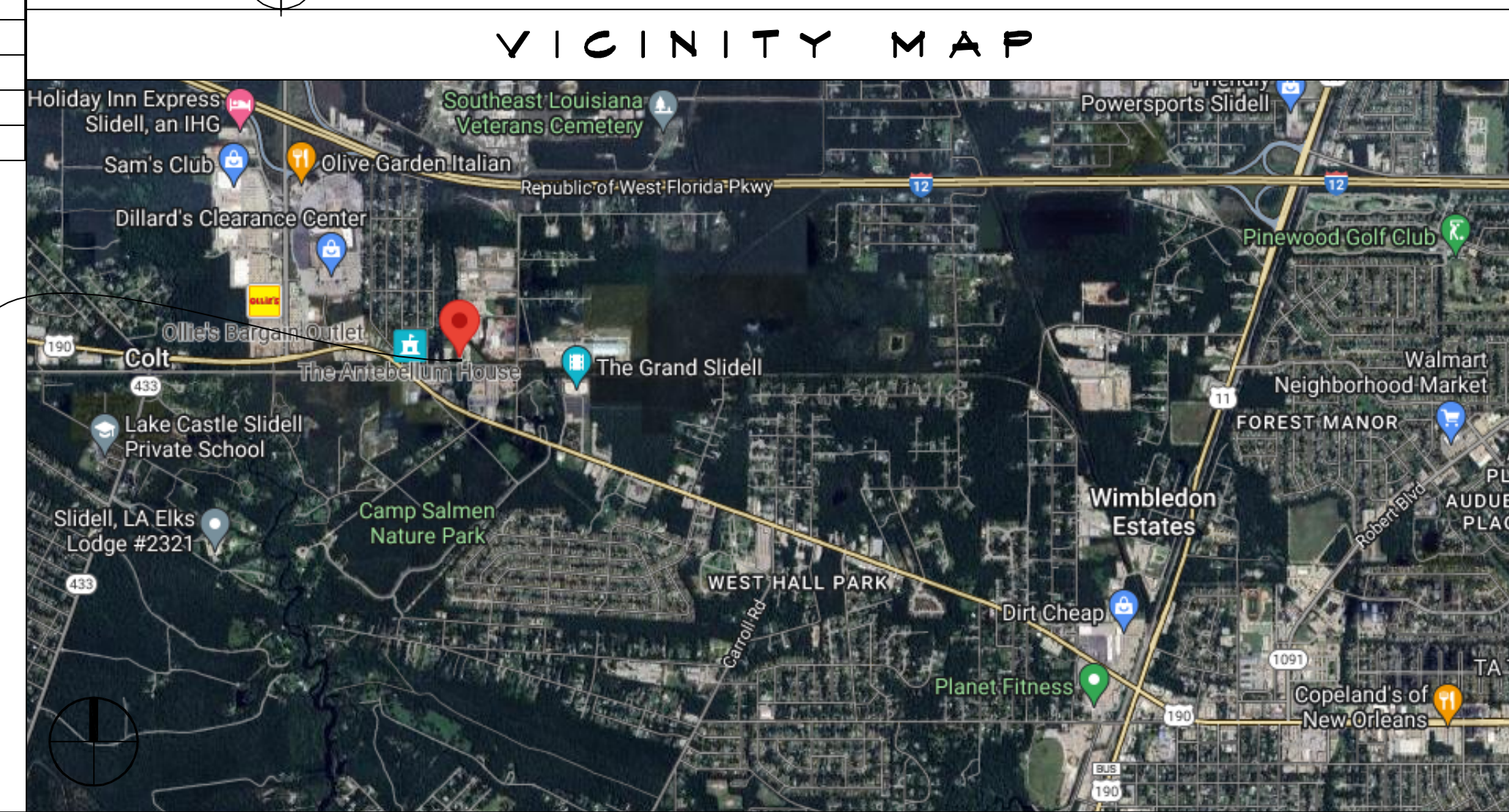

SHEET INDEX

SHEET #	SHEET TITLE
G101	GENERAL INFORMATION SHEET
C101	SITE PLAN
C102	EROSION CONTROL AND DETAILS
S101	FOUNDATION PLAN
A101	FLOOR PLAN
A102	EXTERIOR ELEVATIONS
A103	ROOF PLAN AND BLDG SECTION
E101	LIGHTING & POWER PLAN

GENERAL NOTES

- ALL MATERIALS AND WORK, INCIDENTAL TO THE CONSTRUCTION OF THIS PROJECT, SHALL CONFORM TO ALL GOVERNING CODES, AND REGULATIONS OF AGENCIES IN AUTHORITY.
- CONTRACTOR SHALL PROVIDE ALL PUBLIC PROTECTIONS NECESSARY AS REQUIRED BY LAW.
- THE DRAWINGS AND ANY SUBSEQUENTLY ISSUED ADDENDA, AMENDMENTS OR SUCH CHANGE ORDERS APPROVED BY THE OWNER AND THE CONTRACTOR ARE PART OF THESE CONTRACT DOCUMENTS.
- DO NOT SCALE DRAWINGS. CONSULT WITH THE ENGINEER REGARDING ANY ITEMS IN THE CONTRACT DOCUMENTS THAT REQUIRE CLARIFICATION.
- TRASH SHALL BE REMOVED FROM THE SITE NOT LESS THAN TWICE MONTHLY.
- THE GENERAL CONTRACTOR SHALL VERIFY EXISTING CONDITIONS PRIOR TO COMMENCING WORK AND REPORT ANY AND ALL DISCREPANCIES TO THE ARCHITECT.
- CONTRACTOR VEHICLES AND EQUIPMENT NECESSARY FOR CONSTRUCTION MAY BE PARKED ON THE SITE. OTHER VEHICLES PARKED ON THE SITE REQUIRE THE OWNER'S PERMISSION.
- ALL MATERIALS/EQUIPMENT SHALL BE INSTALLED PER MANUFACTURERS RECOMMENDATIONS. WORK NOT CONSISTENT WITH MANUFACTURERS RECOMMENDATIONS WILL BE REJECTED BY OWNER/ARCHITECT.

DAMMON ENGINEERING, INC.
LOUISIANA & MISSISSIPPI
Chief Engineer: Brian Alstich, PE
554 Old Spanish Trail
Slidell, LA 70458
www.dammonengineering.com
info@dammonengineering.com
PH: 985.649.5832

REVISIONS	DATE	DESCRIPTION
#		

SEAL: 11/4/2023

NEW WAREHOUSE SPECIALTY SEG-SPECIALIZED IMAGING

SHEET TITLE: GENERAL INFORMATION SHEET

DRAWING NUMBER: **G101**

SHEET No: 1 of 15