

DERBIGUM®

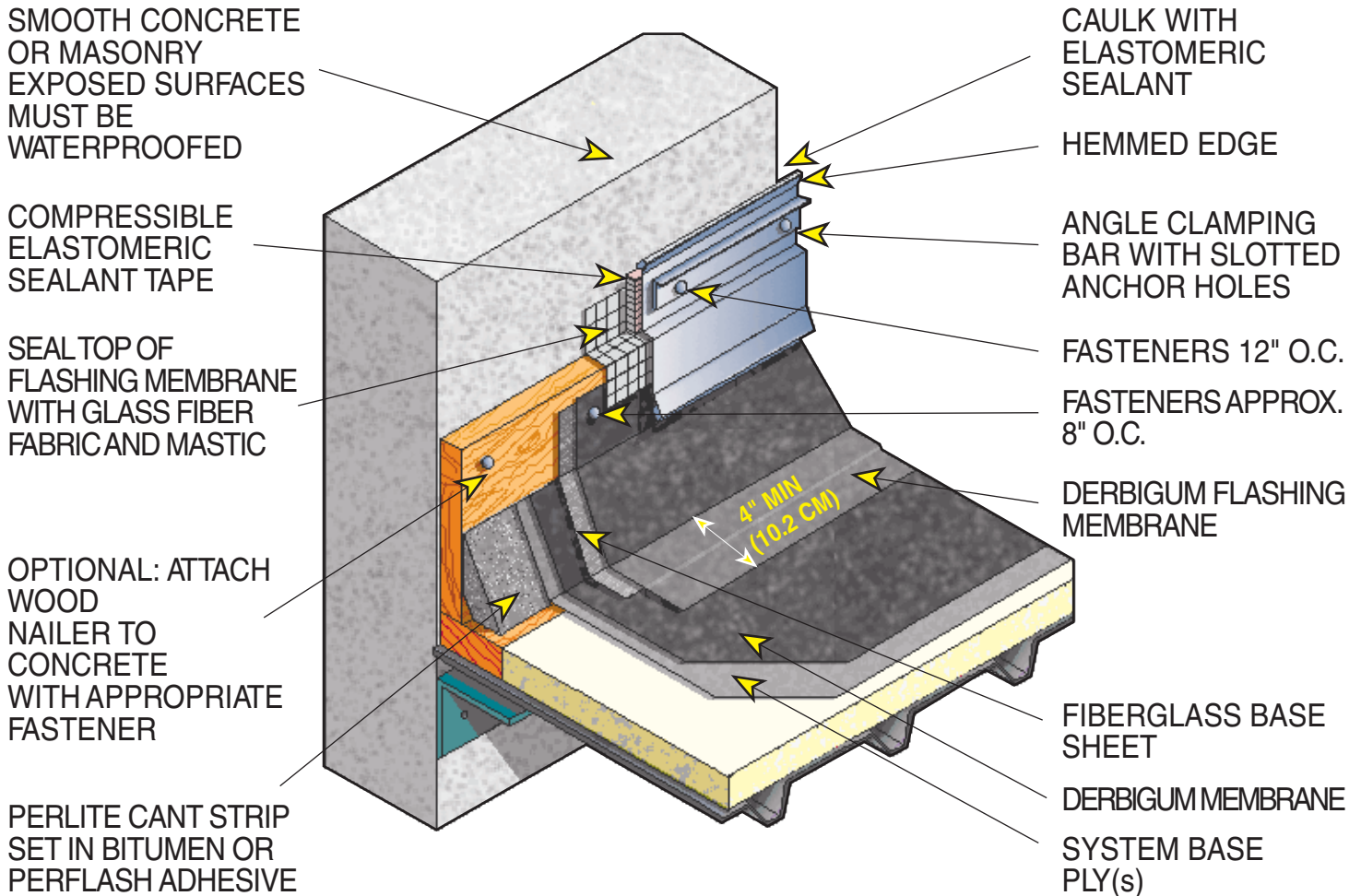

NOTE:
WHERE DECK IS SUPPORTED BY AND FASTENED TO THE CONCRETE DECK WALL, VERTICAL WOOD NAILERS ARE REQUIRED AND SHOULD BE SECURED TO THE WALL WITH SUITABLE FASTENERS.

The actual number of base and membrane plies must be consistent with the number of base and membrane plies used in the field.

P-3 WALL/ SURFACE MOUNTED COUNTERFLASHING