

SIMPSON**Strong-Tie**

TOP FLANGE HANGERS HHB/GB/HGB

BEAM AND PURLIN HANGERS

See tables on page 102. See Hanger Options on page 158 for hanger modifications, which may result in reduced loads.

Precision forming with manufacturing quality control provides dimensional accuracy and helps ensure proper bearing area and connection.

MATERIAL: See tables on page 102.

FINISH: HHB, GB, HGB, all saddle hangers and all welded sloped and special hangers—Simpson gray paint. HHB may be ordered hot-dip galvanized; specify HDG.

INSTALLATION: • Use specified fasteners. See General Notes and nailer table.

- HHB, GB and HGB may be used for weld-on applications. The minimum required weld to the top flanges is $\frac{1}{8}$ " x 2" fillet weld to each side of each top flange tab for 14 and 12 gauge and $\frac{3}{16}$ " x 2" fillet weld to each side of each top flange tab for 7 gauge. Distribute the weld equally on both top flanges. Welding cancels the top and face nailing requirements. Consult the code for special considerations when welding galvanized steel. The area should be well-ventilated. Weld on applications produce the maximum allowable load listed. Uplift loads do not apply to welded applications.
- Ledgers must be evaluated for each application separately. Check TF dimension, nail length and nail location on ledger.

OPTIONS: • HHB—other widths are available; specify W dimension (*the minimum W dimension is 2½"*).

- Saddle hangers are made to order; add "D" to model (*e.g. HHBD3*); specify S (*for saddle*) dimension. They may be used for most conditions except at end wall locations, and are preferred for nailer applications.
- The finish on special B hangers will depend on the manufacturing process used. Check with your Simpson representative for details. Hot-dipped galvanized available: specify HDG.
- B dimensions may be increased on some models.
- See Hanger Options, page 158.

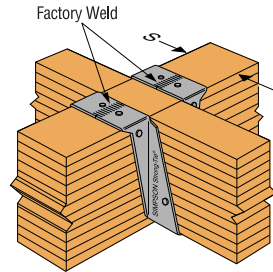

Typical BD Saddle Installation

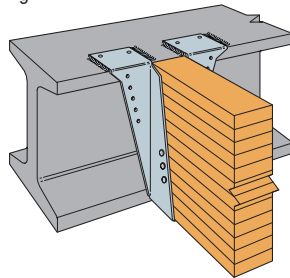

HHB, GB and HGB are acceptable for weld-on applications. See Instructions to the Installer, page 11, note f.