

DWG. NAME: A101 - RESIDENTIAL Floor and Foundation Plans - Date: 09-19-2025 - 15:20:25 - 10/19/2025

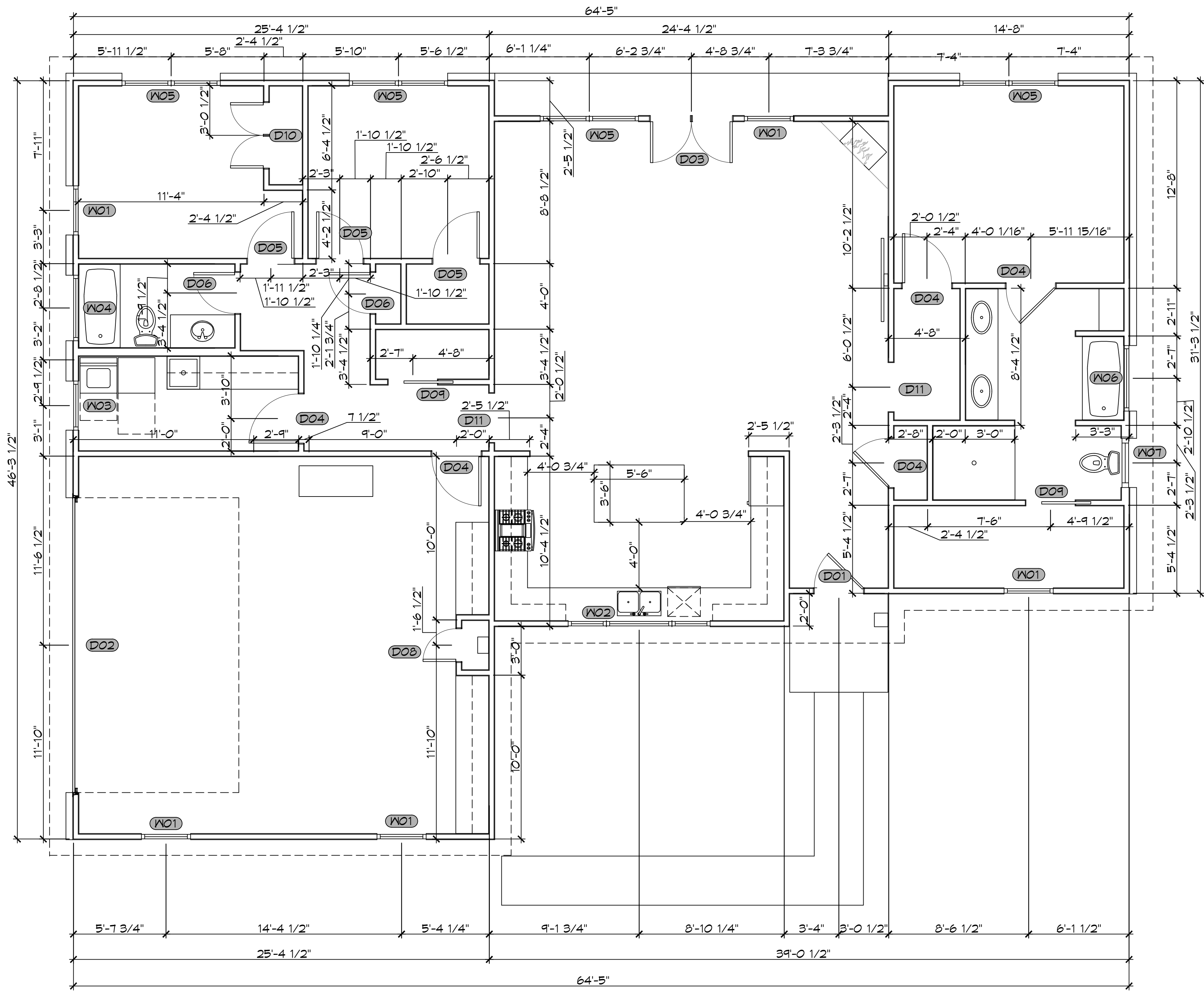

6 FLOOR PLAN
SCALE: 1/4" = 1'-0"

WINDOW SCHEDULE					DOOR SCHEDULE						
MK	WIDTH	HEIGHT	FRAME MAT	NOTES	MK	WIDTH	HEIGHT	THK	DOOR MAT	FRAME MAT	NOTES
W01	3'-0"	6'-0"	VINYL	WINDOW INSULATED	D01	4'-0"	8'-0"	1-3/4"	MTL	WOOD	EXTERIOR DOOR WITH SIDE ONE GLASS SIDE LITE
W02	8'-0"	4'-0"	VINYL	LEFT/RIGHT HANDED VINYL SLIDING WINDOW WITH FIXED CENTER PANE	D02	18'-0"	8'-0"	1-3/4"	MTL	WOOD	2 CAR GARAGE DOOR
W03	3'-0"	4'-0"	VINYL	FIXED WINDOW INSULATED	D03	(2)2'-6"	8'-0"	1-3/4"	MTL	WOOD	EXTERIOR DOUBLE FRENCH DOORS
W04	4'-0"	2'-0"	VINYL	FIXED WINDOW INSULATED	D04	3'-0"	6'-8"	1-3/4"	WOOD	WOOD	INTERIOR DOOR
W05	(2)8'-0"	6'-0"	VINYL	WINDOW INSULATED	D05	2'-10"	6'-8"	1-3/4"	WOOD	WOOD	INTERIOR DOOR
W06	4'-0"	3'-0"	VINYL	INSULATED FIXED WINDOW	D06	2'-6"	6'-8"	1-3/4"	WOOD	WOOD	INTERIOR DOOR
W07	3'-0"	4'-0"	VINYL	INSULATED FROSTED FIXED WINDOW	D07	N/A	N/A	N/A	N/A	N/A	N/A
W08	2'-0"	2'-0"	VINYL	INSULATED FIXED WINDOW	D08	2'-0"	6'-8"	1-3/4"	WOOD	WOOD	INTERIOR DOOR
W09	3'-0"	4'-0"	VINYL	WINDOW INSULATED	D09	3'-0"	6'-8"	1-3/4"	WOOD	WOOD	INTERIOR POCKET DOOR
					D10	(2)2'-0"	6'-8"	1-3/4"	WOOD	WOOD	INTERIOR FRENCH DOOR
					D11	3'-0"	8'-0"	1-3/4"	-	-	CASED OPENING

NOTE: OWNER TO PICK ALL WINDOW STYLES AND COLORS

NOTE: OWNER TO PICK ALL DOOR STYLES AND COLORS

NOTE: ALL EXTERIOR DOORS AND WINDOW ASSEMBLIES TO BE RATED FOR 140 MPH WINDS AND SHALL BE MISSILE IMPACT RESISTANT.

DESIGN CRITERIA
 THE CONSTRUCTION FOR SAID BUILDING, WHERE WIND SPEED IS 140 MILES PER HOUR AND VASD WIND SPEED IS 130 MPH, WIND EXPOSURE ZONE C, IS DESIGNED IN ACCORDANCE WITH: AMERICAN FOREST AND PAPER ASSOCIATION (AF&PA) WOOD FRAME CONSTRUCTION MANUAL FOR ONE AND TWO FAMILY DWELLINGS (WFCM) 2001 EDITION AS WELL AS THE INTERNATIONAL RESIDENTIAL CODE (IRC) 2021 EDITION. STRUCTURE SHALL BE BUILT TO THE 2021 INTERNATIONAL ENERGY CONSERVATION CODE (IECC) AND STATE AMENDMENTS ADOPTED JULY 1, 2023.

SQUARE FEET	
LIVING	1120
FRONT PORCH	36
REAR PORCH	62
GARAGE	575
TOTAL SQ. FT.	2393

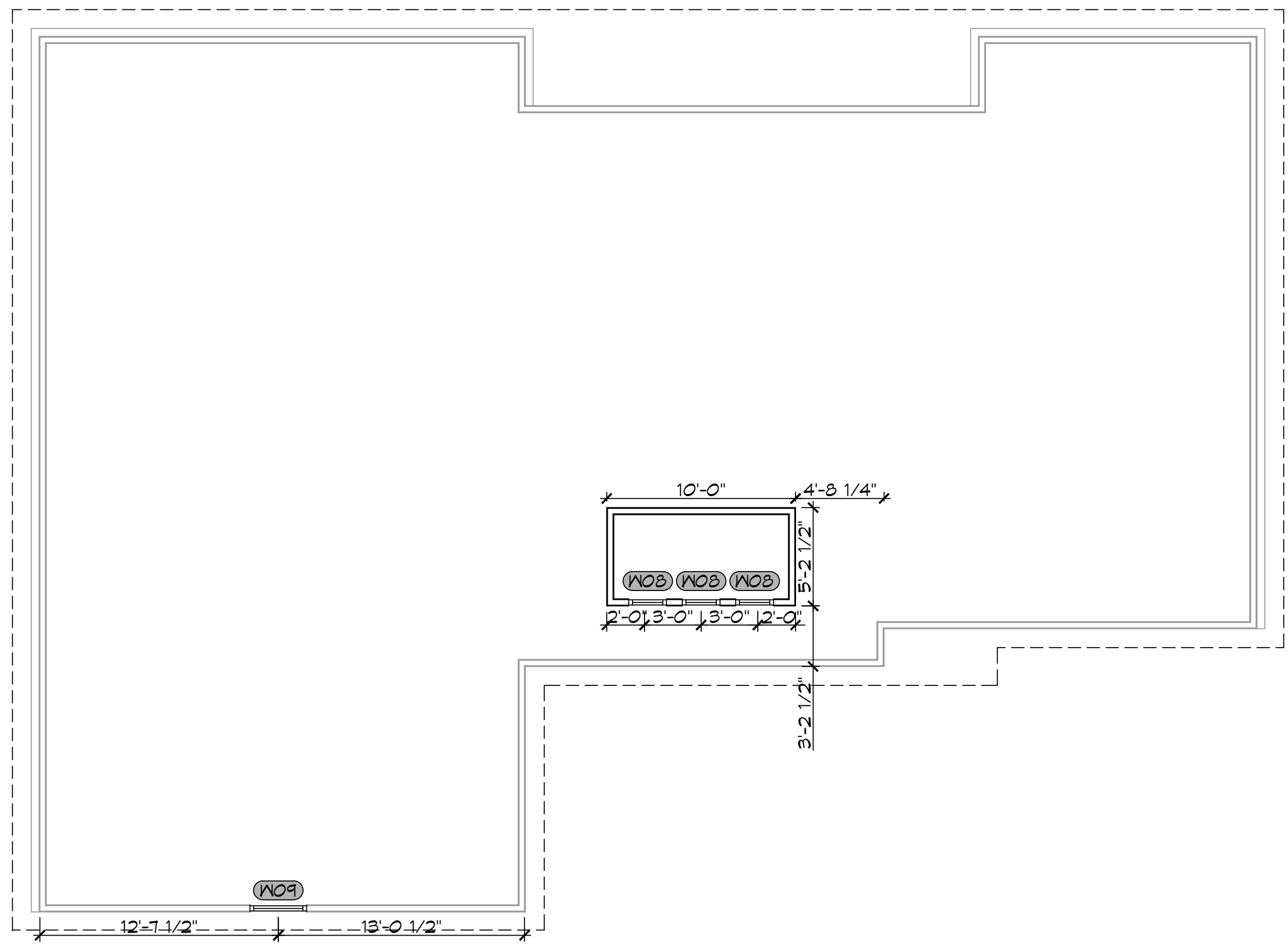

7 DORMER PLAN
SCALE: 3/16" = 1'-0"

DAMMON ENGINEERING, INC.
 LOUISIANA & MISSISSIPPI
 Chief Engineer: Brian Mitchell, PE
 554 Old Spanish Trail
 Slidell, LA 70458
 www.dammonengineering.com
 info@dammonengineering.com
 PH: 985.649.5832

#	DESCRIPTION	DATE

HOUSE PLAN
BRITISH AND JANET
 21444 WILLIAMS STREET
 ABITA SPRINGS, LA 70420
 JOB No: 09-19-2025
 DATE: 09-19-2025
 DRAWN BY: SKJ
 CHECKED BY: CKD

SHEET TITLE:
FLOOR PLAN AND DORMER PLAN
 DRAWING NUMBER:
A101
 SHEET No: 7 of 11