

ELECTRICAL NOTES

NEC2020 GROUND-FULT CIRCUIT-INTERFERENCE PROTECTION FOR RECESSED CAN LIGHTS: ALL RECESSED SINGLE-PHASE E- AND G-POLE RECESSED CAN LIGHTS SHALL BE INSTALLED IN THE LOCATIONS SPECIFIED IN THE NOTES TO THIS PLAN. RECESSED CAN LIGHTS SHALL BE INSTALLED IN THE LOCATIONS SPECIFIED IN THE NOTES TO THIS PLAN. RECESSED CAN LIGHTS SHALL BE INSTALLED IN THE LOCATIONS SPECIFIED IN THE NOTES TO THIS PLAN.

NEC2020 GROUND-FULT CIRCUIT-INTERFERENCE PROTECTION FOR RECESSED CAN LIGHTS: ALL RECESSED SINGLE-PHASE E- AND G-POLE RECESSED CAN LIGHTS SHALL BE INSTALLED IN THE LOCATIONS SPECIFIED IN THE NOTES TO THIS PLAN. RECESSED CAN LIGHTS SHALL BE INSTALLED IN THE LOCATIONS SPECIFIED IN THE NOTES TO THIS PLAN. RECESSED CAN LIGHTS SHALL BE INSTALLED IN THE LOCATIONS SPECIFIED IN THE NOTES TO THIS PLAN.

NEC2020 GROUND-FULT CIRCUIT-INTERFERENCE PROTECTION FOR RECESSED CAN LIGHTS: ALL RECESSED SINGLE-PHASE E- AND G-POLE RECESSED CAN LIGHTS SHALL BE INSTALLED IN THE LOCATIONS SPECIFIED IN THE NOTES TO THIS PLAN. RECESSED CAN LIGHTS SHALL BE INSTALLED IN THE LOCATIONS SPECIFIED IN THE NOTES TO THIS PLAN. RECESSED CAN LIGHTS SHALL BE INSTALLED IN THE LOCATIONS SPECIFIED IN THE NOTES TO THIS PLAN.

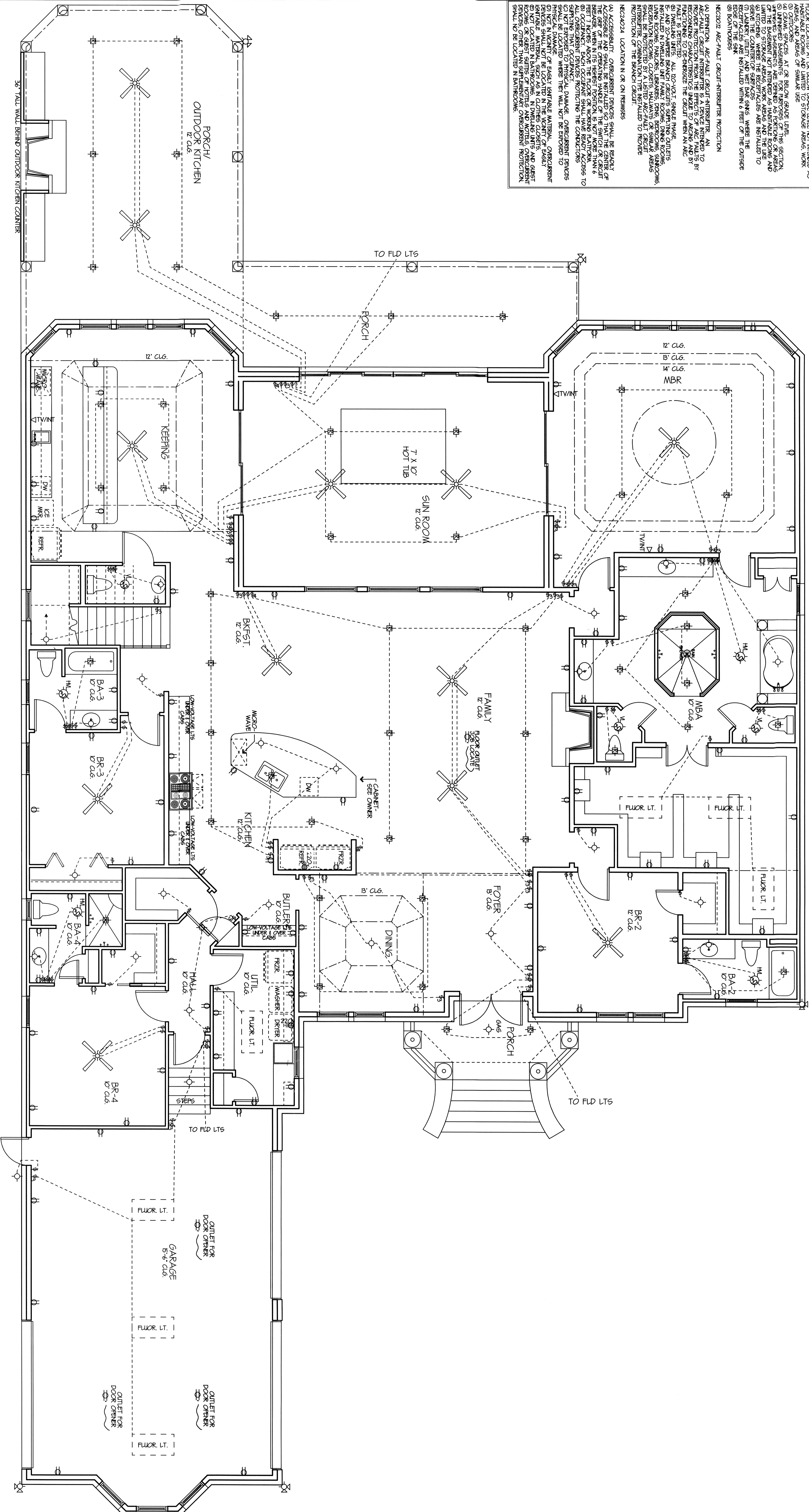

1ST LEVEL ELECTRICAL PLAN
SCALE 1/4"=1'-0"

1ST LEVEL ELECTRICAL PLAN

PLANS FOR:
J.C. & PATSY HIMEL
LOT 26, LAKESHORE ESTATES
ST. TAMMANY PARISH, LA

DesignTech
Residential Planners, Inc.

St. Tammany Parish, LA
COVINGTON 985-871-7211 SLIDELL 985-847-4600

CODE	AREA U. B.	INDEX
A4	6289	8254
9970		

DATE: 5-16-13

DESIGNED BY	CHKD BY
DWH	KGW

E-1

Copyright 2013, as indicated, by DesignTech Residential Planners, Inc. All RIGHTS RESERVED.