

FRONT ELEVATION

SIGN
1

SCOPE OF WORK:

Manufacture & install new channel letters.
Connect to existing electrical.

EXISTING



PROPOSED



SCALE: 3/16"=1'-0"

SALLY
BEAUTY

Address 10840
2949 Veterans Memorial Blvd
Suite A4
City Metairie
State LA 70002

Account Representative:
Joleen Martinez

This design and engineering is submitted as our proposal, and the right to use or exhibit in any form, is not authorized without written permission by Vixxo.

Notes

- *
- *
- *
- *
- *

Designer JW
Design # Vx1104955
Original Date 11/15/23
Revision Date 00/00/23

All electrical scope to be performed in a UL approved method and shall meet current N.E.C. standards



* All electrical components shall be U.L. Listed.
* Sign shall be grounded per N.E.C. Article 250.
* Insulated conductors as per N.E.C. Code 310.8, type to be used - metal: Insulated swaths.
* Disconnect switch as per N.E.C. Code 600.5.



sign & lighting

page 1

The purchaser agrees to hold the seller harmless against any claims for damages which may arise as a result of drilling for pipes and foundations, including but not limited to sewer, gas lines or any underground obstacles which the purchaser or others may have located.

Electrical Notes: All electrical components to be UL approved Customer is responsible for one (1) 120v/20a dedicated circuit with ground per sign within 6' of sign Lock out switch installed at panel box for all electrical signs Install in accordance with N.E.C. article 600 and/or local codes. This includes proper grounding and bonding of signs

30" LINEAR CHANNEL LETTER SET

SIGN
1

SCALE: 3/8"=1'-0"

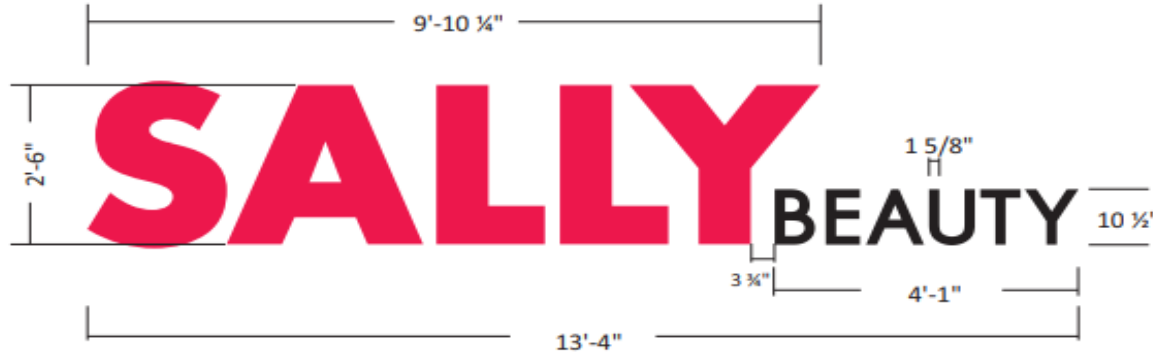

FLUSH MOUNT CHANNEL LETTER SET

33.3 SQUARE FEET

SPECIFICATIONS

- 3" DEEP .050 ALUMINUM RETURNS PAINTED BLACK.
- 1" TRIM CAP BLACK.
- FACES ARE FLAT TRANSLUCENT
"SALLY" #2793 RED 3/16" PLEX.
"BEAUTY" #2447 WHITE ACRYLIC WITH 70/30 BLACK PERFORATED VINYL.
- LETTERS ARE INTERNALLY ILLUMINATED WITH Principal LED:
Red PL-FS2-RR1-P FOR "SALLY"
White PL-OP2-SF3-P-TW FOR "BEAUTY"
- LETTERS ARE MOUNTED FLUSH TO BUILDING WITH NON-CORROSIVE MOUNTING HARDWARE.

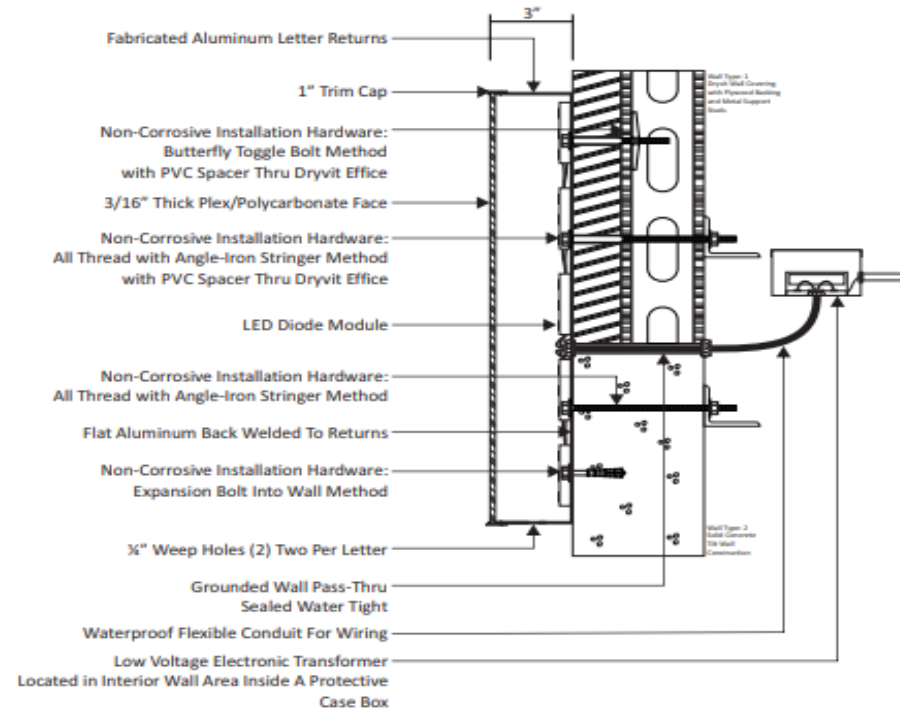

**SALLY
BEAUTY**

Address 10840
2949 Veterans Memorial Blvd
Suite A4
City Metairie
State LA 70002

Account Representative:
Joleen Martinez

This design and engineering is submitted as our proposal, and the right to use or exhibit in any form, is not authorized without written permission by Vixxo.

Notes

- "
- "
- "
- "
- "

Designer JW
Design # Vx1104955
Original Date 11/15/23
Revision Date 00/00/23

All electrical scope to be completed in a U.L. approved method and shall meet current N.E.C. standards.



- * All electrical components shall be U.L. Listed.
- * Sign shall be grounded per N.E.C. Article 250.
- * Insulated conductors as per N.E.C. Code 310.8, type to be used - metallic insulated cable.
- * Disconnect switch as per N.E.C. Code 600.6.



sign & lighting

page 2

The purchaser agrees to hold the offer harmless against any claims for action for damages which may occur as a result of drilling for pins and foundations, including but not limited to wires, gas lines or any underground obstacles which the purchaser or others may deem valuable.

Electrical Notes: All electrical components to be UL approved Customer is responsible for one (1) 120v/20a dedicated circuit with ground per sign within 6' of sign Lock out switch installed at panel box for all electrical signs Install in accordance with N.E.C. article 600 and/or local codes. This includes proper grounding and bonding of signs

**DAMMON
ENGINEERING**



SCALE: 1/2"=1'-0"

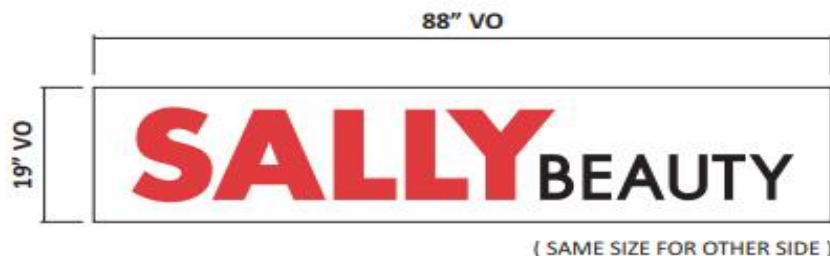

TENANT PANELS - VINYL ONLY

(2) TWO REQUIRED

SCOPE OF WORK

1. FABRICATE, SHIP AND INSTALL (2) TWO NEW VINYL GRAPHICS.

SPECIFICATIONS

1. EXISTING FACES ARE WHITE FLEX WITH NEW VINYL OVERLAYS APPLIED FIRST SURFACE.
2. BACKGROUND IS WHITE.
3. SALLY IS TRANSLUCENT RED VINYL.
4. BEAUTY IS OPAQUE BLACK VINYL.

 3M #3630-33 RED VINYL

 3M #180C-12 BLACK VINYL



SALLY BEAUTY

Address 10840
2949 Veterans Memorial Blvd
Suite A4
City Metairie
State LA 70002

Account Representative:
Joleen Martinez

This design and engineering is submitted as our proposal, and the right to use or exhibit in any form, is not authorized without written permission by Vixxo.

Notes

- *
- *
- *
- *
- *

Designer JW
Design # Vx1104955
Original Date 11/15/23
Revision Date 00/00/23

All electrical scope to be completed in a UL approved method and shall meet current N.E.C. standards.



- * All electrical components shall be U.L. Listed.
- * Sign shall be grounded per N.E.C. Article 250.
- * Insulated conductors as per N.E.C. Code 310.8 type to be used - metallic insulated suitable.
- * Disconnect switch as per N.E.C. Code 600.8.



sign & lighting

page 3

The purchaser agrees to hold the seller harmless against any cause for action for damages which may occur as a result of exiting the poles and foundations, including but not limited to owner, gas lines, or any underground obstacles, which the purchaser or others may deem suitable.

Sally Beauty 2949 Veterans Blvd Ste A4 Metairie, LA 70002

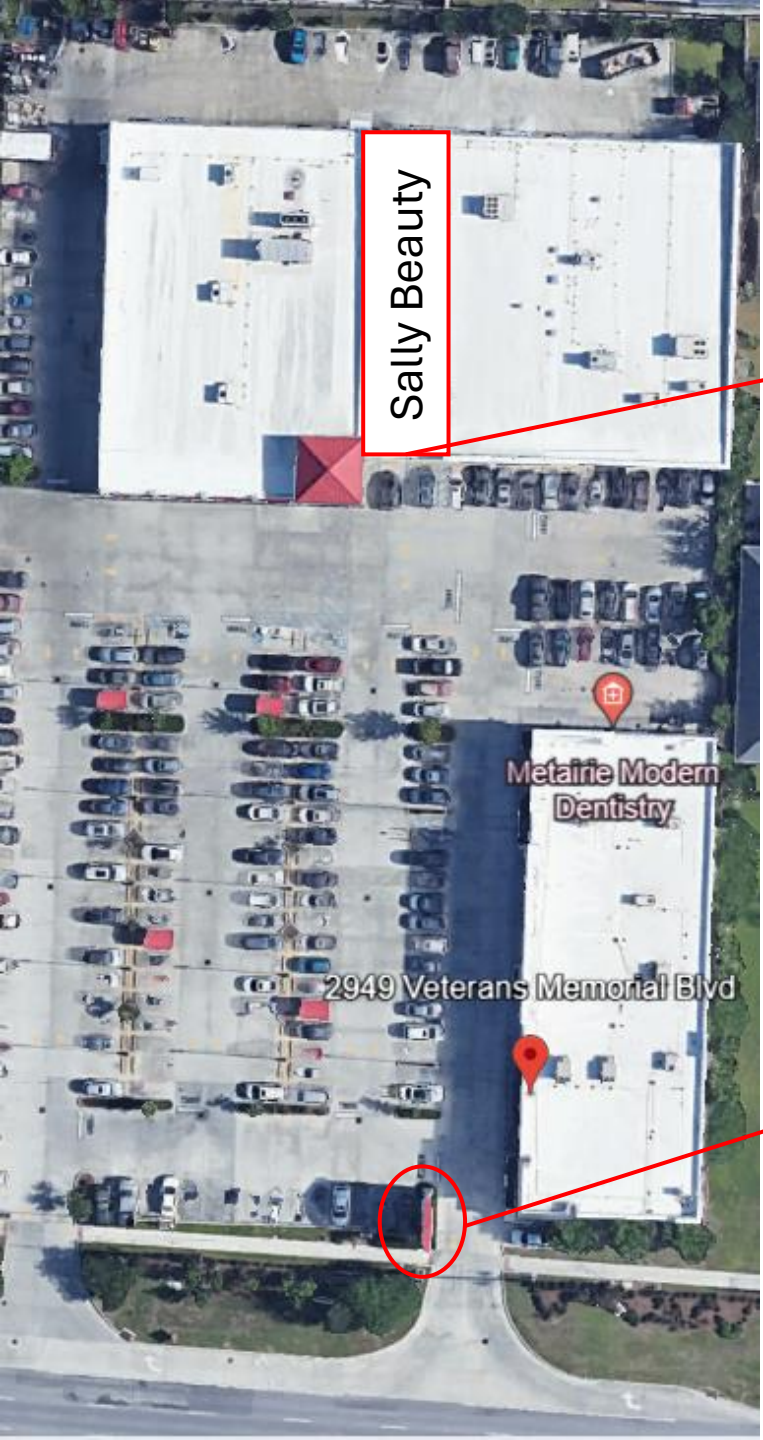

Sally Beauty

Tenant Space Building Sign

Metairie Modern Dentistry

2949 Veterans Memorial Blvd

Multi Tenant Sign Sign Panels (Vinyl Only)