

DAMMON

ENGINEERING, INC.

Architects & Engineers

SHOP DRAWING and SAMPLE TRANSMITTAL

554 Old Spanish Trail
 Slidell, LA 70458
 985.649.5832
 www.dammonengineering.com
 info@dammonengineering.com

DATE: 6/19/2025

TO: Cheri Rush
 M Natal Contractor, Inc.
 P.O. Box 518
 Slidell, La

FROM: Chuck Dammon

SUBMITTAL No.: 123000.002.0

REFERENCE: **STP Fire District 1 Training Center**

DE Project: 2507

WE TRANSMIT:

enclosed under separate cover _____

FOR YOUR:

use record approval
 review and comment information drafting

THE FOLLOWING:

drawing(s) contracts specifications
 shop drawings samples change order(s)
 product information warranty substitution request

# COPIES	DESCRIPTION	ACTION
Electronic	Cabinets and Pulls	A

ACTION CODES:

- A. Reviewed/No Exceptions
- B. Reviewed/Exceptions Noted
- C. Revise and Resubmit
- G. Rejected
- D. No Action Required
- E. For Signature and Return to this Office
- F. See Remarks Below

REMARKS:

Cabinets and pulls are approved but need samples for personal review with Owners.

COPIES TO: File



Project: STFD No.1 New Training Facility
 34780 S. Range Road
 Slidell, Louisiana 70460

SUBMITTAL COVER SHEET

Arch. Project No: _____

MNC Project No: 820

To: Dammon Engineering, Inc.
554 Old Spanish Trail
Slidell, Louisiana 70458
info@dammonengineering.com

From: Cheri Rusich
M Natal Contractor, Inc.
P.O. Box 518
Slidell, LA 70459

Attn. David Dammon
Chuck Dammon

Sent Via E-Mail

General Contractor's Review:

M Natal Contractor, Inc.

<p>SUBMITTAL NO: <u>123000.002.0</u></p> <p>SPEC. SEC. NO: <u>123000</u></p> <p>VENDOR/SUB: <u>Cabinets by Bernal</u></p> <p>DESCRIPTION: <u>Cabinets, Hinges, Pulls, Clops, Brackets</u></p>	<p>CONTRACTOR'S REVIEW:</p> <p>NO EXCEPTIONS TAKEN <input checked="" type="checkbox"/></p> <p>FURNISH AS CORRECTED <input type="checkbox"/></p> <p>REJECTED; RESUBMIT <input type="checkbox"/></p> <p>PARTIAL APPROVAL; SUBMIT ADD'L ITEM(S) <input type="checkbox"/></p>
---	--

Reviewing is for conformance with the design concept of the project and compliance with the information given in the Contract Documents. The Vendor/Subcontractor is responsible for dimensions to be confirmed and correlated at the site for information that pertains solely to the fabrication process or to the means, method, technician, sequences, and procedures of construction; and for coordination of the work with all trades.

BY _____ **DATE:** 06/09/2025

Architect/Engineer Review:

DAMMON ENGINEERING, INC

Date: 06-19-25 Project: Training Facility #2
 Reviewed: X
 Reviewed as noted: _____
 Revise and ReSubmit: _____
 Rejected: _____
 Other: _____

Correction or comments made on the shop drawings during this review do not relieve the contractor from compliance with requirements of the drawings and specifications. This check is only for review of the general conformance with the design concept of the project and general compliance with the information given in the contract documents. This contractor is responsible for: confirming and correlating all quantities and dimensions, selecting fabrication processes and techniques of construction; coordinating his or her work with that of all other trades and performing all in a safe and satisfactory manner.

Submittal item: Cabinets and pulls
 Comments: _____

Cheri Rusich

From: mike natal
Sent: Monday, June 9, 2025 12:14 PM
To: Cheri Rusich
Subject: FW: Joe Liggio Submittals, New Training Facility, Camp Villere

New Training Facility, Camp Villere

Material Submittals for the below items:

- Cabinets
- Cabinet Hinges and Pulls
- Countertops, Uba Tuba (Hard Sample coming soon)
- Countertop Support Brackets

*Sincerely,
Mike Natal*

*M Natal Contractor, Inc.
394 Voters Rd.
Slidell, LA 70461
(985)649-2713 phone
email: mike@mnatal.com
website: www.mnatal.com*

Expert Finishing

Count on consistent, high-quality finishing. Our state-of-the-art manufacturing facility utilizes a multi-step professional finishing process. This meticulous process guarantees that finishes maintain a high degree of color and application accuracy from cabinet to cabinet, which means that every cabinet will look stunning.

Our cabinets and accessories feature water-based ultraviolet (UV) coatings. Water-based UV coatings emit low Volatile Organic Compounds (VOCs) and are environmentally responsible. Ultraviolet finishing uses light instead of heat for curing and the benefits include no environmental pollutants or solvents to evaporate, increased chemical resistance and durability.

Maui in stained
Espresso

Catalina in
stained Slate
Coming Summer 2021

Maui in painted
Pebble Grey

Hatteras
in painted
Polar White

Premium Multi-Step Finishing Process

1. The finest wood components are sanded with precision
2. A balanced base coat is applied to ensure a consistent, quality finish
3. First stage ultraviolet (UV) curing process occurs
4. The wood is finely sanded and vacuumed
5. A tinted primer is applied as a foundation for our superior finish
6. Second stage (UV) curing
7. The wood is finely sanded and vacuumed
8. The solid paint layer is evenly applied
9. Third stage (UV) curing
10. The wood is finely sanded and vacuumed
11. First layer of water based clear coat is applied
12. The components go through the dryer to prepare for final processing
13. The wood is finely sanded and vacuumed
14. Second layer of water-based clear coat is applied
15. The components go through the dryer once again
16. Final sanding for a smooth surface and vacuumed for a thorough cleaning
17. A final layer of topcoat is evenly applied
18. Oven cured for catalyzed hardened finish
19. Visual inspection with a color consistency examination performed

Process for stained products varies slightly from the above steps.

Quality Comes First

Cabinets should withstand the demands of daily use and maintain their integrity throughout their lifetime. That's why when we designed NorthPoint Cabinetry we paid attention to all the details from start to finish. Each cabinet is just as functional on the inside as it is beautiful on the outside.

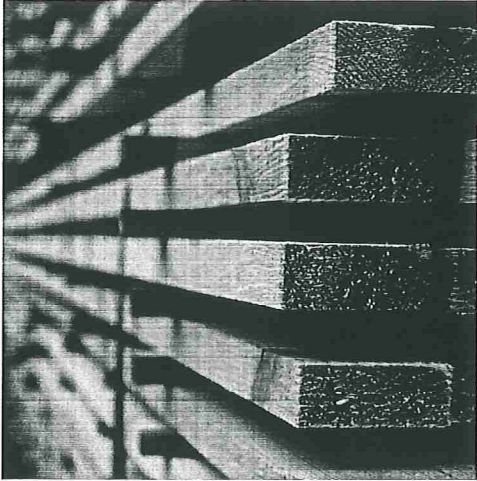

It Starts with Quality Wood

Just as a healthy tree needs strong roots to thrive, so too does a quality cabinet require premium lumber at its core. Our cabinets feature solid wood construction, so the quality of wood is of utmost importance.

Structural Integrity

Meaningful yet hidden reinforcements, like solid wood corner blocks and strategically placed hidden pocket screws, help reinforce the structural integrity of the cabinet. Take comfort that these well-constructed cabinets will stand the test of time.

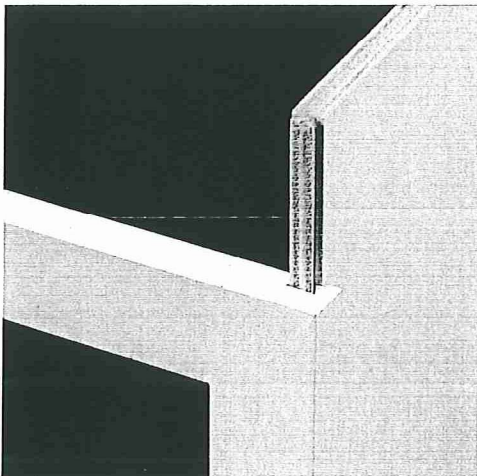
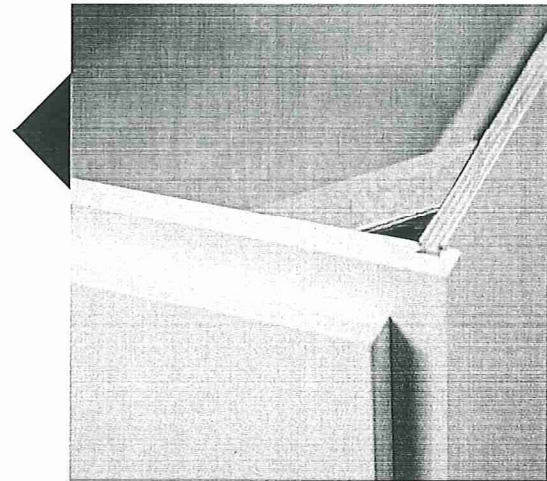

Thoughtful Craftsmanship

Boasting an innovative dovetail and hidden pocket screw construction, these cleverly designed cabinets achieve robust quality and quick, accurate assembly.

Cabinet Lineup

WALL CABINETS

12" deep except where noted
 42" high wall cabinets will have 3 shelves
 *39" and 42" widths will have a vertical center stile unless otherwise noted

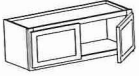

Double Door
 12" Height
 30", 33", 36"
 or *39" Width

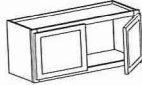

Double Door
 15" Height
 30", 33", 36"
 or *39" Width

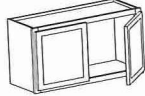

Double Door
 18" Height
 21", 24", 30", 33", 36"
 or *39" Width

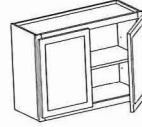

Double Door
 24" Height
 30", 33", 36" or *39" Width

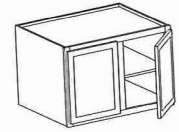

Deep Double Door
 18" or 24" Height • 24" Depth
 36" or *39" Width
 18" Height does not have shelf



Single Door
 30" Height
 9", 12", 15", 18" or 21" Width

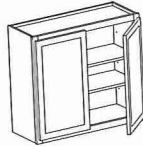

Double Door
 30" Height
 24", 27", 30", 33",
 36", *39" or *42" Width

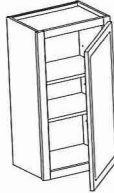

Single Door
 36" Height
 9", 12", 15", 18" or 21" Width

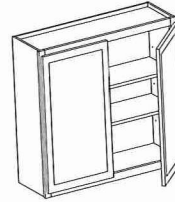

Double Door
 36" Height
 24", 27", 30", 33",
 36", *39" or *42" Width

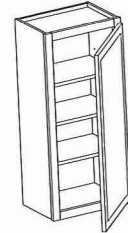

Single Door
 42" Height
 9", 12", 15", 18" or 21" Width



Double Door
 42" Height
 24", 27", 30", 33",
 36", *39" or *42" Width



Single & Double Glass Door
 Matching Finish Color Interior
 30" Height
 15", 18", 30" or 36" Width

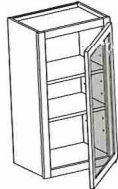

Single & Double Glass Door
 Matching Finish Color Interior
 36" Height
 15", 18", 30" or 36" Width

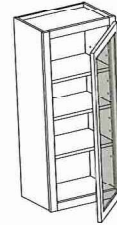

Single & Double Glass Door
 Matching Finish Color Interior
 42" Height
 15", 18", 30" or 36" Width

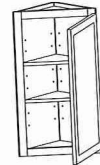

Wall End Single Door
 30", 36" or 42" Height
 12" Width

Glass door wall cabinets only available in the Premier collection

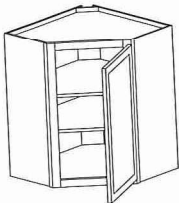

Diagonal Corner
 30", 36" or 42" Height
 12 or 15" Depth
 24" and 27" Width

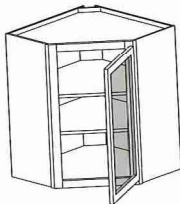

Diagonal Corner Glass Door
 Matching Finish Color Interior
 30", 36" or 42" Height
 12 or 15" Depth
 24" and 27" Width

Glass door wall cabinets only available in the Premier collection

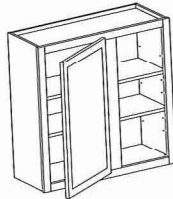

Universal Blind Corner
 30", 36" or 42" Height
 30"-33" Width

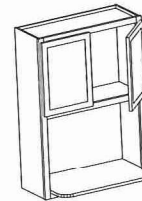

Microwave Wall Cabinet
 Extended Shelf
 36" Height
 30" Width

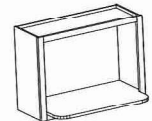

Microwave Wall Cabinet
 Extended Shelf
 18" Height
 30" Width

BASE CABINETS

*39" and 42" widths will have a vertical center stile unless otherwise noted

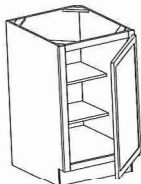

Full Height Single Door
 9", 12", 15" or 18" Width

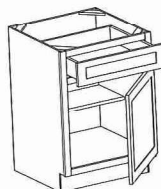

Single Door and Drawer
 12", 15", 18" or 21" Width

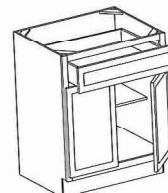

Double Door and Single Drawer
 24", 27" or 30" Width

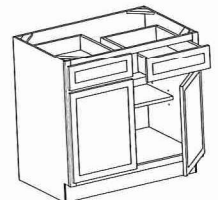

Double Door and Double Drawer
 33", 36", *39" or *42" Width

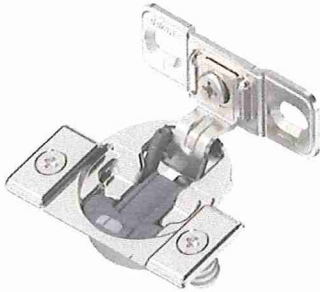

Compact BLUMOTION 38B Face Mounted Hinge and Mounting Plate: 107 Degree, 1-3/8" or Greater Variable Overlay, Dowel or Screw-On Installation, Soft Closing

★★★★★ Rating 4.7 | 1,560

Reviews | Our Item Number BH-38B358BF22

COMPACT BLUMOTION hinges are a one piece hinge, specifically designed for face frame cabinets. The soft-close feature is built right into the hinge cup, which means doors close silently each and every time. The BLUMOTION feature is adaptable, so even if you slam the door, you won't damage it. The door will still close softly for the life of the hinge.

\$3 Each

~~\$4.83~~

SAVE 38%
Ends Jun 03

Qty: Each

Add to Cart

- ✓ In-Stock & Ready to Ship
- ✓ Easy Returns
- ✓ No Restock Fee

Large Project?

Orders \$2500+ Qualify for Special Discounts.

Build your item list and get a Quick Quote

Add to Large Order List

[view bid cart](#)

Add to "My Project List"

[Compare this item](#)



Mothers Day Sale - \$5 off Orders \$95+



Find anything home...



Home Improvement / Hardware / Cabinet Hardware / Cabinet & Drawer Pulls / SKU: OWU1146

Stainless Steel Cabinet 4" Center to Center Bar Pull

By [Omnia](#)



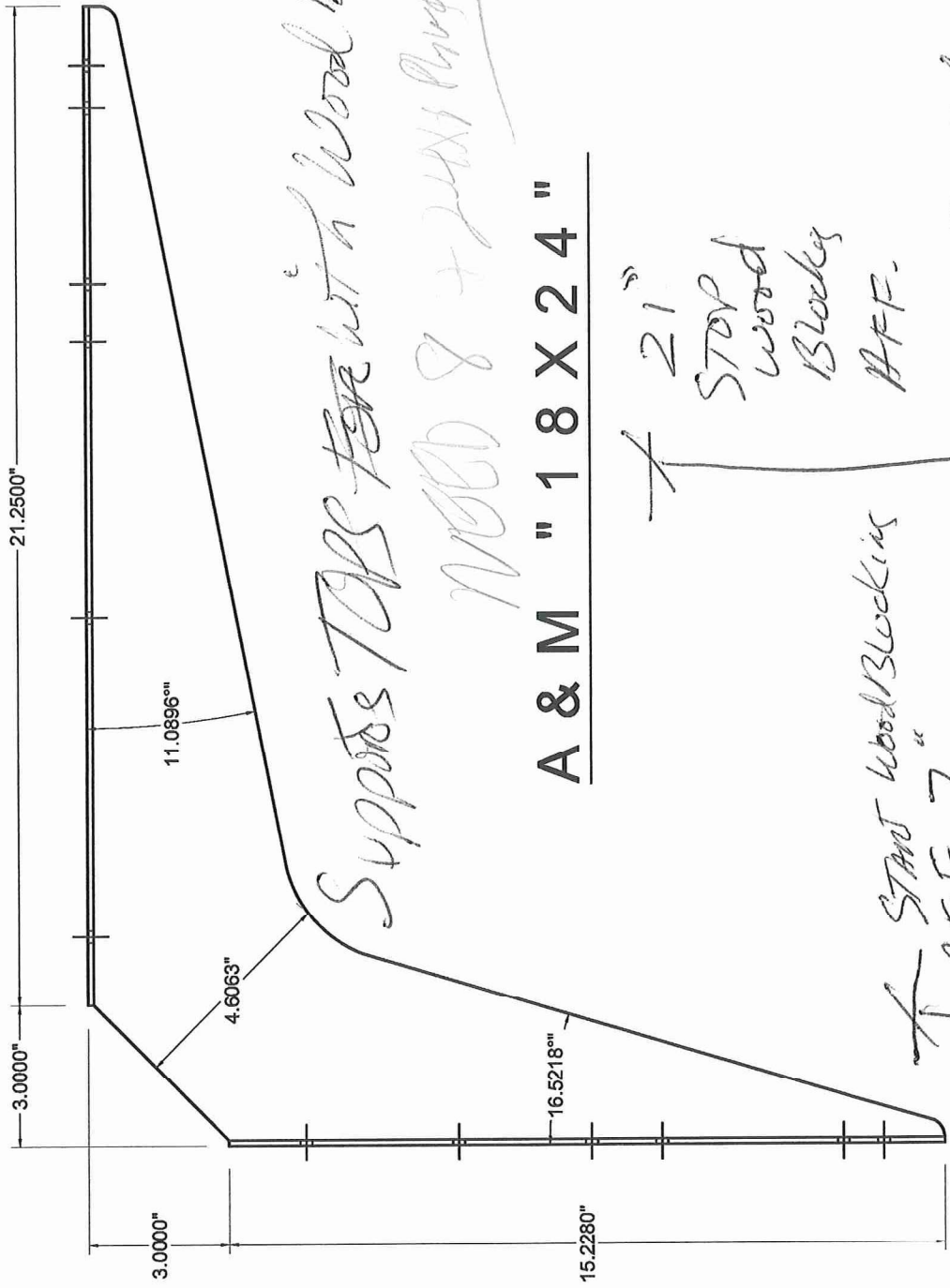
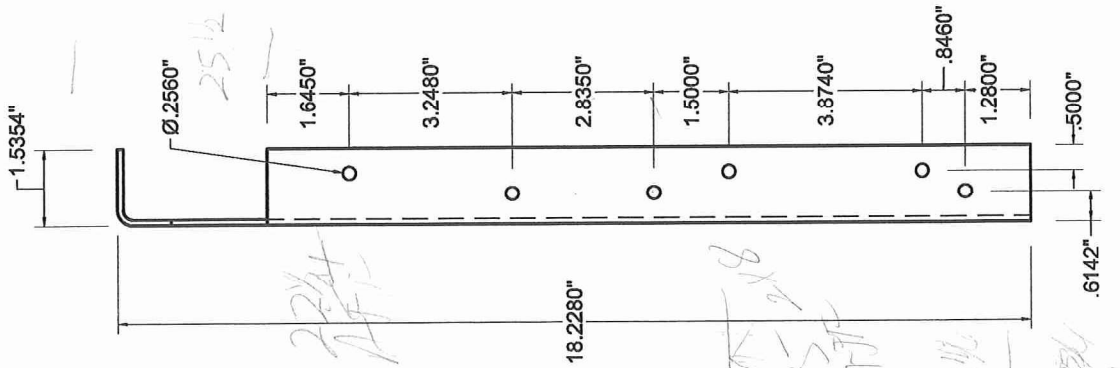
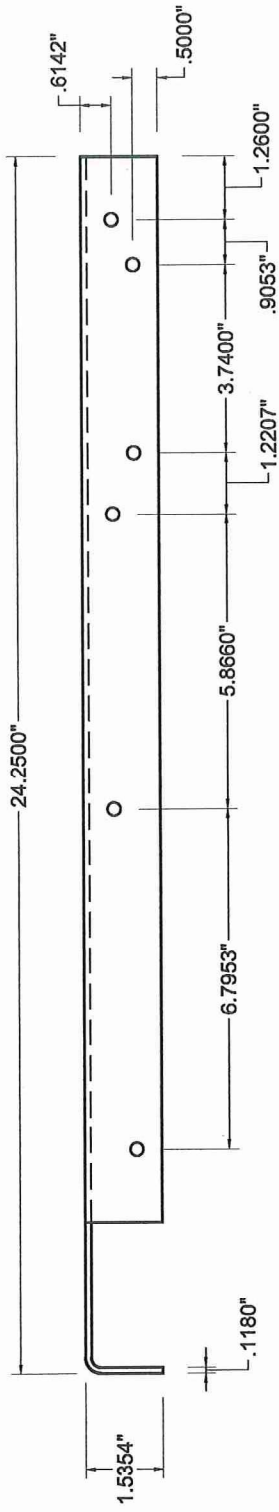

*Supports TOPS here with Wood Blocks
 1/2" 8 + 24x1/2" Prod*

A & M " 18 X 24 "

21" STOP wood Blocks AFF.

START wood Blocking AFF. 7"

NOTE This Blocking is Behind all supports

22x AFF

15x 1/2" Prod

7/16"



STANDARD STEEL BRACKETS

WORK STATION BRACKETS

Extra strong 1/8" steel.

Work Station and Shelf Support Bracket Specs

- Available in US Made and Imported
- A.D.A. brackets for work stations, counter tops and shelves
- 1 1/2" forms with 1/4" mounting holes
- 150,000 in stock and ready to ship
- 500 and 1000 piece pricing available. Call for details.
- Load limit range of 1520 lbs to 2900 lbs per pair
- Now available in Copper, Gold and Silver veined powder coat finish
- Available in a Primer Finish for your own custom paint
- Krinkle powder coat Formica color matches in.



*Benjamin Moore
OC-19 Sea Pearl*

- Black 909-58
- White 933-56
- Gray 961-58
- Almond 920-58
- Brown Pionite ST604*

Bracket Size	6 - 48 Per Bracket		54 - 96 Per Bracket		102+ per bracket		Pcs/Wgt/Box
	USA	Import	USA	Import	USA	Import	
12" x 12"	\$9.25	\$6.95	\$8.80	\$6.50	\$8.35	\$6.05	6 pcs/14 lbs
12" x 18"	\$10.35	\$8.35	\$9.80	\$7.80	\$9.25	\$7.25	6 pcs/18 lbs
15" x 15"	\$11.85	\$8.75	\$11.25	\$8.25	\$10.70	\$7.75	6 pcs/20 lbs
15" x 21"	\$12.65	\$9.50	\$12.10	\$8.95	\$11.55	\$8.40	6 pcs/27 lbs
18" x 18"	\$14.70	\$12.30	\$14.25	\$11.85	\$13.30	\$10.90	6 pcs/26 lbs
18" x 24"	\$16.50	\$13.15	\$16.05	\$12.70	\$15.10	\$11.75	6 pcs/31 lbs
21" x 21"	\$19.00	\$14.90	\$18.05	\$14.20	\$17.10	\$13.30	6 pcs/32 lbs
24" x 24"	\$21.00	\$17.25	\$20.55	\$16.80	\$19.60	\$15.85	6 pcs/48 lbs
24" x 29"	\$23.50	\$19.50	\$22.95	\$18.95	\$22.55	\$18.55	4 pcs/38 lbs
29" x 35"	N/A	\$31.95	N/A	\$30.85	N/A	\$28.55	2 pcs/23 lbs

SHELF SUPPORT BRACKETS

Smaller size - same strength.

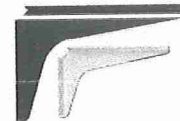

Bracket Size	10 - 50 Per Bracket		60 - 100 Per Bracket		110+ Per Bracket		Pcs/Wgt/Box
	USA	Import	USA	Import	USA	Import	
5" x 8"	\$4.30	\$3.20	\$4.05	\$2.95	\$3.80	\$2.70	10 pcs/10 lbs
8" x 12"	\$7.75	\$6.40	\$7.25	\$5.90	\$6.75	\$5.40	10 pcs/21 lbs

*Brown Pionite ST604 is available on the Import Line only.

A&M HARDWARE, INC.

Call To Order (888) 647-0200

1165 Strickler Road, Mount Joy, PA 17552 | Fax: (717) 653-5874

www.AandMhardware.com