

PILE LOAD  
 MULTI PURPOSE BLDG  
 FOUNDATION SUB  
 INTERIOR GRADE BM

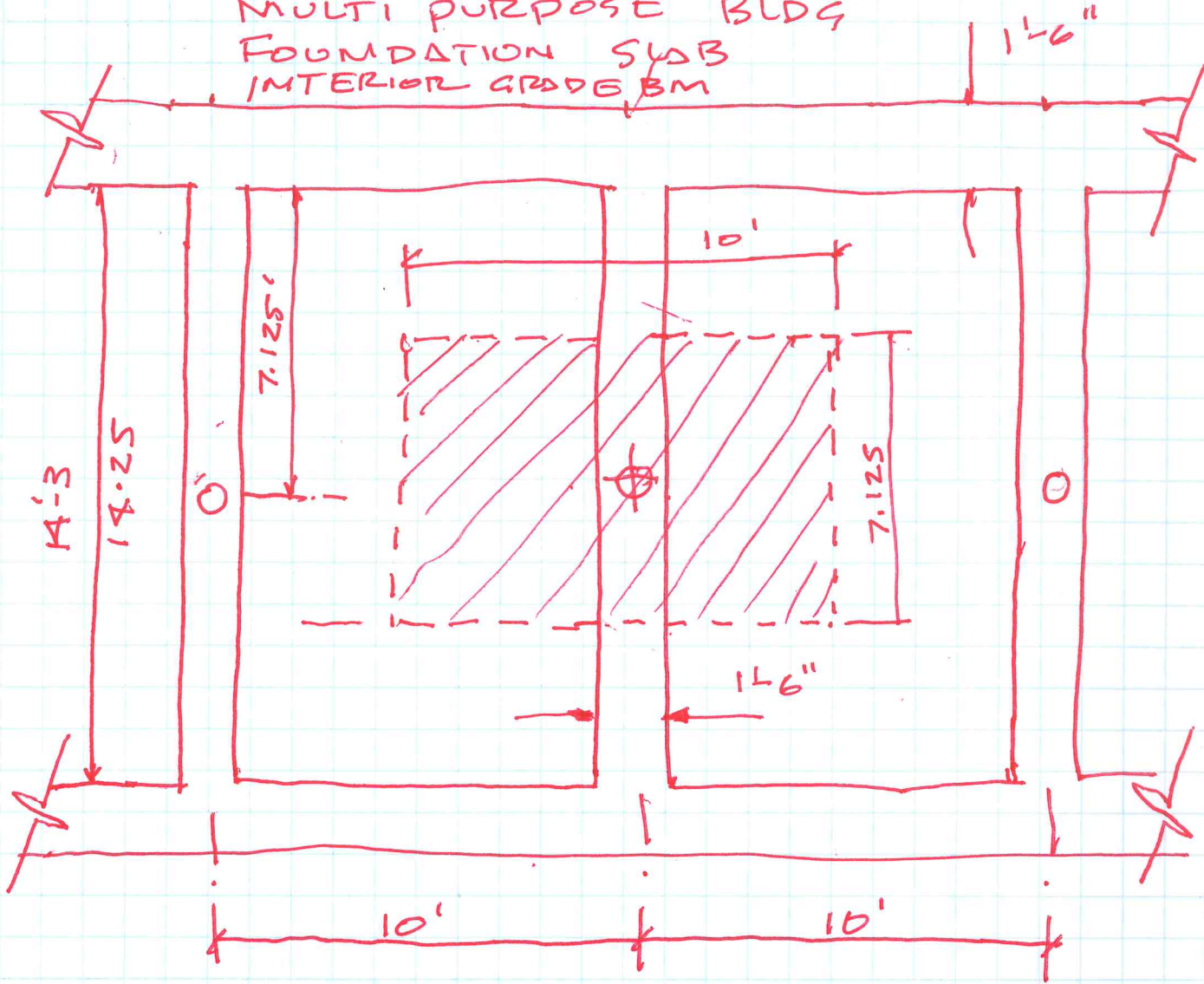

SLAB WT  $150 (5/12) = \underline{62.5 \text{ PSF}}$

GRADE BM WT

TR. B AREA

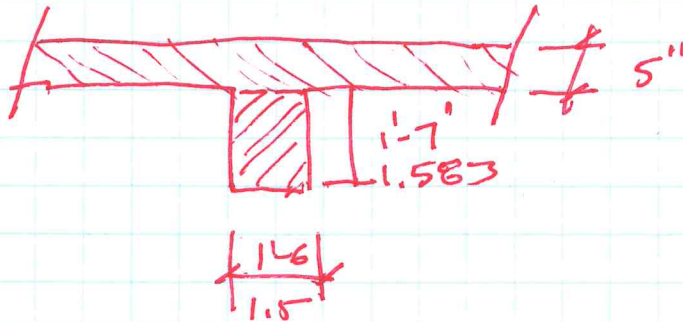

$7.125 \times 10 =$   
 $\underline{71.25 \text{ SF}}$

to  $1.583 \times 1.5 \times 150 = \underline{356.175 \text{ PLF}}$