

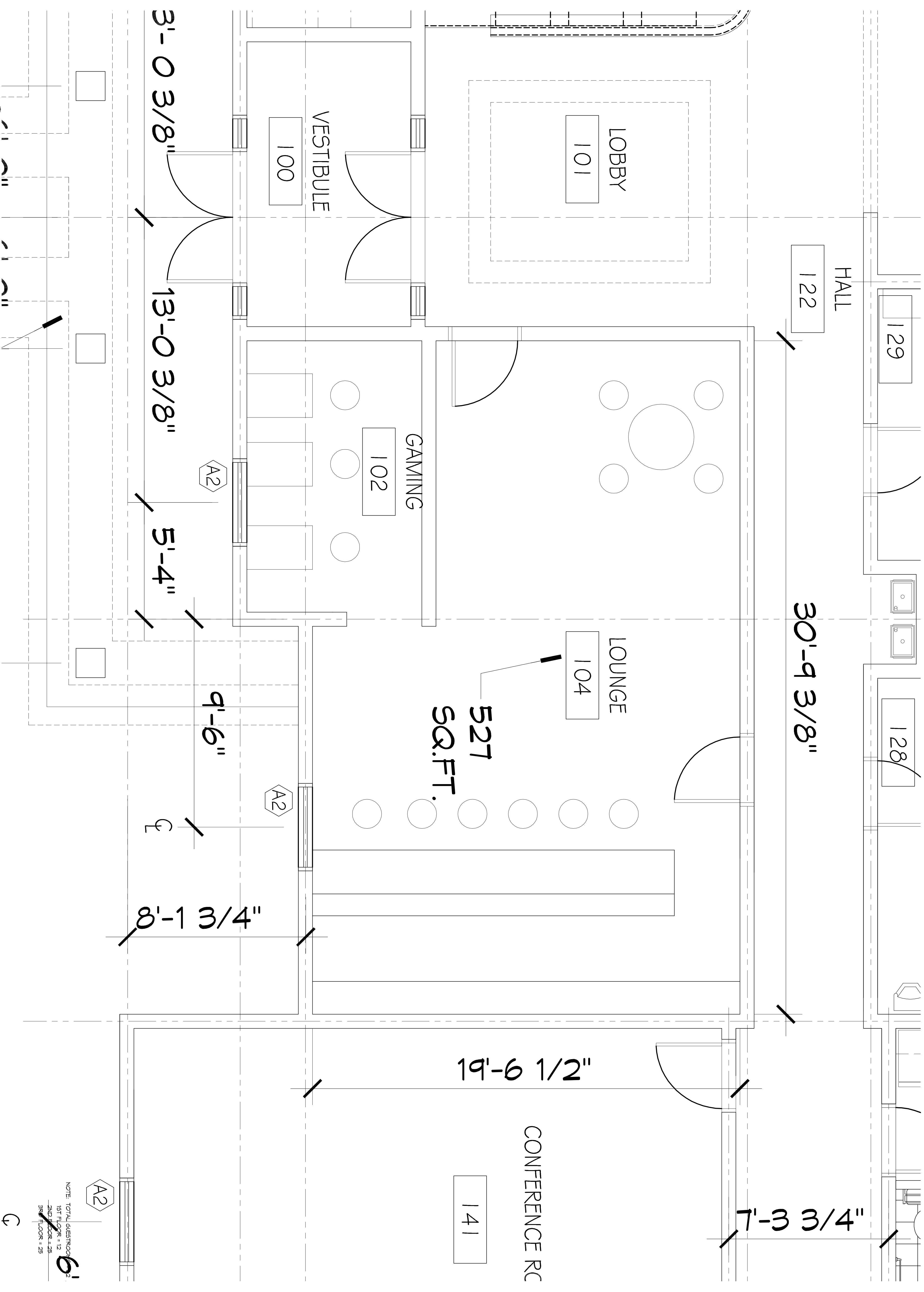

ARCHITECTURAL FLOOR PLAN - LEVEL 1

12 GUESTROOMS



NOTE: TOTAL GUESTROOMS  
1ST FLOOR = 12  
2ND FLOOR = 25  
3RD FLOOR = 25

A2

**MAINSTAY SUITES**

LOT #7 LA HWY 27  
HACKBERRY, LA 70645

JOB No: 2265 DATE: JANUARY, 2016  
DRAWN BY: JTL CHECKED BY: CKD

The above drawings and specifications, together with any amendments thereto, shall constitute the entire contract between the client and Dammon Engineering, Inc. No part thereof shall be copied, reproduced, or used in connection with any work or project other than the specific project for which they have been prepared and approved without written consent of Dammon Engineering. Please contact with those drawings or specifications shall constitute the contract between the client and Dammon Engineering, Inc. No part thereof shall be copied, reproduced, or used in connection with any work or project other than the specific project for which they have been prepared and approved without written consent of Dammon Engineering.

#	DESCRIPTION	DATE

**DAMMON ENGINEERING, INC.**  
LOUISIANA & MISSISSIPPI

Chief Engineer: Brian Mistich, PE  
554 Old Spanish Trail  
Slidell, LA 70458  
www.dammonengineering.com  
info@dammonengineering.com  
PH: 985.649.5832 F: 985.641.5950

SHEET NO: **A101**

DRAWING NUMBER:

1/2" = 1'-0"