

D SECTION SCALE: 1/2" = 1'-0"
E SECTION SCALE: 1/2" = 1'-0"

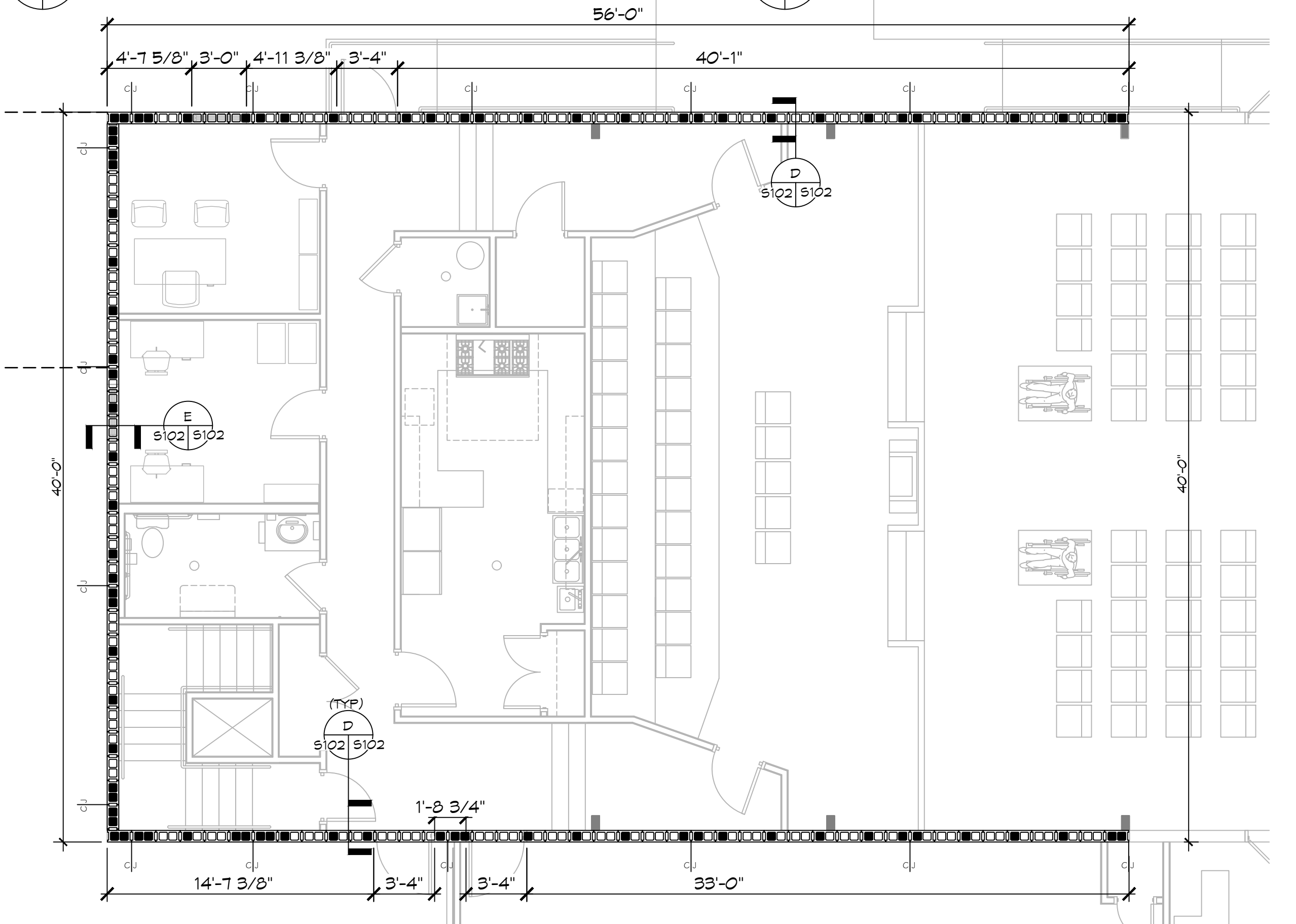

SCMU PLAN SCALE: 3/16" = 1'-0"

MASONRY NOTES

- MASONRY CONSTRUCTION SHALL CONFORM TO ACI BUILDING CODE REQUIREMENTS FOR CONCRETE MASONRY STRUCTURES (ACI 530-99/ASCE 6-95/TMS 602-95) ASTM C476, ASTM C1019, AND NCA TEK 107.
- CONCRETE BLOCKS SHALL CONFORM TO ASTM C-90, (FM = 1500 PSI) (1900 PSI ON THE NET AREA)
- MORTAR SHALL COMPLY WITH ASTM C270, TYPE M (COMPRESSIVE STRENGTH = 2500 PSI SITE TESTED MORTAR CUBES SHALL ACHIEVE A MINIMUM OF 80% OF THE DESIGN COMPRESSIVE STRENGTH)
- BLOCK SHALL NOT BE MOISTENED BEFORE GROUTING.
- ALL MASONRY CROSS WEBS SHALL BE FULLY BEDDED IN MORTAR AROUND CELLS TO BE GROUTED
- VERTICAL REINFORCING MUST BE CENTERED IN THE CAVITY AND SHALL HAVE A MINIMUM CLEARANCE OF 1/2" TO INSIDE FACE. VERTICAL BAR LAP = 48 X BAR DIAMETER U.N.O.. SEE GROUTING DETAIL NOTE FOR CLEANOUT REQUIREMENTS.
- GROUT PLACEMENT STOPPED FOR (1) HOUR OR MORE SHOULD BE STOPPED 1 1/2" BELOW THE TOP OF THE MASONRY UNIT TO PROVIDE A KEY FOR SUBSEQUENT GROUTING
- SEE FOUNDATION PLANS AND WALL SCHEDULE FOR ALL VERTICAL REINFORCING.
- TEMPORARY BRACING AND SHORING OF PIERS DURING CONSTRUCTION TO BE THE RESPONSIBILITY OF THE CONTRACTOR.
- MASONRY CONSTRUCTION MATERIALS AND INSPECTIONS SHALL CONFORM TO ALL REQUIREMENTS OF "SPECIFICATIONS FOR MASONRY STRUCTURES (ACI-ASCE 530.1)" EXCEPT AS MODIFIED BY THE REQUIREMENTS OF THESE DOCUMENTS.
- DO NOT APPLY CONCENTRATED LOADS TO MASONRY WALLS FOR AT LEAST (3) DAYS.
- CONTRACTOR SHALL PROVIDE MOISTURE PROTECTION OF PIER DURING INCLEMENT WEATHER.
- DO NOT GROUT UNTIL MORTAR HAS SET SUFFICIENTLY TO WITHSTAND THE PRESSURE OF THE GROUT. WAIT NOT LESS THAN 24 HOURS.
- WAIT A MINIMUM OF 40 MINUTES BEFORE PLACING NEW GROUT ON A PREVIOUS LIFT.
- MAXIMUM WALL HEIGHT FROM TOP OF PREVIOUS GROUT POURS LAID UP AT ONE TIME SHALL BE 12'-0".
- THE MINIMUM CONTINUOUS UNOBSTRUCTED CLEAR AREA IN CELL TO RECEIVE GROUT MUST BE NOT LESS THAN 3'X3". MORTAR FINIS MUST BE REMOVED AS BLOCKS PLACEMENT PROCEEDS. MORTAR DROPPINGS MUST BE KEPT OUT OF CELLS WHICH ARE TO BE GROUTED.

LEGEND

- INDICATES CONTINUOUS NO. 5 VERTICAL REINF. W/ 3000 PSI CONCRETE FILL.
- INDICATES MASONRY CONTROL JOINT. SEE DETAIL THIS SHEET

CMU LINTEL SCHEDULE

WIDTH (W)	CLEAR SPAN	DEPTH (D)	HORZ. REINF.
8" TYP AT ALL CMU WALLS	UP TO 3'-4"	8"	(1) #6 BOTTOM
	UP TO 6'-4"	16"	(1) #6 T&B
	UP TO 14'-0"	24"	(2) #6 T&B

PROVIDE 3000 PSI PEA-GRAVEL CONCRETE FILL FOR ALL LINTELS.

TYPICAL MASONRY CONTROL JOINT
SCALE: N.T.S.

CONTROL JOINT SEALER AND BACKER ROD @ INTERIOR FACE
 LADDER TYPE JOINT REINFORCING INTERRUPT AT CONTROL JOINT
 PROVIDE VERT. WALL REINF. IN FIRST CELL OF EACH SIDE CONTROL JOINT. SIZE BARS TO MATCH VERT. WALL REINF. SCHEDULED
 PROVIDE 3000 PSI PEA-GRAVEL CONCRETE FILL
 PREFORMED CONTROL JOINT GASKET
 CONTROL JOINT SEALER AND BACKER ROD @ INTERIOR FACE

NOTES:
 1. MAX. JOINT SPACING = 15'.
 2. PROVIDE MIN 50% EXTENSIBILITY OF JOINT MATERIAL.

TYPICAL REINF. @ CORNER OF MASONRY
SCALE: N.T.S.

CONT. HORZ. CORNER BAR MIN. 24" LONG EACH LEG AT EACH BOND BEAM
 EXTEND HORZ. LADDER TYPE JOINT REINF. TO END OF WALL IN BOTH DIRECTIONS SO THAT IT LAPS AT THE CORNER
 VERT. WALL REINF. IN CORNER CELL SIZE BAR TO MATCH VERTICAL WALL REINF. SCHEDULED

CONTROL JOINT @ BOND BEAM
SCALE: N.T.S.

INTERRUPT HORZ. REINF. IN BOND BEAM AT CONTROL JOINT LOCATIONS
 (1) #5 SMOOTH DOWEL 2'-8" LONG. APPLY GREASE TO ONE END
 CONTROL JOINT SEALER AND BACKER ROD

NOTES:
 1. MAX. JOINT SPACING = 15'.
 2. PROVIDE MIN 50% EXTENSIBILITY OF JOINT MATERIAL.

TYPICAL MASONRY WALL OPENING DIAGRAM
SCALE: N.T.S.

OPENING WIDTH REF ARCH PLANS
 OPENING HEIGHT REF ARCH PLANS
 2'-0" FOOTING
 JAMB
 LINTEL
 CMU U-BLOCK BOND BEAM WITH HORZ. REINF. PER LINTEL SCH.

8" AT OPENING UP TO 3'-4"
 16" AT OPENING UP TO 8'-8"
 24" AT OPENING UP TO 10'-0"

2-3/4" (2) no. 5 BARS FOR LENGTH REQ. (TYP.)

NOTES: #
 1. WHERE HORZ. REINFORCEMENT IS INTERRUPTED BY OPENING OR CONTROL JOINT PROVIDE STANDARD ACI HOOK WITH VERT. WALL REINF. AT END CELL.
 2. SPLICES IN VERT. REINF. REF. WALL SECTIONS S-3.
 3. ALL VERT. BARS AT DOOR JAMBS TO BE FULL HEIGHT.
 4. CONTINUE VERT. WALL REINF. OVER OPENING. ANCHOR VERT. REINF. INTO LINTEL BEAM WITH STANDARD ACI HOOK.
 5. EXTEND LINTEL A MIN. 2'-0" BEYOND FACE OF OPENING EACH SIDE FOR STRAIGHT LINTEL REINF. AND 1'-0" FOR LINTEL REINF. WITH STANDARD ACI HOOK.

DAMMON ENGINEERING, INC.
 LOUISIANA & MISSISSIPPI
 Chief Engineer: Brian Watch, PE
 554 Old Spanish Trail
 Slidell, LA 70468
 www.dammonengineering.com
 info@dammonengineering.com
 PH: 985.649.5832 F: 985.641.9590

DATE	REVISIONS
	# DESCRIPTION

DATE	BY	CHECKED BY
24-11-2025	BAM	C&D

THE SIXTH URCHIN AND THE SUSTAINMENT FOUNDATION
 428 FELICITY STREET
 NEW ORLEANS, LA 70130
 JOB No: 24-11-2025
 DATE: 08-11-2025
 DRAWN BY: BAW
 CHECKED BY: C&D

SHEET TITLE: CMU PLAN
 DRAWING NUMBER:
S102
 SHEET No: 2 of 14