

FILE NAME: J:\1 - CLIENTS\1st Floor Residential\Drawings\1st Floor\1st Floor.dwg, PLOT DATE: 08/26/2025, PLOT TIME: 10:29:25 AM, PLOT BY: JLD

### FINISH SCHEDULE

ROOM	FLOOR	BASE	WALLS				CEILING	NOTES
			NORTH	EAST	SOUTH	WEST		
LIVING ROOM	VINYL PLANK	6" MOOD BASE	1/2" GNB	1/2" GNB	1/2" GNB	1/2" GNB	1/2" GNB	
KITCHEN	VINYL PLANK	6" MOOD BASE	1/2" GNB	1/2" GNB	1/2" GNB	1/2" GNB	1/2" GNB	
HALL	VINYL PLANK	6" MOOD BASE	1/2" GNB	1/2" GNB	1/2" GNB	1/2" GNB	1/2" GNB	
BEDROOMS	VINYL PLANK	6" MOOD BASE	1/2" GNB	1/2" GNB	1/2" GNB	1/2" GNB	1/2" GNB	
BATHROOM	CERAMIC 8" HEXAGON	CERAMIC	1/2" MR GNB	1/2" MR GNB	1/2" MR GNB	1/2" MR GNB	1/2" MR GNB	PENNY TILE INSTALLED IN SHOWER PAN WITH LINEAR DRAIN. 12"X24" SHOWER WALL TILE INSTALLED TO CEILING
UTILITY ROOM	CERAMIC 8" HEXAGON	CERAMIC	1/2" GNB	1/2" GNB	1/2" GNB	1/2" GNB	1/2" GNB	PAINT WALLS WITH TWO PART EPOXY

NOTE - (MR) MOLD RESISTANT

NOTE: OWNER TO PICK ALL FINISHES

### SQUARE FEET

LIVING	1040
FRONT PORCH	84
<b>TOTAL SQ. FT.</b>	<b>1124</b>

### WINDOW SCHEDULE

MK	WIDTH	HEIGHT	FRAME MAT	NOTES
W01	3'-0"	5'-0"	ALUM	OPERABLE WINDOW INSULATED
W02	3'-0"	3'-0"	ALUM	OPERABLE WINDOW INSULATED
W03	3'-0"	1'-0"	ALUM	FIXED WINDOW INSULATED

NOTE: OWNER TO PICK ALL WINDOW STYLES

### DOOR SCHEDULE

MK	WIDTH	HEIGHT	THK	DOOR MAT	FRAME MAT	NOTES
D01	3'-0"	6'-10"	1-3/4"	WOOD	WOOD	EXTERIOR DOOR
D02	(2)3'-0"	6'-10"	1-3/4"	WOOD	WOOD	EXTERIOR SLIDING DOUBLE DOOR
D03	3'-0"	6'-8"	1-3/4"	WOOD	WOOD	INTERIOR DOOR
D04	1'-8"	6'-8"	1-3/4"	WOOD	WOOD	INTERIOR DOOR FOR LINEN CLOSET
D05	(2)3'-0"	6'-8"	1-3/4"	WOOD	WOOD	INTERIOR DOUBLE ACCORDION DOORS

NOTE: OWNER TO PICK ALL DOOR STYLES

NOTE: ALL EXTERIOR WINDOWS AND DOORS ASSEMBLES TO BE RATED FOR 140 MPH WINDS AND SHALL BE MISSILE IMPACT RESISTANT.

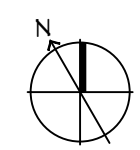
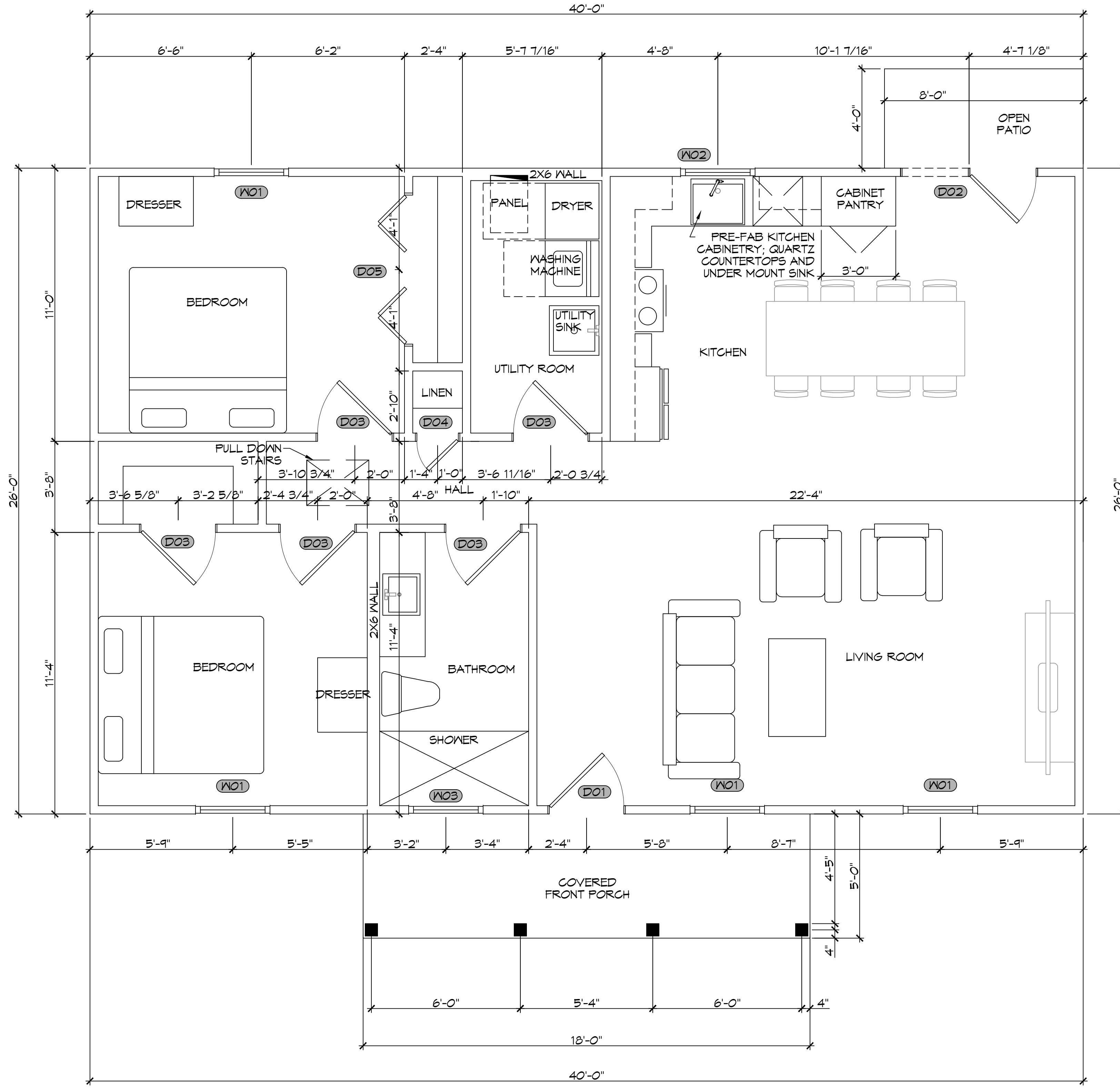

**1st FLOOR PLAN**  
SCALE: 3/8" = 1'-0"

**DAMMON ENGINEERING, INC.**  
 LOUISIANA & MISSISSIPPI  
 Chief Engineer: Brian Misch, PE  
 554 Old Spanish Trail  
 Slidell, LA 70458  
 www.dammonengineering.com  
 info@dammonengineering.com  
 PH: 985-649-5832

#	DESCRIPTION	DATE

SEAL:

**IRSTECHO**  
**AL FURNITURE**  
 388 ROBERT BLVD  
 SLIDELL, LA 70458  
 JOB No: 02-30-2025  
 DATE: 02-30-2025  
 DRAWN BY: SCK  
 CHECKED BY: CKD

SHEET TITLE:  
FLOOR PLAN

DRAWING NUMBER:  
**A101**

SHEET No: 1 of 2



