

P:\E. MUELLER - CIVIL - COMMERCIAL\Drawings\C101 - SITE PLAN.dwg, 11/20/25, 11:27:07 AM

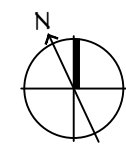
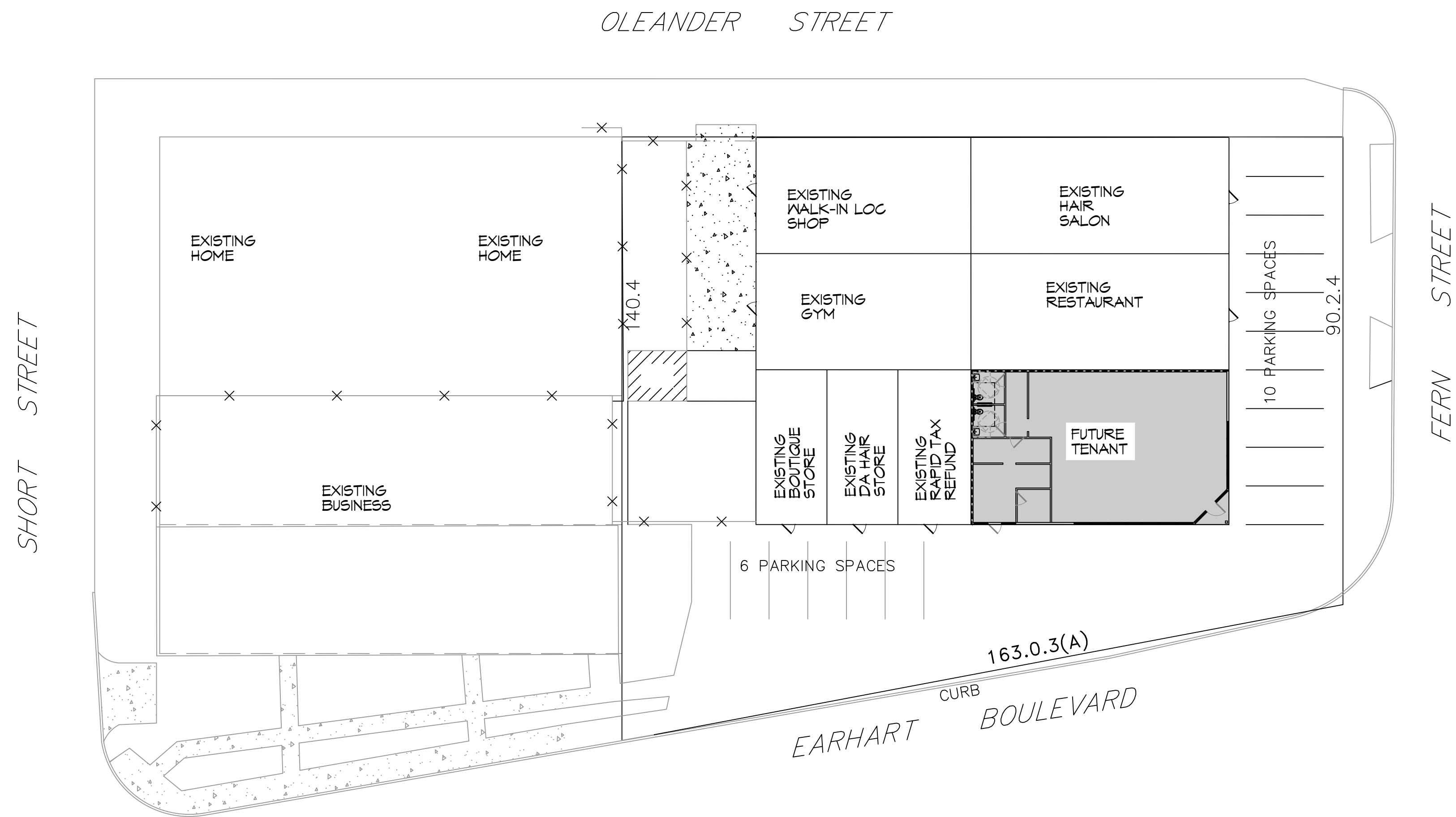

1 EXISTING SITE PLAN
SCALE: 1" = 20'-0"

PLANNING	PARKING REQUIREMENTS
ZONING - HISTORIC URBAN DESCRIPTION - NEIGHBORHOOD MIXED USE DISTRICT	OFF SITE PARKING

#	DESCRIPTION	DATE

SEAL:

SUITE A&B RETAIL STRIP
NORTON EARHEART
3102 FERN ST
NEW ORLEANS, LA 70125
JOB No: _____
DRAWN BY: _____
DATE: 05-01-2025
CHECKED BY: JMS



SHEET TITLE:
EXISTING SITE PLAN

DRAWING NUMBER:
C101
SHEET No: 2 of 6

DAMMON
ENGINEERING, INC.
LOUISIANA & MISSISSIPPI

Chief Engineer: Brian Wistich, PE
554 Old Spanish Trail
Slidell, LA 70468
www.dammonengineering.com
info@dammonengineering.com
PH: 985.649.5832

FILE NAME: \\s:_comm\chris\MOA\Comm\Demog\2101 - Demo Floor Plan.dwg, PLOT DATE: 6/16/2025, 11:27:14 AM

DEMO LEGEND	
	EXISTING TO REMAIN
	DEMO

GENERAL DEMO NOTES

1. THIS DEMOLITION PLAN HAS BEEN DERIVED FROM EXISTING BUILDING PLANS AND ARE INTENDED TO REASONABLY REPRESENT EXISTING CONDITIONS. ENGINEER DOES NOT GUARANTEE ACCURACY OF THE EXISTING CONDITIONS. CONTRACTOR TO FIELD VERIFY EXISTING CONDITIONS IN AREAS TO BE RENOVATED PRIOR TO BID IN ORDER TO PROVIDE AN ACCURATE BID AND BE AWARE OF ALL CONSTRUCTION METHODS NEEDED TO PROVIDE THE FINISHED PRODUCT AS SHOWN ON THE PLANS. ILLUSTRATIONS, DIMENSIONS, AND INFORMATION IN THESE DRAWINGS ARE BASED, IN PART, ON EXISTING DRAWINGS FURNISHED BY THE OWNER. ACTUAL CONDITIONS MAY DEVIATE FROM THAT SHOWN ON THE DRAWINGS. THE CONTRACTOR SHALL VERIFY ACTUAL CONDITIONS AND COORDINATE THE DEMOLITION WITH NEW WORK SO THAT DEMOLITION IS COMPLETE.
2. THE CONTRACTOR SHALL COORDINATE REMOVAL OF SMOKE AND OTHER FIRE ALARM ADDRESSABLE UNITS ATTACHED TO THE AHU WITH THE FIRE ALARM CONTRACTOR PRIOR TO REMOVAL.
3. THE CONTRACTOR SHALL TAKE ALL NECESSARY PRECAUTIONS TO ENSURE THE SAFETY OF THE PUBLIC AND/OR WORKMEN ON THE SITE TO PREVENT ACCIDENTS OR INJURY TO ANY PERSON ON OR ADJACENT TO THE PREMISES. THE CONTRACTOR SHALL COMPLY WITH ALL LAWS, ORDINANCES, AND REGULATIONS PERTAINING TO SAFETY AND THE PREVENTION OF ACCIDENTS.
4. ALL EXISTING STEEL FRAMING MEMBERS (COLUMNS, BEAMS, JOISTS, DECK, ETC...) SHALL REMAIN INTACT AND UNDAMAGED.
5. WHEN DEMOLITION TAKES PLACE, SHOULD ANY WORK AFFECT THE INTEGRITY OF THE STRUCTURE, WORK MUST STOP IMMEDIATELY, AND DAMMON ENGINEERING NOTIFIED. UNDER NO CIRCUMSTANCES SHALL REINFORCING OF ANY KIND BE DAMAGED, CUT, OR BROKEN.
6. EXISTING ITEMS, EQUIPMENT, PLUMBING FIXTURES, ETC. TO REMAIN IN PLACE SHALL BE PROTECTED FROM DIRT AND DAMAGE DURING DEMOLITION AND CONSTRUCTION.
7. ALL OPENINGS AND VOIDS LEFT BY THE REMOVAL OF EXISTING CONSTRUCTION, EQUIPMENT, PIPING, DUCTS, ETC. SHALL BE PROPERLY PATCHED AND CLOSED OFF TO MAINTAIN PROPER FIRE RATING IN WALL. PREPARE PATCHES TO RECEIVE NEW FINISHES AS REQUIRED.
8. WHERE A RATING HAS BEEN GIVEN TO AN EXISTING WALL, ALL PENETRATIONS (EXISTING OR NEW) MUST BE SEALED AND PROPERLY FIREPROOFED PER THAT RATING REQUIREMENT.
9. REMOVAL OF EXISTING HVAC SHALL INCLUDE DUCT WORK HANGERS, GRILLES, DIFFUSERS, THERMOSTATS, ETC. AS REQUIRED TO COMPLETE DEMOLITION.

GYPSTUM DEMO NOTES

1. REMOVE THE MINIMUM AMOUNT OF SUSPENDED GYPSTUM CEILING AS REQUIRED TO ACCOMPLISH WORK INDICATED IN THESE DOCUMENTS. ALL GYPSTUM CEILING BOARD AND RELATED SUPPORT SYSTEMS TO BE REMOVED SHALL INCLUDE GYPSTUM CEILING BOARD, LIGHT FIXTURES, GRILLES, DIFFUSERS, EXIT SIGNS, ELECTRICAL, COMMUNICATIONS, ETC. EXISTING LIGHT FIXTURES, EXIT SIGNS AND COMMUNICATIONS.
2. ALL OPENINGS AND VOIDS LEFT BY THE REMOVAL OF EXISTING CONSTRUCTION, EQUIPMENT, PIPING, DUCTS, ETC. SHALL BE PROPERLY PATCHED AND CLOSED OFF TO MAINTAIN PROPER FIRE RATING IN WALL. PREPARE PATCHES TO RECEIVE NEW FINISHES AS REQUIRED.
3. REMOVE ALL FIRE DAMAGED MATERIALS.
4. ALL FIRE RATED WALLS AND CEILING SHALL REMAIN IN PLACE.

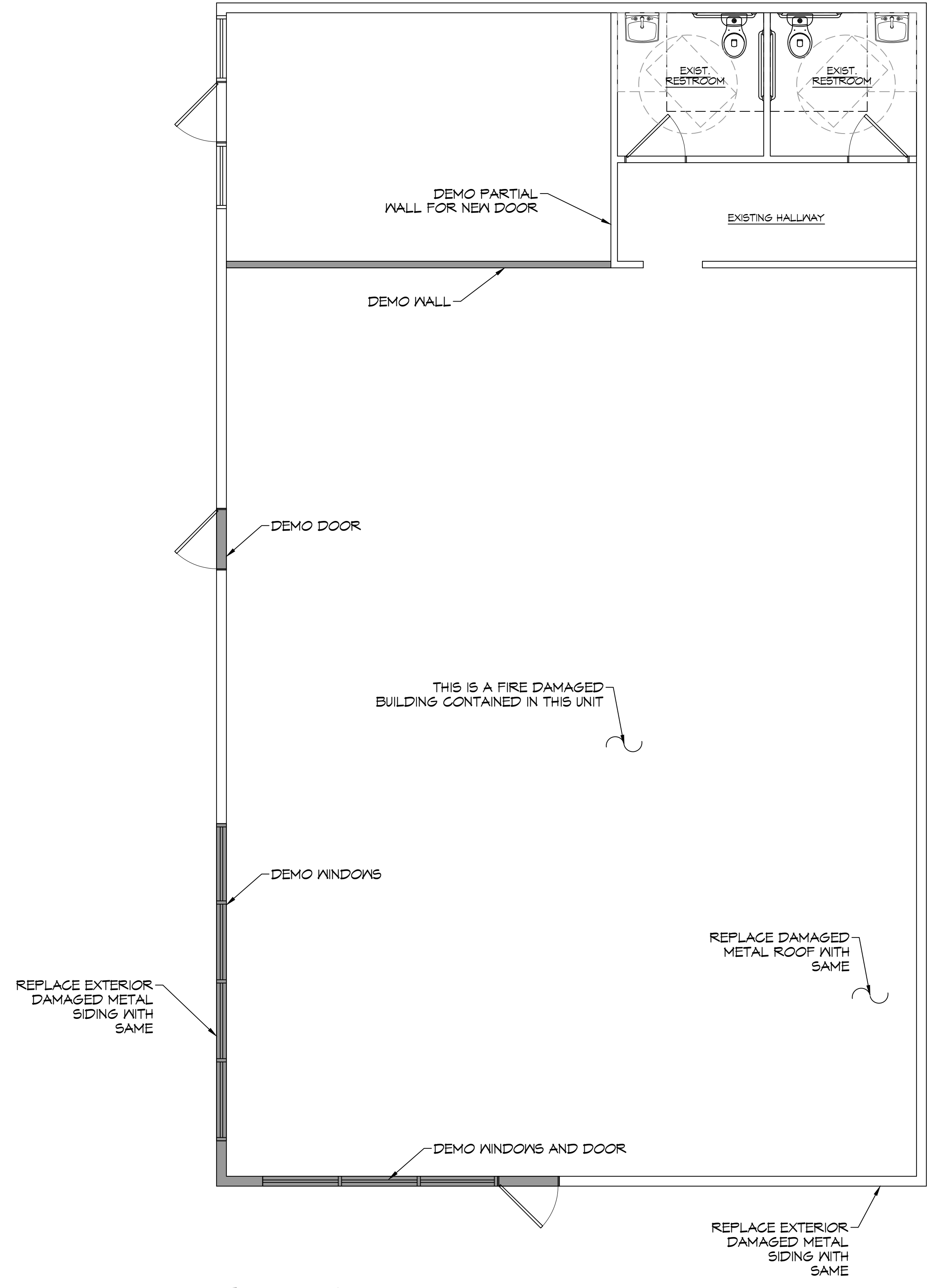

2 DEMO FLOOR PLAN
SCALE: 1/4" = 1'-0"

DAMMON ENGINEERING, INC.
LOUISIANA & MISSISSIPPI

www.dammonengineering.com
info@dammonengineering.com
PH: 985.649.5832

Chief Engineer: Brian Alstich, PE
554 Old Spanish Trail
Stell, LA 70458

REVISIONS	DATE
# DESCRIPTION	

SEAL:

SUITE A&B RETAIL STRIP
NORTON EARHEART

3102 FERN ST.
NEW ORLEANS 70125

JMS
DATE: 05-01-2025
DRAWN BY: SCGK
CHECKED BY:

SHEET TITLE:
DEMO FLOOR PLAN

DRAWING NUMBER:
D101

SHEET No: 3 of 6

