

FILE NAME: J:\Projects\2025\112813\112813.dwg  
 DATE: 04/16/2025 11:28:13 AM  
 USER: brian.mistich  
 PLOT DATE: 04/16/2025 11:28:13 AM  
 PLOT SCALE: 1/8" = 1'-0"  
 PLOT SHEET: 1 OF 2

PLANNING	PARKING REQUIREMENTS
ZONING - C-3 CENTRAL BUSINESS DISTRICT	EXISTING BUILDING = 2190 SQ. FT.
	FLOOR SPACE 89 SQ. FT.
	4.220 AUTOMOBILE REPAIR SHOP
	1 SPACE PER 200 SQUARE FOOT OF FLOOR SPACE.
	EXISTING FOUR PARKING SPACES + ONE NEW HANDICAP PARKING SPACE
	TOTAL OF 5 PARKING SPACES PROVIDED

DAMMON

ENGINEERING, INC.

LOUISIANA & MISSISSIPPI

Chief Engineer: Brian Mistich, PE  
 554 Old Spanish Trail  
 Slidell, LA 70468  
 www.dammonengineering.com  
 info@dammonengineering.com  
 PH: 985.649.9832

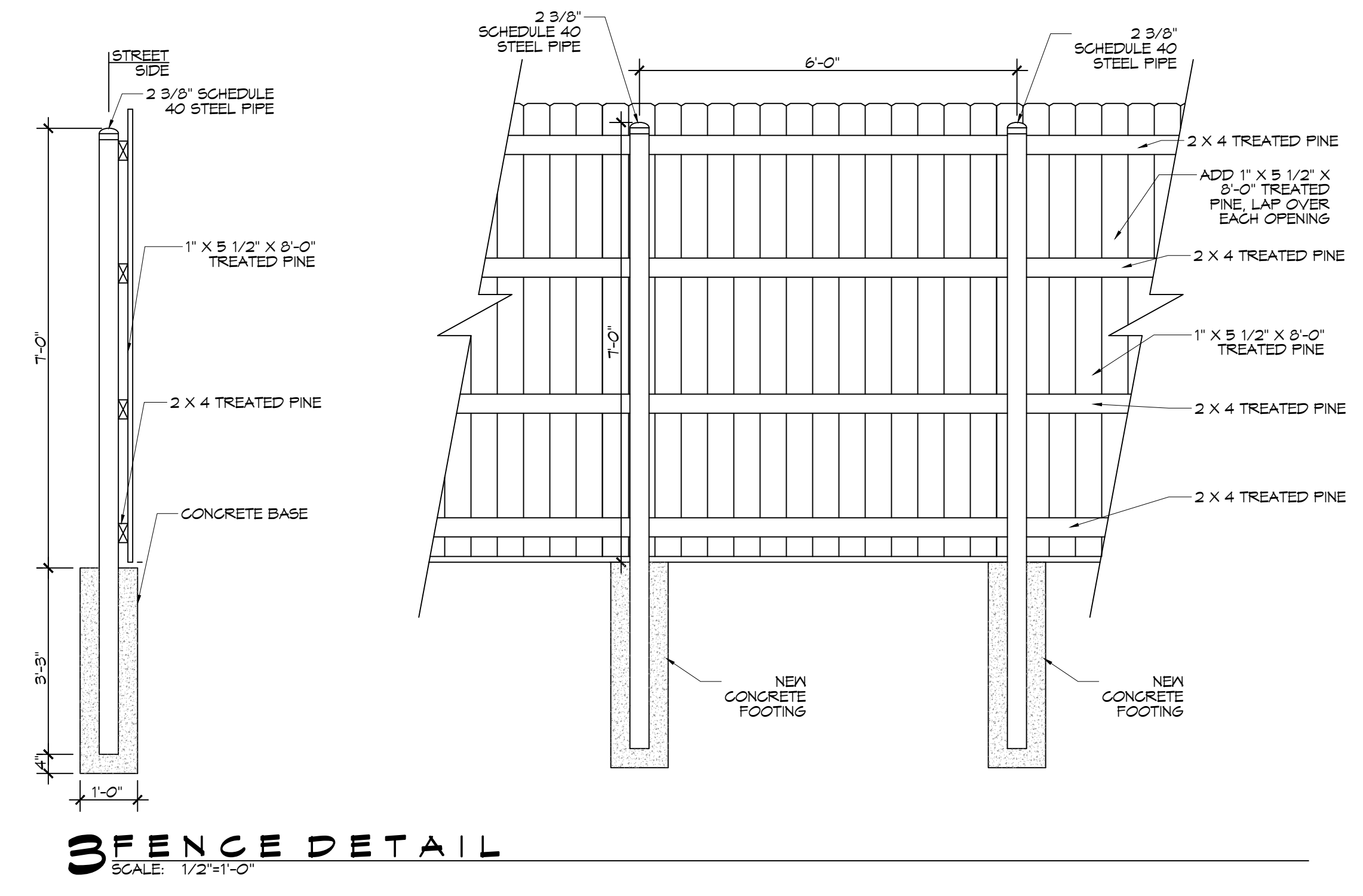
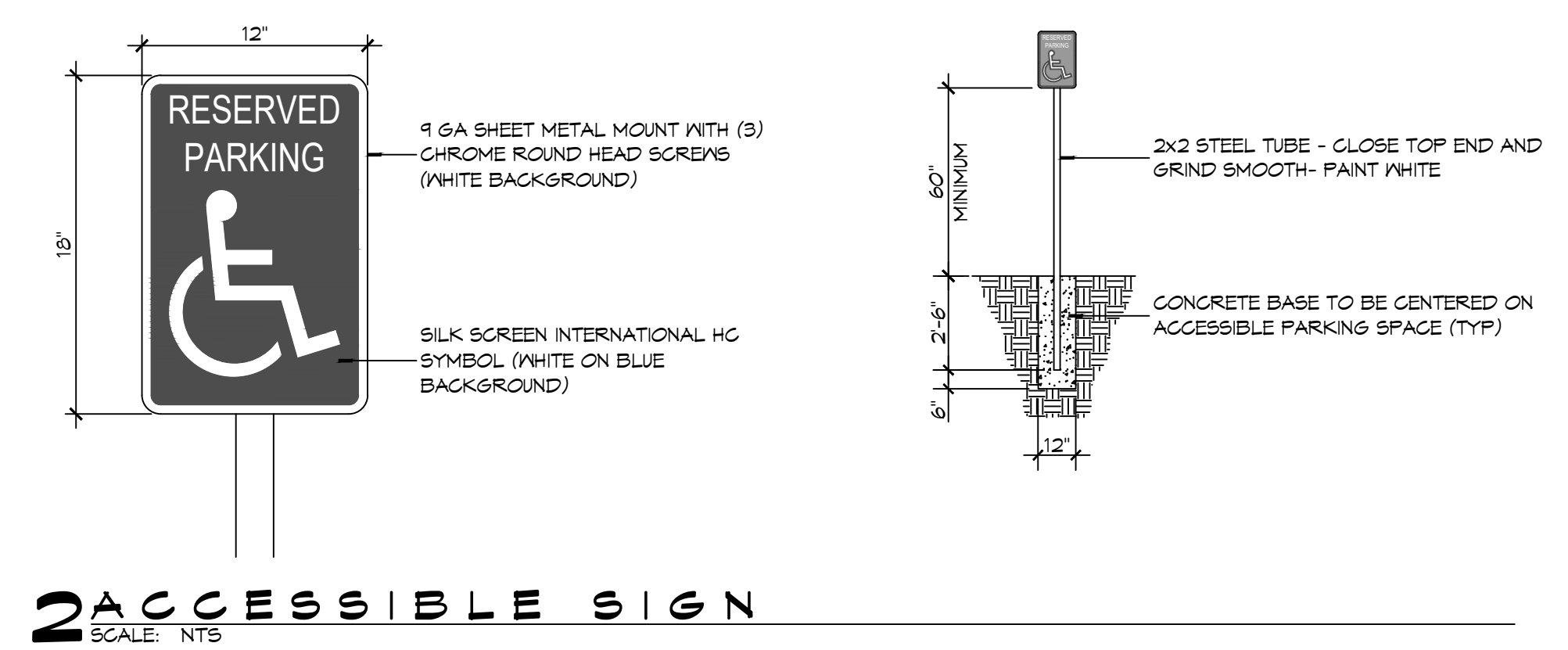
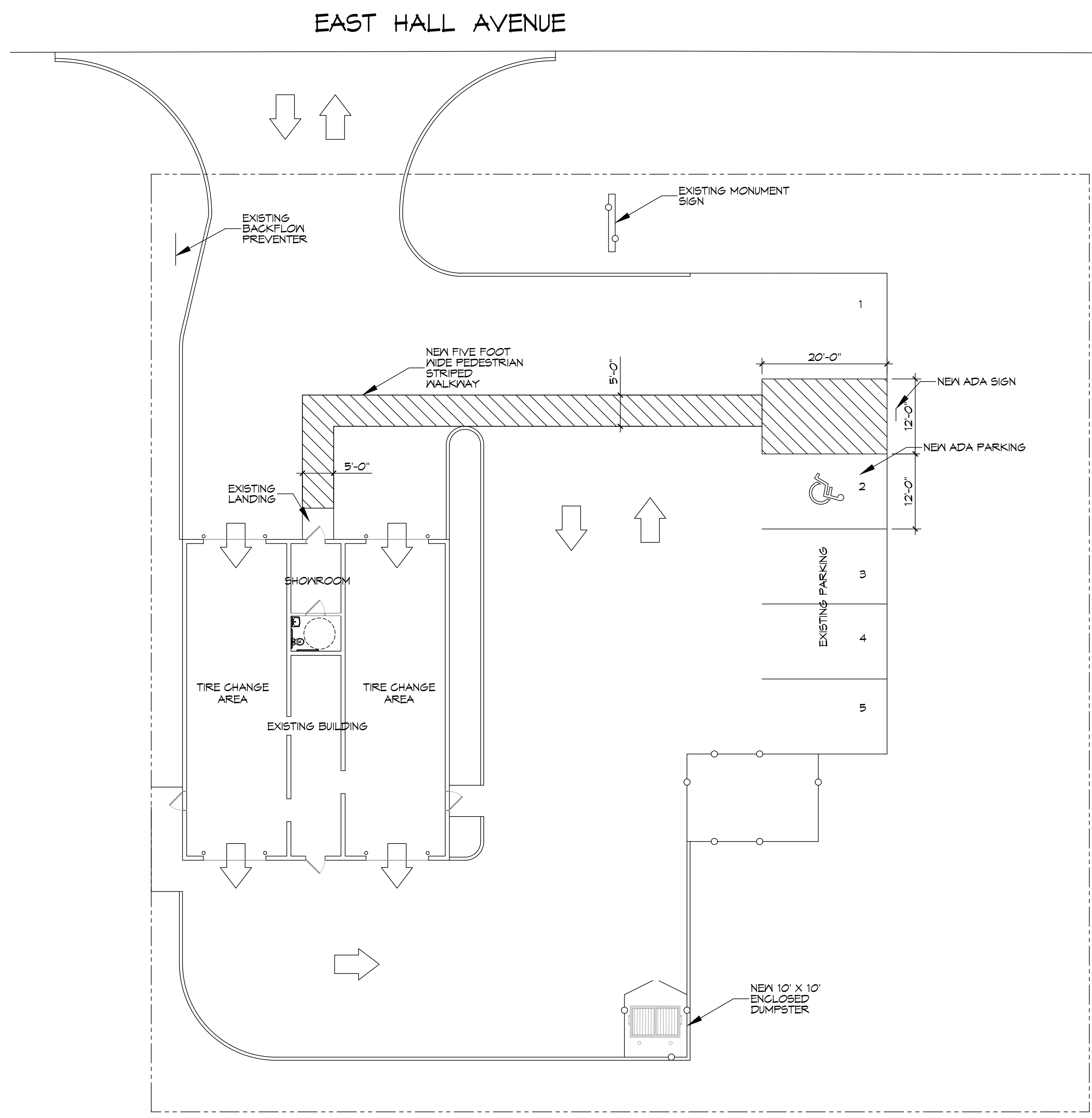

#	DESCRIPTION	DATE

SEAL:

TIRE REPAIR SHOP

SLIDELL TIRE SERVICE

189 EAST HALL AVENUE  
 SLIDELL, LA 70468  
 JOB No: \_\_\_\_\_  
 DATE: 04-16-2025  
 DRAWN BY: BMM  
 CHECKED BY: CKD

SHEET TITLE:  
EXISTING SITE PLAN

DRAWING NUMBER:  
**C101**

SHEET No: 1 of 2