

DATE: 07-15-2023, TIME: 10:45 AM, PROJECT: 2102B, 10TH STREET, SULLY, LOUISIANA, 70459

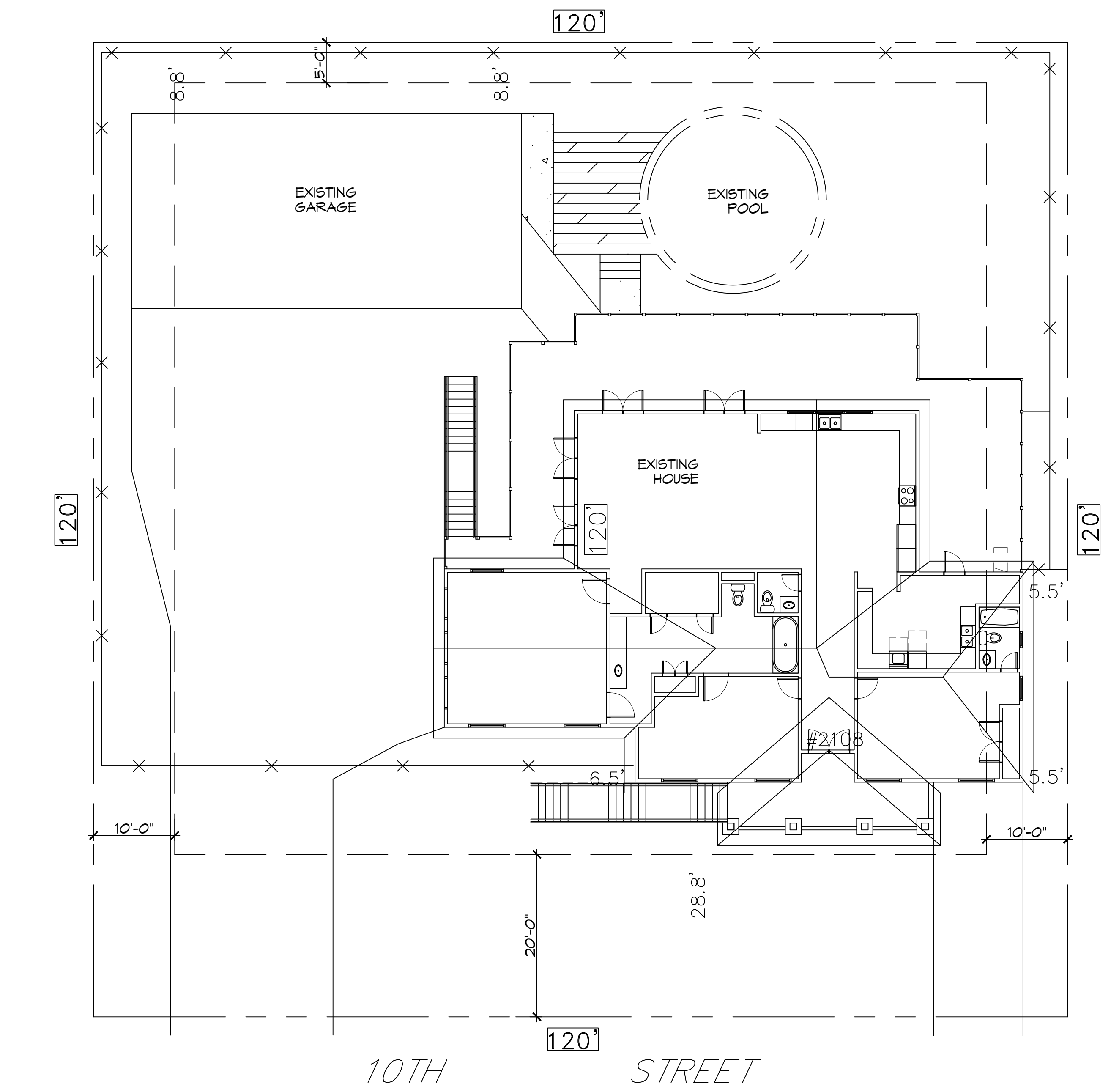

1 SITE PLAN
SCALE: 1" = 10'-0"

ZONING

A8 HIGH DENSITY URBAN

FLOOD ZONE

FLOOD ZONE: AE B.F.E.=11.0' F.F.E.=13.00'

SQUARE FOOTAGE

LIVING = 2514 SQ. FT.
FRONT PORCH = 172 SQ. FT.
BACK PORCH = 1071 SQ. FT.
TOTAL SQ. FT. = 3,757 TOTAL SQ. FT.

DESIGN CRITERIA

THE CONSTRUCTION FOR SAID RESIDENCE, WHERE V_{WIND} WIND SPEED IS 140 MILES PER HOUR AND V_{BASED} WIND SPEED IS 130 MPH, WIND EXPOSURE ZONE C, IS DESIGNED IN ACCORDANCE WITH: AMERICAN FOREST AND PAPER ASSOCIATION (AF&PA) WOOD FRAME CONSTRUCTION MANUAL FOR ONE AND TWO FAMILY DWELLINGS (WFCM) 2001 EDITION AS WELL AS THE INTERNATIONAL RESIDENTIAL CODE (IRC) 2021 EDITION. STRUCTURE SHALL BE BUILT TO THE 2021 INTERNATIONAL ENERGY CONSERVATION CODE (2021 IECC) AND STATE AMENDMENTS ADOPTED JULY 1, 2023.

SHEET INDEX

SHEET #	SHEET TITLE
C101	SITE PLAN
A101	FLOOR PLAN
A102	FRONT AND REAR ELEVATION
A103	LEFT AND RIGHT ELEVATION

DAMMON ENGINEERING, INC.
LOUISIANA & MISSISSIPPI

www.dammonengineering.com
info@dammonengineering.com
PH: 985-649-5832

Chief Engineer: Brian Mischick, PE
554 Old Spanish Trail
Slidell, LA 70458

#	DESCRIPTION	DATE

SEAL:

HOUSE PLAN

JAMIE GOMEZ

2102B 10TH STREET
SULLY, LOUISIANA, 70459

JOB No: _____
DATE: 07-15-2023
DRAWN BY: LJP
CHECKED BY: BAM

SHEET TITLE:
SITE PLAN

DRAWING NUMBER:
C101

SHEET No: 1 of 4

