

TABLE S601.7 - UPLIFT CONNECTIONS - 140 MPH WINDS EXP "B"
NFCM 2015 TABLE 3.2

CONNECTION	FRAMING SPACING (INCHES)	ROOF SPAN (FEET)	UPLIFT	LATERAL	SHEAR	NUMBER OF 8d COMMON NAILS OR 10d BOX NAILS IN EACH END OF 1-1/4" X 20 GAGE STRAP
ROOF ASSEMBLY TO WALL ASSEMBLY	16" OC	16	401	292	152R	4
WALL ASSEMBLY TO FOUNDATION	16" OC	16	224	219	436	4

TABLE S601.8 - SILL OR BOTTOM PLATE TO FOUNDATION CONNECTIONS RESISTING UPLIFT LOADS - 140 MPH WIND EXP "B"
NFCM 2015 TABLE 3.2C

BOTTOM PLATE TO FOUNDATION ANCHOR BOLT CONNECTION RESISTING UPLIFT LOADS	FOUNDATION SUPPORTING	MAXIMUM ANCHOR BOLT SPACING (INCHES)	
		8' END ZONES	INTERIOR ZONES
UPLIFT LOADS	1 - 3 STORIES	25 INCHES ON CENTER	30 INCHES ON CENTER
		NOTE: A MINIMUM OF ONE ANCHOR BOLT SHALL BE PROVIDED WITHIN 6 TO 12 INCHES OF EACH END OF EACH PLATE	

TABLE S601.9 - SILL OR BOTTOM PLATE TO FOUNDATION CONNECTIONS RESISTING SHEAR LOADS - 140 MPH WIND EXP "B"
NFCM 2015 TABLE 3.2B

BOTTOM PLATE TO FOUNDATION ANCHOR BOLT CONNECTION RESISTING UPLIFT LOADS	FOUNDATION SUPPORTING	MAXIMUM ANCHOR BOLT SPACING (INCHES)	
		5/8" Ø ANCHOR BOLTS	48 INCHES ON CENTER W/3X3X1/4" WASHER
UPLIFT LOADS	4 STORY		

TABLE S601.10 - FULL HEIGHT STUD REQUIREMENT FOR HEADERS OR WINDOW SILL PLATES IN EXTERIOR WALLS EXPOSURE "B"
NFCM 2015 TABLE 3.23C

HEADER SPAN (FEET)	WALL SPACING (INCHES)		
	12" O.C.	16" O.C.	24" O.C.
2	1	1	1
4	2	2	1
6	3	3	2
8	4	3	2

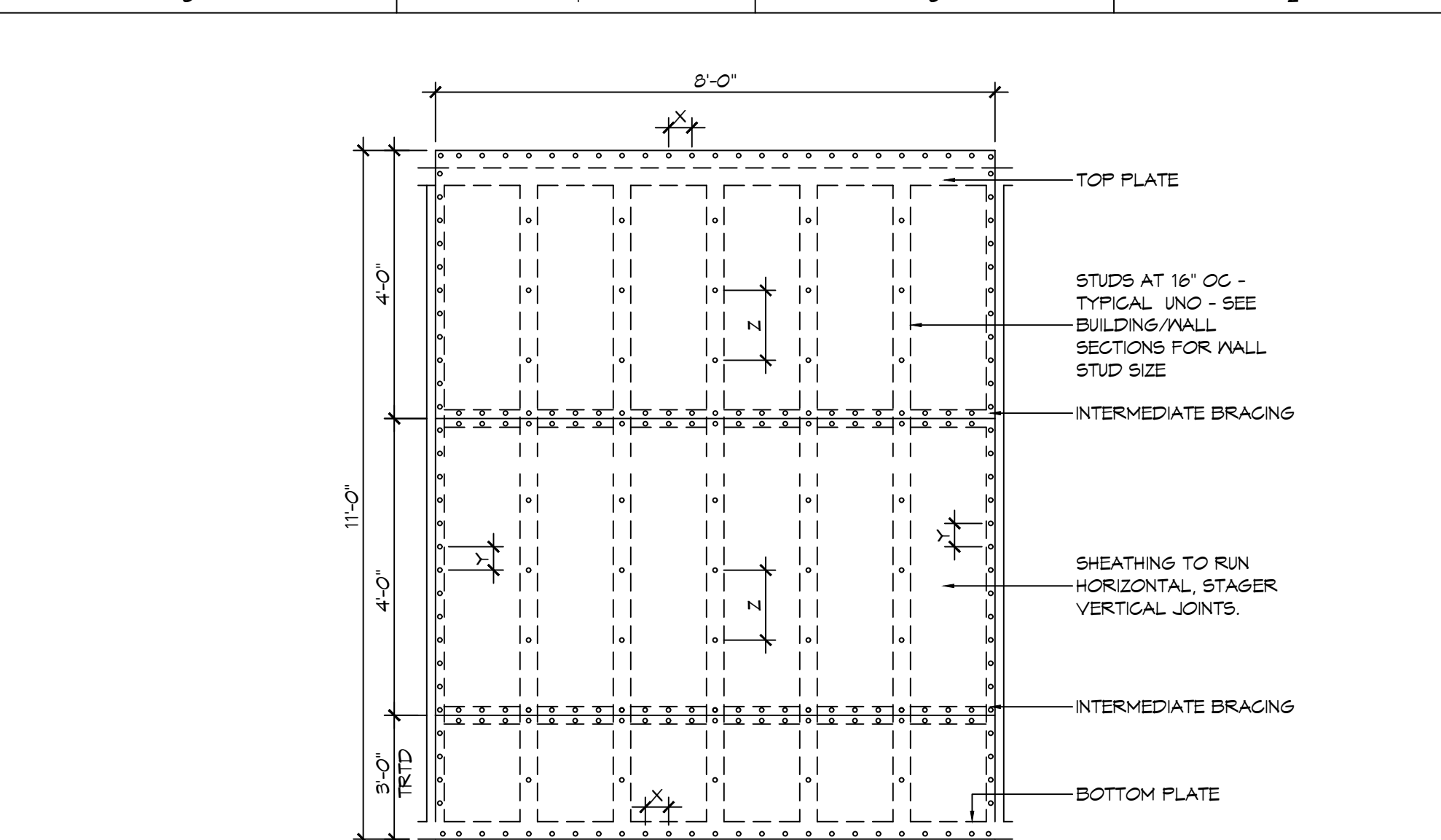

NAIL SPACING
X = 4" OC
Y = 4" OC
Z = 12" OC

INTERIOR SHEATHING
1/2" PLYWOOD EACH FACE STAGGERED 48" OC. W/8d NAILS @ 4" OC FASTENING @ PANEL EDGES 8d NAILS @ 12" OC FASTENING @ INTERMEDIATE MEMBERS.

EXTERIOR SHEATHING
5/8" PLYWOOD EACH FACE STAGGERED 48" OC. W/8d NAILS @ 4" OC FASTENING @ PANEL EDGES 8d NAILS @ 12" OC FASTENING @ INTERMEDIATE MEMBERS.

X = PLATE EDGE NAIL SPACING
Y = LONG EDGE NAIL SPACING
Z = FIELD NAIL SPACING

H SHEAR WALL EXTERIOR SHEATHING NAILING PATTERN

TABLE S601.5 - JACK STUD REQ - INT LOADBEARING WALLS

HEADER SUPPORTING	HEADER SPAN (FT)	ROOF SPAN (FEET)															
		12 FEET				24 FEET				36 FEET							
		3"	4.5"	5"	6.5"	3"	4.5"	5"	6.5"	3"	4.5"	5"	6"				
ONE FLOOR ONLY (CENTER BEARING)	2	1	1	1	1	1	1	1	1	1	1	1	1	1	1	1	1
	4	1	1	1	1	1	1	1	1	1	1	1	1	1	1	1	1
	6	1	1	1	1	1	1	1	1	1	2	1	1	1	1	1	1
	8	1	1	1	1	2	1	1	1	1	2	2	2	1	1	1	1
	10	1	1	1	1	2	2	1	1	3	2	2	2	2	1	1	1
	12	1	1	1	1	2	2	2	1	3	2	2	2	2	2	1	1
	14	2	1	1	1	3	2	2	2	4	3	3	2	2	2	1	1
	16	2	2	1	1	3	2	2	2	4	3	3	2	2	2	1	1
	2	1	1	1	1	1	1	1	1	1	2	1	1	1	1	1	1
	4	1	1	1	1	2	1	1	1	3	2	2	2	2	1	1	1
6	2	1	1	1	3	2	2	2	4	3	2	2	2	2	1	1	
8	2	2	1	1	3	2	2	2	5	3	3	3	3	2	1	1	
10	2	2	2	1	4	3	3	2	6	4	4	3	3	2	1	1	
12	3	2	2	2	5	3	3	3	7	5	4	4	4	3	2	1	
14	3	2	2	2	6	4	4	3	8	5	5	4	4	3	2	1	
16	4	3	2	2	6	4	4	3	9	6	6	5	4	3	2	1	

TABLE S601.6 - JACK STUD REQ - EXTERIOR LOADBEARING WALLS
NFCM 2021 TABLE 3.22F

HEADER SUPPORTING	HEADER SPAN (FT)	ROOF LIVE LOAD 20 PSF								ROOF LIVE LOAD 30 PSF							
		3"				4.5"				3"				4.5"			
		3"	4.5"	5"	6.5"	3"	4.5"	5"	6.5"	3"	4.5"	5"	6.5"	3"	4.5"	5"	6.5"
ROOF AND CEILING	2	1	1	1	1	1	1	1	1	1	1	1	1	1	1	1	1
	4	1	1	1	1	1	1	1	1	1	1	1	1	1	1	1	1
	6	2	1	1	1	1	1	1	2	1	1	1	1	1	1	1	1
	8	2	2	1	1	1	1	1	2	2	1	1	1	1	1	1	1
	10	3	2	2	2	2	2	2	3	2	2	2	2	2	2	2	2
	12	3	2	2	2	2	2	2	3	2	2	2	2	2	2	2	2
	14	4	3	2	2	2	2	2	4	3	2	2	2	2	2	2	2
	16	4	3	3	2	2	2	2	4	3	3	2	2	2	2	2	2
	2	1	1	1	1	1	1	1	1	1	1	1	1	1	1	1	1
	4	2	1	1	1	1	1	1	2	1	1	1	1	1	1	1	1
6	2	2	2	2	1	1	1	3	2	2	2	2	2	2	2	2	
8	3	2	2	2	2	2	2	3	2	2	2	2	2	2	2	2	
10	4	3	2	2	2	2	2	4	3	3	2	2	2	2	2	2	
12	4	3	3	2	2	2	2	5	3	3	3	2	2	2	2	2	
14	5	4	3	3	2	2	2	5	4	3	3	3	2	2	2	2	
16	6	4	4	3	3	2	2	6	4	4	3	3	3	2	2	2	

HEADER WIDTH - 3" (2-2X), 4.5" (3-2X), 5", 6.5" (4-2X) EACH 1/2" PLYWOOD SPACER BETWEEN

(MITERED CORNER)

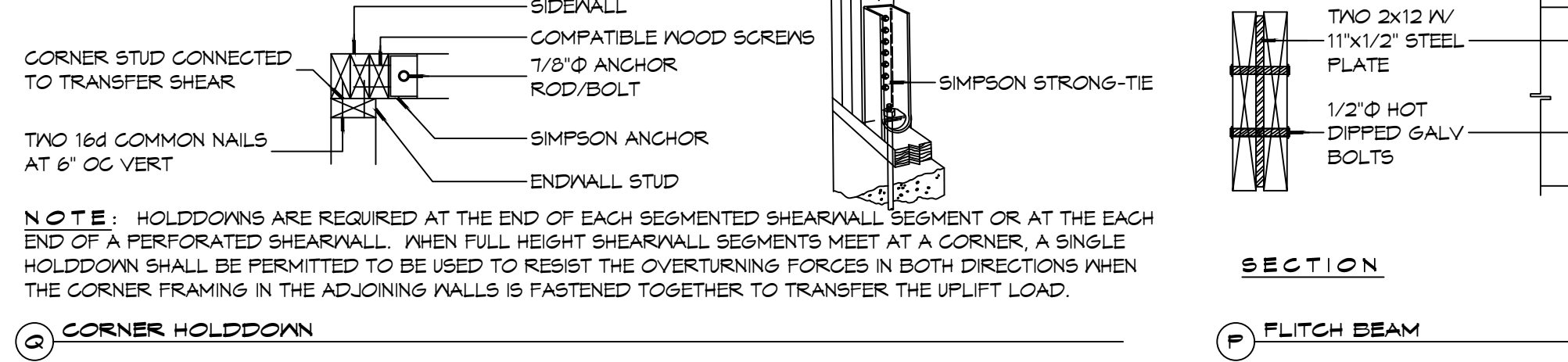

N WINDOW AND DOOR HEADER

M POST TO BEAM

L END WALL CONNECTIONS

K SIMPSON M5TAM56

NOTE: HOLDDOWNS ARE REQUIRED AT THE END OF EACH SEGMENTED SHEARWALL SEGMENT OR AT THE EACH END OF A PERFORATED SHEARWALL. WHEN FULL HEIGHT SHEARWALL SEGMENTS MEET AT A CORNER, A SINGLE HOLDDOWN SHALL BE PERMITTED TO BE USED TO RESIST THE OVERTURNING FORCES IN BOTH DIRECTIONS WHEN THE CORNER FRAMING IN THE ADJOINING WALLS IS FASTENED TOGETHER TO TRANSFER THE UPLIFT LOAD.

G CORNER HOLDDOWN

P FLITCH BEAM

SIMPSON STRONG-TIE AT TOP OF EACH STUD IN GABLE END WALLS

SIMPSON STRONG-TIE AT BOTTOM OF EA STUD TO STUD IN GABLE END WALLS

SIMPSON STRONG-TIE

SIMPSON STRONG-TIE

SIMPSON STRONG-TIE

SIMPSON STRONG-TIE

SIMPSON STRONG-TIE

SIMPSON STRONG-TIE

SIMPSON STRONG-TIE

SIMPSON STRONG-TIE

SIMPSON STRONG-TIE

SIMPSON STRONG-TIE

SIMPSON STRONG-TIE

SIMPSON STRONG-TIE

SIMPSON STRONG-TIE

SIMPSON STRONG-TIE

SIMPSON STRONG-TIE

SIMPSON STRONG-TIE

SIMPSON STRONG-TIE

SIMPSON STRONG-TIE

SIMPSON STRONG-TIE

SIMPSON STRONG-TIE

SIMPSON STRONG-TIE

SIMPSON STRONG-TIE

SIMPSON STRONG-TIE

SIMPSON STRONG-TIE

SIMPSON STRONG-TIE

SIMPSON STRONG-TIE

SIMPSON STRONG-TIE

SIMPSON STRONG-TIE

SIMPSON STRONG-TIE

TABLE S601.3 - NAILING SCHEDULE
NFCM 2015 TABLE 3.1

DESCRIPTION	NUMBER OF COMMON NAILS	NUMBER OF BOX NAILS	SPACING
HEADER TO HEADER (FACE NAILED)	16d	16d	16" OC EDGES

TABLE S601.4 - BUILDING ENVELOPE REQUIREMENTS

ROOFS	OPAQUE ELEMENTS		INSULATION MIN. R-VALUE
	INSULATION ENTIRELY ABOVE DECK	ASSEMBLY MAXIMUM	
METAL BUILDING	U-0.065	R-19	R-20.0 c.i.
	U-0.027	R-30	
	U-0.151	R-5.7 c.i.	
ATTIC AND OTHER	U-0.113	R-19.0	R-19.0
	U-0.124	R-19.0	
	U-0.089	R-19.0	
WOOD-FRAMED AND OTHER	U-0.107	R-6.3 c.i.	R-19.0
	U-0.052	R-19.0	
	U-0.051	R-19.0	
MASS	U-0.107	R-6.3 c.i.	R-19.0
	U-0.052	R-19.0	
STEEL JOIST	U-0.052	R-19.0	R-19.0
	U-0.051	R-19.0	
WOOD-FRAMED AND OTHER	U-0.051	R-19.0	R-19.0
	U-0.051	R-19.0	
SLAB-ON-GRADE	U-0.150	NR	NR
	U-0.150	NR	
UN-HEATED	F-0.700	NR	NR
	F-0.700	NR	
SWINGING	U-0.700	NR	NR
	U-0.700	NR	
NON-SWINGING	U-1.450	NR	NR
	U-1.450	NR	

HEADER WIDTH - 3" (2-2X), 4.5" (3-2X), 5", 6.5" (4-2X) EACH 1/2" PLYWOOD SPACER BETWEEN

ROOF LIVE LOAD 20 PSF

ROOF LIVE LOAD 30 PSF

NUMBER OF JACK STUDS REQUIRED

DOUBLE 2x4 MINIMUM

5/8" Ø GALV ALL THREAD

TYP HOLLOW COLUMN SQUARE OR ROUND

COUPLER NUT

TITEN HD ROD COUPLER OR ADHESIVE ANCHOR

CONCRETE

SIMPSON HOLLOW COLUMN

BEARING PLATE AND NUT

SECTION

ELEVATION

SECTION

ELEVATION

SECTION

ELEVATION

SECTION

ELEVATION

SECTION

ELEVATION

SECTION

ELEVATION

SECTION

ELEVATION

SECTION

ELEVATION

SECTION

ELEVATION

SECTION

ELEVATION

SECTION

ELEVATION

SECTION

ELEVATION

SECTION

ELEVATION

SECTION

ELEVATION

SECTION

ELEVATION

SECTION

ELEVATION

SECTION

ELEVATION

SECTION

ELEVATION

SECTION

ELEVATION

SECTION

ELEVATION

SECTION

ELEVATION

SECTION

ELEVATION

SECTION

ELEVATION

SECTION

ELEVATION

SECTION

ELEVATION

SECTION

ELEVATION

SECTION

ELEVATION

SECTION

ELEVATION