

PERMIT SET

Renovations & Additions
to
6336 Pratt Drive
New Orleans, LA 70122

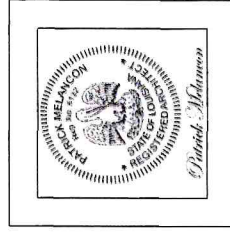

2nd Floor - Proposed
Sheet # 2 of 11

Project #:	04210025
Date: 04/11/2025	
Scale:	
Drawn By: JJA	
Checked By: JJA	
Revised:	
Revised:	

A-1.02.1

MELANCON ORTEGA DESIGNS
ARCHITECTURAL INTERIORS
NEW ORLEANS, LA
INTERIORDESIGN.COM | 504.659.9115

GENERAL NOTES:
1) FLOORING: ENGINEERED HARDWOOD FLOORS THROUGHOUT, AND
TILE IN THE PRIMARY BATHROOM.

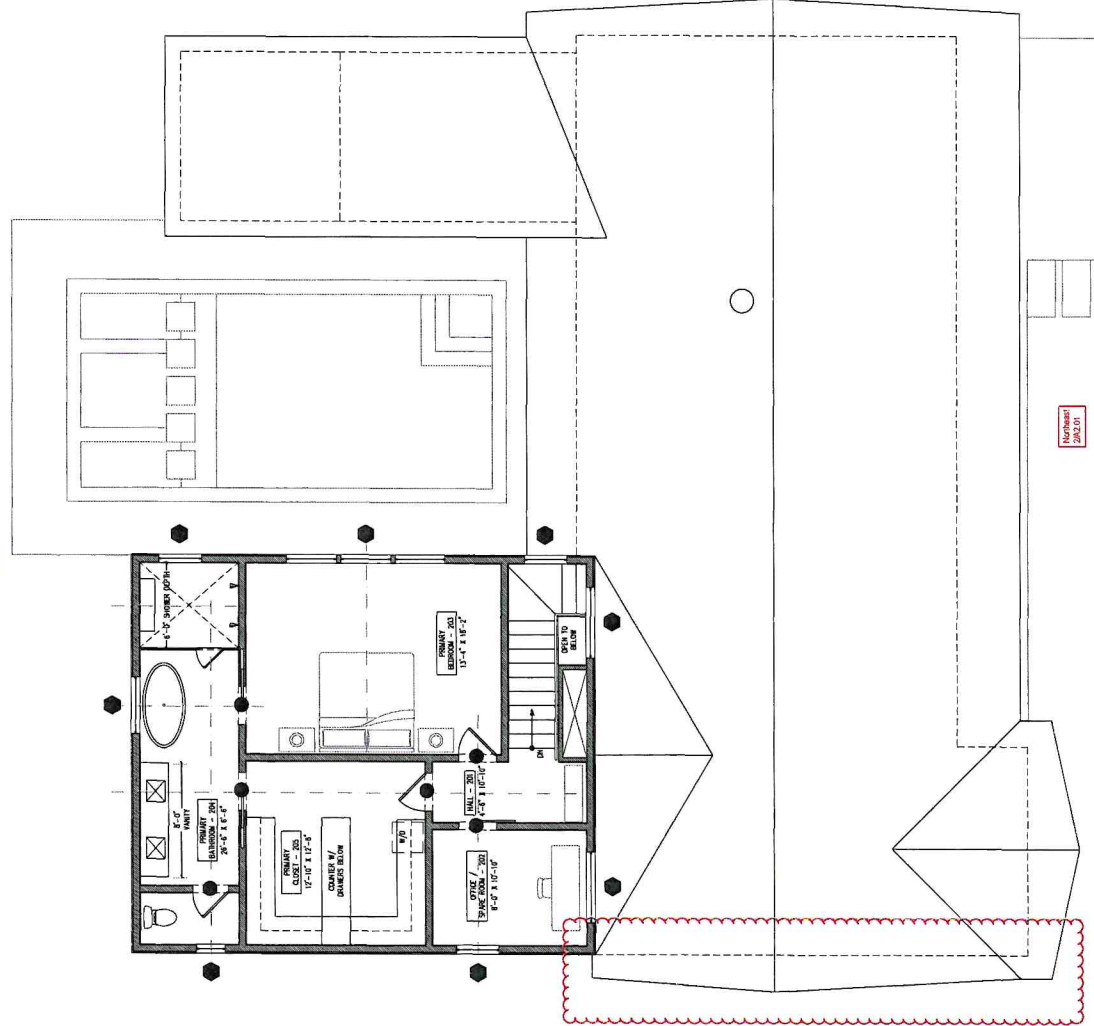

1 Plan - 2nd Floor Proposed
A-101 | 4-101
SCALE: 1/4" = 1'-0"
NORTH

HATCHING INDICATES
LOCATION OF NEW WALL

PERMIT SET

Renovations & Additions
to
6336 Pratt Drive
New Orleans, LA 70122

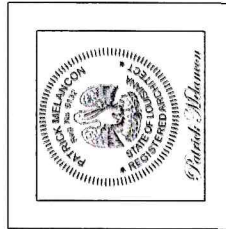

Opening Schedules
Sheet #: 11 of 12

Project P:	Revision:
Date: 04/11/2025	Revision:
Scale:	
Drawn By: AM	
Checked By: PMS	
Revision:	
Revision:	

A-2.06.0

MELANCON ORTEGA DESIGNS
ARCHITECTS/INTERIORS
NEW ORLEANS, LA
PARISH: ORTEGA-ALCON 1, 946,493,931

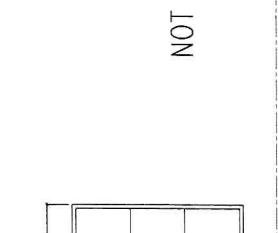
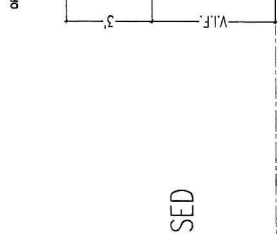
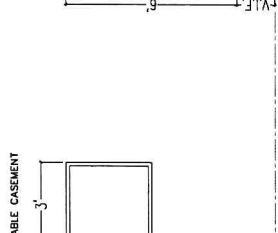
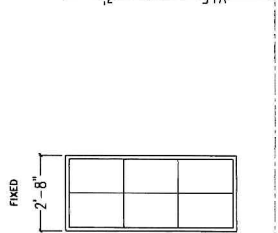
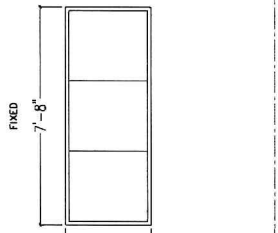
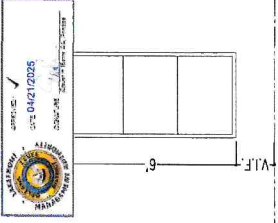

NOT USED

1 Window - Type "A" SCALE: 1/2" = 1'-0" QUANTITY: 3
2 Window - Type "B" SCALE: 1/2" = 1'-0" QUANTITY: 0
3 Window - Type "C" SCALE: 1/2" = 1'-0" QUANTITY: 9
4 Window - Type "D" SCALE: 1/2" = 1'-0" QUANTITY: 1
5 Window - Type "E" SCALE: 1/2" = 1'-0" QUANTITY: 1
6 Window - Type "F" SCALE: 1/2" = 1'-0" QUANTITY: 3

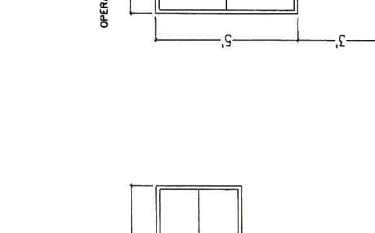
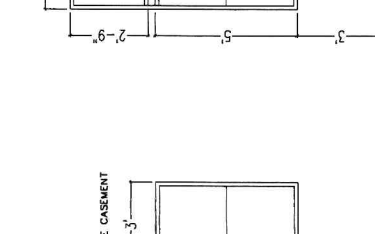
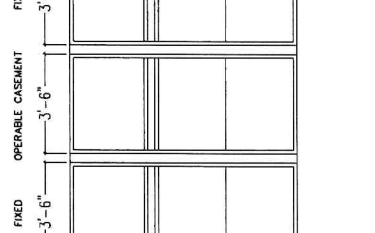
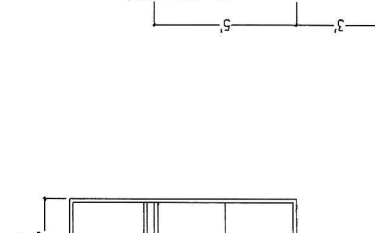
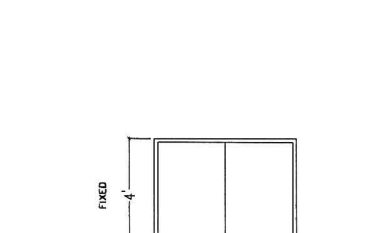
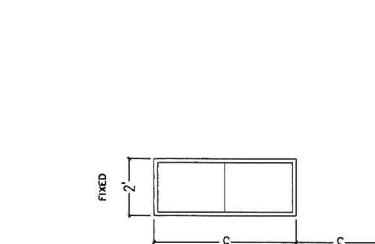

7 Window - Type "G" SCALE: 1/2" = 1'-0" QUANTITY: 2
8 Window - Type "H" SCALE: 1/2" = 1'-0" QUANTITY: 3
9 Window - Type "I" SCALE: 1/2" = 1'-0" QUANTITY: 1
10 Window - Type "J" SCALE: 1/2" = 1'-0" QUANTITY: 1
11 Window - Type "K" SCALE: 1/2" = 1'-0" QUANTITY: 1

COMPLIANCE NOTES:

- SAFETY GLAZING TO BE INSTALLED AT ALL OPERABLE WINDOWS IN ACCORDANCE WITH SECTION R0604.4.5 IRC 2012 ED.
- OPERABLE EXCESS RAINING PROTECTED WITH OPENINGS LARGER THAN 6 SF AT ALL BEDROOMS.
- APPROVED PLYWOOD & OPERABLE SHUTTERS TO BE PROVIDED FOR WINDOWS IN ACCORDANCE WITH IRC SECTION R0604.4.5 REGARDING IMPACT RESISTANCE.

MATERIALS NOTES:

- ALL GLAZING TO BE INSULATED.
- ALL WINDOW & DOOR MULTINE NO LARGER THAN 1/8".
- MARVIN CONTEMPORARY SERIES: SOUND AND THERMAL INSULATION

NOTE: CONTRACTOR TO VERIFY ALL DIMENSIONS FOR OPENINGS, PROPOSED & EXISTING.

NOTE: TRIM PROFILES ARE SHOWN AS PLACEHOLDERS, DESIGN TBD.

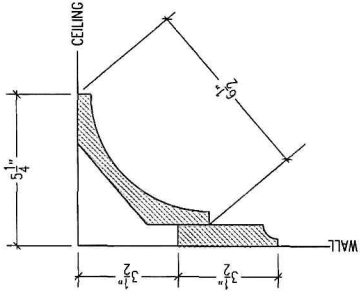

CROWN TYPE "A"

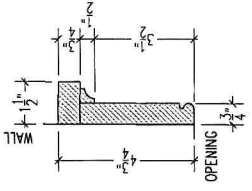

CASING TYPE "A"

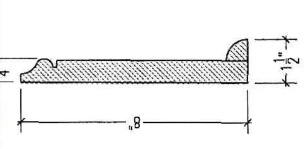

BASEBOARD TYPE "A"

1 Trim Profiles
DETAIL SCALE: 6" = 1'-0"

ROOM FINISH SCHEDULE

ROOM NAME	FLOOR	BASE	WALL	CEILING	CROWN	CASING	NOTES
FIRST FLOOR							
FOYER - 101		REFINISHED TERRAZZO	A				
BREAKFAST ROOM - 102		NEW TERRAZZO	A				
KITCHEN - 103		REFINISHED TERRAZZO	A				
DINING ROOM - 104		REFINISHED TERRAZZO	A				
LIVING ROOM - 105		REFINISHED TERRAZZO	A				
OFFICE / GUEST BEDROOM - 106		REFINISHED PARQUET	A				
STORAGE - 107		REFINISHED TERRAZZO	A				
BATHROOM #1 - 108		REFINISHED TERRAZZO	A				
JULIENS BEDROOM - 109		REFINISHED PARQUET	A				
KIDS PLAYROOM - 110		REFINISHED PARQUET	A				
DESK AREA - 111		REFINISHED TERRAZZO	A				
GUEST BATHROOM - 112		REFINISHED TERRAZZO	A				
GARAGE - 113		CONCRETE SLAB	A				
POOL BATHROOM - 114		CONCRETE SLAB	A				
SHED - 115		CONCRETE SLAB	A				
STORAGE - 116		CONCRETE SLAB	A				
SECOND FLOOR							
HALL - 201		ENGINEERED HARDWOOD	A				
OFFICE - 202		ENGINEERED HARDWOOD	A				
PRIMARY BEDROOM - 203		ENGINEERED HARDWOOD	A				
PRIMARY BATHROOM - 204		TILE	A				
PRIMARY CLOSET - 205		ENGINEERED HARDWOOD	A				

PERMIT SET

Renovations & Additions
to
6336 Pratt Drive
New Orleans, LA 70122

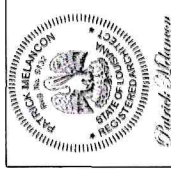

Trim & Finish Sched.
Sheet #: 12 of 15

Project #:	Revision:
Date: 04/11/2025	Revision:
Scale:	Drawn By: JAK
Checked By: JAK	Revision:
A-2.07.0	

MELANCON ORTEGA DESIGNS
ARCHITECTS - INTERIORS
NEW ORLEANS, LA
PATRICK.A.MELANCON@MOSI.COM

Fixture Legend:

- F1 - MR. SAMS RECEIVED SET OF APPROVED COA.
- F2 - DIMMER PROVIDER
- F2.G - DIMMER PROVIDED GAS VALVE
- F3 - LIGHTER KIT LOCATION RECEIVED APPROVED
- F4 - DIMMER PROVIDED CEILING PENDANT / CHANDELIER
- F4.G - DIMMER PROVIDED GAS CEILING PENDANT / CHANDELIER
- F5 - DIMMER PROVIDED TV TABLE RECEPTACLE
- F6 - DIMMER PROVIDED HUNG LIGHT KIT
- F6.G - DIMMER PROVIDED HUNG LIGHT KIT WITH GAS
- F7 - DIMMER PROVIDED 30" CEILING FAN (NO LIGHT KIT)
- F8 - DIMMER PROVIDED CEILING FLOOR MOUNT FIXTURE
- F9 - DIMMER PROVIDED R.A. 24" FLOOR
- F10 - DIMMER PROVIDED PANELED CHANDELIER LIGHT
- F11 - DIMMER PROVIDED HUNG LIGHT KIT WITH GAS FOR TRACK LIGHT / FAN KIT. INSTALL DIMMER SUPPLIES FUTURE.
- F12 - DIMMER PROVIDED SECURITY LIGHT V. PHOTO CELL
- F13 - DIMMER PROVIDED FLOOR LIGHTS - CONSULT CLIENTS

- SD - SMOKE DETECTOR ALARM
- SD - SMOKE DETECTOR ALARM
- SD - SMOKE DETECTOR ALARM

NOTE: ALL DIMMER PROVIDERS SHALL BE INSTALLED IN ACCORDANCE WITH THE 2012 NEC AND 2012 IRC.

RECEPTACLE

GROUND FAULT INTERRUPTER

WATER PROOF BULLET

WATER PROOF BULLET

FLOOR RECEPTACLE

WATER PROOF BULLET

WATER PROOF BULLET

WATER PROOF BULLET

WATER PROOF BULLET

WATER PROOF BULLET

WATER PROOF BULLET

WATER PROOF BULLET

WATER PROOF BULLET

WATER PROOF BULLET

WATER PROOF BULLET

WATER PROOF BULLET

WATER PROOF BULLET

WATER PROOF BULLET

WATER PROOF BULLET

WATER PROOF BULLET

WATER PROOF BULLET

WATER PROOF BULLET

WATER PROOF BULLET

WATER PROOF BULLET

WATER PROOF BULLET

WATER PROOF BULLET

WATER PROOF BULLET

WATER PROOF BULLET

WATER PROOF BULLET

WATER PROOF BULLET

WATER PROOF BULLET

General Notes:

- #1 ALL LIGHTING ELECTRICAL AND POWER NEEDS TO BE IN COMPLIANCE WITH MOST CURRENT IRC BUILDING CODES AND ELECTRICAL CODES, ORLEANS PARISH & ALL APPLICABLE LOCAL CODES.
- #2 GFI PROTECTED OUTLETS IN BATHROOMS SHALL NOT BE ON THE SAME CIRCUIT AS ANY OTHER ROOM OUTLETS.
- #3 ALL SWITCHES AND FIXTURES (EXCEPT FANS) TO BE ON DIMMERS (EXCEPT FANS) TO BE ON DIMMERS. DIMMERS SHALL BE INSTALLED IN CENTERS OF ROOMS OR VANITIES. SWITCHES TO BE INSTALLED IN CORNERS WHEN POSSIBLE. DIMMERS AND SWITCHES TO BE INSTALLED IN CORNERS WHEN POSSIBLE. DIMMERS AND SWITCHES TO BE INSTALLED IN CORNERS WHEN POSSIBLE.
- #4 GENERAL ALL OUTLET RECEPTACLES AT BATHROOM WALLS OR BELOW COUNTERS IN BATHROOMS SHALL BE GFI. ALL OUTLET RECEPTACLES FOR COUNTER USE IN BATHROOMS SHALL BE GFI. ALL OUTLET RECEPTACLES FOR COUNTER USE IN BATHROOMS SHALL BE GFI.
- #5 CONTRACTOR SHALL COORDINATE EXACT ROUGH-IN LOCATION OF ALL CHANDELIER, FLOOR MOUNTED OR HUNG LIGHTS WITH OWNER OR ARCHITECT.
- #6 VERIFY MOUNTING HEIGHT & LOCATION OF SWITCHES IN COORDINATION WITH DOOR CASINGS.
- #7 ALL WEATHER PROOF (WP) OUTLETS TO BE GFI.
- #8 PROVIDE POWER FOR CLICK STRIP OR UNDER COUNTER LIGHTING AND KITCHEN, BUILT-INS.
- #9 ALL WIRING TO BE MINIMUM 12 AWG COPPER. ALL BRANCH CIRCUITS TO BE MINIMUM 20 AMP.
- #10 PROVIDE SEPARATE GATS CRANKAL CABLE RUNS TO EACH RECEPTACLE FROM SINGLE DISTRIBUTION POINT IN ATTIC.
- #11 PANELED & BREAKERS TO BE INSTALLED IN ACCORDANCE WITH THE 2012 NEC & ALL APPLICABLE LOCAL CODES.
- #12 KEEP WIRING LOOSE & LONG FOR ALL F2 & F4 FIXTURES FOR FLEXIBILITY OF LOCATION.
- #13 ALL SOFFIT LIGHTS ON PHOTO CELL SENSOR.
- #14 RUN CONDUIT TO LIGHT FIXTURES IN TREES AND LANDSCAPE.

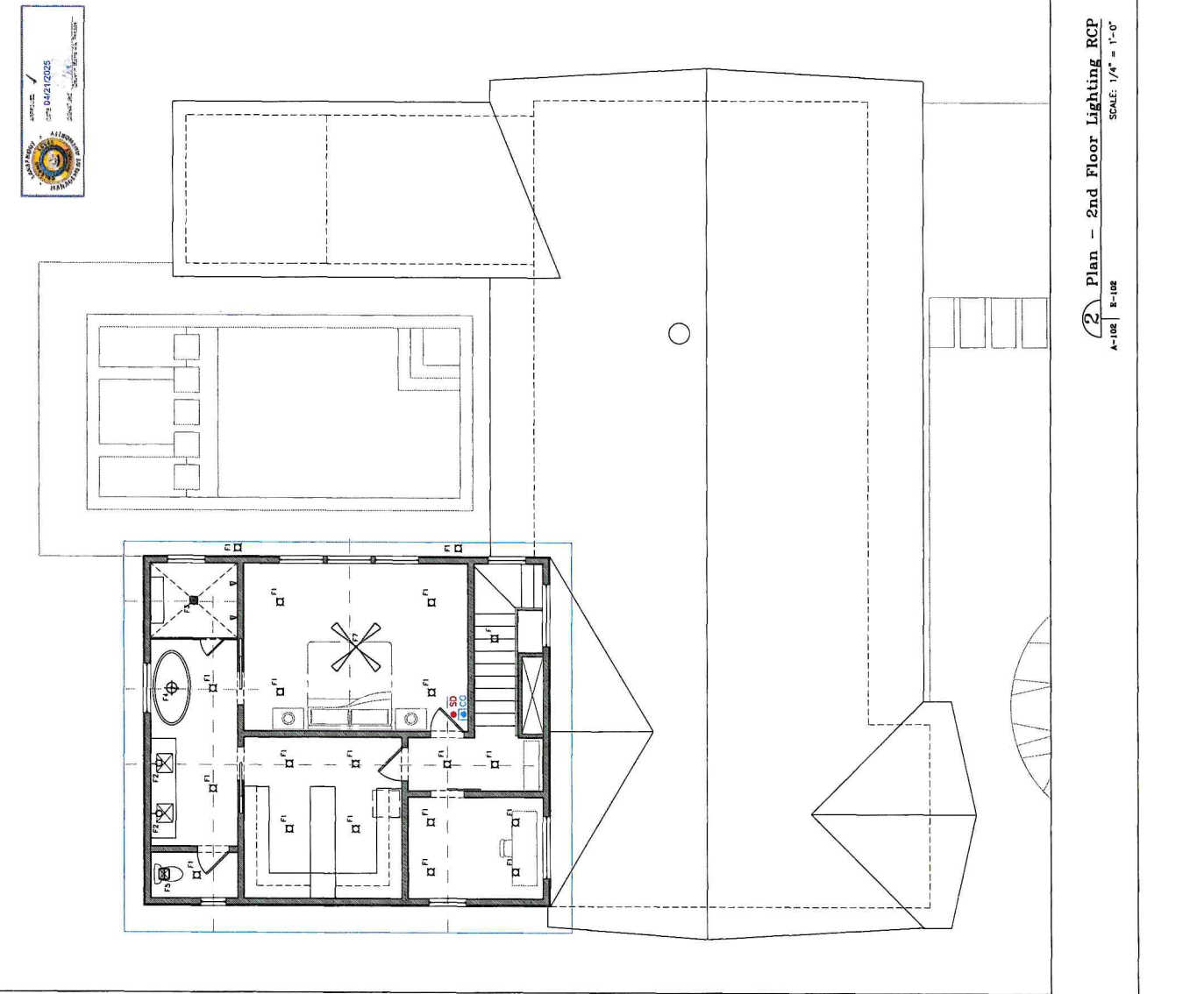

PERMIT SET

Renovations & Additions
to
6336 Pratt Drive
New Orleans, LA 70122

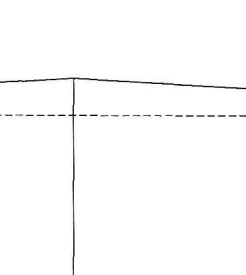

2nd Floor Electrical RCP

Sheet #: 11 of 18

Project R:	Revision:
Date: 04/11/2025	
Scale:	Drawn By: JM
Checked By: PMS	Revision:
Revision:	Revision:

MELANCON ORTEGA DESIGNS
ARCHITECTURE & INTERIORS
1000 N. ORLEANS ST., SUITE 100
NEW ORLEANS, LA 70116
PHONE: 504.586.1000 | WWW.MODERNRCP.COM

2 Plan - 2nd Floor Lighting RCP
A-108 | B-108
SCALE: 1/4" = 1'-0"