

**ROOF PLAN**  
 CORRECT ROOF VENTILATION:  
 \*As a general rule, an square foot of net free vent area per 300 square feet of attic floor or area to be vented is recommended.  
 \*For a balanced system, ventilation should be equal at the soffits and ridge.  
 \*For a balanced system, always provide more than 50% of the total required ventilation at the soffits and the remainder at the upper portion of the roof.

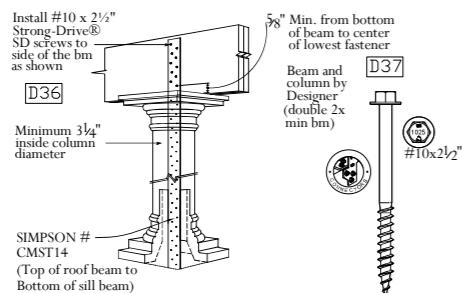

**HOLLOW POST CONNECTION**  
 SIMPSON # CMST18--Uplift Connector

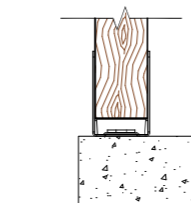

**UPLIFT & HOLD DOWN**  
 SIMPSON # ABU14

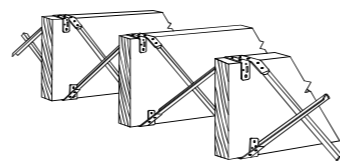

**FLOOR JOIST TO FLOOR JOIST**  
 SIMPSON # TB27--Bridging

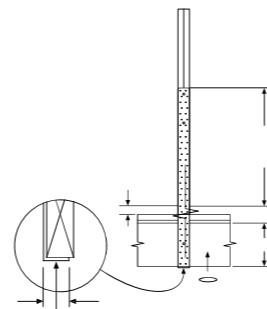

**CORNER WALL HOLD-DOWN**  
 SIMPSON # MSTC48B3Z--Uplift Connector  
 (SEE FLOOR PLANS FOR LOCATIONS)

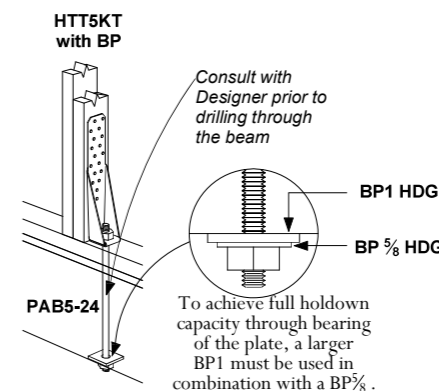

**INTERIOR CORNER HOLD-DOWN**  
 SIMPSON # HTT5KT--Uplift Connector  
 (SEE FLOOR PLANS FOR LOCATIONS)

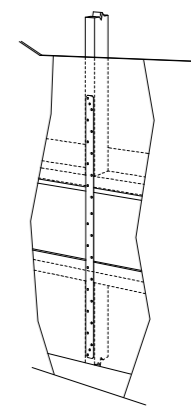

**EACH STUD FLOOR TO FLOOR STRAP**  
 SIMPSON # CS (36" LENGTH)--Uplift Connector  
 Fill the nail holes to the top stud before the roof is installed and then fill bottom stud nails after. **Note:** Rim joist nails are not required.

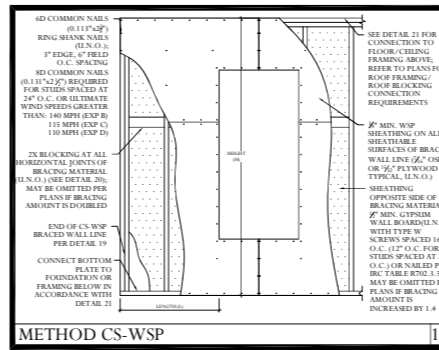

**METHOD CS-WSP** 16

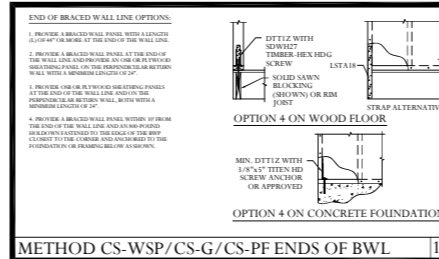

**METHOD CS-WSP/CS-G/CS-PF ENDS OF BWL** 19

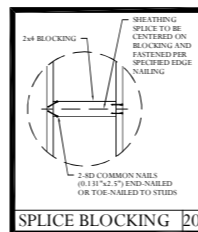

**SPLICE BLOCKING** 20

**NOTE:**  
 SEE ENGINEERING PLAN  
 FOR ALL STRUCTURAL FRAMING LAYOUTS,  
 DETAIL, & FOUNDATION ENGINEERING.

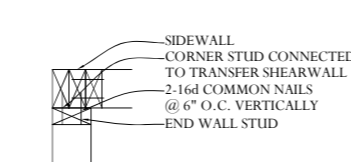

**TYP. WALL CORNER**

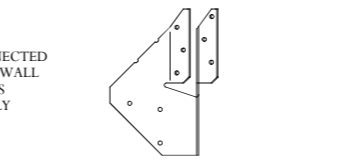

**HIP CORNER PLATE**  
 SIMPSON # HCP--Uplift Connector

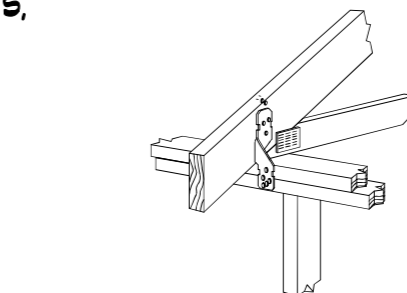

**EACH RAFTER TO TOP PLATE**  
 SIMPSON # H8--Uplift Connector

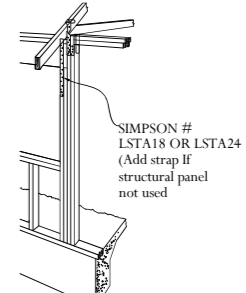

**TYP. HEADER ANCHORAGE**  
 SIMPSON # LSTA18 OR LSTA24--Uplift Connector

**WALL SHEATHING 7/16" REQUIRED FOR WIND LOAD (140mph) --EXPOSURE B**

SHEATHING LOCATION	STUD SPACING	EDGES	FIELDS
INTERIOR ZONE	16" O.C.	3	3
PERIMETER EDGE ZONE	16" O.C.	3	3

**ROOF SHEATHING 15/32" REQUIRED FOR WIND LOAD (140mph) --EXPOSURE B**

SHEATHING LOCATION	RFTRS / TRUSS SPACING	EDGES	FIELDS
INTERIOR ZONE	16" O.C.	3	3
PERIMETER EDGE ZONE	16" O.C.	3	3

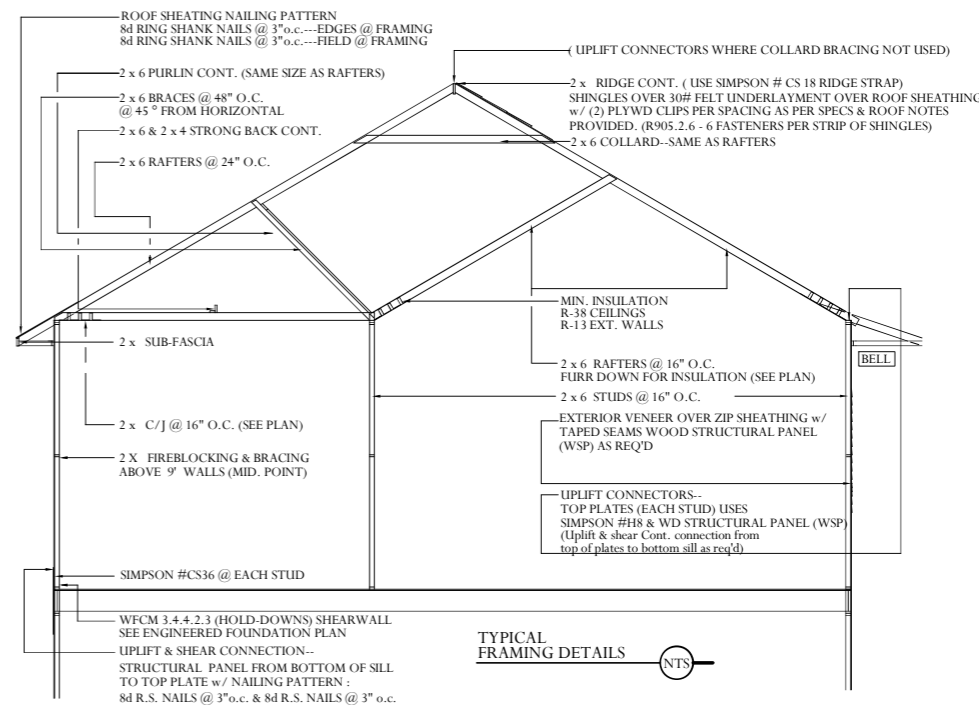

**TYPICAL FRAMING DETAILS** NTS

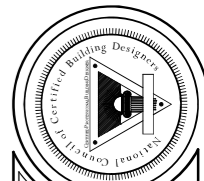

Copyright © 2024 Macaluso Home Designs, Inc. All rights reserved. These drawings are the property of Macaluso Home Designs, Inc. & can not be reproduced without written permission. **NOTES:** Although every effort is made in preparing and checking these plans for accuracy, the designer shall not be held liable for any errors or omissions. The user of these plans shall be responsible for obtaining all applicable local, state and International Residential Code 2021 requirements that pertain to these building plans.

**MACALUSO**  
 home designs, inc.  
 www.macalusohomedesigns.com  
 P: (985) 641-7168  
 F: (985) 641-1859  
 204 Village Circle, Suite 2 • Slidell, Louisiana 70458

LOGAN & MADALYN RUANO  
 LOT # 27, GRAND S/D (LAWRENCE ST)  
 ROOF PLAN & FRAMING DETAILS

DATE: 03/20/2026  
 STATE OF LOUISIANA  
 MARK A. RUANO  
 REGISTERED PROFESSIONAL ENGINEER  
 IN  
 MECHANICAL ENGINEERING

PLAN NUMBER:  
 26-4939

