

**FOUNTAINS  
DOCTOR'S OFFICE**

9.29.17  
FOUNTAINS BLVD.  
MADISON, MS 39110

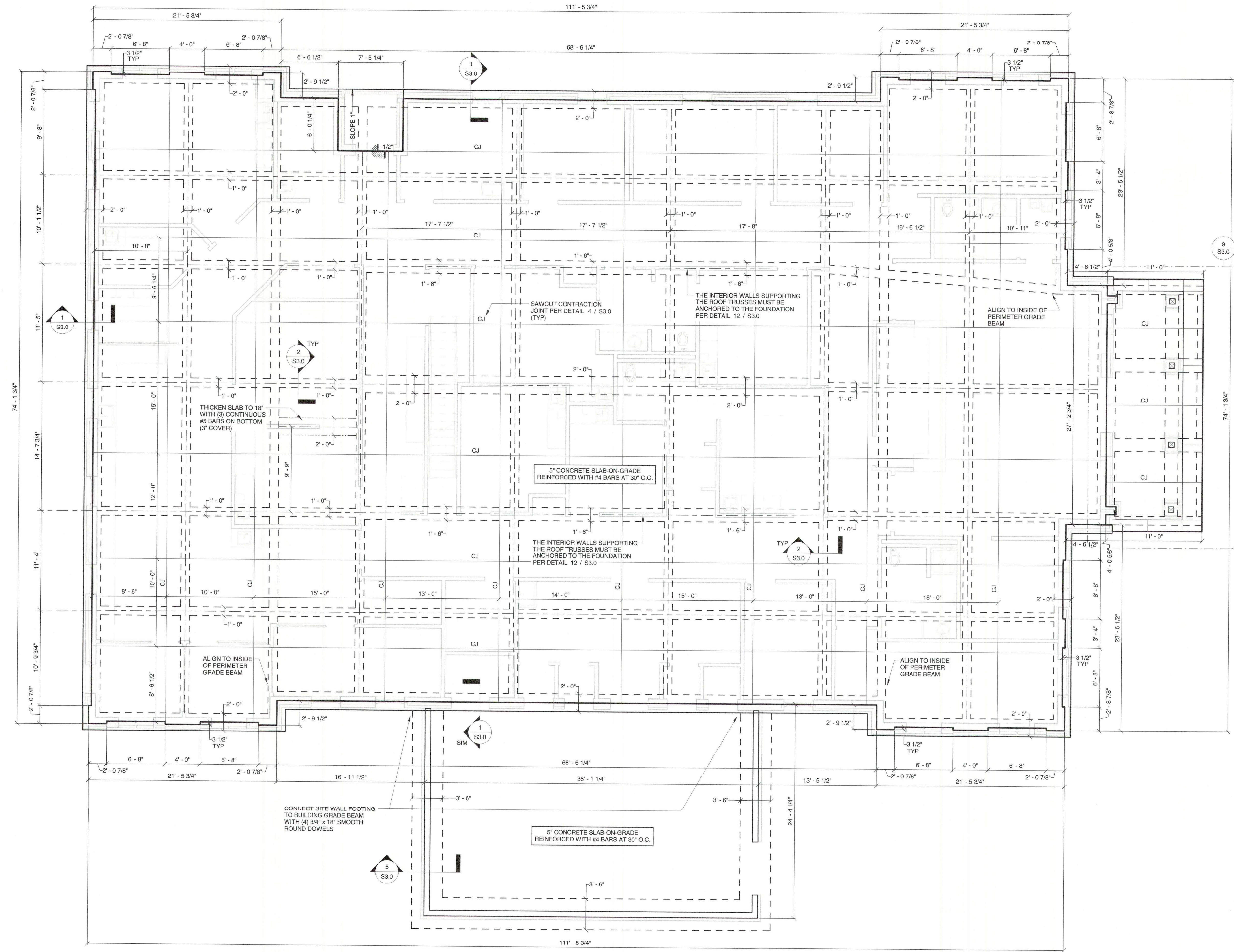

**FOUNDATION PLAN**  
3/16" = 1'-0"

- FOUNDATION NOTES:**
1. PROVIDE CORNER BARS AT ALL GRADE BEAM INTERSECTIONS PER DETAIL 6 / S3.0
  2. PROVIDE REINFORCEMENT AROUND ALL SLAB BLOCKOUTS AND PENETRATIONS, INCLUDING PLUMBING PIPES, PER DETAIL 7 / S3.0
  3. SEE DETAIL 8 / S3.0 FOR PLUMBING PENETRATIONS IN GRADE BEAMS



SEPTEMBER 29, 2017  
CONSTRUCTION DOCUMENTS  
WBA #: 2217

REVISIONS		
NO.	DESCRIPTION	DATE

**S2.0**  
FOUNDATION PLAN