

KOHLER[®] SERVICE PARTS

ALTERNA™ LAVATORY SHAMPOO FAUCETS

| K-# | Soap Dispenser |
|---------------|----------------|
| 6956-CV-**-AA | |
| 6956-CV-**-BA | |
| 6956-2-**-AA | |
| 6962-CV-**-AA | X |
| 6962-CV-**-BA | X |
| 6962-2-**-AA | X |
| 6962-2-**-BA | X |

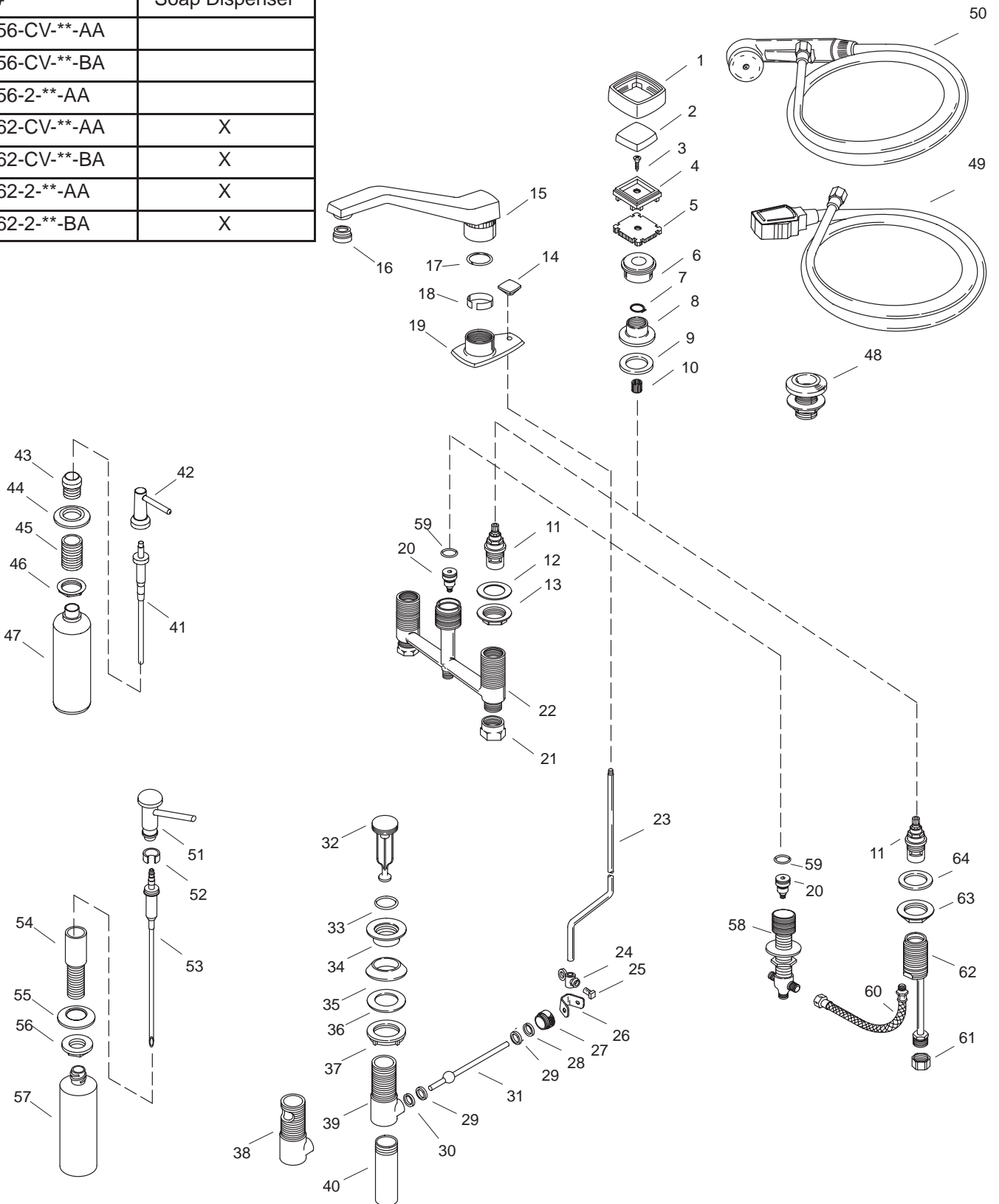

** Finish/color code must be specified when ordering.

SERVICE PARTS

| ITEM | PART NO. | DESCRIPTION |
|------|----------|--|
| 1 | 42734** | Shell |
| 2 | 42730** | Insert |
| 3 | 53416 | Screw |
| 4 | 42732 | Holder |
| 5 | 42733 | Handle |
| 6 | 42731** | Skirt |
| 7 | 46034 | Retaining Ring |
| 8 | 21609** | Flange |
| 9 | 39924 | Gasket |
| 10 | 59027 | Spline Adapter |
| 11 | 30430 | Ceramic Valve (Clockwise Close) |
| | 30431 | Ceramic Valve (Counterclockwise Close) |
| 12 | 32060 | Washer |
| 13 | 50903 | Nut |
| 14 | 29700** | Lift Knob |
| 15 | | Available in Service Kit Only |
| 16 | 59620** | Aerator |
| | 41056** | Aerator (AA version) |
| 17 | 29464 | O-Ring |
| 18 | 41495 | Bushing |
| 19 | 41309** | Escutcheon |
| 20 | | Available in Service Kit Only |
| 21 | 32751** | Coupling Nut |
| 22 | 21610 | Body |
| 23 | 41315** | Lift Rod |
| 24 | 73382 | Link |
| 25 | 41970 | Screw |
| 26 | 40228 | Spring Clip |
| 27 | 57403-RP | Nut |
| 28 | 38745 | Wave Washer |
| 29 | 38744 | Friction Washer |
| 30 | 34917 | Gasket |
| 31 | 41312-RP | Lever and Ball |
| 32 | | Available in Service Kit Only |
| 33 | 38676 | O-Ring |
| 34 | 74732** | Flange |
| | 57408** | Flange (AA version) |
| 35 | 57966 | Gasket |
| 36 | 40238 | Washer |
| 37 | 40076 | Nut |
| 38 | 74410 | Body |
| 39 | 57405-RP | Drain Body |
| 40 | 41640** | Tailpiece |
| 41 | 41382 | Pump |
| 42 | 42768** | Spout Assembly |
| 43 | 41383** | Bonnet |
| 44 | 41384** | Flange |
| 45 | 41388 | Shank |
| 46 | 20496** | Lock Nut |
| 47 | 41381 | Bottle |
| 48 | 34329** | Guide |
| 49 | 41379** | Hose & Spray |
| 50 | 41310** | Hose & Spray (AA version) |
| 51 | 75234** | Spout Assembly |
| 52 | 75239 | Ring, Stabilizer |
| 53 | 75235 | Soap Dispenser |
| 54 | 74834** | Bonnet, Soap Dispenser |
| 55 | 74835** | Flange, Soap Dispenser |
| 56 | 42396 | Lock Nut |
| 57 | 74845 | Bottle, Soap Dispenser |
| 58 | | Available in Service Kit Only |
| 59 | 29682 | O-Ring |
| 60 | 73151-A | Hose |
| 61 | 32751 | Coupling Nut |
| 62 | 74369 | End Valve Assembly |
| 63 | 40005 | Nut |
| 64 | 40001 | Washer |

SERVICE KITS

| PART NO. | ITEM | QTY. | DESCRIPTION |
|----------|------|-------|--------------------|
| 58155 | | | Stopper Kit, Brass |
| | 32 | 1 ea. | Stopper |
| | 33 | 1 ea. | O-Ring |
| 52393 | | | Diverter Assembly |
| | 59 | 1 ea. | O-Ring |
| | 20 | 1 ea. | Diverter |
| 77620 | | | Shank Assembly |
| | 58 | 1 ea. | Shank |
| | 59 | 1 ea. | O-Ring |
| | 20 | 1 ea. | Diverter |
| 77628** | | | Spout |
| | 16 | | Aerator |
| | 17 | | O-Ring |
| | 18 | | Bushing |

** Finish/color code must be specified when ordering.