

STORE NO. 315  
 EXTERIOR SIGN: PLANNING SUBMITTAL

This sign is designed to withstand 130 MPH wind load.  
 This sign will contain a UL label  
 This sign will be installed using 3/8" thru-bolts or appropriately sized fasteners as necessary.



FEBRUARY 3, 2020



**Nick Zahner**  
 9932 Prospect Ave Studio 137  
 San Jose, CA 92071  
 nickz@blairsign.net  
 Northern California: (510) 337-9020  
 Southern California: (619) 792-1600  
 (510) 337-9029 fax (619) 792-1608 fax  
 California License #677503

- Design / Build
- Master Sign Programs
- Re-Image / Re-Model
- Property Branding
- Sustainable Relevance  
 LEED • CalGreen • Governance

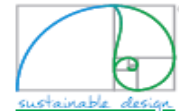

MANHATTAN PLAZA  
 900 Manhattan Blvd.  
 Harvey, LA 70058

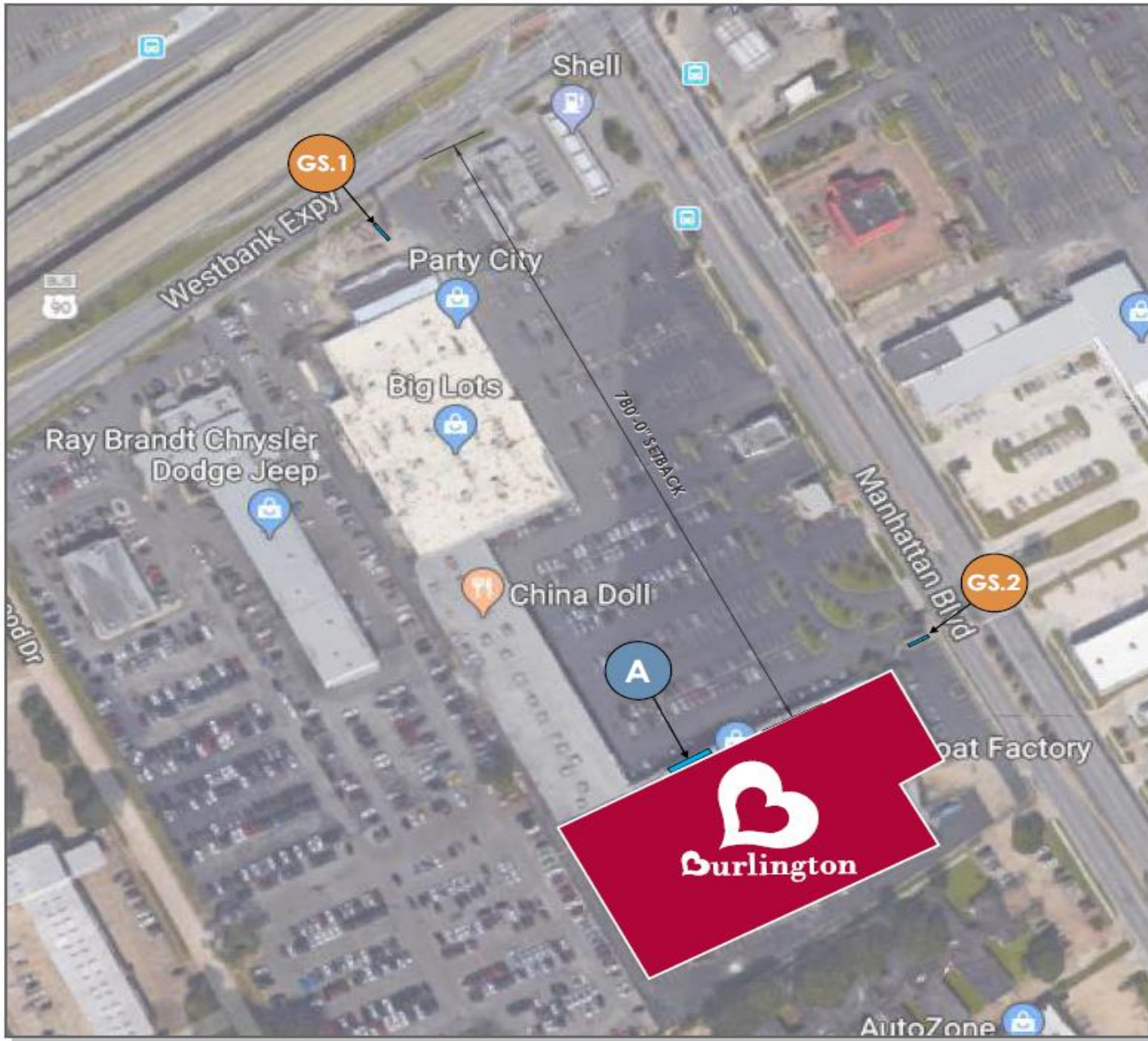

SITE PLAN  
1/128"=1'-0"

SECTION I: BUILDING SIGNS			
SIGN TYPE	SIGN DESCRIPTION	ALLOWED	PROPOSED
A	Channel Letters	300 Sq. Ft.	230 Sq. Ft.
<b>BUILDING SIGN TOTAL</b>		<b>300 Sq. Ft.</b>	<b>230 Sq. Ft.</b>
SECTION II: GROUND SIGNS			
GS.1	Pylon, Tenant Panel		
GS.2	Pylon, Tenant Panel		
SECTION III: CONSTRUCTION			
A	Channel Letter Detail		
A	Tag Line Channel Letter Detail		

NOTES:  
STORE TO HAVE 25,000+ SQ. FT. OF GROSS FLOOR AREA

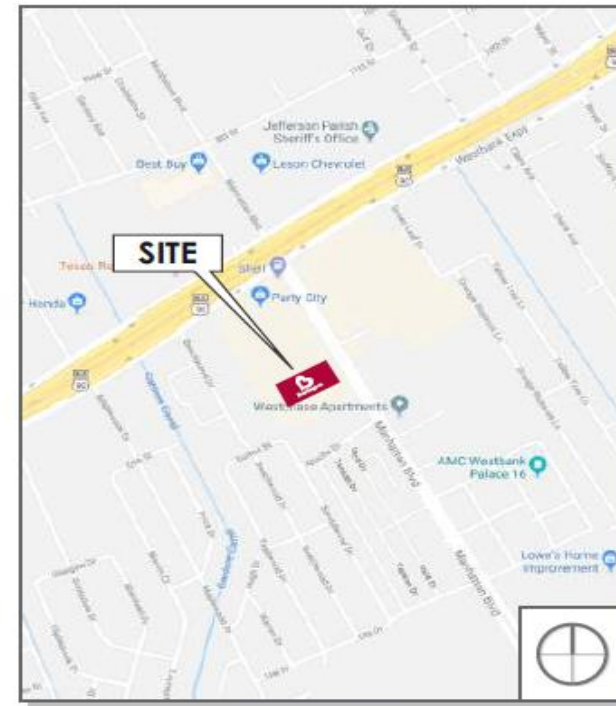

VICINITY MAP

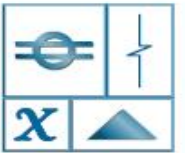

**BLAIR SIGN PROGRAMS**

Northem California:  
(510) 337-9020  
Southern California:  
(619) 792-1600  
info@blairsign.net  
CA License #677503

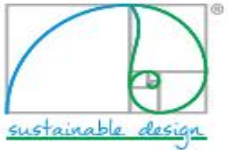

CLIENT:

**Burlington**

PROJECT:  
Harvey, LA #315  
Planning Submittal

ADDRESS:  
900 Manhattan Blvd.  
Harvey, LA 70058

DATE:  
01/11/2019

DESIGNER:  
K. Bossert

DESIGN N<sup>o</sup>:

REVISIONS:  
10/08/2021 9  
02/03/2020

BY:  
JO  
PS

**VICINITY MAP  
SITE PLAN**

ALL RIGHTS RESERVED  
© 2018 BLAIR SIGN PROGRAMS

This sign is designed to withstand 130 MPH wind load.  
 This sign will contain a UL label  
 This sign will be installed using 3/8" thru-bolts or appropriately sized fasteners as necessary.



EXISTING ELEVATION

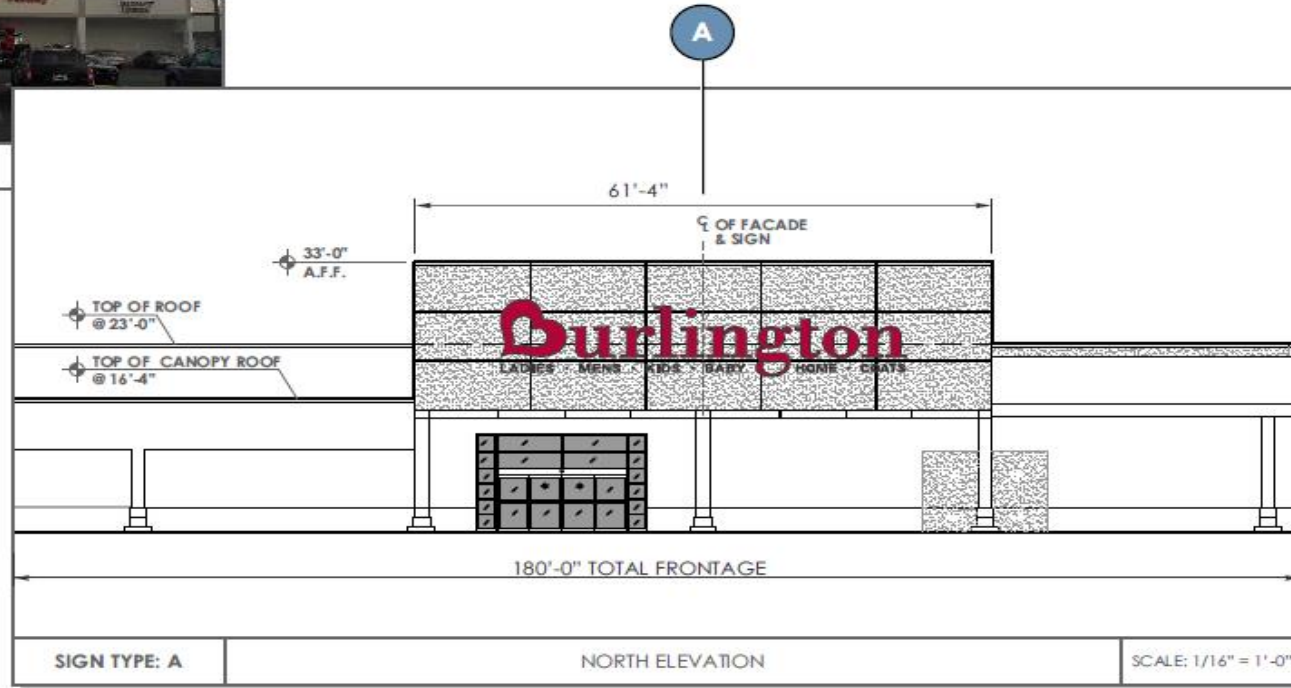

**SCOPE OF WORK**

**Sign(s) Type: A**

**Manufacture and Install:**  
 (1) One Set of Internally (LED) Illuminated Remote Channel Letters

**"Burlington" Letters:**  
 5" Deep, .040" Aluminum Returns Pre-painted Black (Satin Finish), 3/16" White Acrylic Faces with 1st Surface Burlington Red Translucent Vinyl, 1" Black Trim Cap, Red LED's.

**"Tag Line" Letters:**  
 3" Deep, .040" Aluminum Returns Pre-painted Black (Satin Finish), 3/16" Clear Plex Faces with 1st Surface 3M #3635-222 Perforated Black Vinyl, 2nd Surface 3M 30% Diffuser, 1" Black Trim Cap, White 6500k LED's.

**Incoming Power/Access:**  
 120v Primary Circuit(s) by Others, Reasonable Access Required.

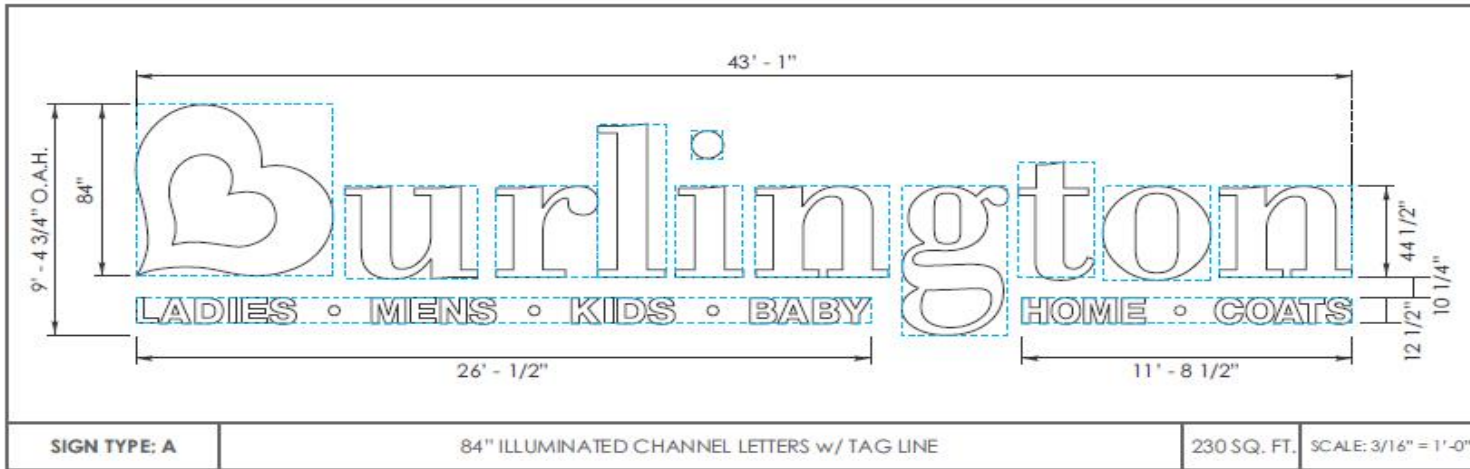
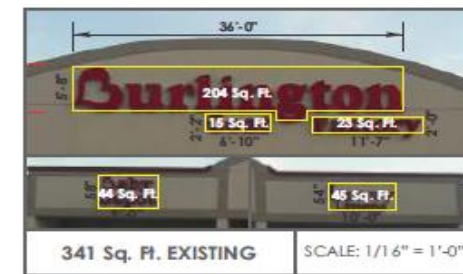

**NOTES:**  
 All dimensions, site and installation conditions, including access and attachment methods, etc. to be verified.

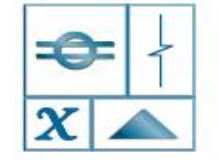

**BLAIR SIGN PROGRAMS**

Northern California:  
 (510) 337-9020  
 Southern California:  
 (619) 792-1600  
 info@blairsign.net  
 CA License # 677503

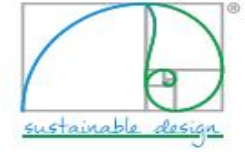

**CLIENT:**  
**Burlington**

**PROJECT:**  
 Harvey, LA #315  
 Planning Submittal

**ADDRESS:**  
 900 Manhattan Blvd.  
 Harvey, LA 70058

**DATE:**  
 01/11/2019

**DESIGNER:**  
 K. Bossert

**DESIGN NO.:**

REVISIONS:	BY:
10/08/20219	JO
02/03/2020	PS

**SIGN TYPE: A**

**SECTION I**  
**SHEET 1**  
 ALL RIGHTS RESERVED  
 © 2018 BLAIR SIGN PROGRAMS

# Face Replacements Only

GS.1

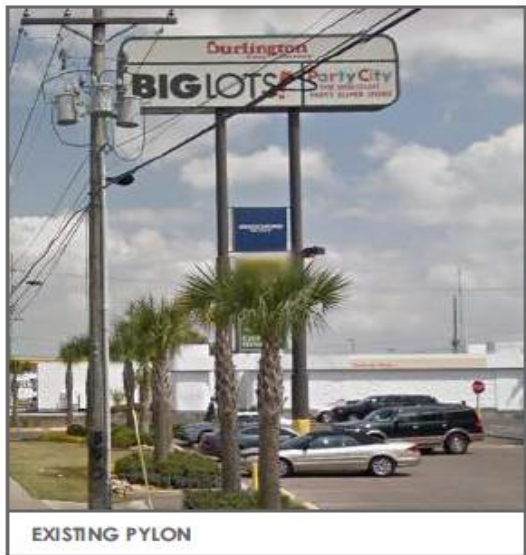

EXISTING PYLON



SIGN TYPE: GS.1 PYLON, TENANT PANEL NOT TO SCALE

**SCOPE OF WORK**

**Sign(s) Type:** GS.1

**Manufacture and Install:**  
 (2) Two re-placement faces on (1) One double-sided pylon as shown and as follows:

**Pana-Flex Faces:**  
 White 3M Pana-Flex w/ digitally printed graphics w/ UV inks to match PMS 207C Red (Copy to be White)

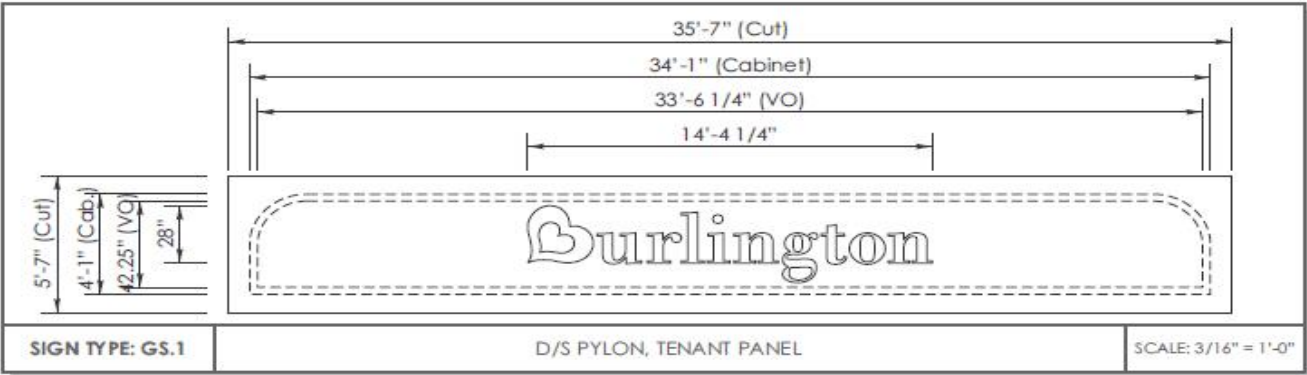

**NOTES:**  
 All dimensions, site and installation conditions, including access and attachment methods, etc. to be verified.



**BLAIR SIGN PROGRAMS**

Northern California:  
 (510) 337-9020  
 Southern California:  
 (619) 792-1600  
 info@blairsign.net  
 CA License # 677503

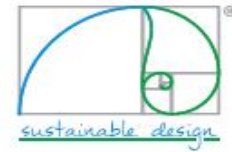

**CLIENT:**  
**Burlington**

**PROJECT:**  
 Harvey, LA #315  
 Planning Submittal

**ADDRESS:**  
 900 Manhattan Blvd.  
 Harvey, LA 70058

**DATE:**  
 01/11/2019

**DESIGNER:**  
 K. Bossert

**DESIGN N°:**

REVISIONS:	BY:
10/08/20219	JO
02/03/2020	PS

SIGN TYPE: GS.1

# Face Replacements Only

GS.2



EXISTING PYLON



SIGN TYPE: GS.2 PYLON, TENANT PANEL NOT TO SCALE

**SCOPE OF WORK**

**Sign(s) Type:** GS.2

**Manufacture and Install:**  
 (2) Two re-placement faces on (1) One double-sided pylon as shown and as follows:

**Pana-Flex Faces:**  
 White 3M Pana-Flex w/ digitally printed graphics w/ UV inks to match PMS 207C Red (Copy to be White)

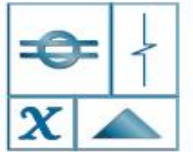

**BLAIR SIGN PROGRAMS**

Northem California:  
 (510) 337-9020  
 Southern California:  
 (619) 792-1600  
 info@blairsign.net  
 CA License # 677503

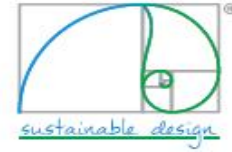

**CLIENT:**  
**Burlington**

**PROJECT:**  
 Harvey, LA #315  
 Planning Submittal

**ADDRESS:**  
 900 Manhattan Blvd.  
 Harvey, LA 70058

**DATE:**  
 01/11/2019

**DESIGNER:**  
 K. Bossert

**DESIGN N<sup>o</sup>:**

REVISIONS:	BY:
10/08/20219	JO
02/03/2020	PS

**SIGN TYPE: GS.2**

**SECTION II SHEET 3**  
 ALL RIGHTS RESERVED  
 © 2018 BLAIR SIGN PROGRAMS

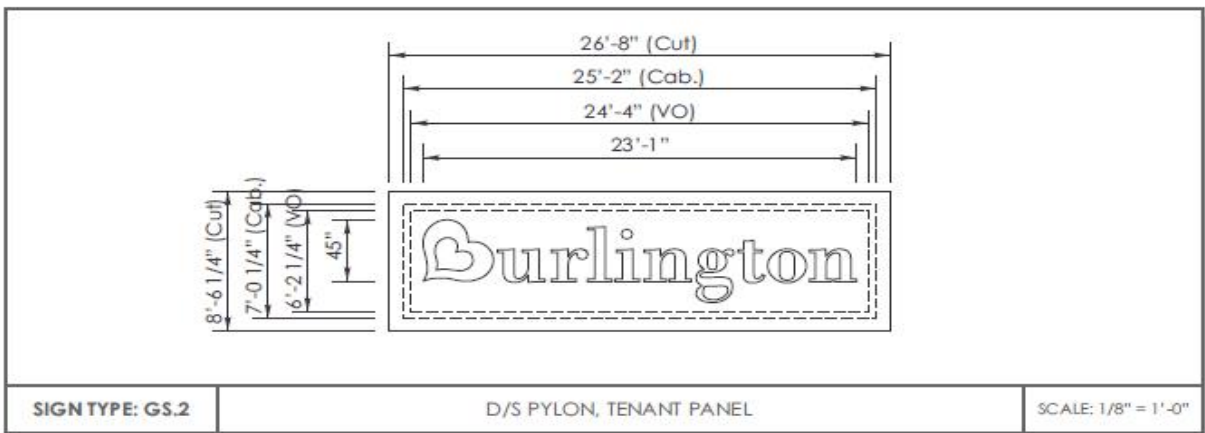

SIGN TYPE: GS.2 D/S PYLON, TENANT PANEL SCALE: 1/8" = 1'-0"

**NOTES:**  
 All dimensions, site and installation conditions, including access and attachment methods, etc. to be verified.

This sign is designed to withstand 130 MPH wind load.  
 This sign will contain a UL label  
 This sign will be installed using 3/8" thru-bolts or appropriately sized fasteners as necessary.

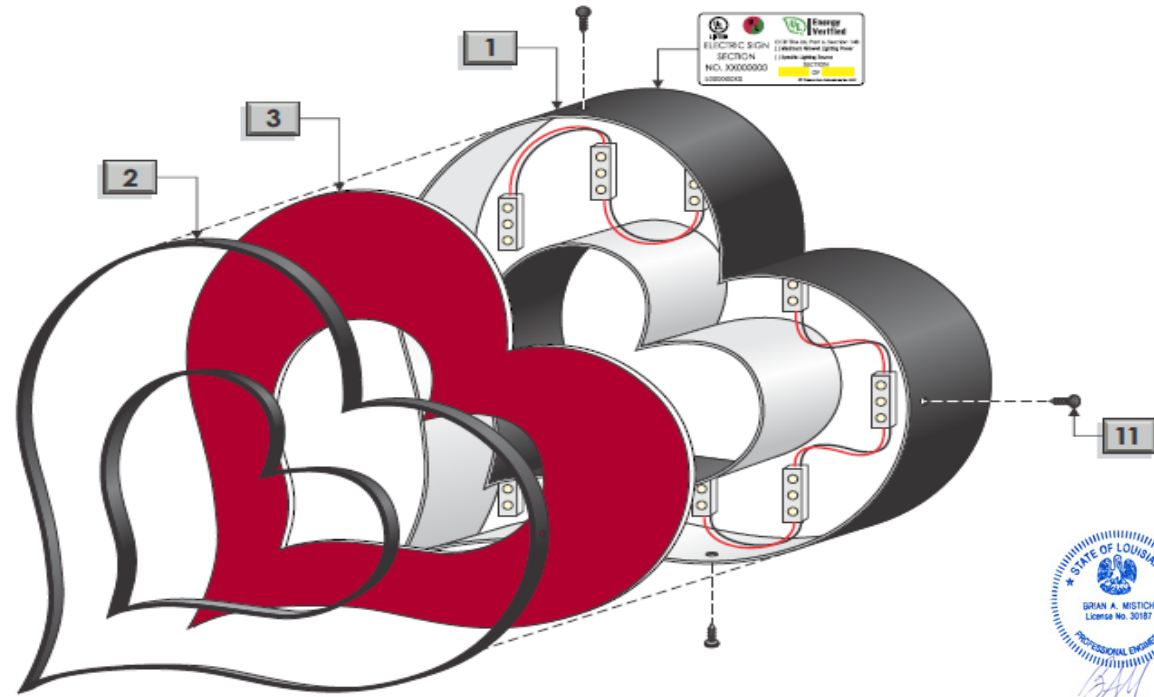

**EXPLODED VIEW: STANDARD FACE LIT CHANNEL LETTER**



**DAMMON**  
 ENGINEERING, INC.  
 LITTLE ROCK, MISSISSIPPI

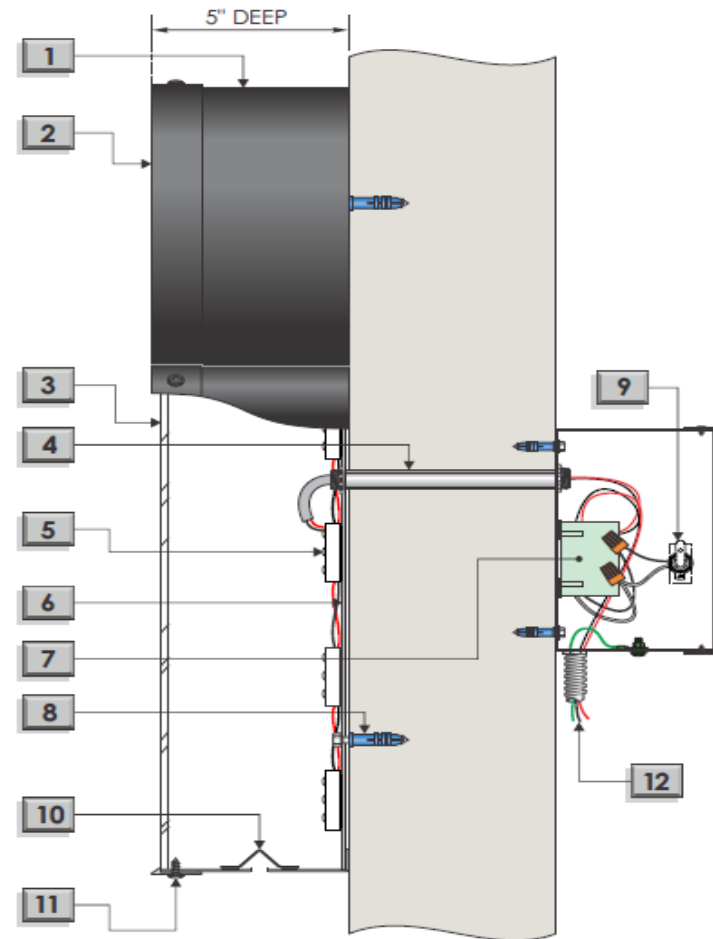

**TYPICAL SECTION** \*UL Listed

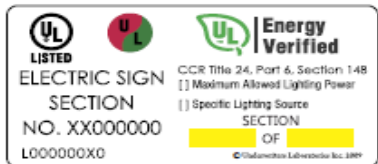

**UL LABEL PLACEMENT**  
 TO BE PLACED ON TOP OF LETTERS

<b>1</b>	.040" Aluminum Returns Pre Painted Black (Satin Finish)	<b>7</b>	Power Supply w/ Enclosure (SNAP 2 Power Supply Box P.N. 980054C)*
<b>2</b>	1" Black Trim Cap	<b>8</b>	Attachment Anchor - Varies
<b>3</b>	3/16" White Acrylic w/ 1st Surface Translucent Burlington Red Vinyl (PMS 207c)	<b>9</b>	Disconnect Switch*
<b>4</b>	1/2" Pass Through*	<b>10</b>	1/4" Dia. Weep Hole (2) Per Letter. w/ Weep Hole Cover
<b>5</b>	"Red" LED Modules*	<b>11</b>	SS. Pan Head Screw Painted Black
<b>6</b>	.040" Aluminum Letter Backs	<b>12</b>	Incoming Power by Others

**Exterior - Red Channel Letters: Remote P/S**

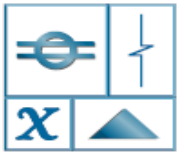

**BLAIR SIGN PROGRAMS**

Northern California:  
 (510) 337-9020  
 Southern California:  
 (619) 792-1600  
 info@blairsign.net  
 CA License # 677503

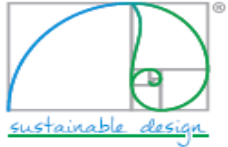

**CLIENT:**  
**Burlington**

**PROJECT:**  
 Harvey, LA #315  
 Planning Submittal

**ADDRESS:**  
 900 Manhattan Blvd.  
 Harvey, LA 70058

**DATE:**  
 01/11/2019

**DESIGNER:**  
 K. Bossert

**DESIGN N°:**

REVISIONS:	BY:
10/08/2021 9	JO
02/03/2020	PS

**SIGN TYPE: A**  
**C.L. DETAIL**

**SECTION III**  
**SHEET 4**

ALL RIGHTS RESERVED  
 © 2018 BLAIR SIGN PROGRAMS

This sign is designed to withstand 130 MPH wind load.  
 This sign will contain a UL label  
 This sign will be installed using 3/8" thru-bolts or appropriately sized fasteners as necessary.

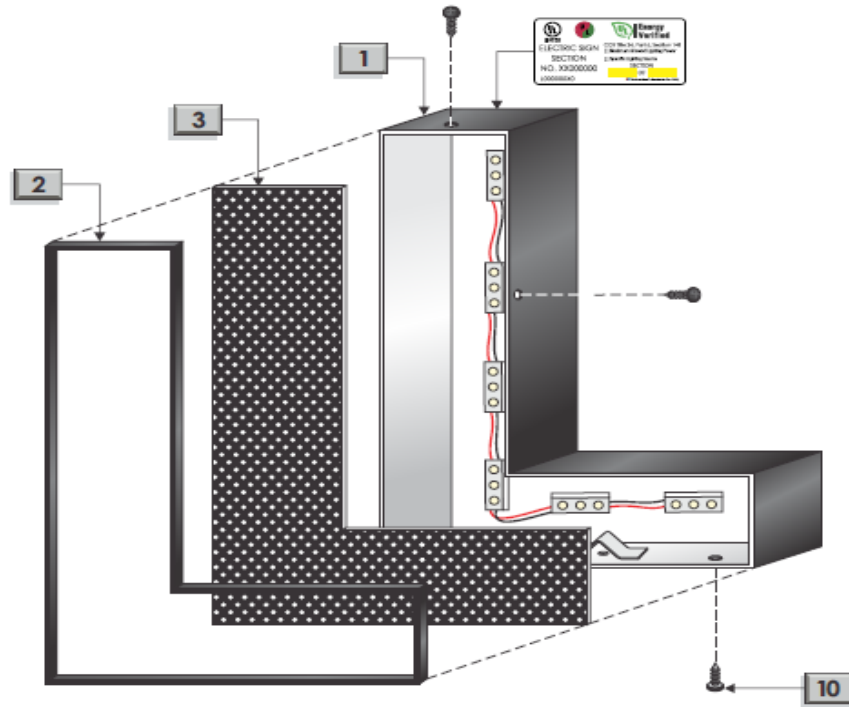

**EXPLODED VIEW: STANDARD FACE LIT CHANNEL LETTER**

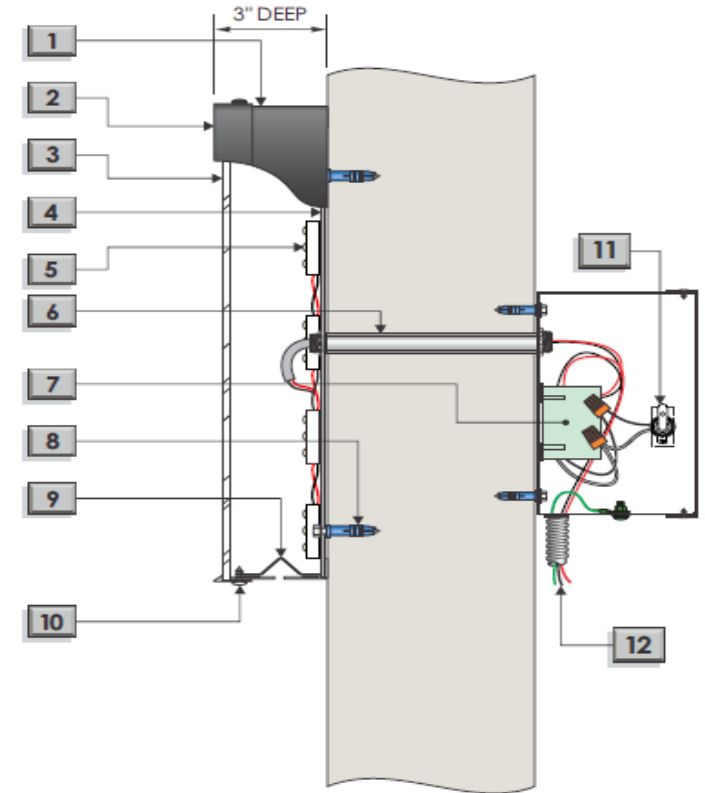

**TYPICAL SECTION** \*UL Listed

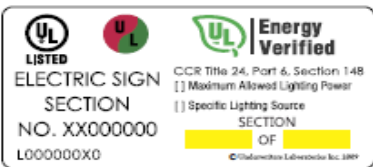

**UL LABEL PLACEMENT**  
 TO BE PLACED ON TOP OF LETTERS

<b>1</b>	.040" Aluminum Returns Pre Painted Black (Satin Finish)	<b>7</b>	Power Supply w/ Enclosure (SNAP 2 Power Supply Box P.N. 980054C)*
<b>2</b>	1" Black Trim Cap	<b>8</b>	Attachment Anchor - Varies
<b>3</b>	3/16" Clear Plex w/ 1st Surface 3M 3635-222 Perforated Black Vinyl & 2nd Surface 3M 30% Diffuser	<b>9</b>	1/4" Dia. Weep Hole (2) Per Letter. w/ Weep Hole Cover
<b>4</b>	.040" Aluminum Letter Backs	<b>10</b>	SS. Pan Head Screw Painted Black
<b>5</b>	"White" LED Modules* / Color Temp: 6500K	<b>11</b>	Disconnect Switch*
<b>6</b>	1/2" Pass Through*	<b>12</b>	Incoming Power by Others

**Exterior - Perforated Black Tag Line Channel Letters: Remote P/S**



**BLAIR SIGN PROGRAMS**

Northern California:  
 (510) 337-9020  
 Southern California:  
 (619) 792-1600  
 info@blairsign.net  
 CA License # 677503

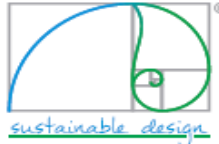

CLIENT:  
**Burlington**

PROJECT:  
 Harvey, LA #315  
 Planning Submittal

ADDRESS:  
 900 Manhattan Blvd.  
 Harvey, LA 70058

DATE:  
 01/11/2019

DESIGNER:  
 K. Bossert

DESIGN NO.:

REVISIONS:	BY:
10/08/20219	JO
02/03/2020	PS

**SIGN TYPE: A  
 TAG LINE C.L. DETAIL**

**SECTION III  
 SHEET 5**

ALL RIGHTS RESERVED  
 © 2018 BLAIR SIGN PROGRAMS