

Sally's Beauty Supply  
700 Terry Parkway Ste. G  
Gretna, LA 70056

Scope of work:  
Install one new building sign

Carol Sue Ave

Terry Parkway

# 36" LINEAR CHANNEL LETTER SET

48 SQUARE FEET

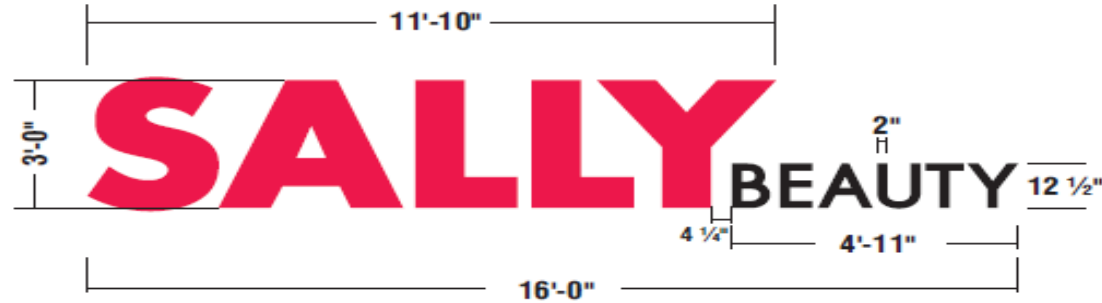

## FLUSH MOUNT CHANNEL LETTER SET

SCALE: 1/4" = 1'-0"

### SPECIFICATIONS

- 3" DEEP .050 ALUMINUM RETURNS PAINTED BLACK.
- 1" TRIM CAP BLACK.
- FACES ARE FLAT TRANSLUCENT  
"SALLY" #2793 RED 3/16" PLEX.  
"BEAUTY" #2447 WHITE ACRYLIC WITH 70/30 BLACK PERFORATED VINYL.
- LETTERS ARE INTERNALLY ILLUMINATED WITH USLED LED MODULES  
RED FOR "SALLY"  
WHITE FOR "BEAUTY"
- LETTERS ARE MOUNTED FLUSH TO BUILDING WITH NON-CORROSIVE MOUNTING HARDWARE.

Electrical Notes:  
All electrical components to be UL approved  
Customer is responsible for one (1) 120v/20a dedicated circuit with ground per sign within 6' of sign  
Lock out switch installed at panel box for all electrical signs  
Install in accordance with N.E.C. article 600 and/or local codes. This includes proper grounding and bonding of signs

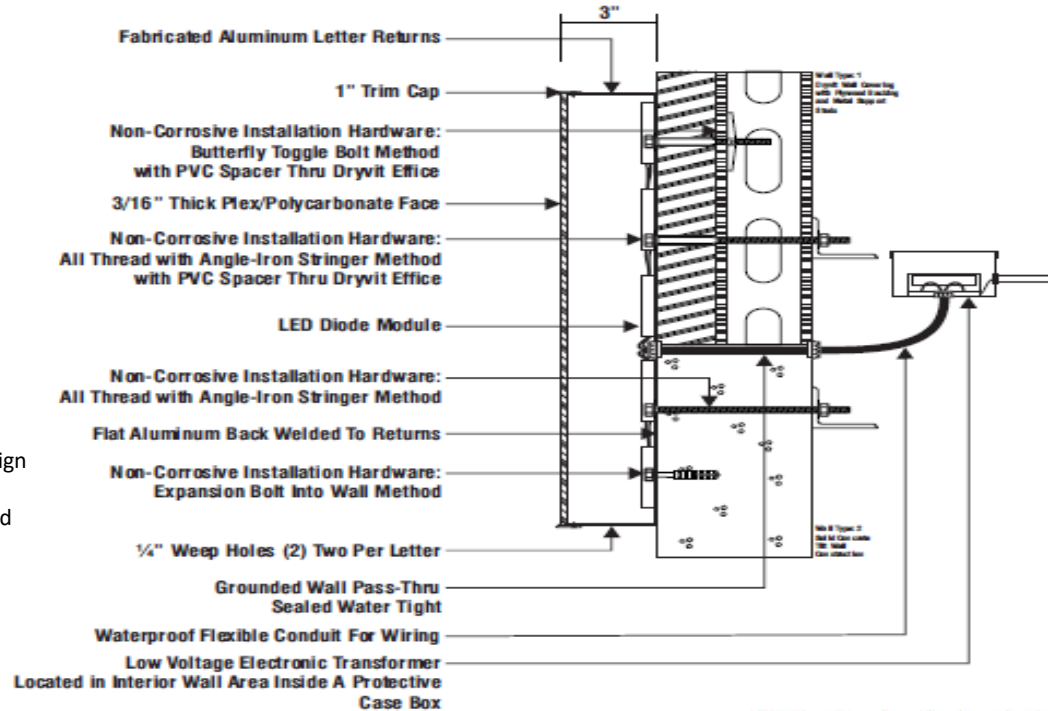

**Houston  
Dallas**

**Houston Corporate Office**  
5225 Katy Frwy. Ste 350  
Houston, Texas 77007  
**713-977-7900**  
Fax 713-977-7903

**Dallas Regional Office**  
2220 San Jacinto Blvd. #365  
Denton, Texas 76205  
**940-380-9153**  
FAX: 940-380-9395

**SALLY  
BEAUTY**

Address: **STANDARDS**

City: \_\_\_\_\_

State: \_\_\_\_\_

Account Rep: **S. GIBBS**

Sales Rep: **K. CREP**

APPROVALS

CLIENT \_\_\_\_\_

DESIGN \_\_\_\_\_

PROD. \_\_\_\_\_

Designer: **J. WOMACK**

Design No. **Us158761**

DATE **7-20-15**

Rev. Date: **0-00-15**

Rev. Date: **0-00-15**

Rev. Date: **0-00-15**

Rev. Date: **0-00-15**

Rev. Date: **0-00-15**

Rev. Date: **0-00-15**

Rev. Date: **0-00-15**

Rev. Date: **0-00-15**

Rev. Date: **0-00-15**

Rev. Date: **0-00-15**

Rev. Date: **0-00-15**

Rev. Date: **0-00-15**

Rev. Date: **0-00-15**

Rev. Date: **0-00-15**

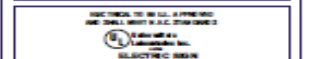

**1:2**

The purchaser agrees to hold the seller harmless against any cause for action for damage which may occur as a result of drilling for pipes and foundations, including but not limited to, sewer, gas lines or any underground obstacles which the purchaser or others may discover.

**DAMMON  
ENGINEERING, INC.**

THIS DESIGN AND ENGINEERING IS SUBMITTED AS OUR PROPOSAL, AND THE RIGHT TO USE OR EXHIBIT IN ANY FORM, IS NOT AUTHORIZED WITHOUT WRITTEN PERMISSION BY US SIGNS.