

**LOT D-2A
CARROLLWOOD VILLAGE
JEFFERSON PARISH, LA.**

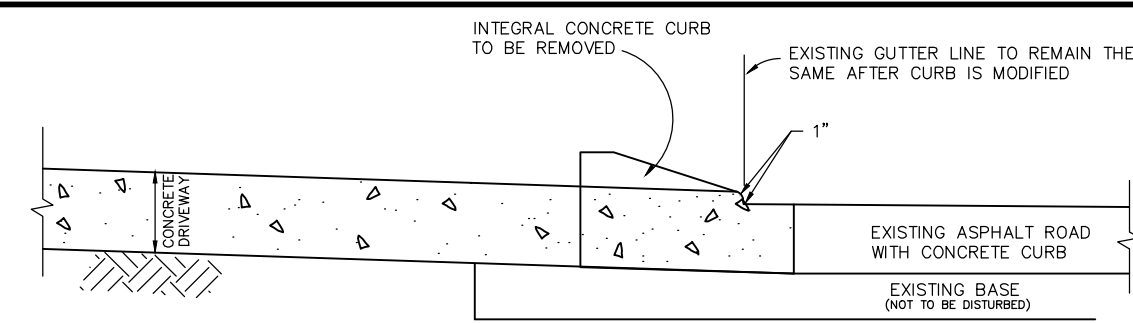
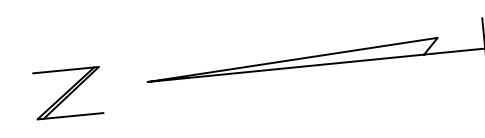

**DETAIL "A"
NEW DRIVEWAY CONNECTION TO EXISTING ASPHALT ROADWAY
WITH ROLLOVER CURB (CURB TO BE REMOVED)**

D-2B

PAVING NOTES

1. PORTLAND CEMENT CONCRETE SHALL BE 6" - 8" THICK (AS SPECIFIED ON PLANS) AND ATTAIN A MINIMUM STRENGTH OF 4,000 PSI IN 28 DAYS.
2. EXISTING VEGETATION AND SOFT SPOTS SHALL BE REMOVED FROM SITE. ANY FILL PROVIDED SHALL BE AASHO A-4 OR BETTER (COMMON RIVER SAND). SUBGRADE SHALL BE COMPACTED TO 97% DENSITY. SAND BASE SHALL BE 12" THICK (MINIMUM).
3. EXPANSION JOINTS SHALL BE PLACED AS SHOWN. THEY SHALL BE FORMED BY 1" THICK PREMOLDED BITUMINOUS MATERIAL OR REDWOOD AND BE RECESSED 1/2" BELOW FINISHED SURFACE OF PAVEMENT. THE JOINTS SHALL HAVE #4 SMOOTH DOWEL BARS BY 24" LONG SPACED 2'-6" ON CENTERS WITH METAL EXPANSION CAPS COVERING ONE END TO ALLOW FOR EXPANSION.
4. CONTRACTION JOINTS SHALL BE PLACED AS SHOWN. THE JOINTS SHALL HAVE #4 DEFORMED DOWEL BARS BY 24" LONG SPACED 2'-6" ON CENTERS. CUTS ARE TO BE A FULL 1/2" WIDE AND A FULL 2-1/2" DEEP. CUTS SHALL BE FILLED WITH SANABARN SL1 OR EQUAL.
5. ALL DOWEL AND REINFORCING BARS SHALL BE HELD LEVEL DURING PAVEMENT OPERATIONS WITH THE USE OF SUITABLE WIRE CHAIRS OR METAL SUPPORTS.
6. THE FINAL CONCRETE FINISH AND TEXTURE SHALL BE OBTAINED BY USING A FABRIC DRAG FINISH, IN ACCORDANCE WITH THE LA DOTD STANDARD SPECIFICATIONS FOR ROADWAYS AND BRIDGES.
7. AFTER FINISHING OPERATIONS HAVE BEEN COMPLETED, THE NEWLY LAID CONCRETE SHALL BE PROTECTED AND CURBED BY AN APPROVED MEMBRANE CURING COMPOUND, IN ACCORDANCE WITH THE LA DOTD STANDARD SPECIFICATIONS FOR ROADWAYS AND BRIDGES.
8. ALL MATERIALS, INSTALLATION AND WORKMANSHIP SHALL MEET LA DOTD STANDARD SPECIFICATIONS FOR ROADWAYS AND BRIDGES.
9. PARKING STALLS MUST BE STRIPPED WITH A FOUR (4) INCH CONTRASTING STRIPE (YELLOW ON CONCRETE AND YELLOW OR WHITE ON ASPHALT PARKING LOT).
10. HANDICAP PARKING SPACE TO BE DESIGNATED BY BLUE STRIPING & EITHER A BLUE SYMBOL ON A WHITE BACKGROUND OR A WHITE SYMBOL ON A BLUE BACKGROUND. HANDICAP PARKING STALL REQUIRES THE INSTALLATION OF THE PROPER SIGNAGE.
11. ALL WHEEL STOPS AND CONCRETE CURBS SHALL BE CONSTRUCTED IN ACCORDANCE WITH THE DETAIL SHOWN ON THIS PLAN.

TRAFFIC CONTROLS
ANY WORK IN THE ROADWAY OR ADJACENT TO THE ROADWAY CAUSING AN INTERFERENCE TO VEHICULAR TRAFFIC REQUIRES PRIOR NOTIFICATION TO JEFFERSON PARISH DEPT OF PUBLIC WORKS AND LA DOTD AND CONFORMITY TO THE REQUIREMENTS OF THE UNIFORM MANUAL ON TRAFFIC CONTROL DEVICES OF THE STATE OF LOUISIANA. THE CONTRACTOR MUST FURNISH ALL NECESSARY TRAFFIC SIGNS AND/OR BARRICADES, AND MAINTAIN THEM DURING CONSTRUCTION ACTIVITY.

LEGEND

- S- SEWER LINE
- W- WATER LINE
- G- GAS LINE
- O- OVERHEAD UTILITY LINES
- ⊙ GAS METER
- ⊙ GAS VALVE
- ⊙ WATER METER
- ⊙ WATER VALVE
- ⊙ FIRE HYDRANT
- ⊙ DRAIN CLEANOUT
- ⊙ SEWER CLEANOUT
- ⊙ POWER POLE
- ⊙ ANCHOR
- ⊙ LIGHT POLE
- ⊙ DOWNSPOUT

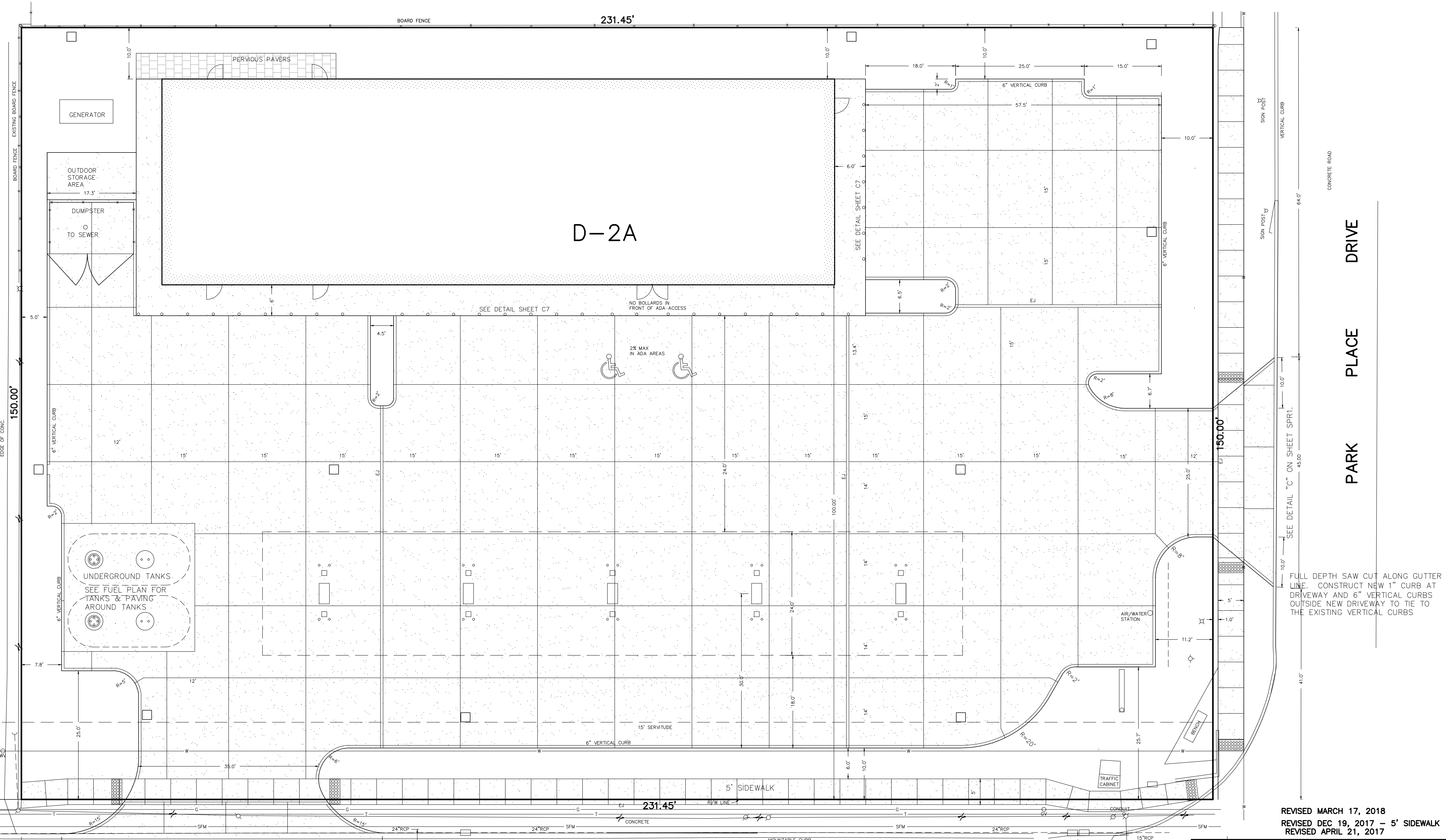

REMOVE AND REPLACE EXISTING CONCRETE CURB. SEE DETAIL "A" ON SHEET C3.

CONTRACTOR TO COORDINATE WITH ENTERGY AND AT&T FOR RELOCATION OF UTILITY POLE

REVISED MARCH 17, 2018
REVISED DEC 19, 2017 - 5' SIDEWALK
REVISED APRIL 21, 2017

BROTHER'S FOODMART
799 BEHRMAN HIGHWAY
TERRYTOWN, LA
PAVING PLAN



DUFRENE SURVEYING & ENGINEERING INC.
1624 MANHATTAN BOULEVARD, HARVEY, LA 70058
504-368-6360 PH
504-368-6394 FAX
dufrene@dufrenesurveying.com

