

LIFE-SAFETY INFORMATION

APPLICABLE CODES	
NFPA 101 LIFE-SAFETY CODE 2015	
OCCUPANCY TYPE(S) AND CHAPTER(S)	
BUSINESS (CHAPTER 38)	
MULTIPLE, MIXED, OR SEPARATE OCCUPANCY (REFERENCE CHAPTER 6)	
N/A	
OCCUPANT LOAD FACTOR (REFERENCE TABLE 7.3.1.2)	
1,950 SF / 100 SF PER OCCUPANT =	21 OCCUPANTS
CLASSIFICATION OF HAZARD OF CONTENTS	
(REFERENCE: OCCUPANCY CHAPTER AND 6.2.2: SPECIFY LOW, ORDINARY, OR HIGH)	
CONSTRUCTION TYPE(S) (REFERENCE: CHAPTERS, TABLE A.9.2.1.2 AND COMMENTARY TABLE 8.1 IN HANDBOOK)	
V	
MINIMUM EXIT SEPARATION DISTANCE FOR REMOTELY LOCATED EXITS	
(REFERENCE: SECTION 7.5; SPECIFY 1/2 OR 1/3 DIAGONAL DISTANCE OF AREA SERVED)	
1/3 DIAGONAL =	24'-10"
MAXIMUM DEAD-END CORRIDORS (REFERENCE: OCCUPANCY CHAPTER AND TABLE A.7.6)	
50'	
MAXIMUM COMMON PATH OF TRAVEL DISTANCE (REFERENCE: OCCUPANCY CHAPTER AND TABLE A.7.6)	
100'	
MAXIMUM TRAVEL DISTANCE TO EXITS (REFERENCE: OCCUPANCY CHAPTER AND TABLE A.7.6)	
300'	
*MAIN ENTRANCE MUST BE SIGNED TO ACCOMMODATE 1/2 OCCUPANT LOAD OF BUILDING	

DETECTION, ALARM, AND COMMUNICATION SYSTEMS	NO
ALLOWABLE HEIGHT AND BUILDING AREA	PER IBC EQUIVALENT CONSTRUCTION TYPE

BUILDING CODE INFORMATION

APPLICABLE CODES	
IBC 2021	
BUSINESS GROUP B (IBC 2021 CHAPTER 3)	
OCCUPANT LOAD CALCULATIONS (TABLE 1004.1.1)	
BUSINESS =	1,950 SQ FT 100 SF PER OCCUPANT (GROSS) 21 OCCUPANTS
CONSTRUCTION TYPE(S) (TABLE 504)	
VB (SECTION 504)	
ALLOWABLE HEIGHT AND BUILDING AREA LIMITED BY TYPE OF CONSTRUCTION	
MAXIMUM HEIGHT IN STORIES (SECTION 504.4)	2
MAXIMUM AREA IN SQUARE FEET (SECTION 503, 506 & 507, TABLE 503)	9,000

WIND SPEED DESIGN REQUIREMENTS

THIS BUILDING SHALL BE DESIGNED WITH IBC SEC 1609 AS A FULLY ENCLOSED BLDG USING THE FOLLOWING INFORMATION:

WIND DESIGN DATA:

DETERMINATION OF WIND LOADS SHALL BE IN ACCORDANCE WITH IBC SEC 1609.3 (1), (2), OR (3) DEPENDING ON THE RISK CATEGORY

WIND SPEED V_{ult} (3 SECOND GUST) = 140 MPH (IBC FIG 1609.3(1))

NOMINAL DESIGN WIND SPEED V_{asd} = 110 MPH ($V_{ult} \times (0.6)^{1/2}$)

RISK CATEGORY: CATEGORY II BLDG SURFACE ROUGHNESS = B

TOPOGRAPHIC FACTOR = 1 EXPOSURE = B

DESIGN WIND PRESSURE (ASCE 7-10 TABLE 28.6-1): 31.7 PSF

INTERNAL PRESSURE COEFFICIENT (ASCE 7-10 TABLE 28.11-1): ± 0.18

LIVE LOADS (IBC SEC 1607)

OFFICE LOBBIES & CORRIDORS 1ST FLOOR (IBC TABLE 1607.1): 100 PSF

OFFICES (IBC TABLE 1607.1): 50 PSF

ROOF LIVE LOADS (IBC TABLE 1607.1): 20 PSF UNIFORM, 300 LB CONCENTRATED

SNOW LOADS (IBC SEC 1608):

GROUND SNOW LOAD (IBC FIG 1608.2): 5 PSF

FLOOD ZONE INFORMATION

BASED ON THE SURVEY OF THIS PROPERTY BY J.V. BURKES, THIS PROPERTY IS NOT IN SPECIAL FLOOD HAZARD AREA

FIRM, COMMUNITY NO. 22520500415 C DATED 4-02-1991

FLOOD ZONE: C BASE FLOOD ELEVATION: N/A

LIFE-SAFETY LEGEND

SYMBOL	DESCRIPTION
	EXITS
	DOOR FIRE RATING (MINUTES)
	DOOR WIDTH/EGRESS CAPACITY
	EXIT LIGHT
	FIRE EXTINGUISHER IV WALL MTD BRACKET
	COMMON PATH OF TRAVEL
	TRAVEL DISTANCE
	DECISION POINT

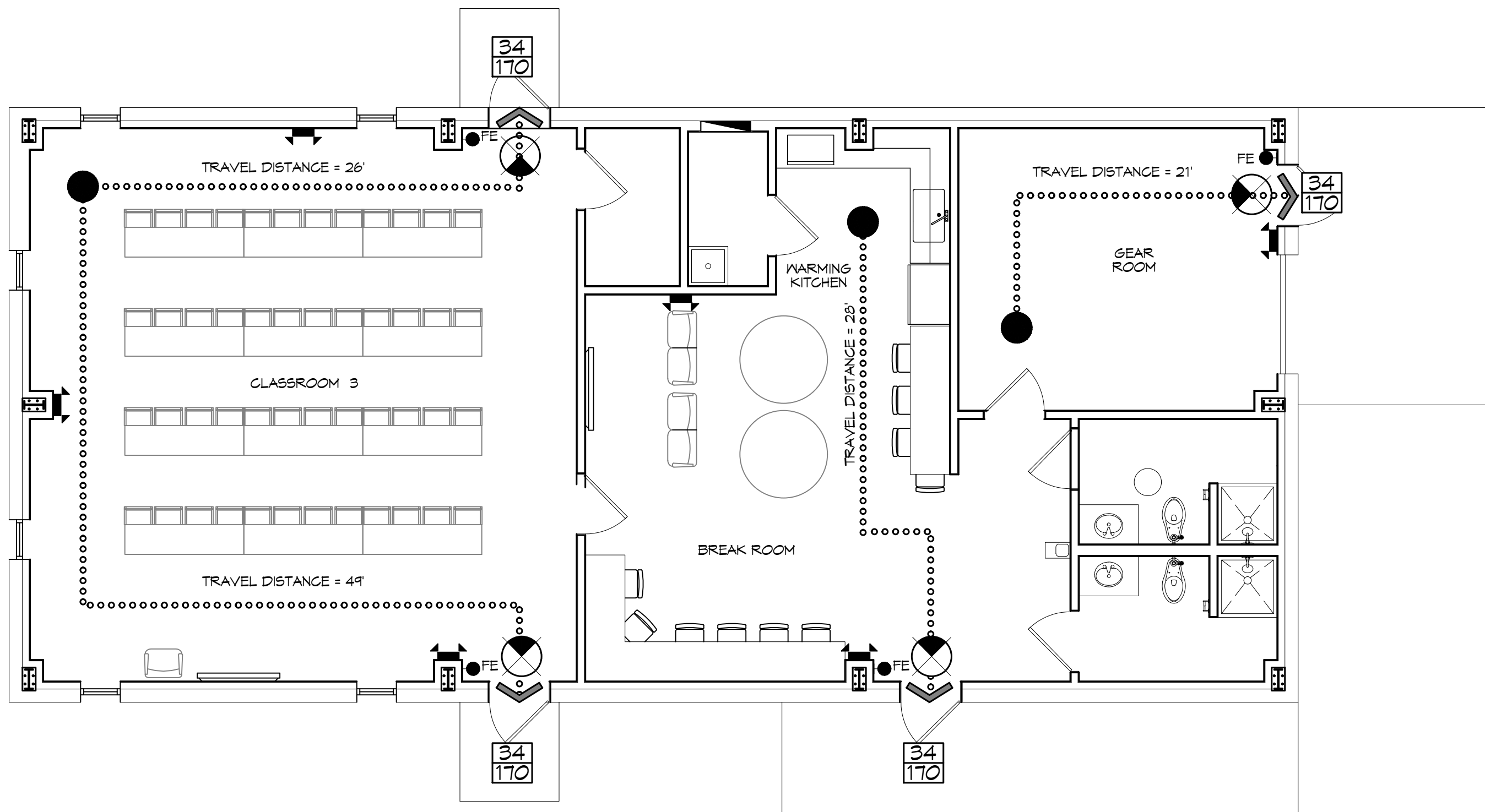

LIFE-SAFETY PLAN
SCALE: 3/16" = 1'-0"

VICINITY MAP



SHEET INDEX

SHEET #	SHEET TITLE
G101	GENERAL INFORMATION SHEET
G102	ACCESSIBILITY INFORMATION
C101	SITE PLAN
C102	DRAINAGE AND UTILITY SITE PLAN
C103	PAVING & FILL PLAN
C104	EROSION CONTROL AND DETAILS
S101	FOUNDATION PLAN
A101	FLOOR PLAN
A102	EXTERIOR ELEVATIONS
A103	ROOF PLAN AND BLDG SECTION
A104	REFLECTED CEILING PLAN
P101	PLUMBING PLAN
M101	MECHANICAL FLOOR PLAN, SCHEDULES & DETAILS
E101	POWER PLAN
E102	LIGHTING PLAN

GENERAL NOTES

- ALL MATERIALS AND WORK, INCIDENTAL TO THE CONSTRUCTION OF THIS PROJECT, SHALL CONFORM TO ALL GOVERNING CODES, AND REGULATIONS OF AGENCIES IN AUTHORITY.
- CONTRACTOR SHALL PROVIDE ALL PUBLIC PROTECTIONS NECESSARY AS REQUIRED BY LAW.
- THE DRAWINGS AND ANY SUBSEQUENTLY ISSUED ADDENDA, AMENDMENTS OR SUCH CHANGE ORDERS APPROVED BY THE OWNER AND THE CONTRACTOR ARE PART OF THESE CONTRACT DOCUMENTS.
- DO NOT SCALE DRAWINGS. CONSULT WITH THE ENGINEER REGARDING ANY ITEMS IN THE CONTRACT DOCUMENTS THAT REQUIRE CLARIFICATION.
- TRASH SHALL BE REMOVED FROM THE SITE NOT LESS THAN TWICE MONTHLY.
- THE GENERAL CONTRACTOR SHALL VERIFY EXISTING CONDITIONS PRIOR TO COMMENCING WORK AND REPORT ANY AND ALL DISCREPANCIES TO THE ARCHITECT.
- CONTRACTOR VEHICLES AND EQUIPMENT NECESSARY FOR CONSTRUCTION MAY BE PARKED ON THE SITE. OTHER VEHICLES PARKED ON THE SITE REQUIRE THE OWNER'S PERMISSION.
- ALL MATERIALS/EQUIPMENT SHALL BE INSTALLED PER MANUFACTURER'S RECOMMENDATIONS. WORK NOT CONSISTENT WITH MANUFACTURER'S RECOMMENDATIONS WILL BE REJECTED BY OWNER/ARCHITECT.

DAMMON ENGINEERING, INC.
LOUISIANA & MISSISSIPPI

Chief Engineer: Brian Mistich, PE
554 Old Spanish Trail
Slidell, LA 70458
www.dammonengineering.com
info@dammonengineering.com
PH: 985.649.5832

DATE	REVISIONS



NEW TRAINING FACILITY
ST. TAMMANY FIRE PROTECTION DISTRICT NO. 1

34750 S RANGE ROAD
SLIDELL, LA 70460

JOB NO.: 2807 DATE: 02-04-2025
DRAWN BY: CKD CHECKED BY: JMS

GENERAL INFORMATION SHEET

DRAWING NUMBER:

G101

SHEET No: 1 of 15