

SECTION 7.0112 MAINTENANCE & REPLACEMENT

- A. MAINTENANCE: The Owner or his agent shall be responsible for the maintenance and repair of all landscaping materials and barriers as may be required by the provisions of this Section.
- Planting Beds shall be mulched to prevent weed growth and maintain soil moisture.
 - Plant Materials shall be pruned as required to maintain good health and character.
 - Turf areas shall mowed periodically.
 - All roadways, curbs and sidewalks shall be edged when necessary in order to prevent encroachment from the adjacent grassed areas.
 - The Owner of the Property shall be responsible for the provision of adequate water, fertilizer and nutrients to the required plant materials.
- B. REPLACEMENT: Subject to the provisions of Section 7.0105.E entitled, "Replacement of Preserved Trees that Die", trees and plants that die must be replaced within six (6) months of the death of the tree or plant with trees or plants that meet the requirements of Section 7.01. Barriers and curbs that are damaged or destroyed beyond repair shall be replaced within six (6) months after the damage or destruction.

Certification of Installation According to the Landscape Documentation Package

I certify that based upon periodic site observation, the work has been substantially completed in accordance with the ordinance and that the landscape planting and irrigation installation conform with the criteria and specifications of the approved landscape and irrigation plan.

Signature	Date
Name (print)	Telephone No.
Title	Email Address
License No. or Certification No.	Street Address
Company	State
City	Zip Code

*Signer of the approved landscape and irrigation plan

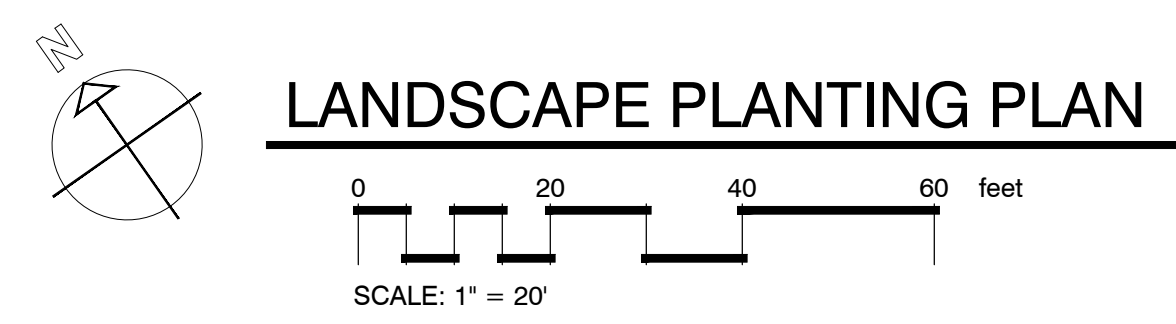

PLANT SCHEDULE

SYMBOL	CODE	QTY	BOTANICAL / COMMON NAME	CONT	CAL	SIZE	
CLASS 'A'							
	QN	4	Quercus nuttallii / Nuttall Oak	Gallon or B&B	2.50" Cal.	10' to 12' ht.	
	SS	12	Sabal palmetto / Cabbage Palmetto	B&B	8' C.T.	Regenerated	
CLASS 'B'							
	IE	15	Ilex x attenuata 'Eagleston' / Eagleston Holly	Gallon or B&B	1.50" Cal.	8'-10' ht.	
	LM	6	Lagerstroemia indica x fauriei 'Muskoegee' / Muskoegee Crape Myrtle	Gallon or B&B	1 Inch per trunk, Min. 3 trunks	8'-10' ht.	
	ML	17	Magnolia grandiflora 'Little Gem' / Little Gem Dwarf Southern Magnolia	Gallon or B&B	1.50" Cal.	8'-10' ht.	
SYMBOL	CODE	QTY	BOTANICAL / COMMON NAME	CONT	SIZE		
SHRUBS							
	IB	35	Ilex cornuta 'Burfordii Nana' / Dwarf Burford Holly	7-Gal.	2' ht. at the time of planting		
	MS	16	Miscanthus sinensis 'Adagio' / Adagio Eulalia Grass	3-Gal.	2' ht. at the time of planting		
SYMBOL	CODE	QTY	BOTANICAL / COMMON NAME	CONT	REMARKS		SPACING
GROUND COVERS							
	SOD	24,173 sf	Cynodon dactylon / Bermudagrass	Squares or Mini Rolls	Class 'A'		
	MULCH	1,068 sf	Mulch Area / Pine Straw Mulch	Pine Straw Bales	4" Depth		

ST. TAMMANY PARISH-LANDSCAPE, BUFFERING, SCREENING, & TREE PRESERVATION

EXHIBIT 600-3-13 LANDSCAPE AREA REQUIREMENTS		ST. TAMMANY PARISH-LANDSCAPE, BUFFERING, SCREENING, & TREE PRESERVATION				
STREET/BUFFER NAME	BUFFER LENGTH (FT)	BUFFER DEPTH (FT)	CODE REQUIRED LANDSCAPE		PROVIDED LANDSCAPE	
			SINGLE STREET FRONTAGE			
			(4) CLASS "A" & (6) CLASS "B" TREES & (20) SHRUBS / 100'			
			TREES	SHRUBS	TREES	SHRUBS
LAKESHORE VISTA BLVD.	251'	25	(10) CLASS "A" TREES & (15) CLASS "B" TREES	51.0	(10) CLASS "A" TREES & (15) CLASS "B" TREES	51.0
			SIDE YARD LANDSCAPE AREA (LV-3)			
			(3) CLASS "B" TREES / 100'			
			TREES	SHRUBS	TREES	SHRUBS
NORTH SIDE BUFFER	203'	10	(7) CLASS "B" TREES	-	(7) CLASS "B" TREES	-
WEST SIDE BUFFER	246	10	(8) CLASS "B" TREES	-	(8) CLASS "B" TREES	-
EAST SIDE BUFFER	266'	10	(8) CLASS "B" TREES	-	(8) CLASS "B" TREES	-

ALPHONSE BARCIA III
LANDSCAPE ARCHITECT LLC.
562 CLAYTON COURT
SLIDELL, LOUISIANA 70461
BARCIADESIGNS@GMAIL.COM
(985) 960-0429

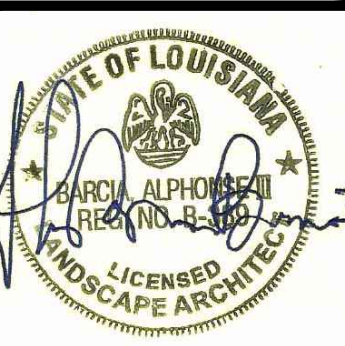
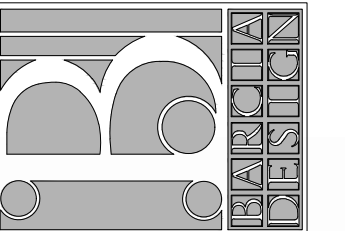

12-10-2025

THIS DRAWING IS AN INSTRUMENT OF SERVICE, AND THE PROPERTY OF THE ARCHITECT AND MAY BE USED ONLY ON THE PROJECT NAMED HEREIN. THIS DRAWING SHALL NOT BE REPRODUCED, COPIED OR USED IN WHOLE OR PART WITHOUT WRITTEN PERMISSION OF THE ARCHITECT. ANY USE IS A VIOLATION OF FEDERAL AND STATE COPYRIGHT STATUTES.

New Fire Station #10

St. Tammany Fire Protection
2745 Lakeshore Vista Blvd.
Slidell, LA.

Sheet Title: Landscape Planting Plan

JOB No.:

SCALE: AS SHOWN

DRAWN BY: AB3

CHECKED BY: AB3

SHEET:

LS-1

REV.

DATE: DECEMBER 10TH 2025