

A SOLID CORE WOOD or HOLLOW METAL WITH ELECTRIC STRIKE

DOOR(s)					
110a	110b	111a	111b	112	
125	126	133	138c	143	
149	157a	201	204	206	
211	222	240			

- 2 SUPPLIED AND INSTALLED BY OTHERS:
- ELECTRIC STRIKE 1006CLB
 - DOOR POSITION SWITCH DPS-M-BK
 - WIRING HARNESS QC-C1500P
 - POWER SUPPLY AGD1

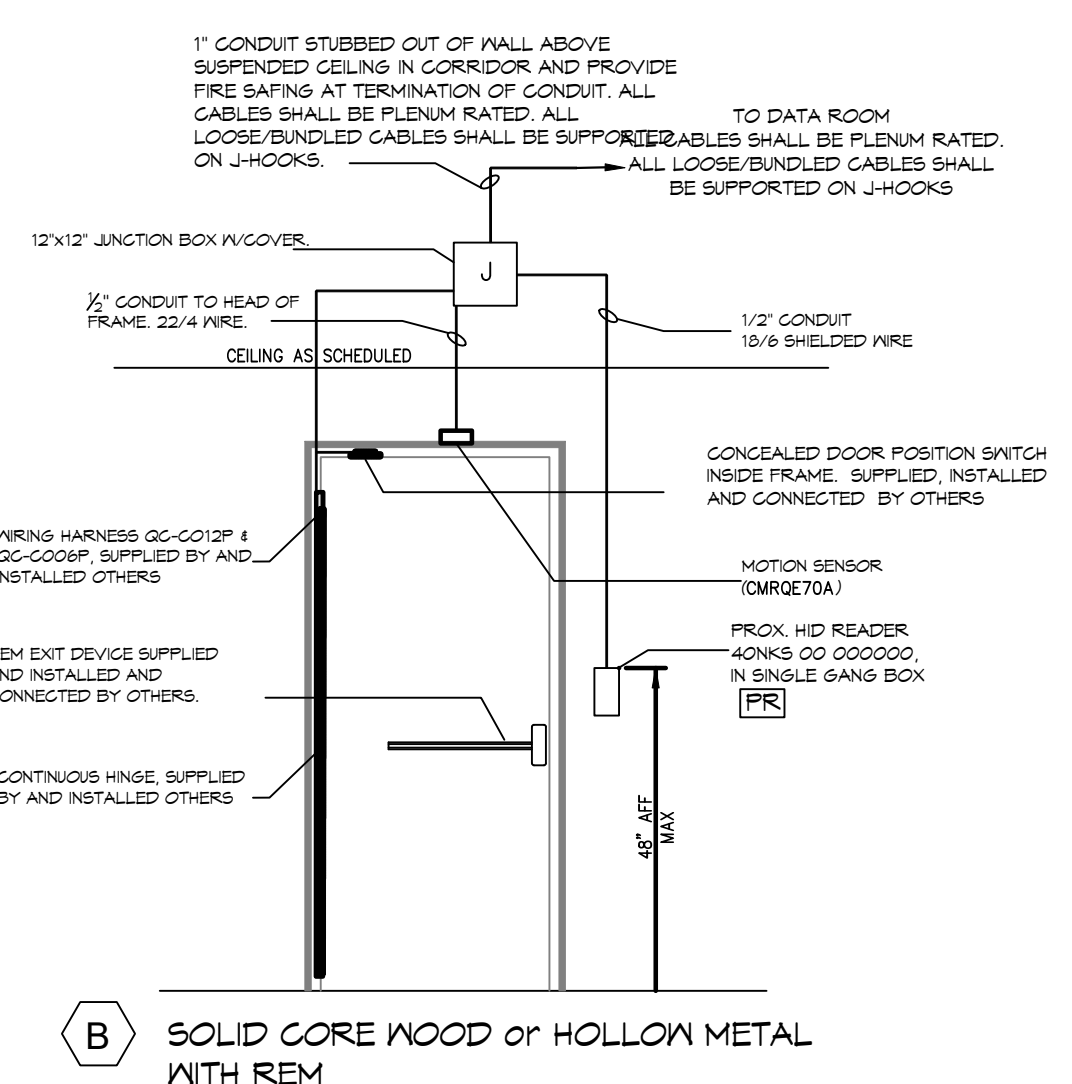

B SOLID CORE WOOD or HOLLOW METAL WITH REM

DOOR(s)				
136a	136b	138b	153	156

- SUPPLIED AND INSTALLED BY OTHERS:
- CONTINUOUS HINGE HG-305 X KMP55 X EL-12
 - RIM EXIT DEVICE EDB200A X TH95TET CT6D
 - DOOR POSITION SWITCH DPS-M-BK
 - WIRING HARNESS QC-C012P
 - WIRING HARNESS QC-C006P
 - POWER SUPPLY AGD1

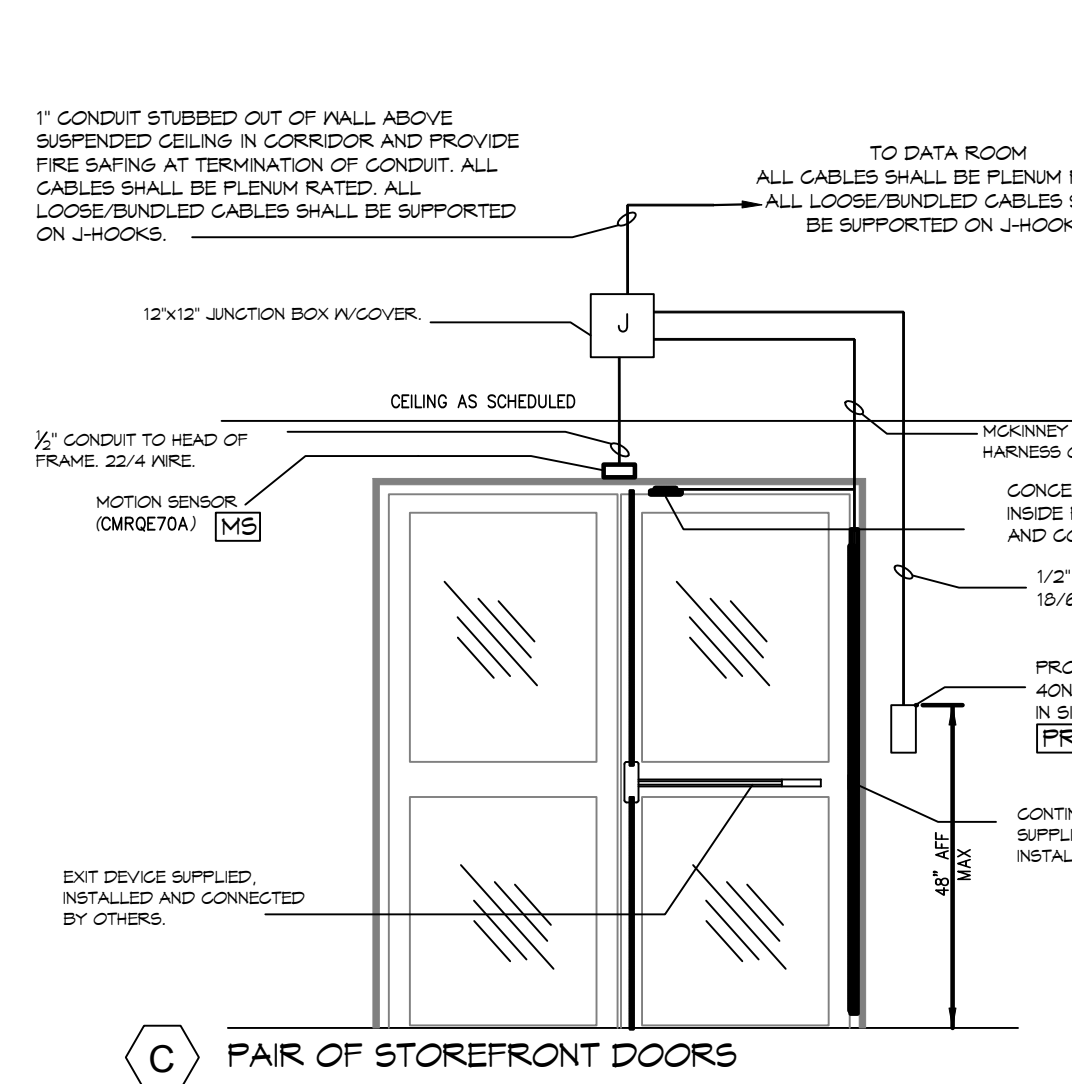

C PAIR OF STOREFRONT DOORS

DOOR(s)		
101	124a	138a

- 2 SUPPLIED AND INSTALLED BY OTHERS:
- EXIT DEVICE EDB200A X TH95TET CT6D
 - DOOR POSITION SWITCH BK DPS-M-BK
 - WIRING HARNESS QC-C012P
 - WIRING HARNESS QC-C006P
 - POWER SUPPLY AGD1

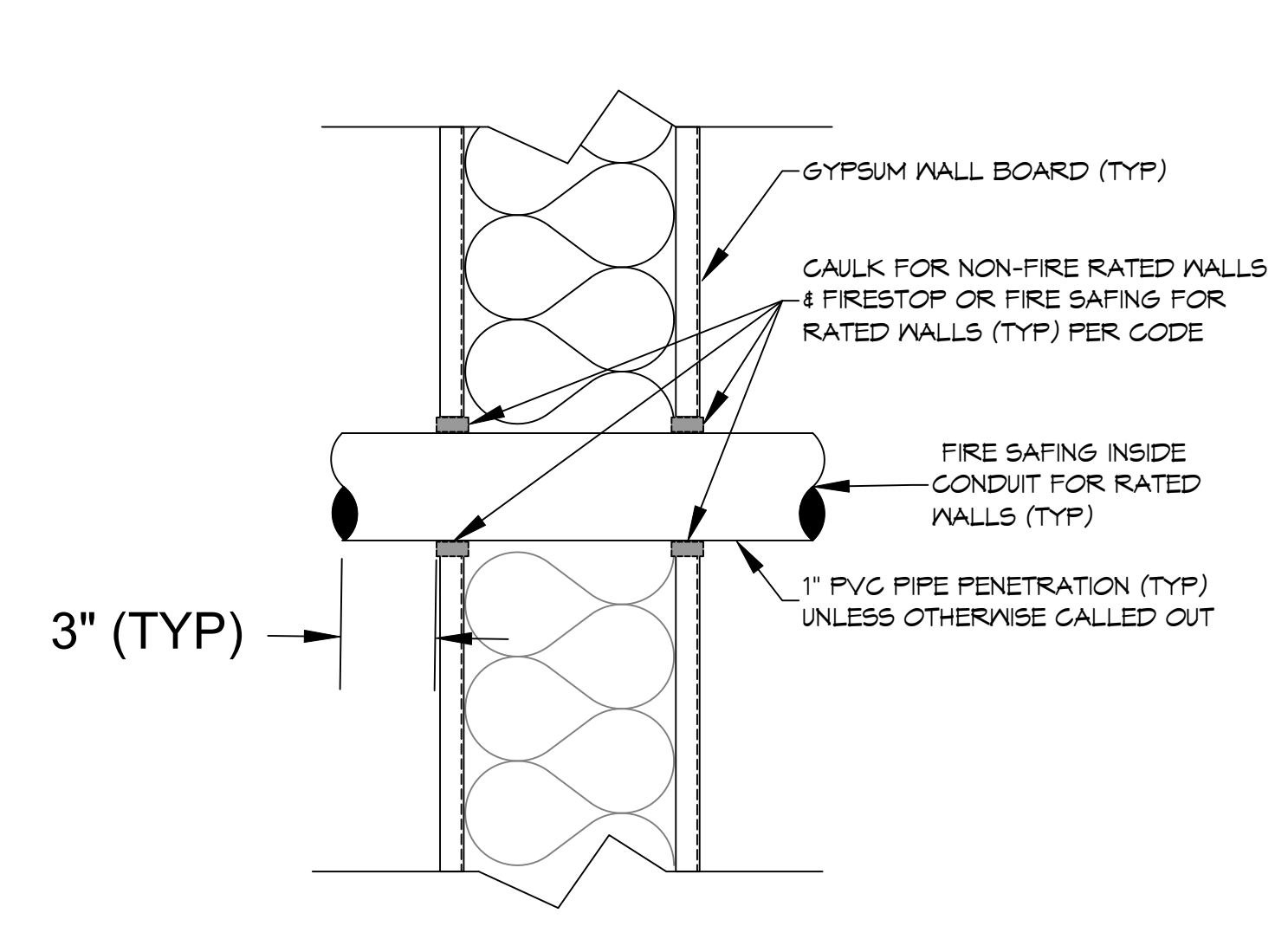

TYPICAL PIPE SLEEVE PENETRATION DETAIL

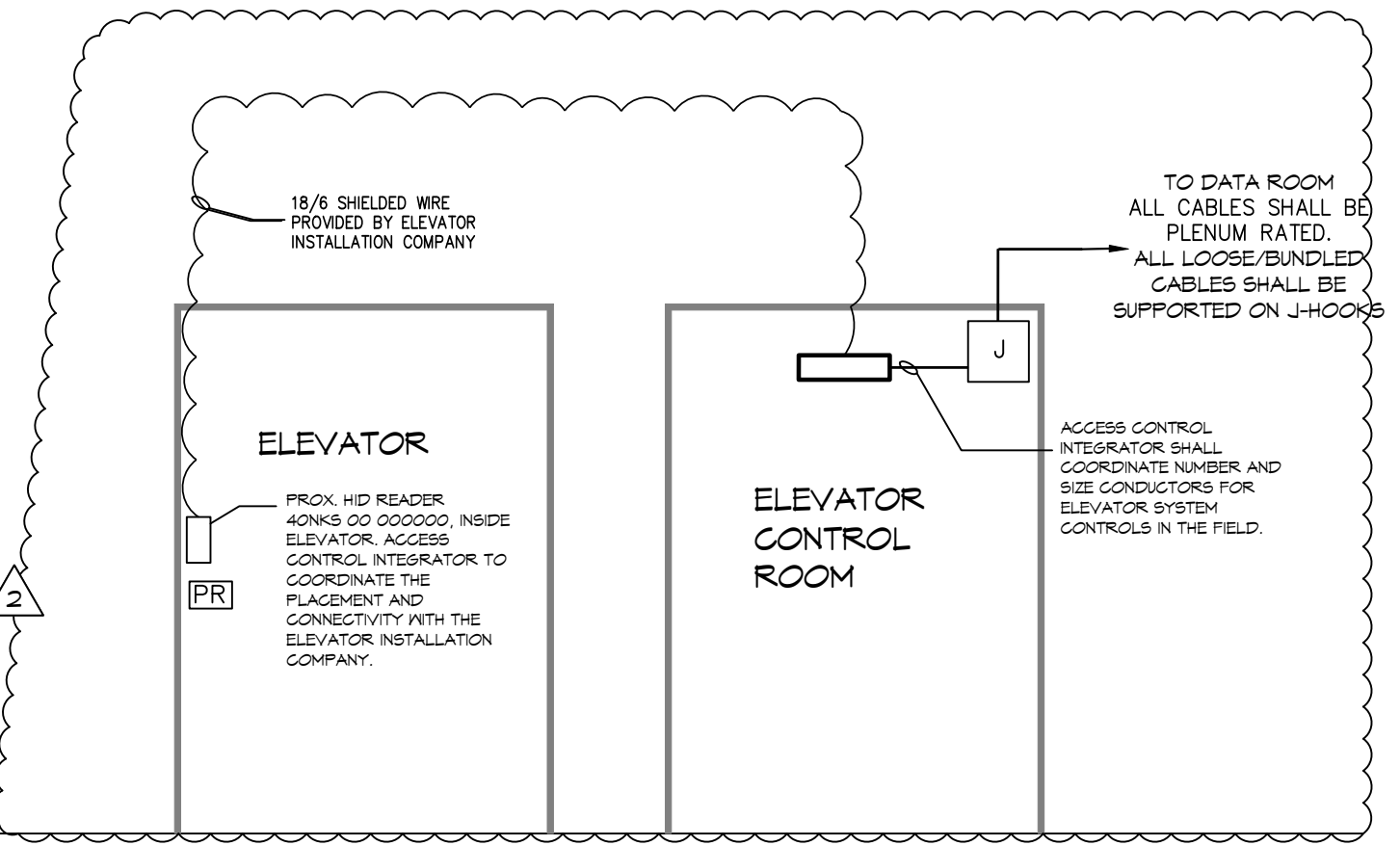

D ELEVATORS

DOOR(s)
ELEV. 106a
ELEV. 106b

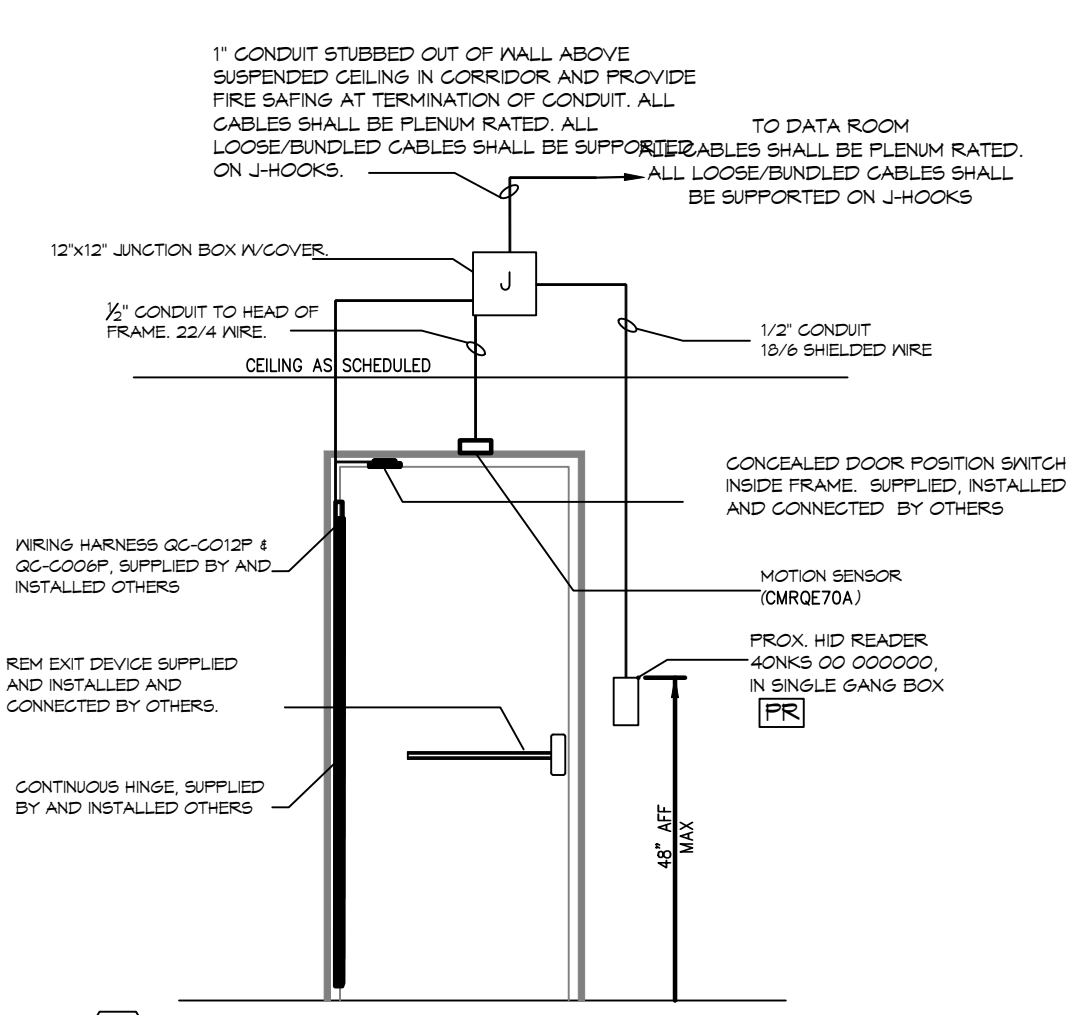

E SOLID CORE WOOD or HOLLOW METAL WITH REM

DOOR(s)				
136a	136b	138b	153	156

- SUPPLIED AND INSTALLED BY OTHERS:
- CONTINUOUS HINGE HG-305 X 10" X EL-12
 - RIM EXIT DEVICE EDB200A X 1.990SET CT6D
 - DOOR POSITION SWITCH BK DPS-M-BK
 - WIRING HARNESS QC-C1500P
 - WIRING HARNESS QC-C012P
 - POWER SUPPLY AGD1

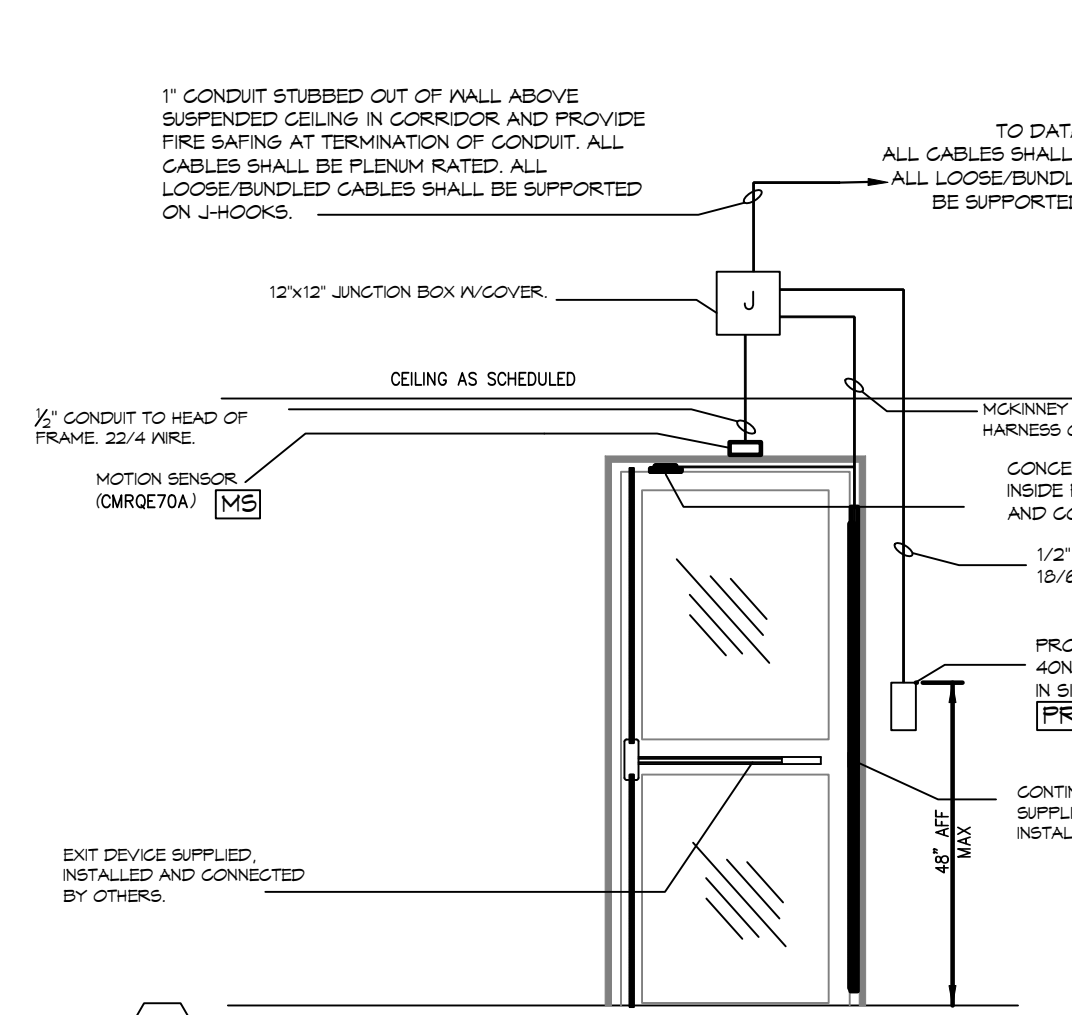

F PAIR OF STOREFRONT DOORS

DOOR(s)
100a

- SUPPLIED AND INSTALLED BY OTHERS:
- EXIT DEVICE EDB200A X TH95TET CT6D
 - DOOR POSITION SWITCH BK DPS-M-BK
 - WIRING HARNESS QC-C012P
 - WIRING HARNESS QC-C006P
 - POWER SUPPLY AGD1

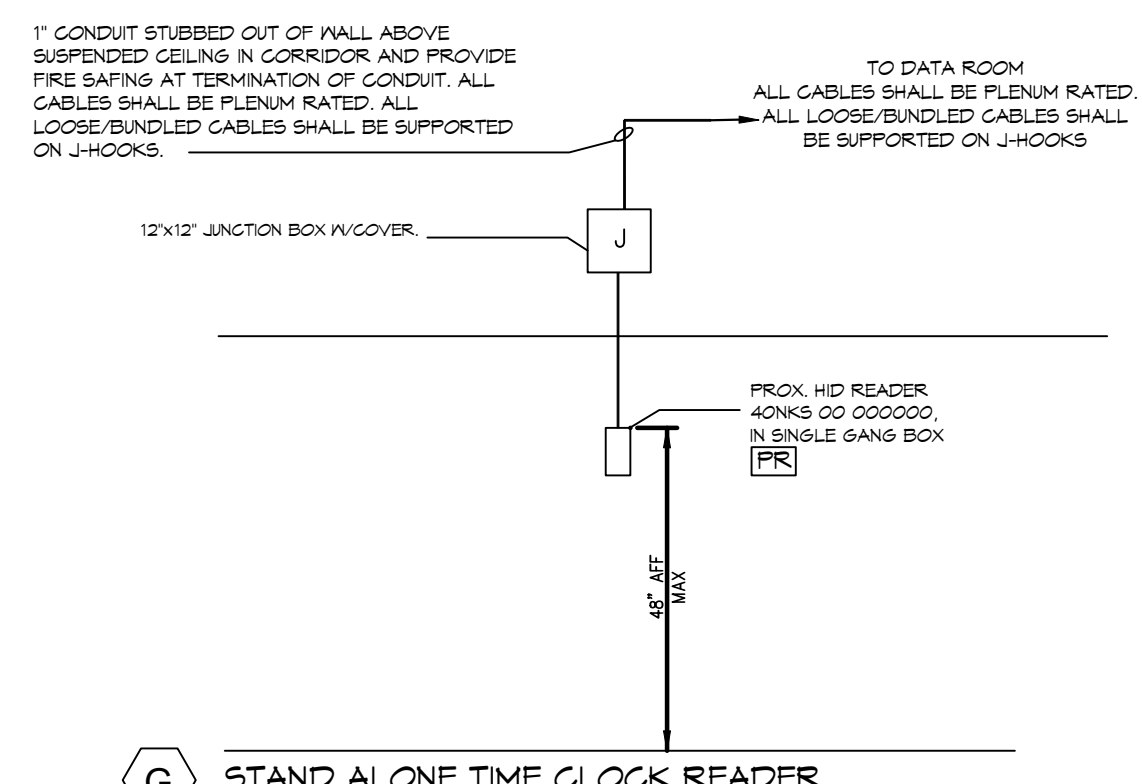

G STAND ALONE TIME CLOCK READER

DOOR(s)
124b

- SUPPLIED AND INSTALLED BY OTHERS:
- N/A

ACCESS CONTROL SYMBOL LEGEND

- PR** = PROX. HID READER
- MS** = MOTION SENSOR
- DP** = DOOR POSITION SWITCH - BY OTHERS.
- EH** = ELECTRIC HINGE - BY OTHERS.
- EL** = ELECTRIC RELEASE LEVER - BY OTHERS
- J** = 12"x12" JUNCTION BOX

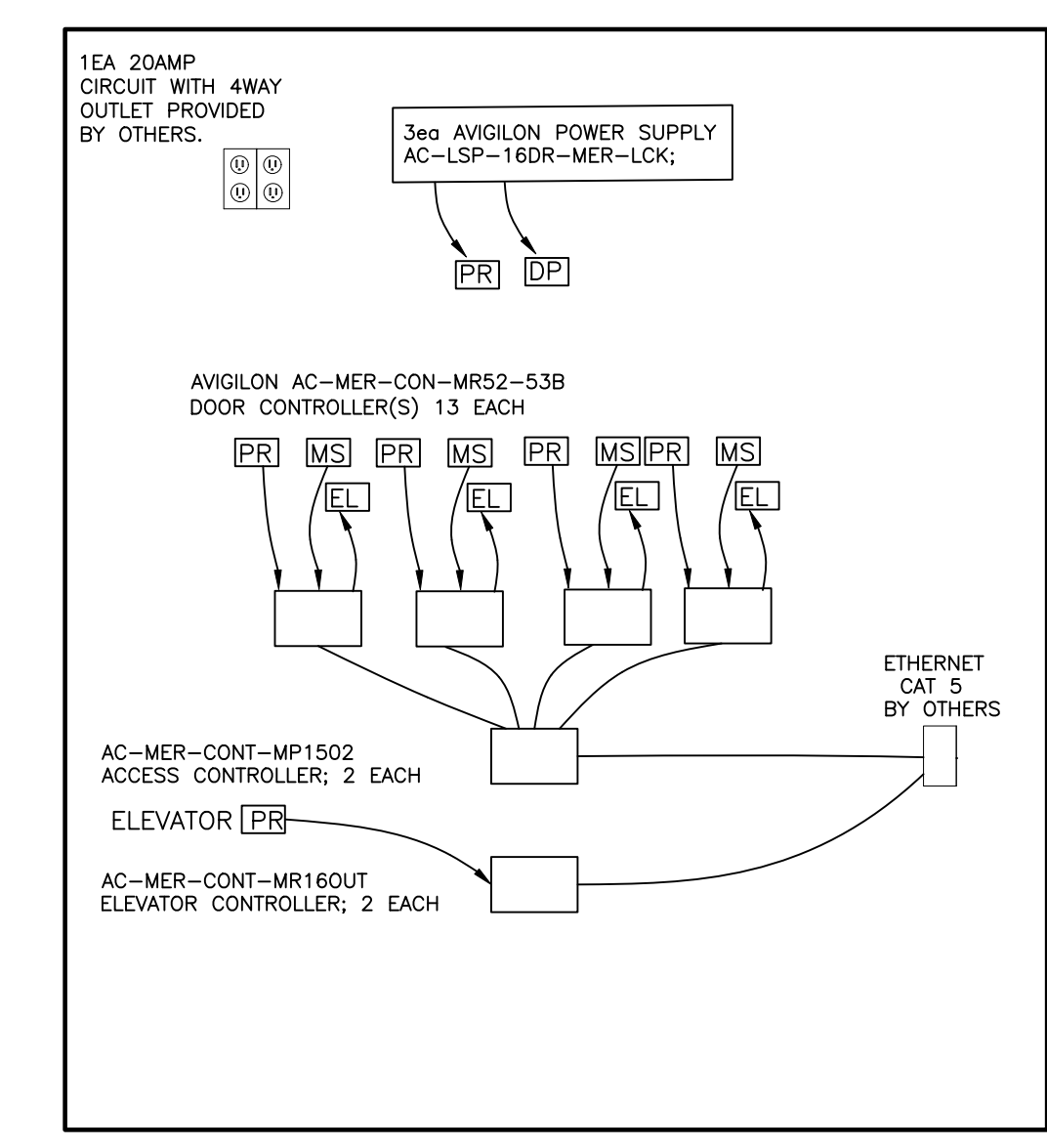

1st Floor Access System Diagram

REVISIONS	DATE
1 ADD DETAILS FOR DOORS 100a, 124b & 222	2/2/2026
2 REV ELEVATOR DETAIL; ADDED DOOR DETAIL	8/11/2026
DOOR(S) 101, 136a, 138, 150, 201, 211	

SEAL:

SECURITY ACCESS

NORTH OAKS PHYSICAL THERAPY

1870 PAUL VEGA RD DR.
 HANCOCK, LA 70420

JOB No: 2519 DATE: 10/10/2025
 DRAWN BY: C-CD CHECKED BY: BAK

SHEET TITLE:
DOOR DETAILS

DRAWING NUMBER:
SEC 0.1

SHEET No: 13 of #