

- ### GENERAL NOTES
- INSULATION AND INSULATION ASSEMBLIES SHALL MEET THE REQUIREMENTS OF IBC 2021 SECTION 711.
 - CONCEALED INSULATION SHALL HAVE A FLAME SPREAD OF 0-25 AND SMOKE DEVELOPED INDEX OF 0-450 EXCEPT THAT IN COMBUSTIBLE (WOOD FRAME) CONSTRUCTION.
 - FACING SHALL COMPLY WITH IBC 2021.
 - ALL MATERIALS SHALL BE NEW AND UL LISTED.
 - NO WORK SHALL BE CONCEALED UNTIL APPROVED BY LOCAL INSPECTORS.
 - CONSTRUCTION SHALL COMPLY WITH ALL PARISH, STATE, AND LOCAL CODES.
 - CONTRACTOR TO GUARANTEE WORK FOR ONE YEAR FROM DATE OF SUBSTANTIAL COMPLETION.
 - CONTRACTOR SHALL FURNISH WATER AND POWER FROM EXISTING SOURCES.
 - EXTERIOR CAULKING SHALL BE THICK CAULK.
 - PAINT SHALL BE SHERWIN WILLIAMS OR EQUIVALENT AND APPROPRIATE FOR THE SUBSTRATE TO WHICH IT IS APPLIED AS RECOMMENDED BY PAINT MANUFACTURER. ALL WORK TO RECEIVE THREE COATS (ONE PRIMER COAT, TWO FINISH COATS) UNLESS OTHERWISE RECOMMENDED BY PAINT MANUFACTURER. COLORS TO BE SELECTED BY OWNER.
 - PROVIDE CLEANUP ON A REGULAR BASIS. NO TRASH SHALL BE STORED INSIDE BUILDING PREMISES.
 - ALL BATT INSULATION SHALL HAVE A CLASS 'A' (0-25) FLAME SPREAD IN COMPLIANCE WITH IBC 2012.
 - USE 2x6 STUDS, OR TWO 2x4 STAGGERED STUDS WITH 2x6 SILL PLATE AT ALL WALLS WHERE 4" PIPE IS INDICATED. SEE PLUMBING RISER DIAGRAM FOR PIPE SIZE.
 - PROVIDE GALVANIZED METAL PAN WITH DRAIN AT ALL WATER HEATERS.
 - ALL FLOORING SHALL MEET OR EXCEED ADA GUIDELINES REQUIREMENTS FOR SLIP RESISTANCE.
 - INTERIOR LOCKS ON DOORS IN MEANS OF EGRESS SHALL NOT REQUIRE THE USE OF A KEY, SPECIAL KNOWLEDGE, OR SPECIAL DEVICE TO OPEN IN THE DIRECTION OF EGRESS. ALL DOORS SHALL HAVE LEVER TYPE HANDLES.
 - INTERIOR WALLS AND CEILINGS SHALL HAVE A FLAME SPREAD OF 0-200 AND A SMOKE DEVELOPMENT RATING OF 0-450.
 - ALL WORK SHALL COMPLY WITH THE LATEST EDITION OF ALL LOCAL, STATE, AND NATIONAL CODES COVERING THE TYPE OF WORK BEING PERFORMED.
 - PROVIDE PORTABLE FIRE EXTINGUISHERS IN ACCORDANCE WITH NFPA 101. SEE APPENDIX 'E' OF NFPA 101 FOR DISTRIBUTION OF EXTINGUISHERS.
 - ALL FIRE WALLS SHALL EXTEND TIGHT TO ROOF DECK AND BE SEALED WITH AN APPROVED FIRE CAULK.
 - ALL ELECTRICAL, MECHANICAL, AND PLUMBING MATERIALS PENETRATING FIRE WALLS SHALL BE FIRE CAULKED. (PENETRATIONS THROUGH RATED CONSTRUCTION SHALL BE SEALED WITH A MATERIAL CAPABLE OF PREVENTING THE PASSAGE OF FLAMES AND HOT GASES WHEN TESTED IN ACCORDANCE WITH ASTM-E814.)
 - SERVICE COUNTERS SHALL HAVE AN ACCESSIBLE WRITING SURFACE IN COMPLIANCE WITH ADAAG ACCESSIBILITY GUIDELINES 2010, SECTION 402.3.

DOOR SCHEDULE

MK	WD	HT	THK	MAT	FRM	FR	NOTES
D01	(2) 5'-0"	8'-0"	1-3/4"	GLASS	METAL	NR	EXTERIOR DOUBLE DOOR WITH CLOSER
D02	3'-0"	7'-0"	1-3/4"	METAL	METAL	NR	EXTERIOR DOOR WITH CLOSER
D03	(2) 3'-0"	8'-0"	1-3/4"	WOOD	METAL	NR	INTERIOR DOUBLE DOOR WITH CLOSER
D04	3'-0"	7'-0"	1-3/4"	WOOD	METAL	45 MN	INTERIOR DOOR WITH CLOSER
D05	3'-0"	7'-0"	1-3/4"	WOOD	METAL	NR	INTERIOR DOOR WITH CLOSER
D06	3'-0"	7'-0"	1-3/4"	WOOD	METAL	45 MN	INTERIOR DOOR WITH CLOSER
D07	10'-0"	10'-0"	-	METAL	METAL	-	ROLL UP GARAGE DOOR
D08	(2) 3'-0"	7'-0"	1-3/4"	WOOD	METAL	45	INTERIOR DOUBLE DOOR WITH WINDOW & CLOSER

WINDOW SCHEDULE

MK	WD	HT	FRAME	TYPE	NOTES
W01	6'-0"	5'-0"	ALUM	FIXED	TEMPERED
W02	3'-0"	5'-0"	ALUM	FIXED	TEMPERED

NOTE: DOORS IN A REQUIRED MEANS OF EGRESS SERVING ANY ASSEMBLY AREA HAVING AN OCCUPANT LOAD OF 50 OR MORE PERSONS SHALL NOT BE EQUIPPED WITH A LATCH OR LOCK OTHER THAN PANIC HARDWARE OR FIRE EXIT HARDWARE.

NOTE: ALL EXTERIOR DOORS ASSEMBLES TO BE RATED FOR 140 MPH WINDS AND SHALL BE MISSILE IMPACT RESISTANT.

NOTE: CONTRACTOR SHALL HIRE A FULLY LICENSED SPRINKLER COMPANY AND FIRE ALARM COMPANY TO DESIGN AND INSTALL THE EQUIPMENT.

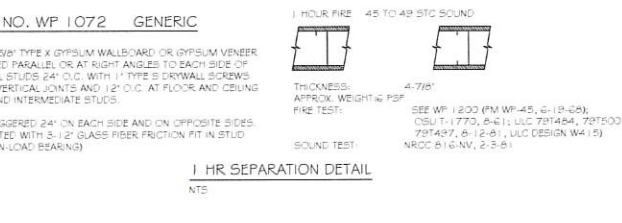

DAMMON ENGINEERING, INC.
LOUISIANA & MISSISSIPPI
Chief Engineer: Barry Wirtch, PE
www.dammonengineering.com
info@dammonengineering.com
564 Oak Springs Trail
Slidell, LA 70458
PH: 985.449.9332 F: 985.441.9350

REVISIONS

#	DESCRIPTION	DATE

STATE OF LOUISIANA
BRIAN A. MESTON
LICENSE No. 30197
PROFESSIONAL ENGINEER

NEW AUDITORIUM
PIPER JOHN PAUL
PIPER JOHN SCHOOL

11 FLOOR PLAN
DRAWING NUMBER: **A101**
SHEET No. 10 of 20