

REVISIONS	BY

**NEW OFFICE/ STORAGE**  
 38299 MANZELLA DRIVE  
 SLIDELL, LOUISIANA 70461

**JOSEPH F. SCHNEIDER JR., AIA**  
 ARCHITECT  
 L.A #4206 MS #3020 AL #8724 FL #AR95908 TX #24294  
 105 EVANGELINE DRIVE, SLIDELL, LOUISIANA 70460  
 (985) 290-6648 jfsarchitect@charter.net

DRAWN  
H. SCHNEIDER  
 CHECKED  
J. SCHNEIDER  
 DATE  
11/10/2024  
 SCALE  
AS NOTED  
 JOB NO.  
 SHEET  
**A-**  
 OF SHEETS

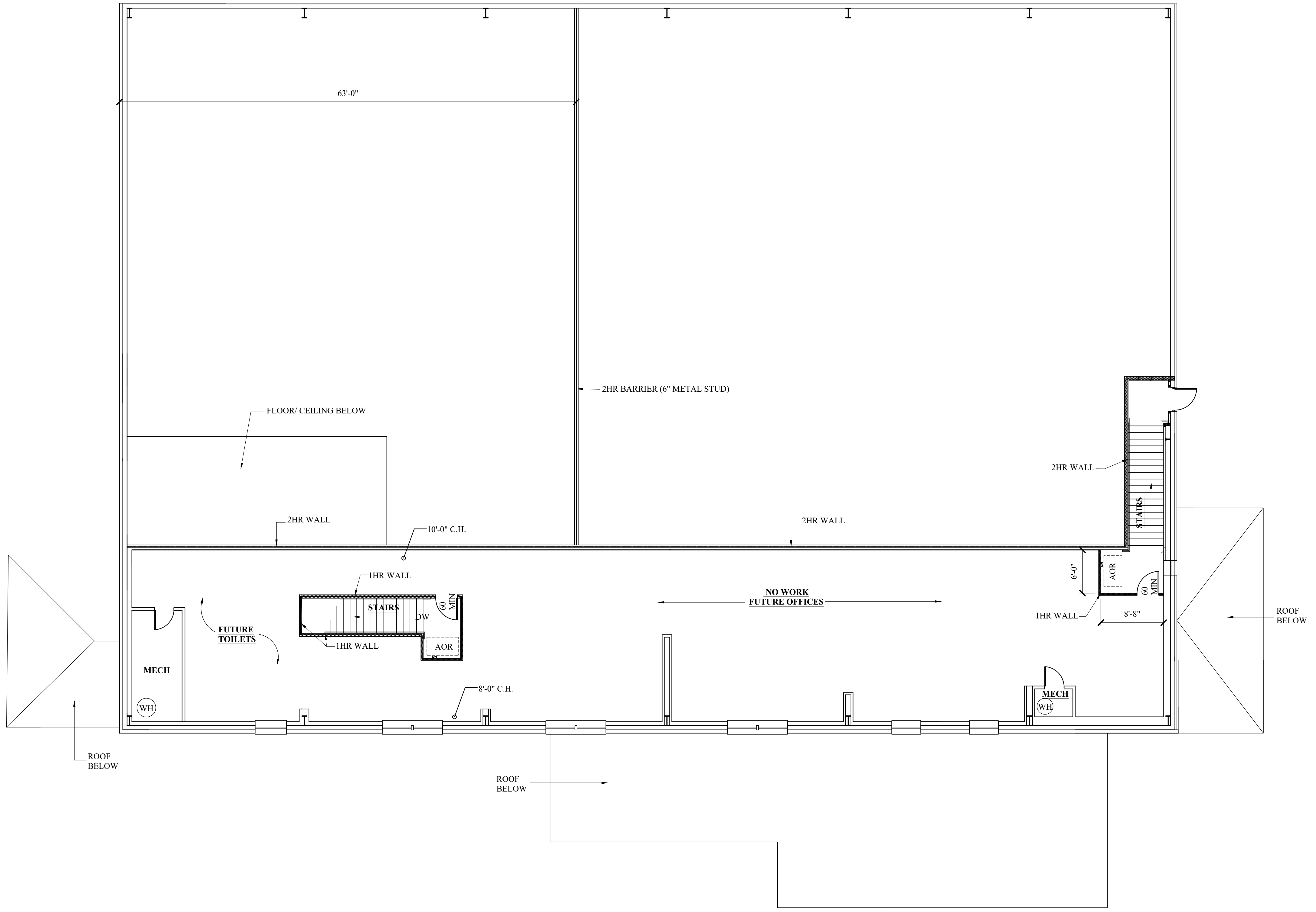

**SECOND FLOOR PLAN- NEW WORK**

SCALE: 1/8" = 1'-0"

**A-**

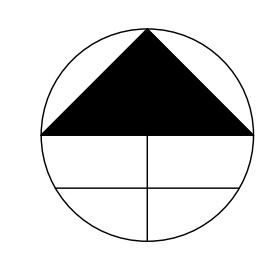

THESE DESIGN AND CONSTRUCTION DOCUMENTS AT THE SOLE PROPERTY OF JOSEPH F. SCHNEIDER, JR. AIA, ARCHITECT. NO USE OR REPRODUCTION OF THESE DOCUMENTS OR PARTIAL USE OR PARTIAL REPRODUCTION IS ALLOWED. NO USE OF THESE DRAWINGS WITHOUT THE WRITTEN EXPRESSED PERMISSION OF JOSEPH F. SCHNEIDER, JR. ARCHITECT IS ALLOWED.