

LOT D-2A
 CARROLLWOOD VILLAGE
 JEFFERSON PARISH, LA.

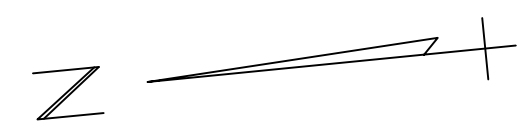

SINGLE STORY RETAIL BUILDING
 5,227 SF
 PARKING REQUIRE: 1/200 SF
 = 27 SPACES
 PARKING PROVIDED: 27 SPACES
 1 HANDICAP SPACE
 28 TOTAL SPACES

**MUCD – MINOR CHANGE TO SITE PLAN
 PLANNING DEPARTMENT CERTIFICATION**

DOCKET NO. _____

ORIGINALLY APPROVED UNDER DOCKET NO. _____

PREVIOUSLY AMENDED UNDER DOCKET NO(S). _____

PLANNING DIRECTOR _____ DATE _____

OWNER(S) EXPRESSWAY ENTERPRISES LLC

D-2B

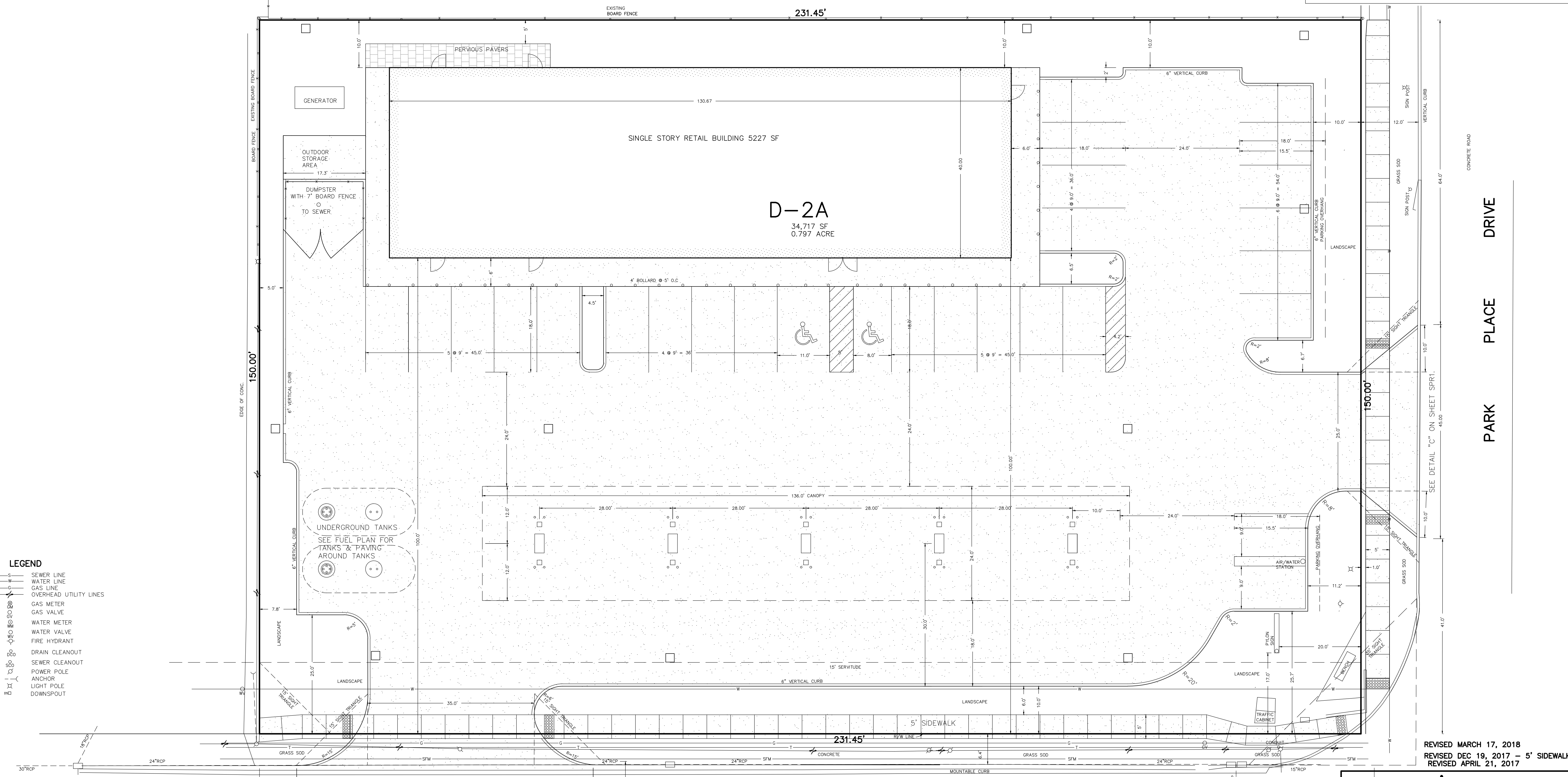

- LEGEND**
- S — SEWER LINE
 - W — WATER LINE
 - G — GAS LINE
 - U — OVERHEAD UTILITY LINES
 - GAS METER
 - GAS VALVE
 - WATER METER
 - WATER VALVE
 - FIRE HYDRANT
 - DRAIN CLEANOUT
 - SEWER CLEANOUT
 - POWER POLE
 - ANCHOR
 - LIGHT POLE
 - DOWNSPOUT

REMOVE AND REPLACE EXISTING CONCRETE CURB. SEE DETAIL "A" ON SHEET C3.

CONTRACTOR TO COORDINATE WITH ENTergy AND AT&T FOR RELOCATION OF UTILITY POLE

REVISED MARCH 17, 2018
 REVISED DEC 19, 2017 – 5' SIDEWALK
 REVISED APRIL 21, 2017

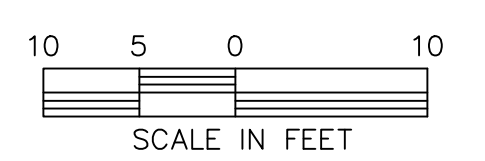

BEHRMAN HIGHWAY

BROTHER'S FOODMART
 799 BEHRMAN HIGHWAY
 TERRYTOWN, LA
SITE PLAN

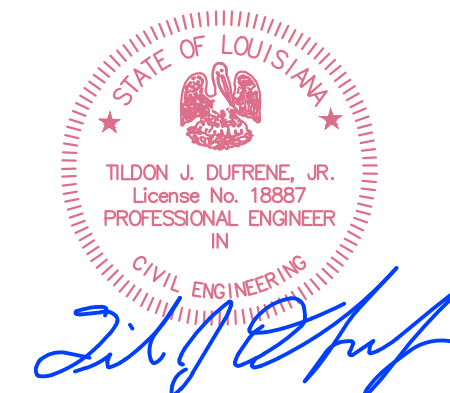

**DUFRENE SURVEYING
 & ENGINEERING INC.**
 1624 MANHATTAN BOULEVARD, HARVEY, LA 70058
 504-368-6360 PH
 504-368-6394 FAX
 du@dufrenesurveying.com