

**SIMPSON****Strong-Tie**

# TOP FLANGE HANGERS HHB/GB/HGB

**BEAM AND  
PURLIN HANGERS**

*See table on page 106. See Hanger Options on page 164 for hanger modifications, which may result in reduced loads.*

Precision forming with manufacturing quality control provides dimensional accuracy and helps ensure proper bearing area and connection.

**MATERIAL:** See table on page 106.

**FINISH:** HHB, GB, HGB, all saddle hangers and all welded sloped and special hangers—Simpson gray paint.

HHB may be ordered hot-dip galvanized; specify HDG.

**INSTALLATION:** • Use specified fasteners. See General Notes.

- HHB, GB and HGB may be used for weld-on applications. The minimum required weld to the top flanges is  $\frac{1}{8}$ " x 2" fillet weld to each side of each top flange tab for 14 and 12 gauge and  $\frac{3}{16}$ " x 2" fillet weld to each side of each top flange tab for 7 gauge. Distribute the weld equally on both top flanges. Welding cancels the top and face nailing requirements. Consult the code for special considerations when welding galvanized steel. The area should be well-ventilated. See page 11 for weld information. Weld on applications produce the maximum allowable load listed. Uplift loads do not apply to welded applications.
- Ledgers must be evaluated for each application separately. Check TF dimension, nail length and nail location on ledger.

**OPTIONS:** • HHB—other widths are available; specify W dimension (the minimum W dimension is  $2\frac{1}{2}$ ").

- Saddle hangers are made to order; add "D" to model (e.g. HHBD3); specify S (for saddle) dimension. They may be used for most conditions except at end wall locations, and are preferred for nailer applications.
- The finish on special B hangers will depend on the manufacturing process used. Check with your Simpson representative for details. Hot-dipped galvanized available: specify HDG.
- B dimensions may be increased on some models.
- See Hanger Options, page 164.

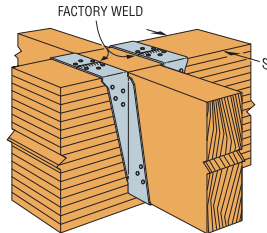

**Typical BD  
Saddle  
Installation**

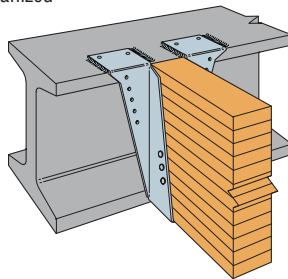

**HHB, GB and  
HGB are  
acceptable  
for weld-on  
applications.  
See Instructions  
to the Installer,  
page 11, note f.**