

STAIR OPENING HEAD DETAIL

This is the area that resist the forces of wind

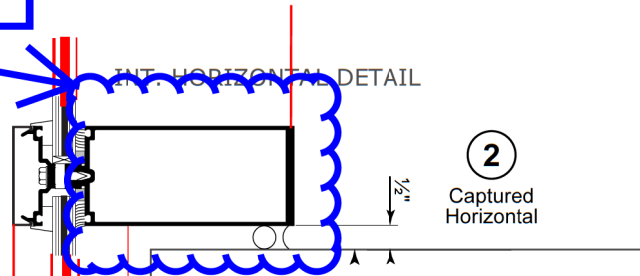

*NOTE
NO APPROVED MANUFACTURE OFFERS 5 1/2" CURTAINWALL SYSTEM. C.W. HORIZONTALS WILL NEED TO BE ON TOP OF THE FLOOR @ STAIR REFERENCE DETAILS.

