

D
M101B/M101B 1/4" = 1'-0"

- ABBREVIATIONS**
- CB = CATCH BASIN
 - CMP = CORRUGATED METAL PIPE
 - COR = CENTER OF ROAD
 - EOR = EDGE OF ROAD
 - FM = FORCE MAIN
 - INV = INVERT
 - MH = NEW SANITARY SEWER MANHOLE
 - RCP = ROUND CORRUGATED PIPE
 - RCPA = ROUND CORRUGATED PIPE-ARCH
 - ROW = RIGHT OF WAY
 - SN = SWALE

- LEGEND**
- FM — FM — 6" FORCE MAIN
 - SS — GRAVITY FED SEWER
 - FENCE
 - ⊙ POWER POLE
 - ⊙ SANITARY SEWER MANHOLE
 - X EXISTING ELEVATION
 - STA=0+00' STATION #
 - EL=101.1' ELEVATION

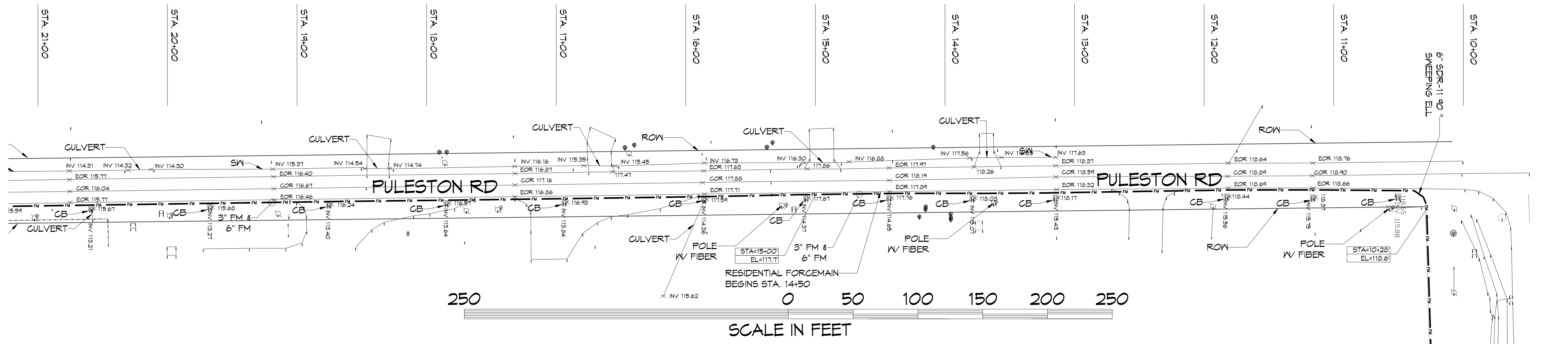

3
M101B/M101 1" = 40'

PRE-TREATED LEACHATE AND SEWER FORCE MAINS PARTIAL SITE PLAN

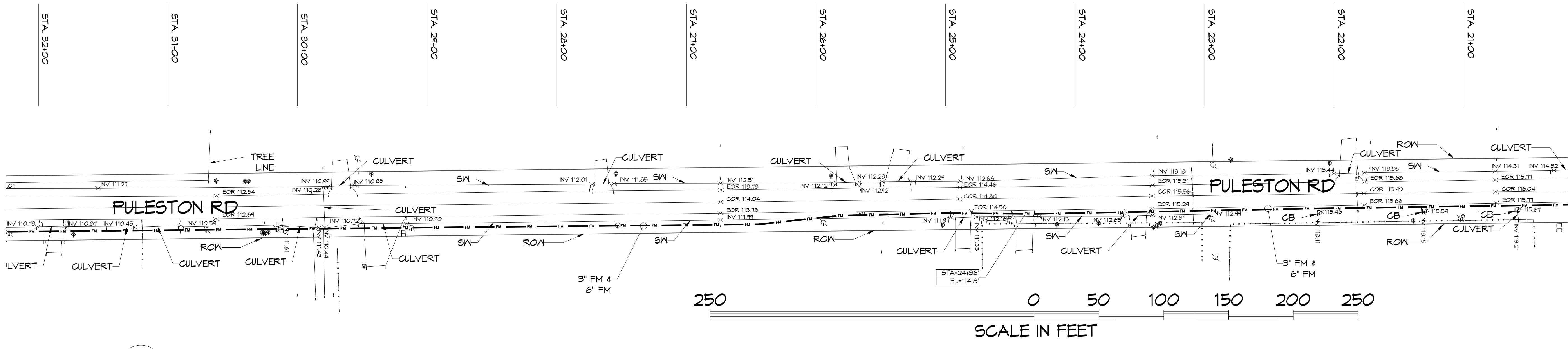

4
M101B/M101 1" = 40'

PRE-TREATED LEACHATE AND SEWER FORCE MAINS PARTIAL SITE PLAN

DAMMON
ENGINEERING, INC.
LOUISIANA & MISSISSIPPI

Chief Engineer: Brian Mastich, PE
554 Old Spanish Trail
Slidell, LA 70458
www.dammonengineering.com
info@dammonengineering.com
PH: 985.649.5832

REVISIONS	DATE

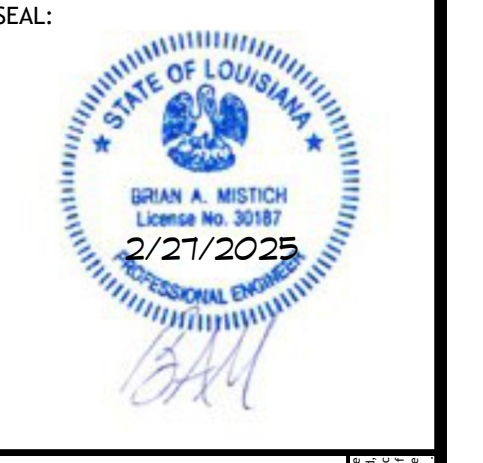

NEW FORCEMAIN
TANGIPAHOA PARISH LANDFILL

AVITE CITY, LA
JOB No: 2440 DATE: 2-27-2025
DRAWN BY: DPD CHECKED BY: BML

SHEET TITLE:
FORCE MAIN HWY 16

DRAWING NUMBER:
M101B

SHEET No: 3 of 7