

**Product Information**

Fixture:	
Weight, side panel	74 lbs.
Glass, tempered safety	clear
Included Components:	
Frames and hardware	K-9558
Side panel	K-9551

**Installation Notes**

Refer to installation instructions included with fixture before beginning installation.

<b>Roughing-In Notes</b>
Tempered glass conforms to ANSI Z97.1.
<b>Leave studs exposed.</b> Shower enclosure wall jambs must be installed directly to studs.

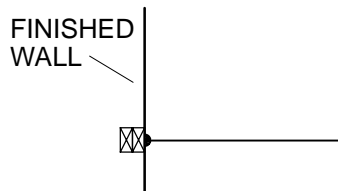

**TOP VIEW**

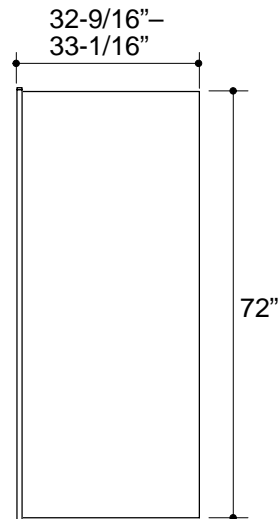

**FRONT VIEW**