

IRC 2021
WFCM
ECC 2021
NEC 2020
40 MPH WIND SPEED
EXPOSURE: C
DESIGN MEETS THE PRESCRIPTIVE
ENERGY CODE REQUIREMENTS
CLIMATE ZONE: 2
MANUAL J CALCULATIONS BY OTHERS

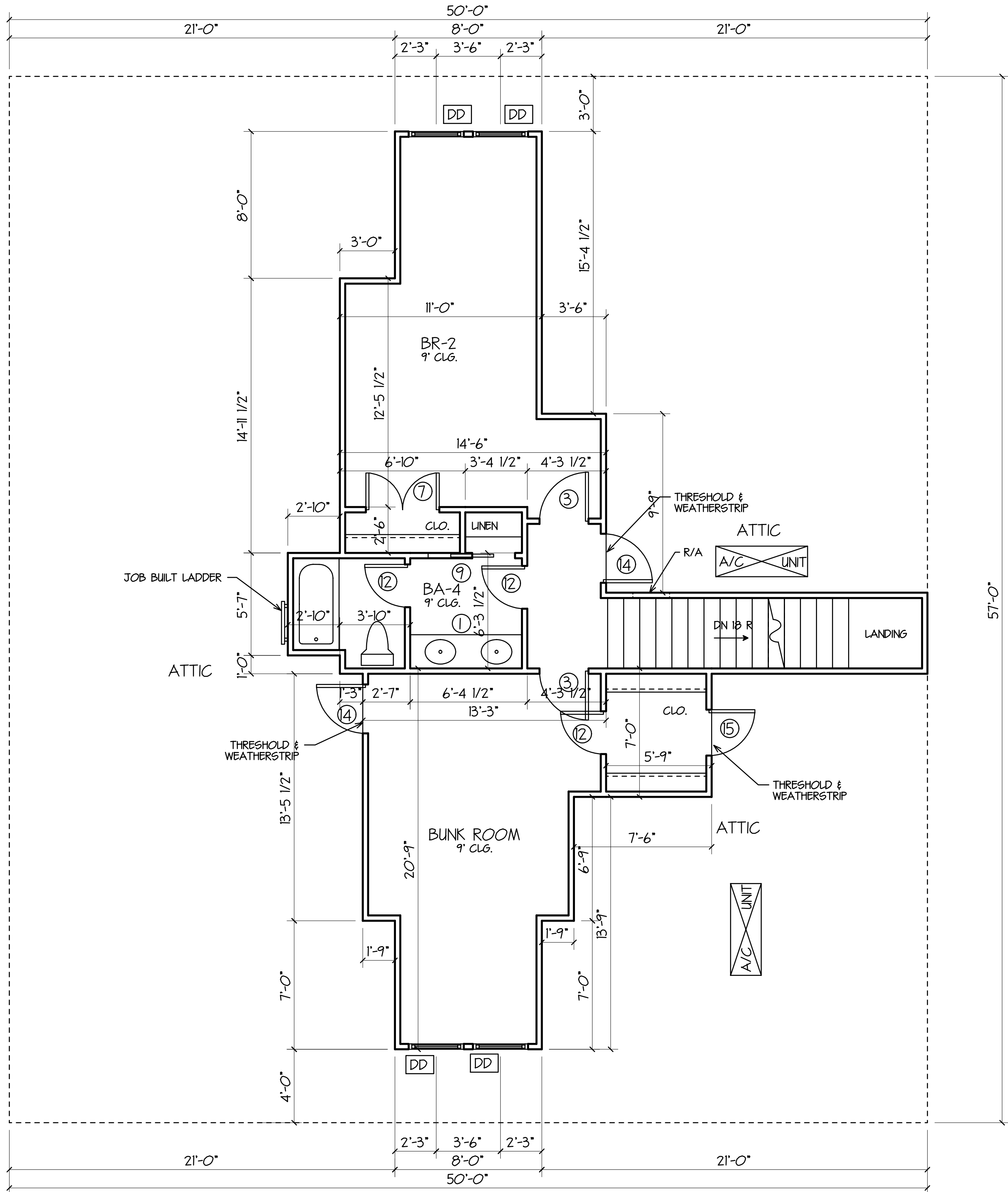

2ND LEVEL FLOOR PLAN
SCALE 1/4"=1'-0"

** SEE FRAMING PLANS BY ENGINEER FOR LUMBER SIZES AND DIRECTION **



CABINET ELEVATIONS
SCALE 1/4"=1'-0"

RESIDENCE IS LOCATED IN A
WINDBORNE DEBRIS PROTECTION REGION

THERMAL COMPONENT CRITERIA (U-FACTOR AND R-VALUE) (MAX. SHGC = 0.25 FOR GLAZING)			
MAXIMUM GLAZING PENETRATION U-FACTOR 0.40	MIN INSULATION R-VALUE		
	CLGS.	WALLS	FLOORS
	R-38	R-15	R-15
R-8 DUCT INSULATION ATTIC ACCESS INSULATED INSULATE HOT & COLD WATERLINE IN UNCONDITIONED ATTIC AND CRAWSPACES. FURR OUT 2x RAFTERS AS REQUIRED FOR BATT INSULATION AT CATHEDRAL CEILINGS OR USE SPRATED FOAM INSULATION IF ACCEPTABLE.			

NOTES

- CONTRACTOR SHALL SELECT WINDOW & DOOR PRODUCTS MEETING THE ENERGY EFFICIENCY REQUIREMENTS OF THE BUILDING CODE (BASED ON IRC 2021 CLIMATE ZONE 2 - U-FACTOR-0.40 MAX, SHGC-0.25 MAX).
 - CONTRACTOR SHALL SELECT WINDOW & DOOR PRODUCTS MEETING WIND DESIGN PRESSURE REQUIREMENTS OF R603 (GARAGE DOOR SHALL BE RATED TO MEET WIND LIMITATIONS AS PER R 301.2).
 - PER R309.1 DOORS BETWEEN GARAGE & RESIDENCE SHALL BE 20-MINUTE FIRE RATED DOORS (INCLUDING ATTIC STAIRS). ALSO PER R302.5.1 SELF CLOSING.
 - SAFETY GLAZING (TEMPERED GLASS) IS REQUIRED AT LOCATIONS IDENTIFIED IN R308.4 (EX. GLAZING WITHIN 24" OF DOORS & OVER TUBS).
 - PER R307.2 GARAGE SHALL BE SEPARATED FROM RESIDENCE BY NOT LESS THAN 1/2" GYPSUM BOARD APPLIED TO THE GARAGE SIDE OF WALLS AND CEILING. GARAGES BENEATH HABITABLE ROOMS ABOVE SHALL BE SEPARATE BY NOT LESS THAN 5/8" TYPE X GYPSUM BOARD OR EQUIVALENT.
 - RAIL INDICATES GUARD RAIL AT PORCHES & GUARDRAIL WITH HANDRAIL AT STAIRS.
 - OPENING IN THE RESIDENCE SHALL BE PROTECTED BY 20 MIN RATED DOORS.
 - IF REQUIRED ATTIC ACCESS (IRC-R807) IS LOCATED IN THE GARAGE, THE REQUIRED 1/2" GYPSUM WILL BE APPLIED TO CEILING AND DROP DOWN STAIR MUST BE 20 MIN RATED.
- PROTECTION OF APPLIANCE IN GARAGE IS REQUIRED.

WINDOW SCHEDULE

** ALL IMPACT GLASS WINDOWS **		
MARK	DESCRIPTION	HDR
AA	3060 VINYL SH.	8'-0"
BB	FR. 3060 VINYL SH.	8'-0"
CC	3040 VINYL SH. TEMPERED	8'-0"
DD	3050 VINYL SH.	8'-0"

DOOR SCHEDULE

MARK	WIDTH	HEIGHT	THICK.	DESCRIPTION
1	6'-0"	8'-0"	1 3/4"	FR. 3080 1 LT. FRENCH EXT.
2	3'-0"	6'-8"	1 3/8"	RAISED PANEL INTERIOR
3	2'-8"	6'-8"	1 3/8"	RAISED PANEL INTERIOR
4	2'-4"	8'-0"	1 3/8"	RAISED PANEL INTERIOR
5	2'-0"	6'-8"	1 3/8"	RAISED PANEL INTERIOR
6	1'-6"	6'-8"	1 3/8"	RAISED PANEL INTERIOR
7	4'-0"	6'-8"	1 3/8"	FR. 2068 RAISED PANEL INT.
8	3'-0"	6'-8"	1 3/8"	RAISED PANEL POCKET
9	2'-4"	6'-8"	1 3/8"	RAISED PANEL POCKET
10	3'-0"	6'-8"	1 3/4"	RAISED PANEL EXTERIOR SELF CLOSING & SELF LATCHING
11	3'-0"	6'-8"	1 3/4"	RAISED PANEL EXTERIOR
12	2'-4"	6'-8"	1 3/8"	RAISED PANEL INTERIOR
13	3'-0"	6'-8"	1 3/4"	FR. 1668 RAISED PANEL INT.
14	2'-8"	6'-8"	1 3/4"	RAISED PANEL EXTERIOR
15	2'-6"	6'-8"	1 3/4"	RAISED PANEL EXTERIOR
16	3'-0"	8'-0"	1 3/4"	SCREENED DOOR EXTERIOR
17	9'-0"	8'-0"	~	OH GARAGE 140 MPH RATED
18	3'-0"	6'-8"	1 3/4"	1 LT. / 2 PANEL EXTERIOR

2ND LEVEL FLOOR PLAN

PLANS FOR:
DOUG & TINA FARGE
LOT 5, POINT CARR S/D.
ST. TAMMANY PARISH, LA

DesignTech

Residential Planners, Inc.

St. Tammany Parish, LA.

COVINGTON 985-871-7211 SLIDELL 985-847-0600

CODE	LIVING	AREA U. B.	INDEX
B4	3029	3479	13172

DESIGNED BY DMH	FINISHED BY JTB	CHECKED BY DMH	
-----------------------	-----------------------	----------------------	--

Copyright, 2025, an unpublished work by DesignTech Residential Planners, Inc.
ALL RIGHTS RESERVED.

EMAIL: houseplans@designtechusa.com

Although every effort has been made in preparing these plans, the contractor must check all details for accuracy or errors and be responsible for same. Purchaser assumes the risk of any errors, omissions or mistakes during construction due to the fact that "DesignTech" does not perform field supervision nor select building materials sub-contractors and/or products/equipment. All notes, specifications and other information on the plans are included as instructed by and/or with the approval of Purchaser and without warranty of any kind whatsoever. PLANS HAVE BEEN PREPARED FOR USE BY KNOWLEDGEABLE AND EXPERIENCED, LICENSED CONTRACTORS.
This drawing contains valuable, confidential, proprietary, trade secret information of DesignTech Residential Planners, Inc. No reproduction or other use of the drawing or any of its contents is permitted without consent of DesignTech Residential Planners, Inc.

A-2