

PLOT MARK: A:\1 - Commercial\2024 - Cross Section\Bldg A\Bldg A Demo Reflected Ceiling Plan.dwg
 PLOT DATE: 10/10/2024 10:07:05 AM
 PLOT SCALE: 1/4"=1'-0"
 PLOT SHEET: 1 of 1

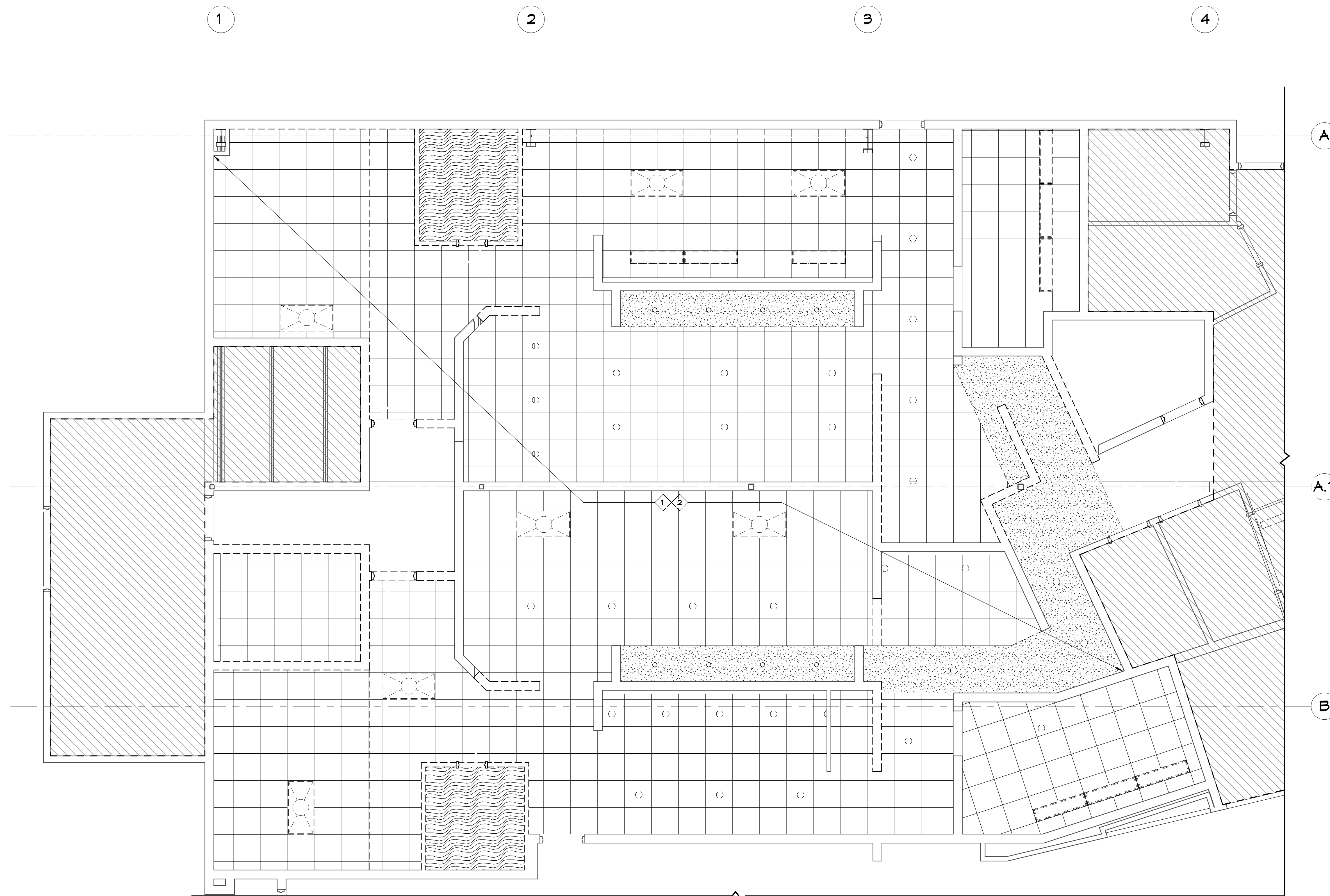

21ST FLOOR BLDG A DEMO REFLECTED CEILING PLAN
 SCALE: 1/4"=1'-0"

GENERAL DEMO NOTES

1. THIS DEMOLITION PLAN HAS BEEN DERIVED FROM EXISTING BUILDING PLANS AND ARE INTENDED TO REASONABLY REPRESENT EXISTING CONDITIONS. ENGINEER DOES NOT GUARANTEE ACCURACY OF THE EXISTING CONDITIONS. CONTRACTOR TO FIELD VERIFY EXISTING CONDITIONS IN AREAS TO BE RENOVATED PRIOR TO BID IN ORDER TO PROVIDE AN ACCURATE BID AND BE AWARE OF ALL CONSTRUCTION METHODS NEEDED TO PROVIDE THE FINISHED PRODUCT AS SHOWN ON THE PLANS. ILLUSTRATIONS, DIMENSIONS, AND INFORMATION IN THESE DRAWINGS ARE BASED, IN PART, ON EXISTING DRAWINGS FURNISHED BY THE OWNER. ACTUAL CONDITIONS MAY DEVIATE FROM THAT SHOWN ON THE DRAWINGS. THE CONTRACTOR SHALL VERIFY ACTUAL CONDITIONS AND COORDINATE THE DEMOLITION WITH NEW WORK SO THAT DEMOLITION IS COMPLETE.
2. THE CONTRACTOR SHALL COORDINATE REMOVAL OF SMOKE AND OTHER FIRE ALARM ADDRESSABLE UNITS ATTACHED TO THE AHU WITH THE FIRE ALARM CONTRACTOR PRIOR TO REMOVAL.
3. THE CONTRACTOR SHALL TAKE ALL NECESSARY PRECAUTIONS TO ENSURE THE SAFETY OF THE PUBLIC AND/OR WORKMEN ON THE SITE TO PREVENT ACCIDENTS OR INJURY TO ANY PERSON ON OR ADJACENT TO THE PREMISES. THE CONTRACTOR SHALL COMPLY WITH ALL LAWS, ORDINANCES, AND REGULATIONS PERTAINING TO SAFETY AND THE PREVENTION OF ACCIDENTS.
4. ALL EXISTING STEEL FRAMING MEMBERS (COLUMNS, BEAMS, JOISTS, DECK, ETC...) SHALL REMAIN INTACT AND UNDAMAGED.
5. WHEN DEMOLITION TAKES PLACE, SHOULD ANY WORK AFFECT THE INTEGRITY OF THE STRUCTURE, WORK MUST STOP IMMEDIATELY, AND DAMMON ENGINEERING NOTIFIED. UNDER NO CIRCUMSTANCES SHALL REINFORCING OF ANY KIND BE DAMAGED, CUT, OR BROKEN.
6. EXISTING ITEMS, EQUIPMENT, PLUMBING FIXTURES, ETC. TO REMAIN IN PLACE SHALL BE PROTECTED FROM DIRT AND DAMAGE DURING DEMOLITION AND CONSTRUCTION.
7. ALL OPENINGS AND VOIDS LEFT BY THE REMOVAL OF EXISTING CONSTRUCTION, EQUIPMENT, PIPING, DUCTS, ETC. SHALL BE PROPERLY PATCHED AND CLOSED OFF TO MAINTAIN PROPER FIRE RATING IN WALL. PREPARE PATCHES TO RECEIVE NEW FINISHES AS REQUIRED.
8. WHERE A RATING HAS BEEN GIVEN TO AN EXISTING WALL, ALL PENETRATIONS (EXISTING OR NEW) MUST BE SEALED AND PROPERLY FIREPROOFED PER THAT RATING REQUIREMENT.
9. REMOVAL OF EXISTING HVAC SHALL INCLUDE DUCT WORK HANGERS, GRILLES, DIFFUSERS, THERMOSTATS, ETC. AS REQUIRED TO COMPLETE DEMOLITION.

DAMMON ENGINEERING, INC.
 LOUISIANA & MISSISSIPPI
 Chief Engineer: Brian Misch, PE
 554 Old Spanish Trail
 Slidell, LA 70568
 www.dammonengineering.com
 info@dammonengineering.com
 PH: 985.649.5832

#	DESCRIPTION	DATE



KEY NOTES

- 1 REMOVE EXISTING LIGHTING AND CAP OFF IN THIS AREA.
- 2 REMOVE EXISTING CEILING IN THIS AREA.

DEMO LEGEND

- EXISTING TO REMAIN
- - - DEMO

MENS AND WOMENS LOCKER ROOM
CROSSETTES
ATHLETIC CLUB
 200 NORTH MILITARY ROAD
 SLIDELL, LA
 JOB No: 2527 DATE: 10-10-2024
 DRAWN BY: JMS CHECKED BY: JMS

SHEET TITLE:
 1ST FLOOR BLDG A DEMO
 REFLECTED CEILING PLAN

DRAWING NUMBER:

D102